

SUMMARY

Wires

Low voltage 4



Image is for illustrative purpose only

Series	4B
Termination type	Female crimp
IP rating	50
AWG wire size	14.00 - 10.00
Cable Ø	9.10 - 10.50 mm
Status	active
Matching parts	FGA.4B.304.CYCD10Z

Download

[Request a quote](#)

[Catalog](#)

TECHNICAL DETAILS

Mechanics

Shell Style/Model	PF*: Fixed receptacle, with two nuts, cable collet (back panel mounting)
Keying	2 keys (alpha=30, plug: male contacts, receptacle: female contacts)
Housing Material	Brass (chrome plated [SAE AMS 2460]) shell and collet nut, nickel plated [SAE AMS QQ N 290] brass latch sleeve and mid pieces
Variant	Z : Nut for fitting a bend relief
Weight	153.18 g

Performance

Configuration	4B.304 : 4 Low Voltage
Insulator	Y: PEEK for crimp contacts
Rated Current	30 Amps

Specifications

Contact Type: Crimp
Contact Retention: 75 N
Contact Dia.: 3 mm (0.118in)
Bucket Dia.: 2.9 mm (0.114in)
Min. Conductor: 2.5 mm ² (AWG 14)
Max. Conductor: 4 mm ² (AWG 10)

LEMO products and services are provided "as is". LEMO makes no warranties or representations with regard to LEMO product & services or use of them, express, implied or statutory, including for accuracy, completeness, or security. The user is fully responsible for his products and applications using LEMO components.

R (max): 3.1 mOhm
Vtest (contact-shell): 1200 V (AC), 1700 V (DC)
Vtest (contact-contact): 1800 V (AC), 2550 V (DC)

Others

Endurance (Shell): 5000
Temp (min / max): -55°C / +250°C
Humidity (max): <=95% [at 60 deg C / 140 F]
Vibration: 15 g [10 Hz - 2000 Hz]
Shock Resistance: 100 g [6 ms]
Climatical Category: 50/175/21
Shielding (min): 75 dB (10 MHz)
Shielding (min): 40 dB (1 GHz)
Salt Spray Corrosion: >1000 hr

DRAWINGS

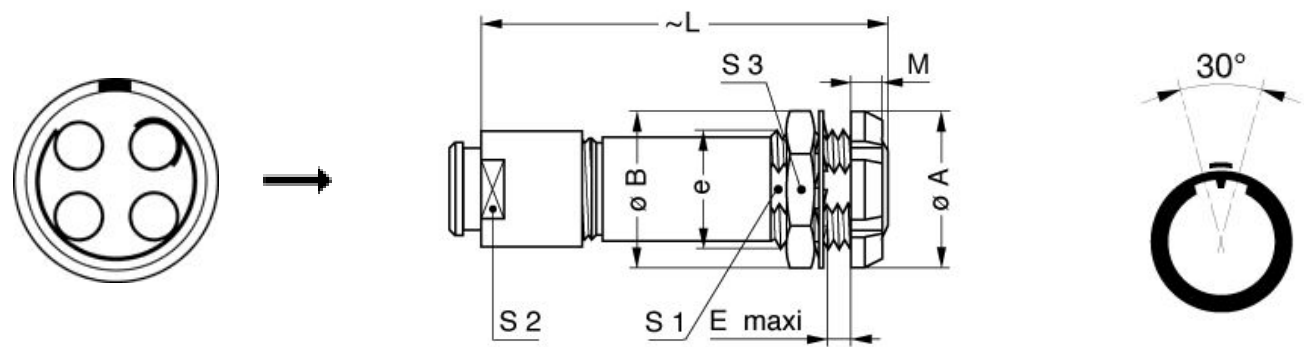

Dimensions

	A	B	E	L	M	S1	S2	S3	e
mm.	30	32	11	69	4.5	23.5	20	30	M25x1.0
in.	1,18	1,26	0,43	2,72	0,18	0,93	0,79	1,18	

RECOMMENDED BY LEMO

LEMO products and services are provided “as is”. LEMO makes no warranties or representations with regard to LEMO product & services or use of them, express, implied or statutory, including for accuracy, completeness, or security. The user is fully responsible for his products and applications using LEMO components.

Tools

Crimp Tool:	DPC.91.102.V
Crimp settings:	AWG/Selector = 10-12-14/3-1-1
Positionner:	DCE.91.304.BVCM
Extractor:	DCF.91.303.5LT
Replacement contact:	EGG.4B.680.ZZM

LEMO products and services are provided "as is". LEMO makes no warranties or representations with regard to LEMO product & services or use of them, express, implied or statutory, including for accuracy, completeness, or security. The user is fully responsible for his products and applications using LEMO components.