

Please be informed that the data shown in this PDF document is generated from our online catalog. Please find the complete data in the user documentation. Our general terms of use for downloads are valid.



T distributor, PROFIBUS DP (12 Mbps), 5-position, shielded, Socket straight M12, coding: B, on Plug straight M12, coding: B and Plug straight M12, coding: B

Your advantages

- Safe use in the field, thanks to a high degree of protection
- Reliable signal transmission – 360° shielding in environments with electromagnetic interference

Commercial data

| | |
|--------------------------------------|---------------------|
| Item number | 1424711 |
| Packing unit | 1 pc |
| Minimum order quantity | 1 pc |
| Sales key | BF10 |
| Product key | BF1GAA |
| Catalog page | Page 436 (C-2-2019) |
| GTIN | 4055626376745 |
| Weight per piece (including packing) | 49.4 g |
| Weight per piece (excluding packing) | 49.4 g |
| Customs tariff number | 85366990 |
| Country of origin | DE |

1424711

<https://www.phoenixcontact.com/us/products/1424711>

Technical data

Product properties

| | |
|----------------------|---------------|
| Product type | T-distributor |
| Sensor type | PROFIBUS DP |
| Number of positions | 5 |
| No. of cable outlets | 2 |
| Shielded | yes |
| Coding | B |
| Thread type | M12 |

Insulation characteristics

| | |
|----------------------|----|
| Overvoltage category | II |
| Degree of pollution | 3 |

Electrical properties

| | |
|-----------------------|-----------------------|
| Nominal voltage U_N | 48 V AC |
| | 60 V DC |
| Nominal current I_N | 1 A (Contact 2 and 4) |
| | 4 A (Contact 1 and 3) |
| Transmission medium | Copper |

Interfaces

| | |
|----------------------|----------------------|
| Signal type/category | PROFIBUS DP, 12 Mbps |
|----------------------|----------------------|

Signaling

| | |
|------------------------|----|
| Status display | no |
| Status display present | No |

Dimensions

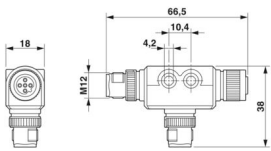
| | |
|---------------------|--------------------------------------------------------------------------------------|
| Dimensional drawing |  |
| Height | 18 mm |
| Length | 66.5 mm |

Material specifications

| | |
|----------------------------------------|----------------------------------------|
| Material | PBT (Female connector contact carrier) |
| | (Pin contact carrier) |
| Flammability rating according to UL 94 | V0 |
| Seal material | NBR |
| Material of grip body | PBT |

SAC-5PT-FB/2XMB PBDP SH - T distributor



1424711

<https://www.phoenixcontact.com/us/products/1424711>

| | |
|-------------------------------|------------------------------|
| Contact material | CuZn (pin) / CuSn (socket) |
| Contact surface material | Ni/Au |
| Material for screw connection | Zinc die-cast, nickel-plated |

Connector

Connection 1

| | |
|-------------|---------------------|
| Type | Socket straight M12 |
| Coding type | B |

Connection 2

| | |
|-------------|-------------------|
| Type | Plug straight M12 |
| Coding type | B |

Connection 3

| | |
|-------------|-------------------|
| Type | Plug straight M12 |
| Coding type | B |

Cable/line

| | |
|----------------------|----------------------|
| Signal type/category | PROFIBUS DP, 12 Mbps |
|----------------------|----------------------|

Mechanical properties

Mechanical data

| | |
|-----------------------------|-------|
| Insertion/withdrawal cycles | ≥ 100 |
|-----------------------------|-------|

Environmental and real-life conditions

Ambient conditions

| | |
|---------------------------------|----------------------------------|
| Degree of protection | IP65 |
| Ambient temperature (operation) | -25 °C ... 85 °C (Plug / socket) |

Standards and regulations

| | |
|--------------------------|------------------------------|
| Standard designation | M12 connector |
| Standards/specifications | according to IEC 61076-2-101 |

Drawings

Schematic diagram

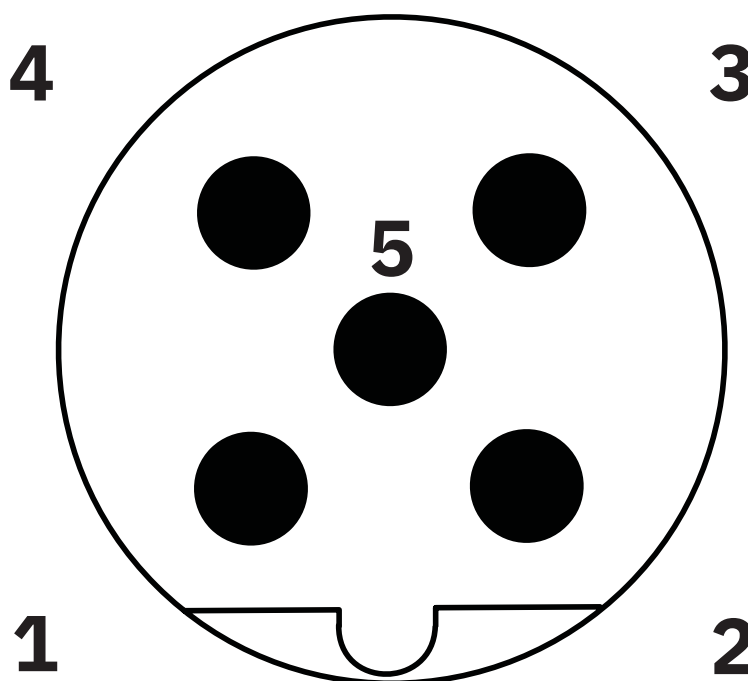

Pin assignment M12 male connector, 5-pos., B-coded, male side

SAC-5PT-FB/2XMB PBDP SH - T distributor

1424711

<https://www.phoenixcontact.com/us/products/1424711>

Schematic diagram

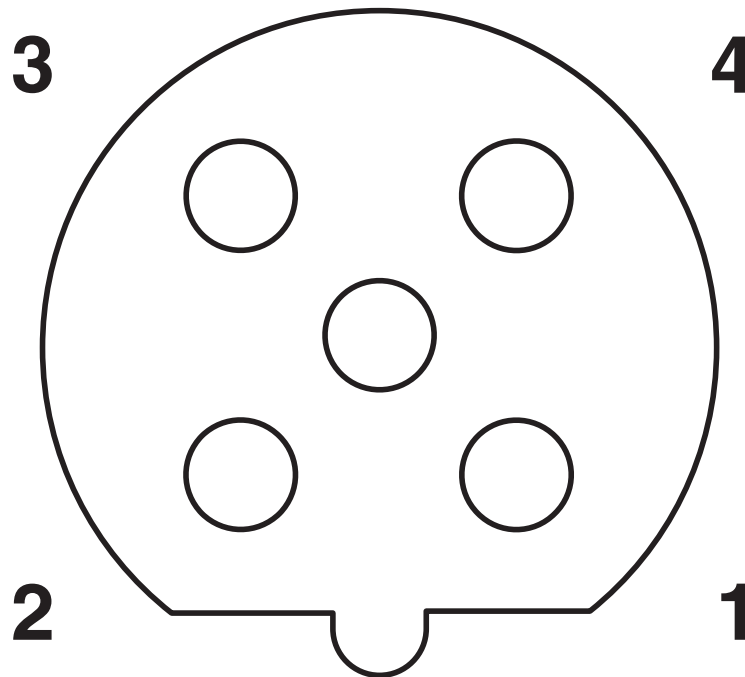

Pin assignment M12 socket, 5-pos., B-coded, female side

Dimensional drawing

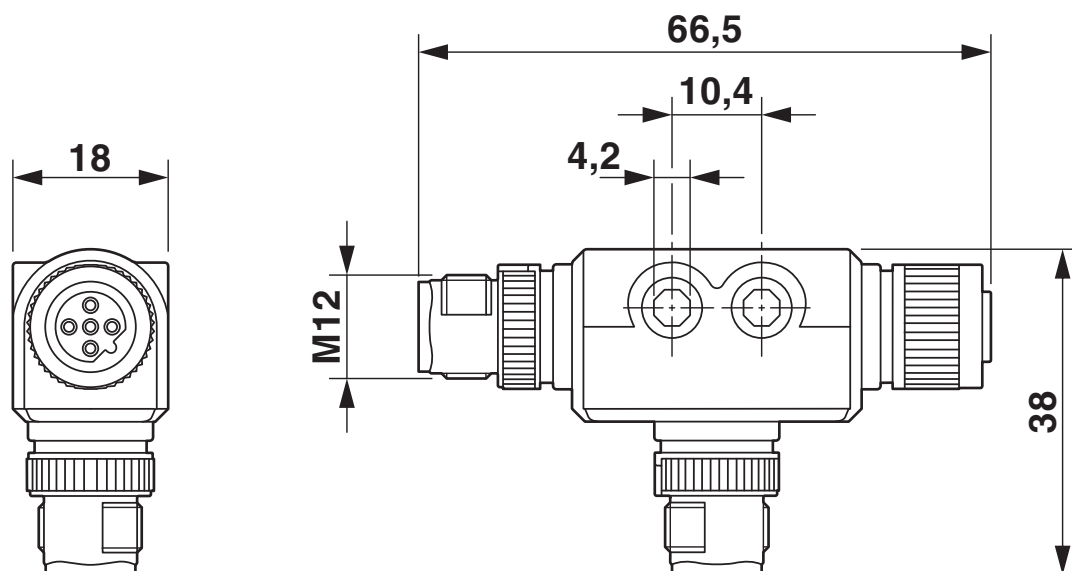

M12 T distributor

1424711

<https://www.phoenixcontact.com/us/products/1424711>

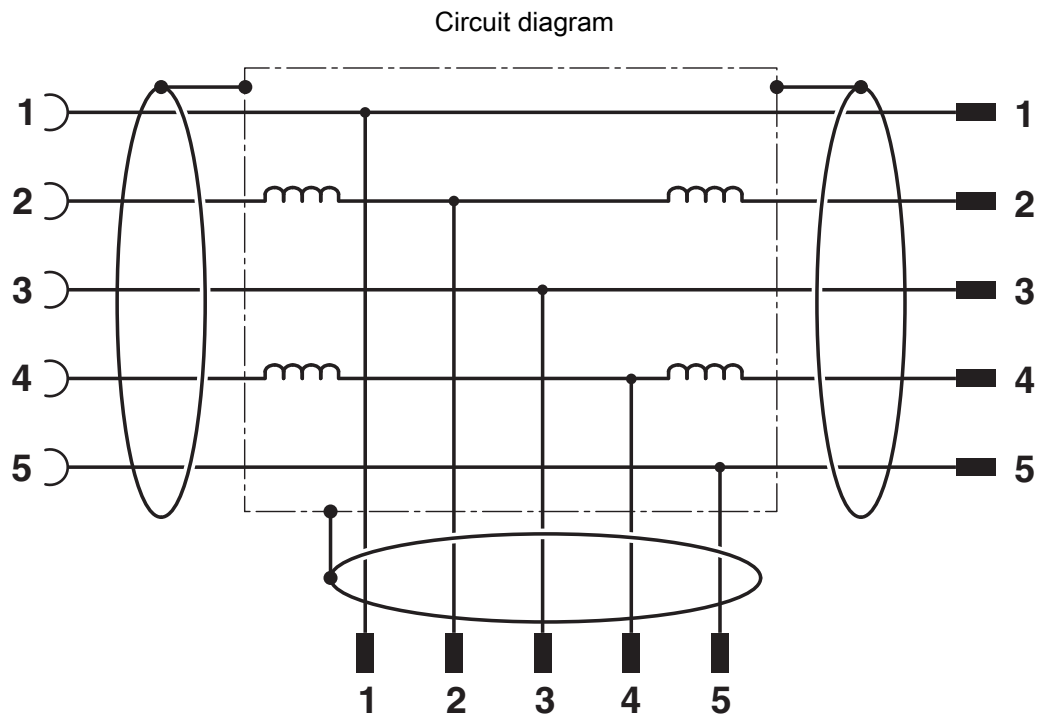

Contact assignment of the M12 plug and the M12 socket

SAC-5PT-FB/2XMB PBDP SH - T distributor



1424711

<https://www.phoenixcontact.com/us/products/1424711>

Classifications

ECLASS

| | |
|-------------|----------|
| ECLASS-11.0 | 27440106 |
| ECLASS-12.0 | 27440106 |
| ECLASS-13.0 | 27440106 |

ETIM

| | |
|----------|----------|
| ETIM 9.0 | EC002925 |
|----------|----------|

UNSPSC

| | |
|-------------|----------|
| UNSPSC 21.0 | 31251500 |
|-------------|----------|

SAC-5PT-FB/2XMB PBDP SH - T distributor



1424711

<https://www.phoenixcontact.com/us/products/1424711>

Environmental product compliance

| | |
|-----------------------------------------|------------------------------------------|
| EU RoHS | |
| Fulfills EU RoHS substance requirements | Yes, No exemptions |
| China RoHS | |
| Environment friendly use period (EFUP) | EFUP-E |
| | No hazardous substances above the limits |
| EU REACH SVHC | |
| REACH candidate substance (CAS No.) | No substance above 0.1 wt% |

Phoenix Contact 2025 © - all rights reserved
<https://www.phoenixcontact.com>

Phoenix Contact USA
586 Fulling Mill Road
Middletown, PA 17057, United States
(+717) 944-1300
info@phoenixcon.com