

C-RCI 2,5/M6 - Ring cable lug

3240025

<https://www.phoenixcontact.com/us/products/3240025>



Please be informed that the data shown in this PDF document is generated from our online catalog. Please find the complete data in the user documentation. Our general terms of use for downloads are valid.



Ring cable lug, blue, 1.5 ... 2.5 mm², M6

Your advantages

- The sleeves are conically tapered to facilitate easy and correct insertion of the conductor
- The insulated ring cable lugs with plastic sleeve are hard-soldered and feature the 'EASY ENTRY' system

Commercial data

| | |
|--------------------------------------|---------------------|
| Item number | 3240025 |
| Packing unit | 50 pc |
| Minimum order quantity | 50 pc |
| Sales key | BH34 |
| Product key | BH3421 |
| Catalog page | Page 492 (C-3-2019) |
| GTIN | 4046356452021 |
| Weight per piece (including packing) | 1.251 g |
| Weight per piece (excluding packing) | 1.243 g |
| Customs tariff number | 85369010 |
| Country of origin | CN |

C-RCI 2,5/M6 - Ring cable lug

3240025

<https://www.phoenixcontact.com/us/products/3240025>



Technical data

Product properties

| | |
|------------------|--------------------------|
| Product type | Connector |
| Product property | halogen-free |
| | With "Easy Entry" system |

Electrical properties

| | |
|------|-----|
| Fuse | yes |
|------|-----|

Dimensions

| | |
|--|---------|
| Dimensional drawing | |
| Width | 12 mm |
| Sleeve length | 28.1 mm |
| Length of the insulating material sleeve | 11 mm |
| Maximum stripping length | 8 mm |
| Distance from the center to the insulating material sleeve | 11 mm |
| Min. material thickness | 0.8 mm |
| Inner dimensions of the insulating collar | 4.5 mm |

Internal dimensions

| | |
|-------------------|--------|
| Internal diameter | 6.5 mm |
|-------------------|--------|

Material specifications

| | |
|--|-----------------|
| Color | blue (RAL 5015) |
| Material | Copper |
| Flammability rating according to UL 94 | V2 |
| Coating | tin-plated |
| Insulating material | PA |
| Components | halogen-free |

Mechanical properties

Technical data

| | |
|---------------|---------|
| Sleeve length | 28.1 mm |
|---------------|---------|

Environmental and real-life conditions

Ambient conditions

| | |
|---|---|
| Optimum ambient temperature (storage/transport) | 20.00 °C 50.00 % Humidity (RH), store inside sealed original packaging. Avoid direct sunlight and heat. |
|---|---|

C-RCI 2,5/M6 - Ring cable lug



3240025

<https://www.phoenixcontact.com/us/products/3240025>

| | |
|---------------------------------|-------------------|
| Ambient temperature (operation) | -20 °C ... 105 °C |
| Ambient temperature (assembly) | -20 °C ... 100 °C |
| Short-term temperature | 100 °C |

Standards and regulations

| | |
|------------------------------|--------------|
| Design according to standard | JIS, UL, CSA |
|------------------------------|--------------|

C-RCI 2,5/M6 - Ring cable lug

3240025

<https://www.phoenixcontact.com/us/products/3240025>



Drawings

Dimensional drawing

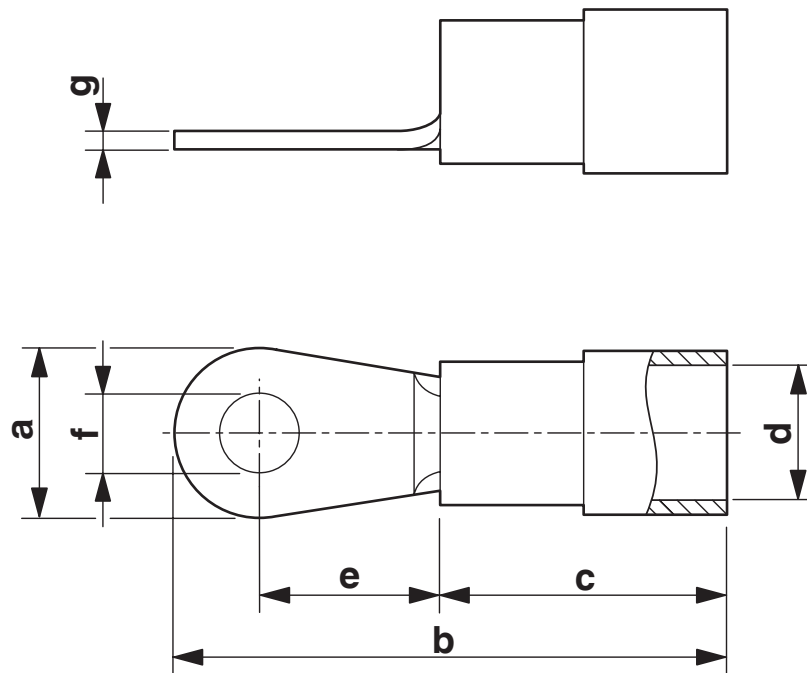

C-RCI 2,5/M6 - Ring cable lug

3240025

<https://www.phoenixcontact.com/us/products/3240025>



Classifications

ECLASS

| | |
|-------------|----------|
| ECLASS-11.0 | 27400204 |
| ECLASS-13.0 | 27400204 |
| ECLASS-12.0 | 27400204 |

ETIM

| | |
|----------|----------|
| ETIM 9.0 | EC001052 |
|----------|----------|

UNSPSC

| | |
|-------------|----------|
| UNSPSC 21.0 | 27121700 |
|-------------|----------|

C-RCI 2,5/M6 - Ring cable lug

3240025

<https://www.phoenixcontact.com/us/products/3240025>



Environmental product compliance

EU RoHS

| | |
|---|--------------------|
| Fulfills EU RoHS substance requirements | Yes, No exemptions |
|---|--------------------|

China RoHS

| | |
|--|--|
| Environment friendly use period (EFUP) | EFUP-E |
| | No hazardous substances above the limits |

EU REACH SVHC

| | |
|-------------------------------------|----------------------------|
| REACH candidate substance (CAS No.) | No substance above 0.1 wt% |
|-------------------------------------|----------------------------|

Phoenix Contact 2025 © - all rights reserved
<https://www.phoenixcontact.com>

Phoenix Contact USA
586 Fulling Mill Road
Middletown, PA 17057, United States
(+717) 944-1300
info@phoenixcon.com