

# HC-HPR-B16-HHWH-1TTM40-EM-BK - Housing



1411885

<https://www.phoenixcontact.com/us/products/1411885>

Please be informed that the data shown in this PDF document is generated from our online catalog. Please find the complete data in the user documentation. Our general terms of use for downloads are valid.



Sleeve housing B16, with screw locking, material: Die-cast aluminum, cable outlets: 1, straight, 1x M40, height: 110.5 mm, cable gland: none, protective cover: no, Railway applications, for increased environmental and EMC requirements, Series HPR

## Your advantages

- Vibration and shock: IEC 61373/EN 50155, category 1, class 1B

## Commercial data

Item number	1411885
Packing unit	1 pc
Minimum order quantity	1 pc
Sales key	BF60
Product key	BF7AAI
Catalog page	Page 628 (C-4-2015)
GTIN	4046356944533
Weight per piece (including packing)	651 g
Weight per piece (excluding packing)	746 g
Customs tariff number	85389099
Country of origin	CN

# HC-HPR-B16-HHWH-1TTM40-EM-BK - Housing



1411885

<https://www.phoenixcontact.com/us/products/1411885>

## Technical data

### Notes

General	For contact inserts HC-B16, BB32, BBB40, D40, DD72, HS6, M, K
---------	---

### Product properties

Product type	Housing with screw locking
Housing type	Sleeve housing
Product family	HC-HPR-B
Series	HPR-B16
Application	Railway applications
Type	B16
No. of cable outlets	1
Type of the screw connection	1x M40
Type	Tall design
Protective cover	no
Cable outlet	straight
Pg screw connection	none

### Dimensions

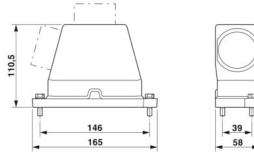
Dimensional drawing	
Width	59.2 mm
Height	110.5 mm
Length	166.2 mm

### Material specifications

Housing material	Die-cast aluminum
Housing surface material	Powder-coated, black
Locking latch material	Stainless steel

### Environmental and real-life conditions

#### Ambient conditions

Degree of protection	IP66
	IP68 (0.5 bar / 24 h)
	IP69 (ISO 20653:2013-02)
Impact strength	IK09
Ambient temperature (operation)	-40 °C ... 125 °C

# HC-HPR-B16-HHWH-1TTM40-EM-BK - Housing



1411885

<https://www.phoenixcontact.com/us/products/1411885>

## Mechanical properties

### Mechanical data

Type of the screw connection	1x M40
Locking type	Screw

## Mounting

Assembly note	M6 locking screw, slotted hexagon head screw (SW10), tightening torque: 4 Nm
---------------	---

# HC-HPR-B16-HHWH-1TTM40-EM-BK - Housing

1411885

<https://www.phoenixcontact.com/us/products/1411885>



## Drawings

Dimensional drawing

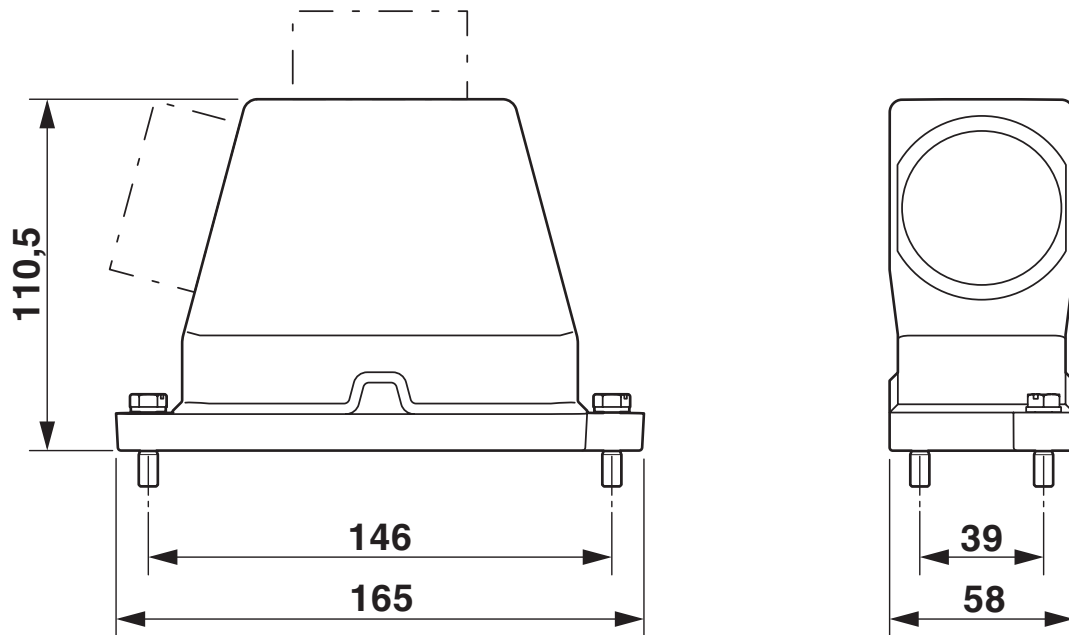

Dimensional drawing

# HC-HPR-B16-HHWH-1TTM40-EM-BK - Housing



1411885

<https://www.phoenixcontact.com/us/products/1411885>

## Approvals

💡 To download certificates, visit the product detail page: <https://www.phoenixcontact.com/us/products/1411885>

### DNV

Approval ID: TAE000037S



### EAC

Approval ID: RU C-DE.AI30.B.01102

# HC-HPR-B16-HHWH-1TTM40-EM-BK - Housing



1411885

<https://www.phoenixcontact.com/us/products/1411885>

## Classifications

### ECLASS

ECLASS-11.0	27440202
ECLASS-12.0	27440202
ECLASS-13.0	27440202

### ETIM

ETIM 9.0	EC000437
----------	----------

### UNSPSC

UNSPSC 21.0	31261500
-------------	----------

Environmental product compliance

EU RoHS	
Fulfills EU RoHS substance requirements	Yes, No exemptions
China RoHS	
Environment friendly use period (EFUP)	EFUP-E
	No hazardous substances above the limits
EU REACH SVHC	
REACH candidate substance (CAS No.)	No substance above 0.1 wt%

Phoenix Contact 2025 © - all rights reserved  
<https://www.phoenixcontact.com>

Phoenix Contact USA  
586 Fulling Mill Road  
Middletown, PA 17057, United States  
(+717) 944-1300  
[info@phoenixcon.com](mailto:info@phoenixcon.com)