

HC-STA-D25-BWS-EL-AL - Housing



1424391

<https://www.phoenixcontact.com/us/products/1424391>

Please be informed that the data shown in this PDF document is generated from our online catalog. Please find the complete data in the user documentation. Our general terms of use for downloads are valid.



Panel mounting base D25, with single locking latch, material: Die-cast aluminum, salt water resistant, height: 26 mm, cable gland: none, Standard

Commercial data

Item number	1424391
Packing unit	1 pc
Minimum order quantity	1 pc
Sales key	BF56
Product key	BF7APE
Catalog page	Page 531 (C-2-2019)
GTIN	4055626371313
Weight per piece (including packing)	76.6 g
Weight per piece (excluding packing)	70 g
Customs tariff number	85389099
Country of origin	CN

HC-STA-D25-BWS-EL-AL - Housing

1424391

<https://www.phoenixcontact.com/us/products/1424391>



Technical data

Notes

General	For contact inserts HC-D25, A16
---------	---------------------------------

Product properties

Product type	Housing with locking latch
Housing type	Panel mounting base
Product family	HC-STA-D
Application	Standard
Type	D25
Pg screw connection	none

Dimensions

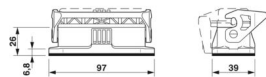
Dimensional drawing	
Width	39 mm
Height	26 mm
Length	97 mm
Hole diameter	3.3 mm

Installation dimensions

Width of the assembly cutout	24 mm
Length of the assembly cutout	74 mm

Material specifications

Flammability rating according to UL 94	V0 (Interlock)
Seal material	NBR, conductive
Housing material	Die-cast aluminum, salt water resistant
Housing surface material	uncoated
Locking latch material	PA

Mechanical properties

Mechanical data

Locking type	Latch
--------------	-------

Connection data

Tightening torque	0.5 Nm ... 0.8 Nm (For M3 mounting screws on the panel-mount base)
-------------------	--

Environmental and real-life conditions

HC-STA-D25-BWS-EL-AL - Housing

1424391

<https://www.phoenixcontact.com/us/products/1424391>



Ambient conditions

Degree of protection	IP66
	IP67
Impact strength	IK08
Ambient temperature (operation)	-40 °C ... 125 °C

HC-STA-D25-BWS-EL-AL - Housing

1424391

<https://www.phoenixcontact.com/us/products/1424391>



Drawings

Dimensional drawing

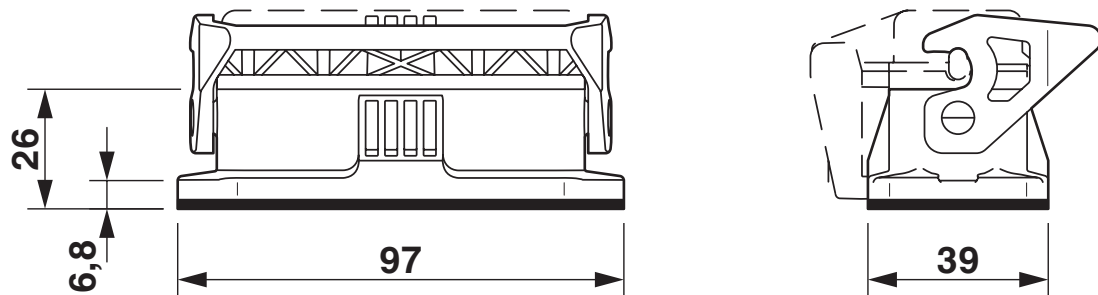

Dimensional drawing

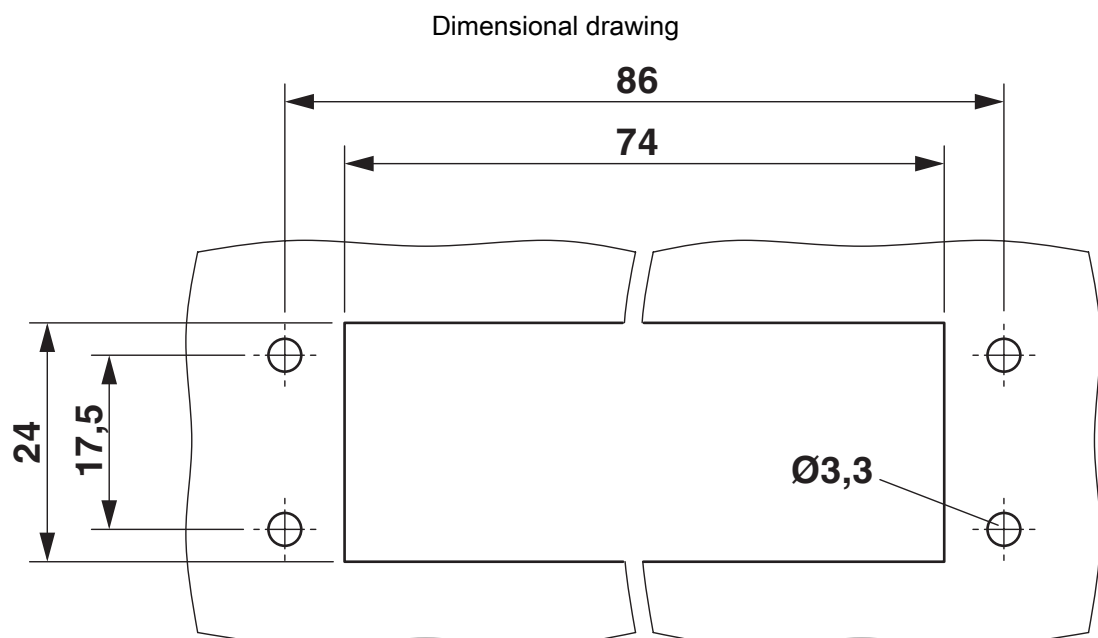

Mounting cutout

HC-STA-D25-BWS-EL-AL - Housing



1424391

<https://www.phoenixcontact.com/us/products/1424391>

Approvals

To download certificates, visit the product detail page: <https://www.phoenixcontact.com/us/products/1424391>



DNV
Approval ID: TAE000037S



cUL Recognized
Approval ID: E255026



UL Recognized
Approval ID: E255026

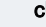

cULus Recognized

HC-STA-D25-BWS-EL-AL - Housing

1424391

<https://www.phoenixcontact.com/us/products/1424391>



Classifications

ECLASS

ECLASS-11.0	27440202
ECLASS-12.0	27440202
ECLASS-13.0	27440202

ETIM

ETIM 9.0	EC000437
----------	----------

UNSPSC

UNSPSC 21.0	31261500
-------------	----------

HC-STA-D25-BWS-EL-AL - Housing



1424391
<https://www.phoenixcontact.com/us/products/1424391>

Environmental product compliance

EU RoHS	
Fulfills EU RoHS substance requirements	Yes, No exemptions
China RoHS	
Environment friendly use period (EFUP)	EFUP-E
	No hazardous substances above the limits
EU REACH SVHC	
REACH candidate substance (CAS No.)	No substance above 0.1 wt%

Phoenix Contact 2025 © - all rights reserved
<https://www.phoenixcontact.com>

Phoenix Contact USA
586 Fulling Mill Road
Middletown, PA 17057, United States
(+717) 944-1300
info@phoenixcon.com