



Connectors > Terminal Blocks & Strips > Barrier Strips



Number of Positions: 12

Barrier Strip Style: **Tri-Barrier**

Bottom Termination Type: **Printed Circuit Pin**

Connector System: **Wire-to-Board**

Centerline (Pitch): **9.53 mm [.375 in]**

Features

Industry Standards

| | |
|------------------------|----------|
| UL Flammability Rating | UL 94V-0 |
|------------------------|----------|

Packaging Features

| | |
|--------------------|---------|
| Packaging Method | Package |
| Packaging Quantity | 80 |

Operation/Application

| | |
|---------------------|-------|
| Circuit Application | Power |
|---------------------|-------|

Mechanical Attachment

| | |
|-------------------------|-----------------------|
| Top Termination Type | Wire Clamp Combo Head |
| Mounting Options | None |
| Screw Plating Material | Zinc Chromate |
| Screw Material | Steel |
| Thread Size | 6-32 |
| Screw Head Type | Combo Phil-Slot |
| Connector Mounting Type | Board Mount |



Contact Features

| | |
|---|--------------|
| Contact Base Material | Copper Alloy |
| PCB Contact Termination Area Plating Material | Tin |
| Contact Current Rating (Max) | 25 A, 5 A |

Dimensions

| | |
|----------------|---------------------|
| Product Length | 115.85 mm[4.561 in] |
| Wire Size | 22 – 12 AWG |

Housing Features

| | |
|--------------------|------------------|
| Housing Material | Thermoplastic |
| Centerline (Pitch) | 9.53 mm[.375 in] |

Product Type Features

| | |
|-----------------------------------|----------------------------|
| Block Style | Flat Bottom with standoffs |
| Connector System | Wire-to-Board |
| Connector & Contact Terminates To | Printed Circuit Board |

Body Features

| | |
|-----------------------|-------------|
| Primary Product Color | Black |
| Product Orientation | Vertical |
| Barrier Strip Style | Tri-Barrier |

Configuration Features

| | |
|---------------------|----|
| Number of Levels | 1 |
| Number of Positions | 12 |
| Number of Rows | 1 |

Termination Features

| | |
|-------------------------|---------------------|
| Bottom Termination Type | Printed Circuit Pin |
|-------------------------|---------------------|

Electrical Characteristics

| | |
|-------------------|--------------|
| Operating Voltage | 300 V, 600 V |
|-------------------|--------------|

Other

| | |
|--------------------|-----------|
| EU RoHS Compliance | Compliant |
| EU ELV Compliance | Compliant |

Product Compliance

For compliance documentation, visit the product page on [TE.com](#)>



| | |
|---|---|
| EU RoHS Directive 2011/65/EU | Compliant |
| EU ELV Directive 2000/53/EC | Compliant |
| China RoHS 2 Directive MIIT Order No 32, 2016 | No Restricted Materials Above Threshold |
| EU REACH Regulation (EC) No. 1907/2006 | Current ECHA Candidate List: JUNE 2024 (241) Candidate List Declared Against: JUNE 2024 (241) Does not contain REACH SVHC |
| Halogen Content | Low Halogen - Br, Cl, F, I < 900 ppm per homogenous material. Also BFR/CFR/PVC Free |
| Solder Process Capability | Wave solder capable to 265°C |

Product Compliance Disclaimer

This information is provided based on reasonable inquiry of our suppliers and represents our current actual knowledge based on the information they provided. This information is subject to change. The part numbers that TE has identified as EU RoHS compliant have a maximum concentration of 0.1% by weight in homogenous materials for lead, hexavalent chromium, mercury, PBB, PBDE, DBP, BBP, DEHP, DIBP, and 0.01% for cadmium, or qualify for an exemption to these limits as defined in the Annexes of Directive 2011/65/EU (RoHS2). Finished electrical and electronic equipment products will be CE marked as required by Directive 2011/65/EU. Components may not be CE marked. Additionally, the part numbers that TE has identified as EU ELV compliant have a maximum concentration of 0.1% by weight in homogenous materials for lead, hexavalent chromium, and mercury, and 0.01% for cadmium, or qualify for an exemption to these limits as defined in the Annexes of Directive 2000/53/EC (ELV). Regarding the REACH Regulation, the information TE provides on SVHC in articles for this part number is based on the latest European Chemicals Agency (ECHA) 'Guidance on requirements for substances in articles' posted at this URL: <https://echa.europa.eu/guidance-documents/guidance-on-reach>

Compatible Parts



Also in the Series | Buchanan 6 Series

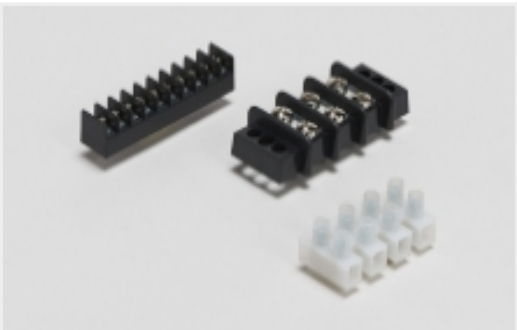

Barrier Strips(149)

Customers Also Bought



TE Part #CAT-104MTA-NGPNR
Nylon Gold Plated Receptacle: 2.54 mm, no Mating Alignment



TE Part #1623732-5
BCHE 7 W 12K 5%



TE Part #5-1437567-0
MPG106F=(MSPG) SWITCH
PUSHBUTT

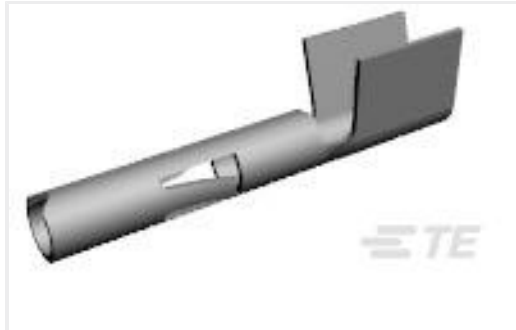

TE Part #640310-3
UMNL SOK 12-10 PTPPHBZ



TE Part #350922-3
PIN, MATE-N-LOK, UMNL

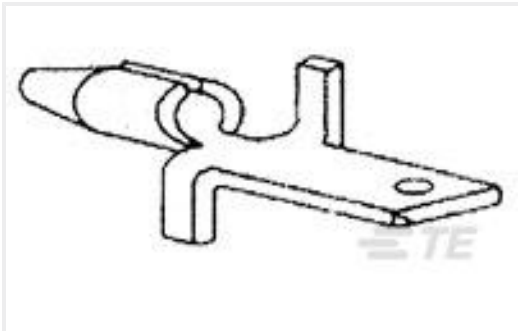

TE Part #61968-1
110 FASTON TAB TPBR

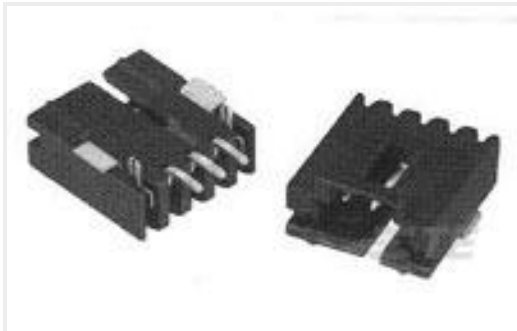

TE Part #5-147278-7
08 MTE HDR SRRA SFMNT .100CL



TE Part #1571527-2
FSM2JSMLTR=TACT SWITCH,SMT,
T&R



TE Part #1393249-6
W58-XB1A4A-1.50=W58

Documents

Product Drawings

6PCV-12-006=6PCV ASSEMBLY

English

CAD Files

Customer View Model

ENG_CVM_CVM_5-1437653-1_P.2d_dxf.zip

English

3D PDF



3D

Customer View Model

[ENG_CVM_CVM_5-1437653-1_P.3d_igs.zip](#)

English

Customer View Model

[ENG_CVM_CVM_5-1437653-1_P.3d_stp.zip](#)

English

By downloading the CAD file I accept and agree to the [Terms and Conditions](#) of use.

Datasheets & Catalog Pages

[1-1773458-2_BARRIER_STRIP_QUICK_REFERENCE_GUIDE](#)

English