

1. 产品尺寸图Product Dimension Drawing

标识点
Identification points

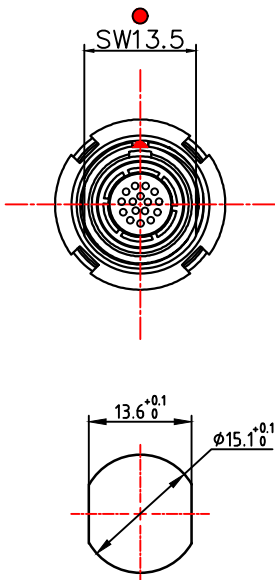

面板开孔尺寸
Panel cut-out size

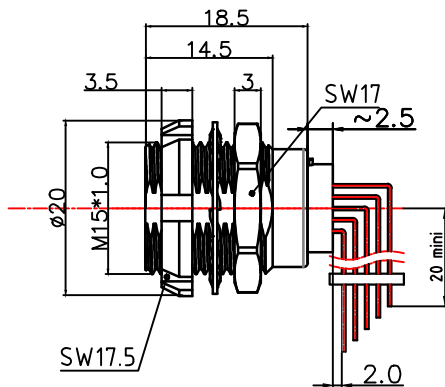

焊接顺序点
Weld sequence points

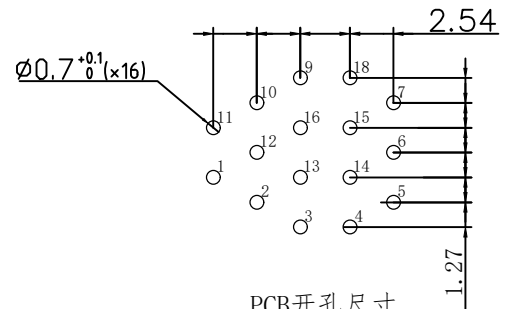
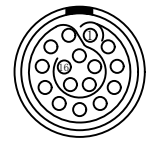

PCB开孔尺寸
PCB cut-out size

2. 产品电器参数Product electrical parameters

| | |
|---|--------------------|
| 防护等级 (Ingress protection) | IP50 |
| 插拔测试 (Plugging and unplugging test) | <5000次 |
| 产品耐温 (The product is temperature resistant) | -55° C / +250° C |
| 盐雾腐蚀 (Salt Spray Corrosion) | >72 hr |
| 测试电压 (kV rms) 针芯-针芯 | 0.95 |
| 测试电压 (kV rms) 针芯-外壳 | 1.25 |
| 额定电流Current rating | 6A |
| 导体接触规格 Conductor contact specifications | 0.7 |
| 最大接触电阻(mΩ)Maximum Contact Resistance (mΩ) | 12.5 |
| 绝缘电阻(Insulation resistance) | 5000MΩ (常态) |
| 屏蔽 (分钟) Shielding (min) | 100 g (6 ms) |
| 振动 Vibration | 15 g (10Hz-1000Hz) |

3. 环境及表面处理产品特性Environmental and surface treatment product characteristics

| | |
|--------------------------|---|
| 外壳材料 Housing material | 金属件铜合金镀镍镀铬 (Metal parts: copper alloy nickel plated and chrome plated) |
| 绝缘体材料 Insulator material | PPS (可选PEEK) PPS (optional PEEK) |
| 触体材料 Contact material | 铜合金镀金Copper alloy gold-plated |

| | | |
|--|---|--|
| | 东莞市通瑞电子科技有限公司 TongRuiJoin Dongguan Tongrui Electronic Technology Co., Ltd www.cntfre.com | 单芯图纸Single-core drawings 单位unit:mm 修改revise:A0 视图view: |
| | 2B双固定插座2B double fixed socket | 型号Model R.ECG.2B.16.CSV |

1: 连接器组装生产所有公差通常为0.1mm,2: 插座直接拧入螺纹孔中, 螺纹 +0.05mm
 1: All tolerances are usually 0.1mm for connector assembly production, 2: The socket is screwed directly into the threaded hole, the thread is +0.05mm