

ROHS

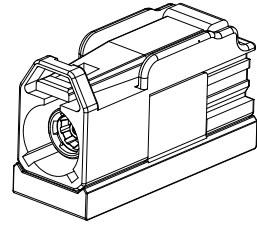

3D View

9.30 [0.366]

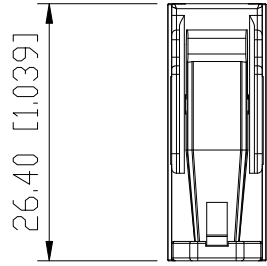
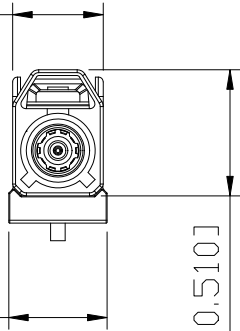

10.10 [0.398]

12.95 [0.510]

15.75 [0.620]

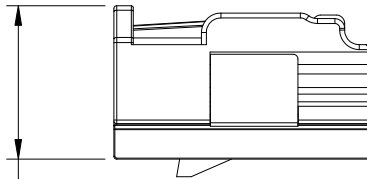

REVISIONS					
REV.	ECN NO.	LOCATION	DESCRIPTION	DATE	DESIGN
A0	N/A		INITIAL RELEASE	2024.08.22	

Specifications(规格):

- 1.Impedance(特性阻抗) : 50Ω;
- 2.Frequency (工作频率) : DC~6GHz;
- 3.VSWR (电压驻波比) : 1.50 @3GHz;
1.60 @6GHz;
- 4.Insulation resistance(绝缘阻抗) : ≥100MΩ;
- 5.Dielectric withstand voltage (介质耐电压) : 800V AC;
- 6.Mating cycles (耐久性) : ≥25;
- 7.Engagement force(啮合力) : ≤25N;
- 8.Retention force latch(保持力) : ≥110N;
- 9.Temperature range(使用温度) : -40℃~+105℃;

PART NO.:

XK1PLF1S7-NA36-X

Code: A~Z

BOM List:

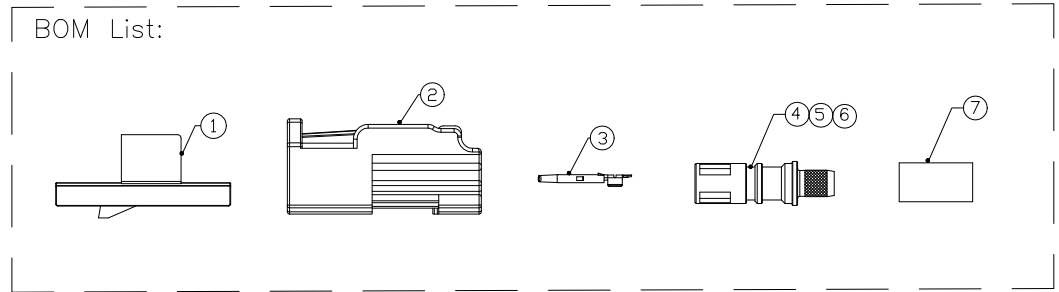

NO.	SPEC.	MATERIAL	FINISH (Contact)	Q'TY	Note
7	Outer Ferrule	Copper Alloy	Ni PLATED	1 PC	
6	Spring	Copper Alloy	Tin PLATED	1 PC	
5	Dielectric	PP		1 PC	
4	Outer Conductor	Zinc Alloy	Tin PLATED	1 PC	
3	Center Conductor	Copper Alloy	Gold PLATED	1 PC	5000PCS/R
2	Housing	PBT		1 PC	
1	Secondary Lock	PBT		1 PC	

ANGLAR	±5°
X.	±0.50
X.x	±0.30
X.xx	±0.20
X.xxx	±0.10

UNSPECIFIED TOLERANCES



DESIGN	希文	VIEW:	
CHECKED		UNIT:	mm/in
APPROVED		SIZE:	A4

MODEL TYPE:	FAKRA Female Connector for 302
PART NO.:	XK1PLF1S7-NA36-X
DWG NO.:	X-XK1PLF1S7-NA36-X

XKB INDUSTRIAL PRECISION CO.,LIMITED

SCALE	PAGE	REVISION
N/A	1/2	A0

REVISIONS					
REV.	ECN NO.	LOCATION	DESCRIPTION	DATE	DESIGN
A0	N/A		INITIAL RELEASE	2024.08.22	

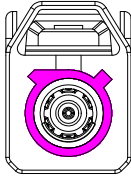
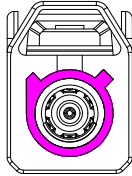
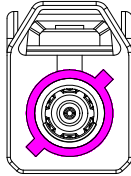
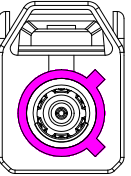
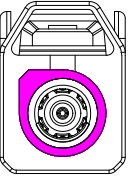
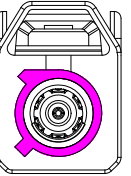
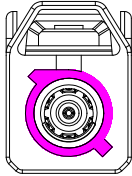
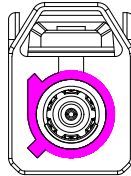
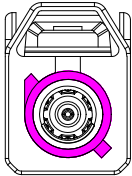
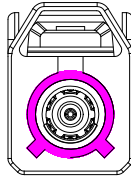
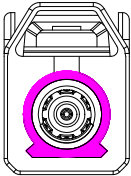
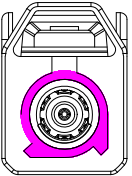
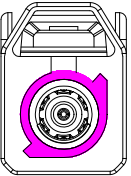
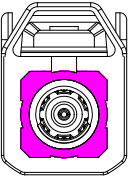
Code List:							
Colde							
	A	B	C	D	E	F	G
Color/RAL-No.	Black/9005	White/9001	Blue/5005	Bordeaux/4004	Green/6002	Brown/8011	Grey/7031
PART NO.	XK1PLF1S7-NA36-A	XK1PLF1S7-NA36-B	XK1PLF1S7-NA36-C	XK1PLF1S7-NA36-D	XK1PLF1S7-NA36-E	XK1PLF1S7-NA36-F	XK1PLF1S7-NA36-G
Colde							
	H	I	K	L	M	N	Z
Color/RAL-No.	Violet/4003	Beige/1001	Curry/1027	Carmine red/3002	Pastel Orange/2003	Pastel Green/6019	Water Blue/5021
PART NO.	XK1PLF1S7-NA36-H	XK1PLF1S7-NA36-I	XK1PLF1S7-NA36-K	XK1PLF1S7-NA36-L	XK1PLF1S7-NA36-M	XK1PLF1S7-NA36-N	XK1PLF1S7-NA36-Z

ANGLAR	±5°
X.	±0.40
X.x	±0.30
X.xx	±0.20
X.xxx	±0.15
UNSPECIFIED TOLERANCES	



DESIGN	希文
CHECKED	
APPROVED	

VIEW:	
UNIT:	mm/in
SIZE:	A4

MODEL TYPE:	FAKRA Female Connector for 302
PART NO.:	XK1PLF1S7-NA36-X
DWG NO.:	X-XK1PLF1S7-NA36-X

NOTE: ALL RIGHTS RESERVED, BANNED COPY!