

PART MUNBER  
SEE SHEET 2

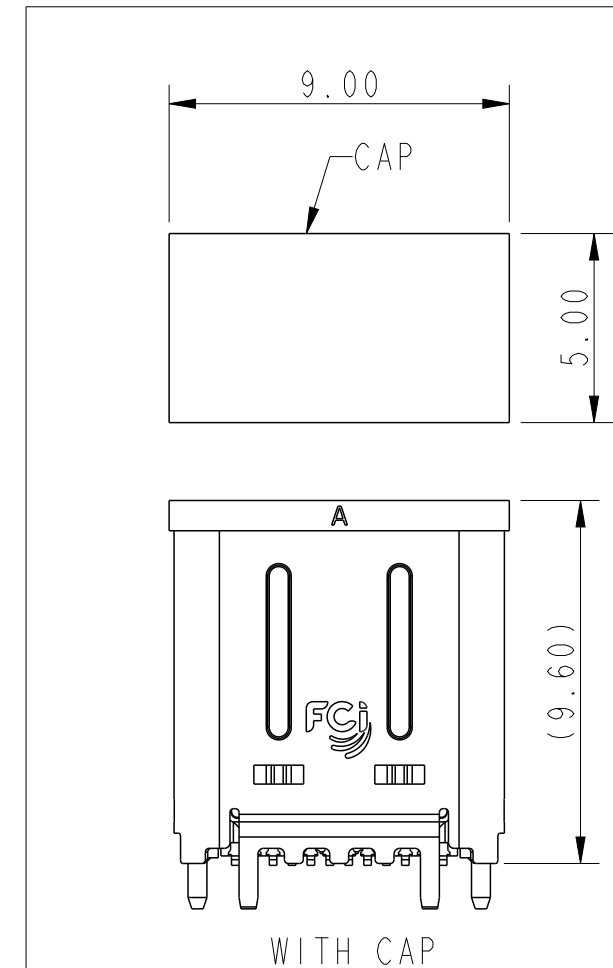
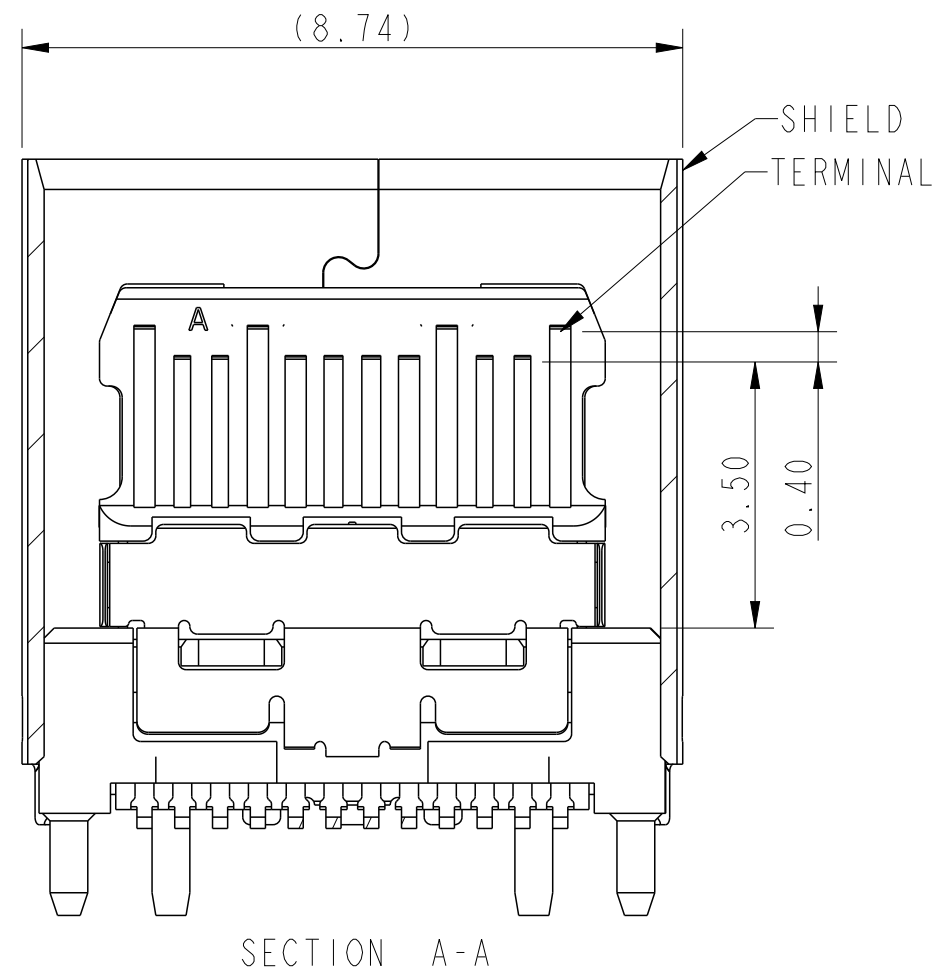
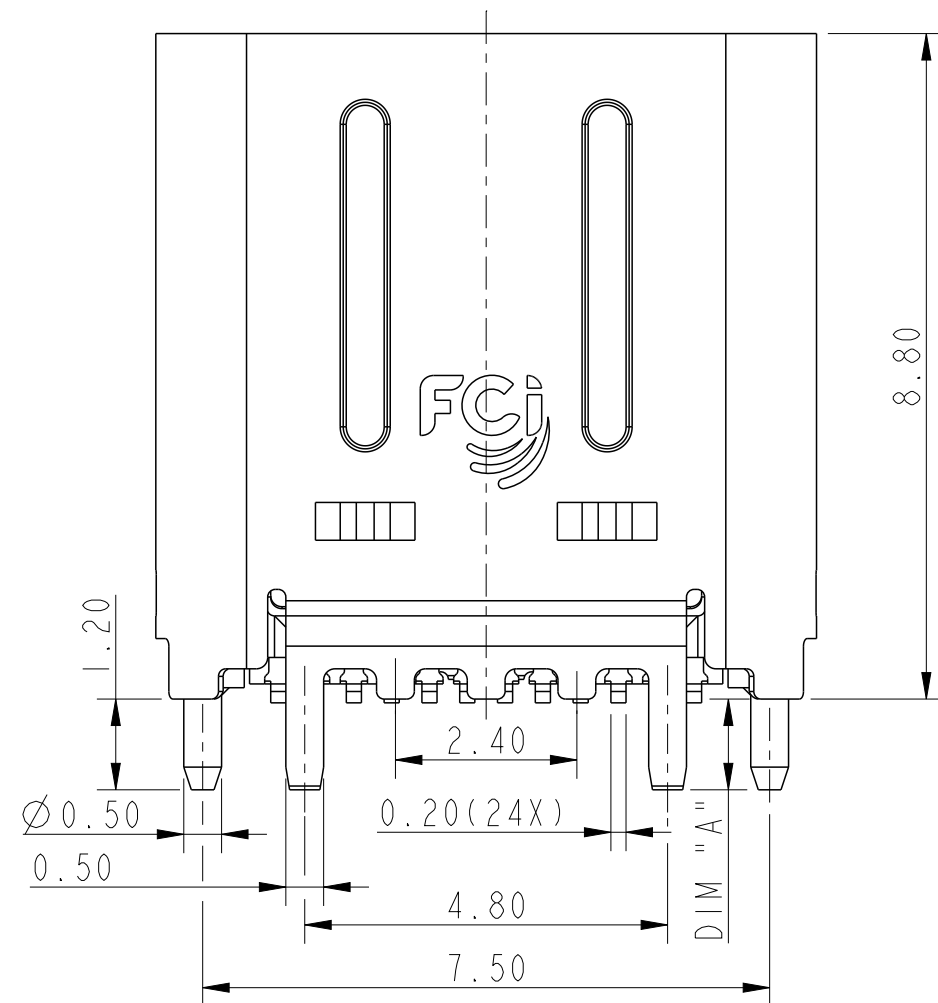
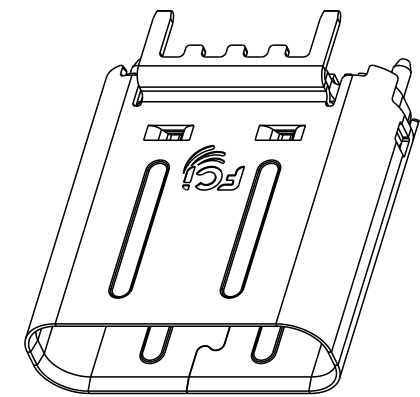
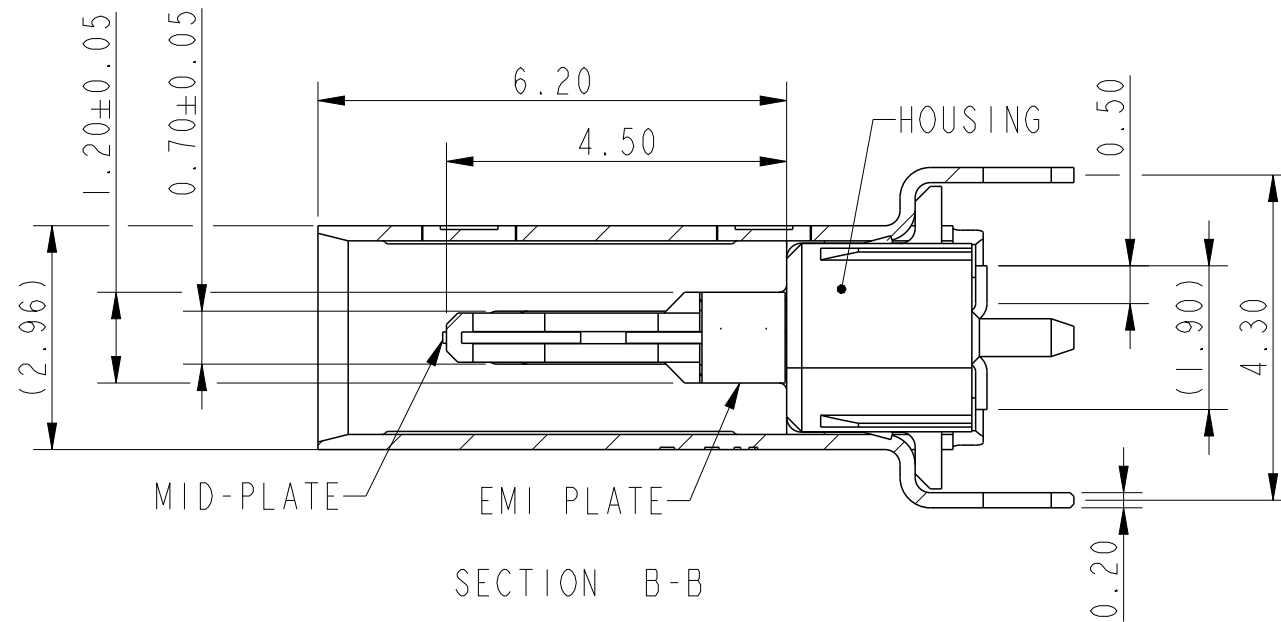
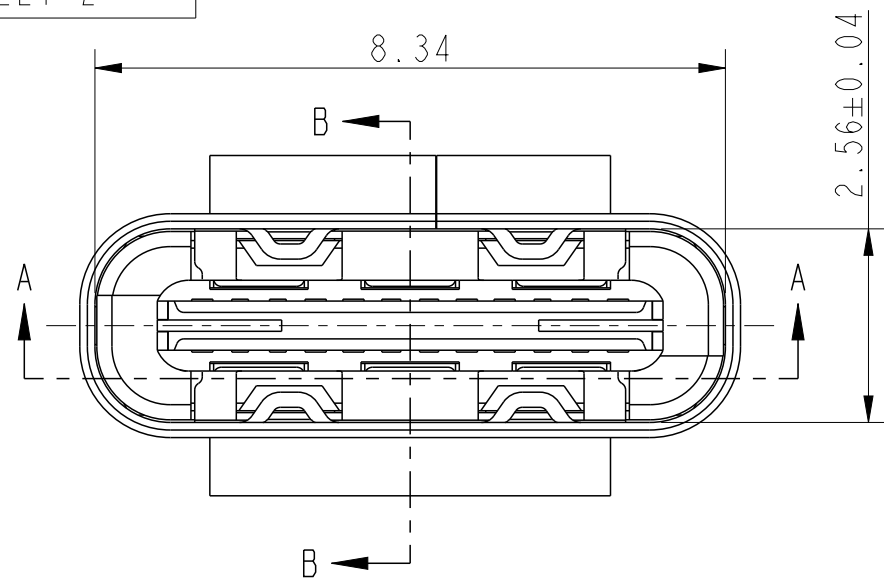

spec ref -				dr Li-Qing Lei		2014/11/20		<div>projection</div> <div></div>	<div>mm</div> <div></div>	size A3		scale 10:1					
tolerance std				eng Li-Qing Lei		2020/07/24				ecn no ELX-N-37761-1							
ISO 406				chr -		-				rel level Released							
ISO 1101				appr Tim Yao		2020/07/29				product family -							
surface <div>ISO 1302</div>	linear	0.X ±0.25		Amphenol FCI				title USB3.1 Type-C Vertical, Receptacle				dwg no 10132328				rev B	
		0.XX ±0.15															
		0.XXX ±0.10															
	angular	0° ±2°		cat. no. -				Product - Customer Drw				sheet 1 of 3					

NOTE:

1. MATERIAL:

- 1.1 HSG: THERMOPLASTIC, BLACK, UL94-V0
- 1.2 TERMINAL: COPPER ALLOY
- 1.3 EMI PLATE: STAINLESS STEEL
- 1.4 MID PLATE: STAINLESS STEEL
- 1.5 SHIELD: STAINLESS STEEL

2. PLATING:

- 2.1 TERMINAL: (Min) 0.05  $\mu$ m Au + (Min) 0.75  $\mu$ m Ni-Pd ON CONTACT AREA
- 2.2 SHELL: PLATING 0.74 $\mu$ m MIN Ni OVER AREA.
- 2.3 EMI: PLATING 0.74 $\mu$ m MIN Ni OVER AREA.
- 2.4 CENTER PLATE: PLATING 0.74 MIN Ni OVER AREA.

3. MECHANICAL CHARACTER:

- 3.1 INSERTION FORCE: 5~20N;
- 3.2 EXTRACTION FORCE: 8~20N INITIAL, 6~20N AFTER DURABILITY;
- 3.3 DURABILITY: 10,000 CYCLES;
- 3.4 OPERATION TEMPERATURE: -55°C TO +85°C

4. ELECTRICAL CHARACTER:

- 4.1 LLCR: 40m $\Omega$  INITIAL, 50m $\Omega$  MAX AFTER ENVIRONMENT TEST;
- 4.2 INSULATION RESISTANCE: 100M $\Omega$  MIN AT 250V DC.
- 4.3 DIELECTRIC WITHSTAND VOLTAGE: 100VAC MIN.

5. THE HOUSING WILL WITHSTAND EXPOSURE TO 260°C PEAK TEMPERATURE FOR 20 SECONDS IN A CONVECTION, INFRA-RED OR VAPOR PHASE REFLOW;

6. LEAD FREE PRODUCT MEETS EUROPEAN UNION DIRECTIVES AND OTHER COUNTRY REGULATIONS AS DISCRIBLED IN GS-22-008

7. PRODUCT SPEC: GS-12-1351 FOR GENERAL CUSTOMER

GS-12-1299 FOR DEDICATED CUSTOMER

8. SOLDER TAILL TO BE COPLANAR WITHIN 0.10 TO EACH OTHER  
PRODUCT NUMBER CODE:

10132328-100XXLF

THE LENGTH OF SHELL'S LEG OPTION

1. DIM"A"=1.2 WITH 6 SMT TAILS IN THE MIDDLE
2. DIM"A"=1.6 WITH 6 SMT TAILS IN THE MIDDLE
3. DIM"A"=1.2 WITHOUT 6 SMT TAILS IN THE MIDDLE
4. DIM"A"=1.6 WITHOUT 6 SMT TAILS IN THE MIDDLE

GROUND PIN STATUS (A1/A12/B1/B12)

0. SEPARATED
1. CONNECTED

AVAILABLE P/N:	
10132328-10001LF	
10132328-10011LF	
10132328-10013LF	

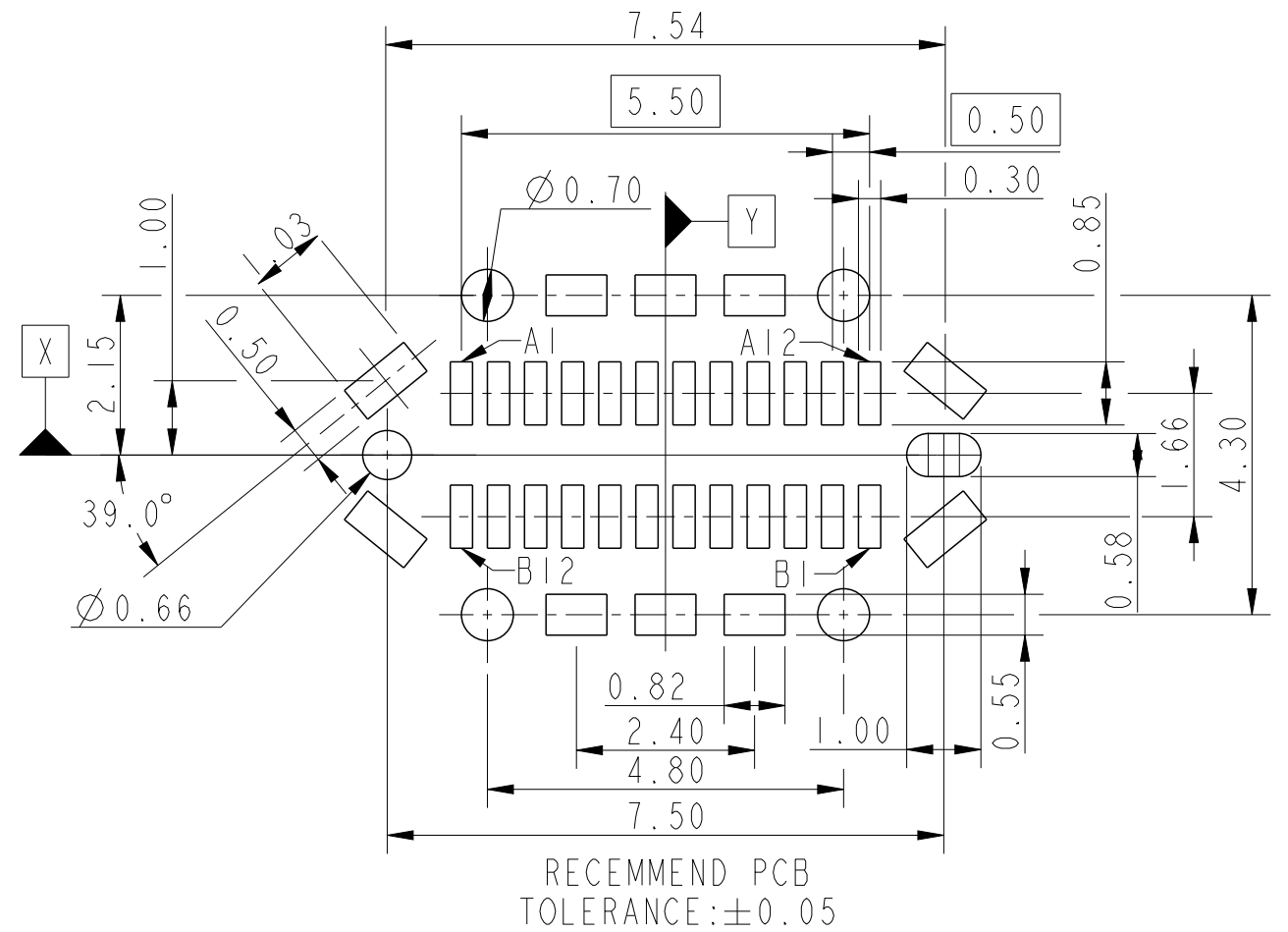

6 SMT TAILS

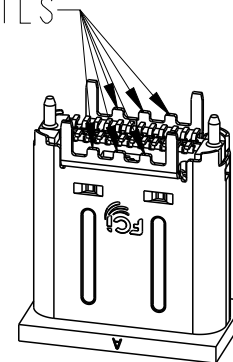

PIN ASSIGNMENTS

PIN	SIGNAL NAME	PIN	SIGNAL NAME
A1	GND	B12	GND
A2	SSTXp1	B11	SSRXp1
A3	SSTXn1	B10	SSRXn1
A4	VBUS	B9	VBUS
A5	CC1	B8	SBU2
A6	Dp1	B7	Dn2
A7	Dn1	B6	Dp2
A8	SBU1	B5	CC2
A9	VBUS	B4	VBUS
A10	SSRXn2	B3	SSTXn2
A11	SSRXp2	B2	SSTXp2
A12	GND	B1	GND

NOTE: TX AND RX ARE DEFINED FORM THE HOST PERSPECTIVE

spec ref -				dr Li-Qing Lei		2014/11/20		projection		mm		size A3		scale 10:1			
tolerance std				eng Li-Qing Lei		2020/07/24						ecn no		ELX-N-37761-1			
ISO 406 ISO 1101				chr -		-						rel level		Released			
TOLERANCES UNLESS OTHERWISE SPECIFIED				appr Tim Yao		2020/07/29		product family									
surface 		linear		0.X ±0.25 0.XX ±0.15 0.XXX ±0.10		Amphenol FCI		title USB3.1 Type-C Vertical, Receptacle				dwg no 10132328		rev B			
ISO 1302		angular		0° ±2°				cat. no.				Product - Customer Drw				sheet 2 of 3	

TAPE REEL PACKAGE  
Q'TY: (350)EA/REEL

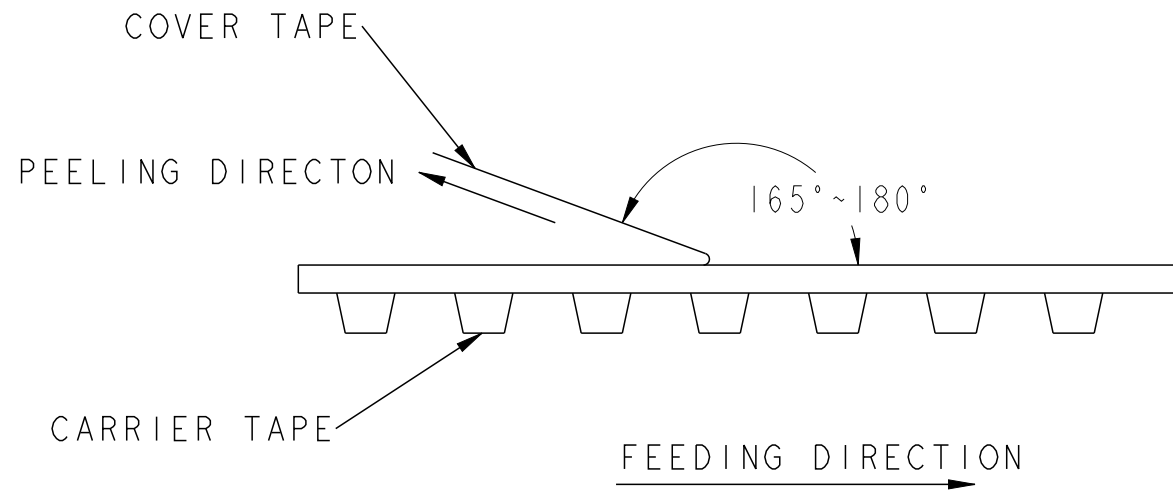
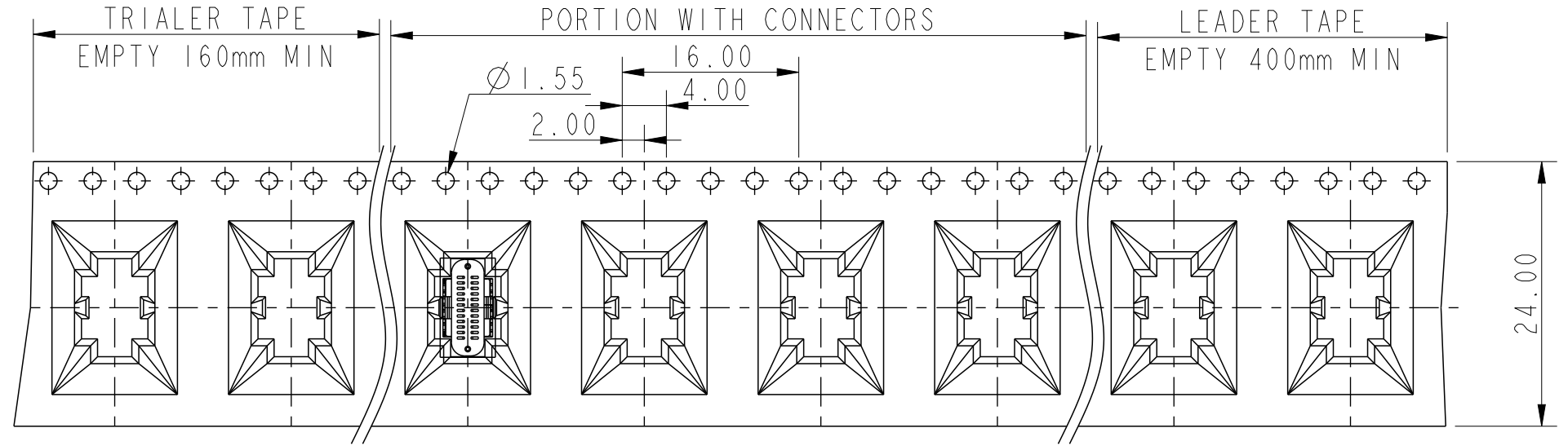
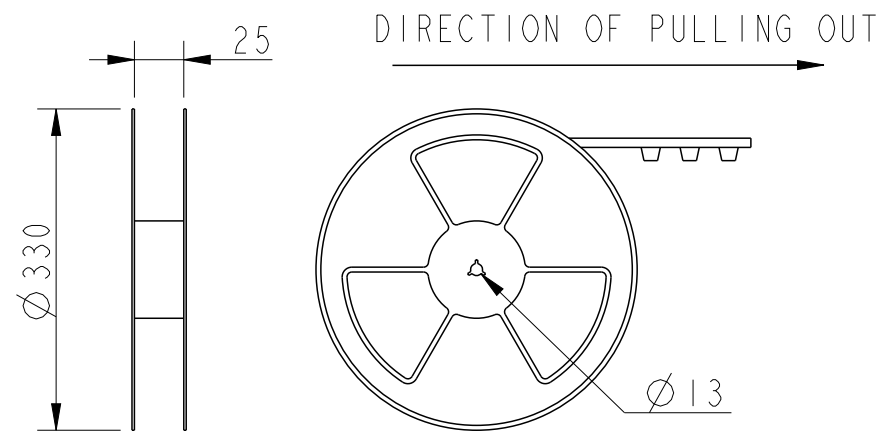

SHOWS THE METHOD OF COVER TAPE'S PEELING FORCE MEASUREMENT.  
PEELING FORCE MUST BE 0.1 TO 1.3N AT THE SPEED OF 300MM/MIN.

spec ref	-	dr	Li-Qing Lei	2014/11/20	projection	mm	size	A3	scale	1:1
tolerance std	ISO 406 ISO 1101	eng	Li-Qing Lei	2020/07/24	chr	-	ecn no	ELX-N-37761-1	rel level	Released
surface	ISO 1302	appr	Tim Yao	2020/07/29	product family	USB3.1 Type-C Vertical, Receptacle	dwg no	10132328	rev	B
					cat. no.	Product - Customer Drw	sheet 3 of 3			