

REV.	ECN NO.	DESCRIPTION	DATE	DESIGN

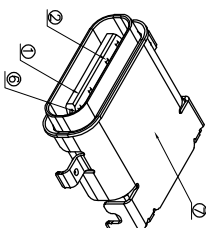

Pin	Signal	Mating	Pin	Signal	Mating
A1	Shell	Shell	B11	SS8Kv1	Second
A2	SS15Kv1	Second	B10	SS8Kv1	Second
A3	SS15Kv1	Second	B9	Via	First
A4	Via	First	B8	SBU2	Second
A5	CC1	Second	B7	Db2	Second
A6	Db1	Second	B6	Db2	Second
A7	Db1	Second	B5	CC2	Second
A8	Shell	Second	B4	Via	First
A9	Via	First	B3	SS15Kv2	Second
A10	SS8Kv2	Second	B2	SS15Kv2	Second
A11	SS8Kv2	Second	B1	CC1	First
A12	QND	First	B1	QND	First

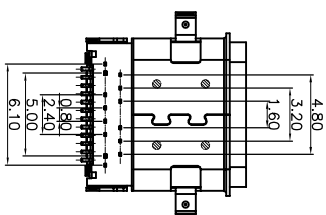
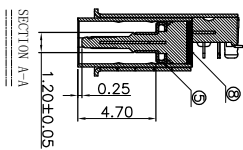
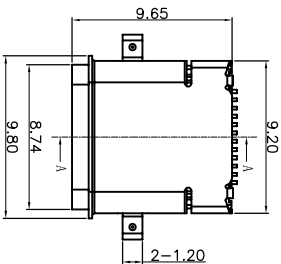

- NOTES:
1. MATERIAL: SEE "TABLE 1";
  2. FINISH: SEE "TABLE 1";

3. ELECTRICAL :
- 3-1.CONTACT CURRENT RATING :  
5A(BUS PIN 15A/PIN),  
5A(GND PIN 1.25A/PIN MAX),0.25A/PIN(OTHER PIN).

- 3-2.INSULATION RESISTANCE :  
100 MEGAOHMS MIN. AT 250VDC.
- 3-3.DIELECTRIC WITHSTANDING VOLTAGE :  
100VAC MIN.

- 3-4.LOW LEVEL CONTACT RESISTANCE :  
INITIAL 40mΩ MAX.  
AFTER 50mΩ MAX.

- 4.MECHANICAL CHARACTERISTICS :

- 4-1. MATING FORCE: 5~20N;
- 4-2. UNMATING FORCE: 6~20N(INITIAL)6~20N(AFTER 10000 CYCLES);
- 4-3.DURABILITY : 10,000 MATING CYCLES.
- 4-4.OPERATING TEMPERATURE : -40°C TO +80°C

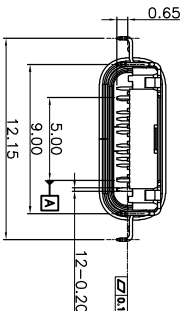
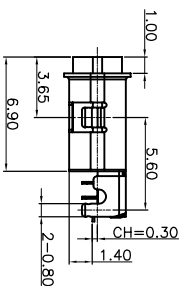
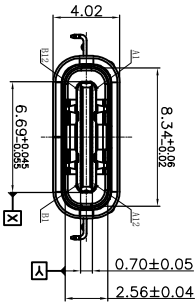
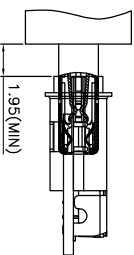
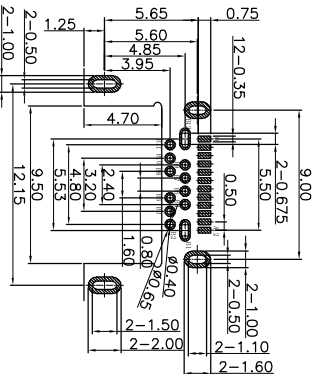
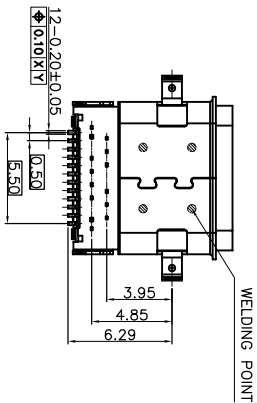

TABLE 1:

③	GLUE WATER	1	Epoxy	BLACK;
⑦	Shell-2	1	Stainless steel	PPAR, NI PLATING; T=0.20mm
⑧	Shell-1	1	Stainless steel	PPAR, NI PLATING; T=0.20mm
⑤	GND PLATE	1	Stainless steel	NI PLATING; T=0.10mm
④	MID PLATE	1	Stainless steel	T=0.15mm
③	Terminal-B	12	C7025	CONTACT AREA:AU15u" T=0.12mm
②	Terminal-A	12	C7025	CONTACT AREA:AU15u" T=0.12mm
①	Housing	1	HIGH TEMP NYLON	Block T=0.12mm



TOLERANCE		NAME(INTENDED USE)	
X.X	±0.30	X.X	±10°
.XX	±0.20	.X	± 8°
.XXX	±0.10	.XX	± 5°
UNITS	mm	DESIGN:	ZXM
MATERILA	----	CHED:	----
FINISH	-----	APPD:	----

DRAWG NO.		SCALE		SHEET		REV.	
FY23-25CF241F410-01		1:1		1/2		A	

FY20U 广东富盈兴业精密科技实业有限公司  
Guangdong FY20U Precision Electronic Technology Co.,LTD.

TITLE: CF 24P防水沉板L.4直边

FY23-25CF241F410-01

CUSTOMER

REV.	ECN NO.	DESCRIPTION	DATE	DESIGN

密封方式

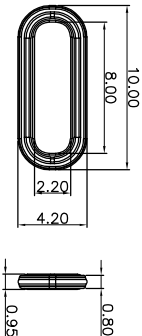
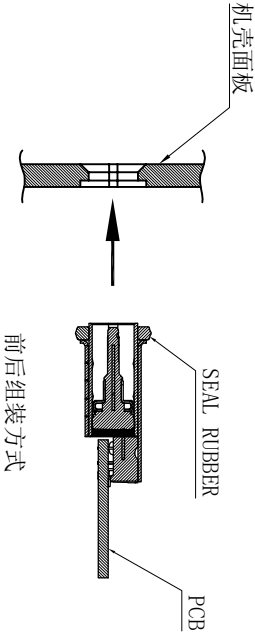

Space(Panl with Seal Rubber)0.30Min  
(The amount of compression is recommende  
as 40%~50% of seal rubber O.D.)

Seal Rubber For Reference

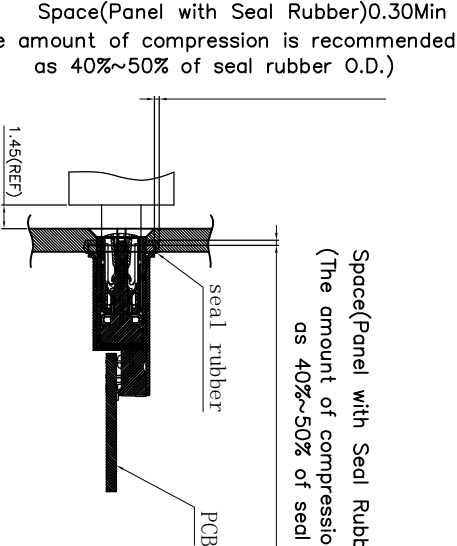

TOLERANCE		NAME(INTENDED USE) CUSTOMER DRAWING		TITLE: FY23-25CF241F410-01	
X.X	±0.30	X.*	±10°	PART NO.	CF 24P防水沉板1.4直边
XX	±0.20	X.*	± 8°	DESIGN:	ZXM
.XXX	±0.10	.XX*	± 5°	CHEG:	
UNITS	mm			APPD:	
MATERILA	----				
FINISH	-----				

FY23-25CF241F410-01

CF 24P防水沉板1.4直边

DRAWG NO. FY23-25CF241F410-01

SCALE SHEET REV.

1:1 1/2 A