



bestirpower

BMD65N340E2

Super Junction Power MOSFET

650 V, 12 A, 340 mΩ

Description

BMD65N340E2 is power MOSFET using bestirpower's advanced super junction technology that can realize very low on-resistance and gate charge.

It will provide much high efficiency by using optimized charge coupling technology. These user friendly devices give an advantage of Low EMI to designers as well as low switching loss.

$BV_{DSS} @ T_{J,max}$	I_D	$R_{DS(on),max}$	$Q_{g,typ}$
700 V	12 A	340 mΩ	19 nC

Applications

- Switch Mode Power Supply (SMPS)
- Uninterruptible Power Supply (UPS)
- Power Factor Correction (PFC)
- Charger

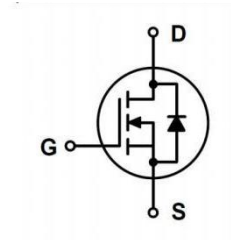
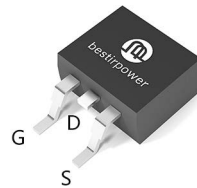

Features

- Reduced Switching & Conduction Losses
- Lower Switching Noise
- 100% Avalanche Tested
- Halogen Free, and RoHS Compliant



Absolute Maximum Ratings ($T_J = 25^\circ\text{C}$ unless otherwise noted)

Symbol	Parameter		Value	Unit	Note
V_{DSS}	Drain to Source Voltage		650	V	
V_{GSS}	Gate to Source Voltage		± 30	V	
I_D	Drain Current (continuous)	$V_{GS}=10\text{V}, T_C = 25^\circ\text{C}$	12	A	Fig 10
		$V_{GS}=10\text{V}, T_C = 100^\circ\text{C}$	7.6		
I_{DM}	Drain Current	Pulsed (Note1)	36	A	
E_{AS}	Single Pulsed Avalanche Energy (Note2)		245	mJ	
I_{AS}	Avalanche Current (Note2)		7	A	
dv/dt	MOSFET dv/dt		50	V/ns	
	Peak Diode Recovery dv/dt (Note3)		15		
P_D	Power Dissipation	$(T_C = 25^\circ\text{C})$	114	W	Fig 11
		Derate Above 25°C	0.9	W/°C	
T_J, T_{STG}	Operating and Storage Temperature Range		-55 to 150	°C	

Thermal Characteristics

Symbol	Parameter	Value	Unit
$R_{\theta JC}$	Thermal Resistance, Junction to Case, Max.	1.1	°C/W
$R_{\theta JA}$	Thermal Resistance, Junction to Ambient, Max.	62	
T_{solder}	Soldering temperature, wave soldering only allowed at leads	260	°C

Electrical Characteristics (T_J = 25°C unless otherwise noted)

Symbol	Parameter	Test Conditions	Min	Typ	Max	Unit	Note
--------	-----------	-----------------	-----	-----	-----	------	------

Off Characteristics

BV _{DSS}	Drain to Source Breakdown Voltage	V _{GS} = 0 V, I _D = 250 μA	650	-	-	V	Fig 7
I _{DSS}	Zero Gate Voltage Drain Current	V _{DS} = 650 V, V _{GS} = 0 V	-	-	1	μA	
I _{GSS}	Gate-Source Leakage Current	V _{GS} = ±30 V, V _{DS} = 0 V	-	-	±100	nA	

On Characteristics

V _{GS(th)}	Gate Threshold Voltage	V _{GS} = V _{DS} , I _D = 250 μA	2.0	3.0	4.0	V	Fig 9
R _{DS(on)}	Static Drain to Source On Resistance	V _{GS} = 10 V, I _D = 4.8 A, T _J = 25°C	-	315	340	mΩ	Fig 3
		V _{GS} = 10 V, I _D = 4.8 A, T _J = 150°C	-	790	850	mΩ	Fig 8

Dynamic Characteristics

C _{iss}	Input Capacitance	V _{DS} = 400 V, V _{GS} = 0 V, f = 1 MHz	-	801	-	pF	Fig 5
C _{oss}	Output Capacitance		-	28	-	pF	
C _{rss}	Reverse transfer capacitance		-	3.8	-	pF	
Q _{g(tot)}	Total Gate Charge at 10 V	V _{DS} = 400 V, I _D = 5.5 A, V _{GS} = 10 V	-	19	-	nC	Fig 6
Q _{gs}	Gate to Source Charge		-	2.9	-	nC	
Q _{gd}	Gate to Drain "Miller" Charge		-	9.7	-	nC	
R _G	Gate Resistance	f = 1 MHz, Open Drain	-	5.6	-	Ω	

Switching Characteristics

t _{d(on)}	Turn-On Delay Time	V _{DS} = 400 V, I _D = 5.5 A, V _{GS} = 10 V, R _G = 10 Ω	-	16	-	ns	
t _r	Turn-On Rise Time		-	6	-	ns	
t _{d(off)}	Turn-Off Delay Time		-	29	-	ns	
t _f	Turn-Off Fall Time		-	22	-	ns	

Source-Drain Diode Characteristics

I _S	Maximum Continuous Diode Forward Current		-	-	12	A	
I _{SM}	Maximum Pulsed Diode Forward Current		-	-	36	A	
V _{SD}	Diode Forward Voltage	V _{GS} = 0 V, I _{SD} = 11 A	-	0.9	1.2	V	Fig 4
t _{rr}	Reverse Recovery Time	V _{DD} = 400 V, I _{SD} = 5.5A, di _F /dt = 100 A/μs	-	198	-	ns	
Q _{rr}	Reverse Recovery Charge		-	1.93	-	μC	

※Notes:

1. Repetitive rating: pulse-width limited by maximum junction temperature.
2. L=10mH, R_G = 25 Ω, starting T_J = 25°C.
3. I_{SD} ≤ 4 A, di_F/dt ≤ 100 A/μs, V_{DD} ≤ 400 V, starting T_J = 25°C.

Typical Performance Characteristics

Figure 1. On-Region Characteristics

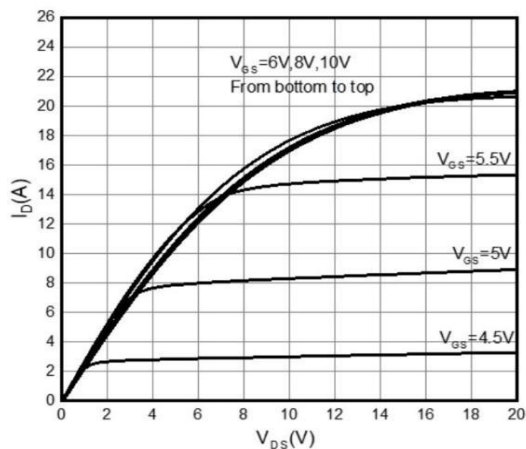

Figure 2. Transfer Characteristics

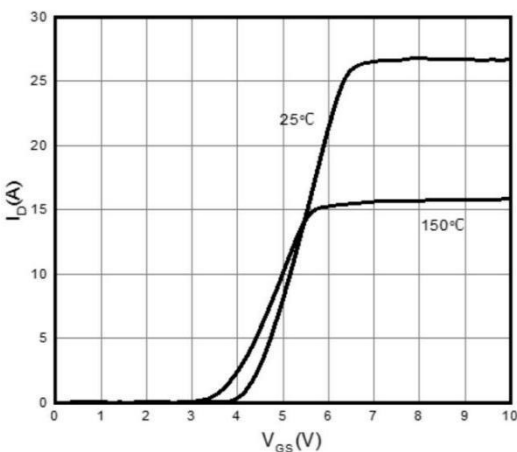

Figure 3. On-Resistance vs. Drain Current

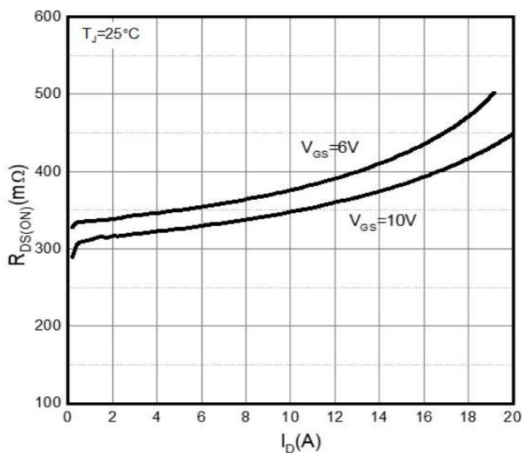

Figure 4. Body-Diode Characteristics

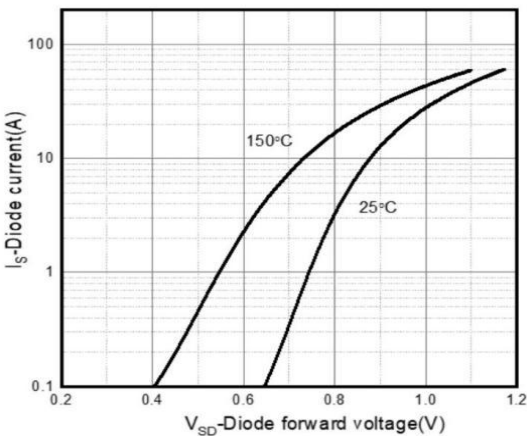

Figure 5. Capacitance Characteristics

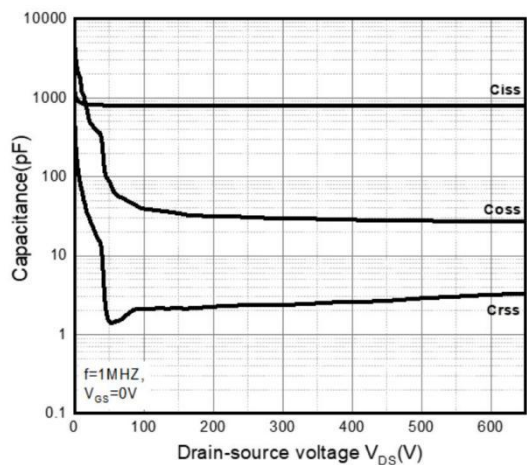
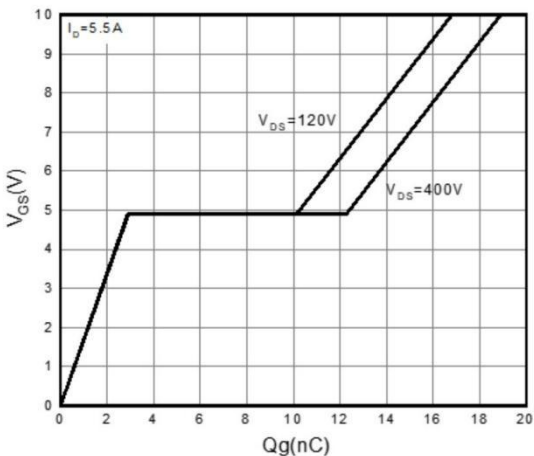

Figure 6. Gate Charge Characteristics



Typical Performance Characteristics

Figure 7. Breakdown Voltage vs. Temperature

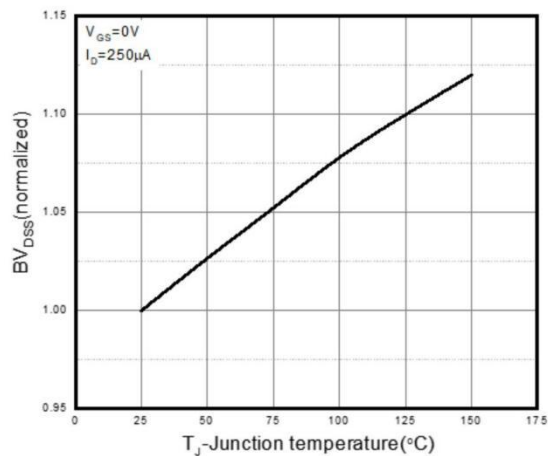

Figure 8. On-Resistance vs. Temperature

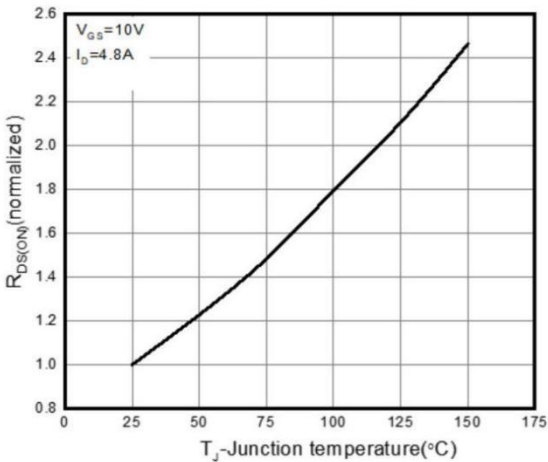

Figure 9. Threshold Voltage vs. Temperature

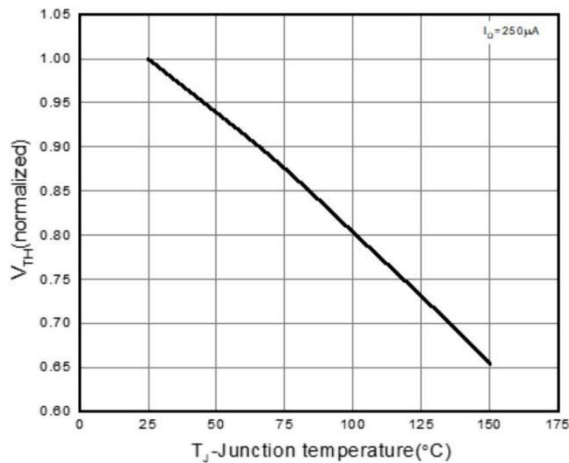

Figure 10. Drain Current vs. Temperature

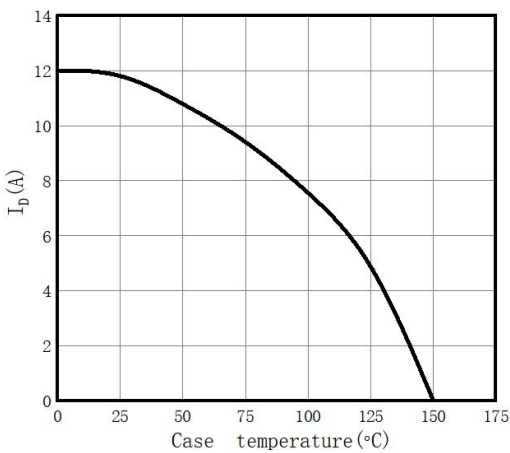

Figure 11. Power Dissipation vs. Temperature

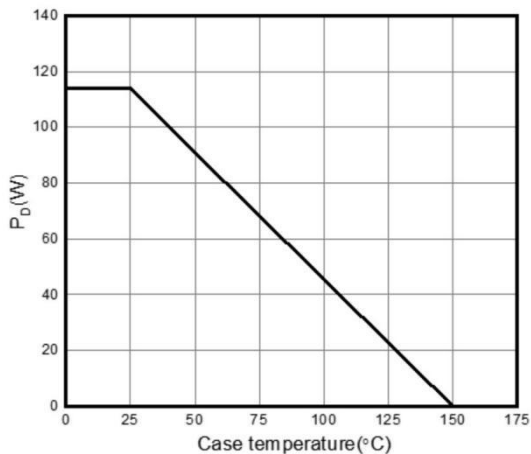

Figure 12. Maximum Safe Operating Area

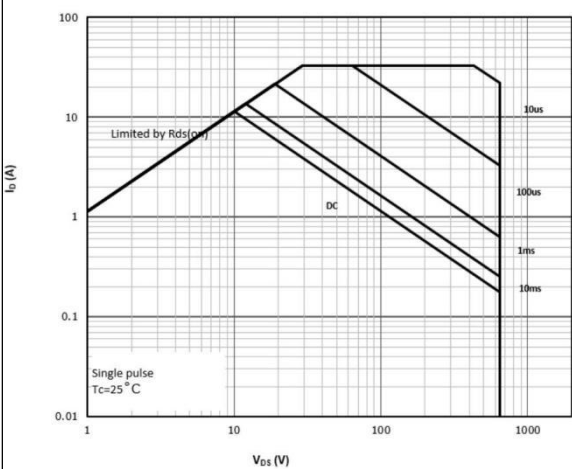
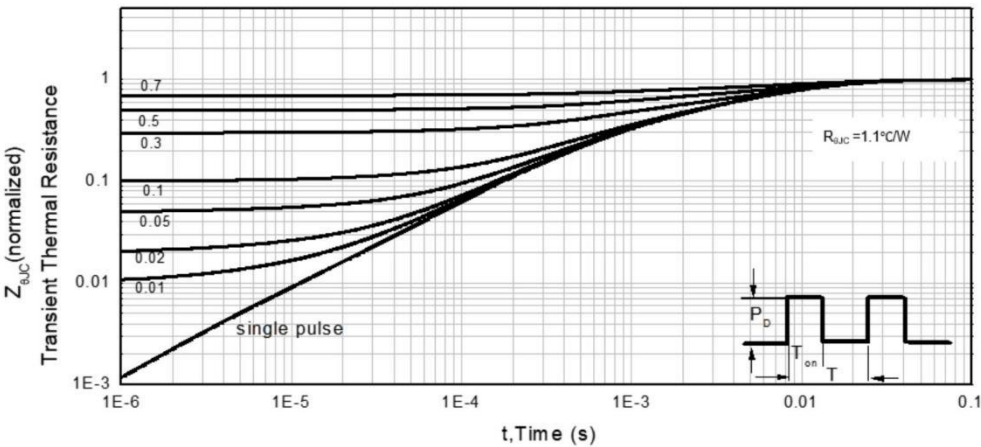

Figure 13. Normalized Maximum Transient Thermal Impedance



Test Circuits

Figure 14. Switching times test circuit for inductive load and Switching times waveform

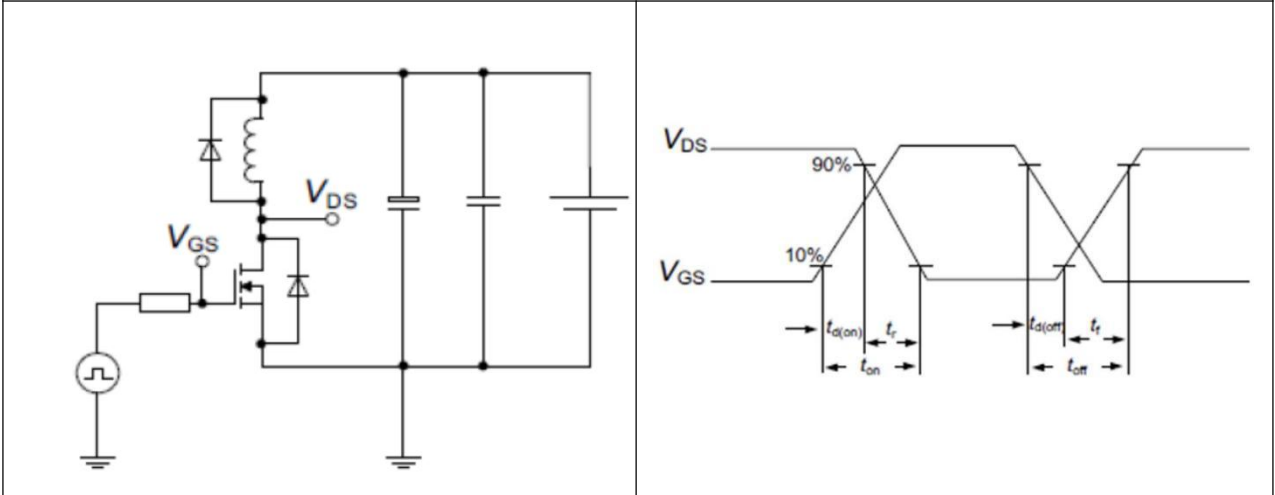

Figure 15. Test circuit for diode characteristics and Diode recovery waveform

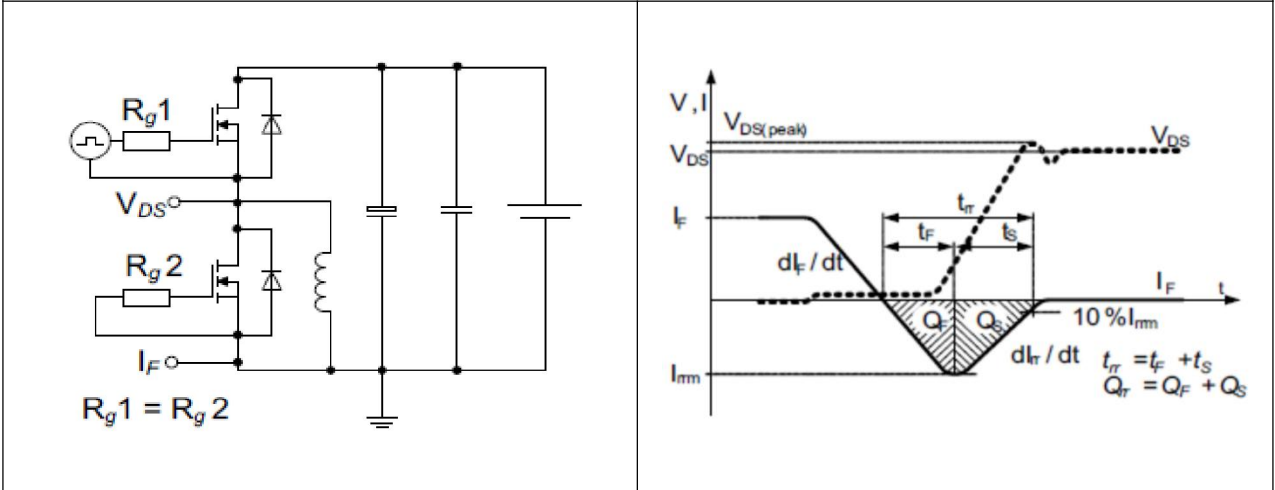
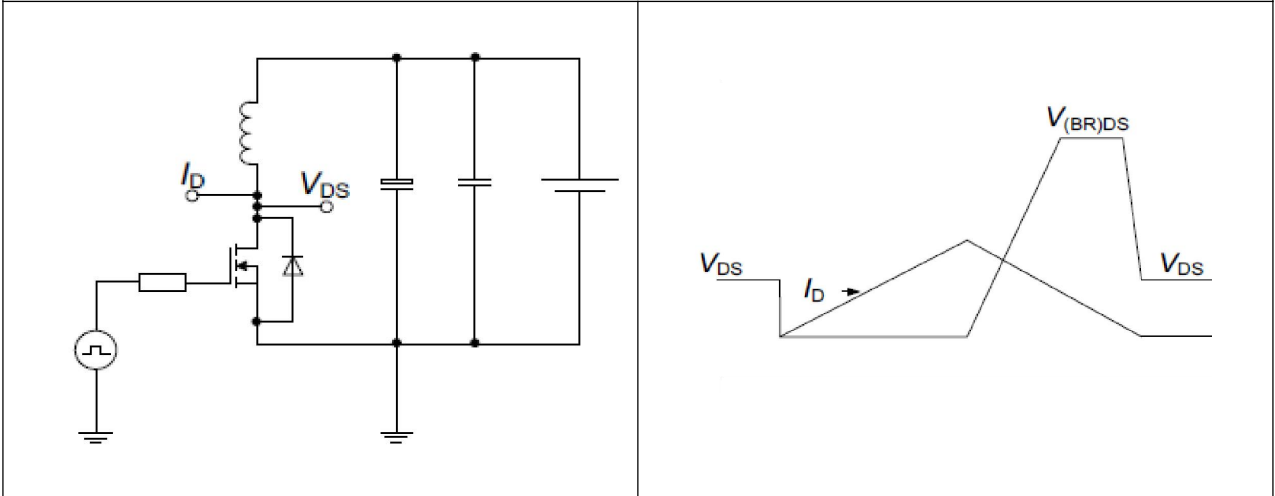
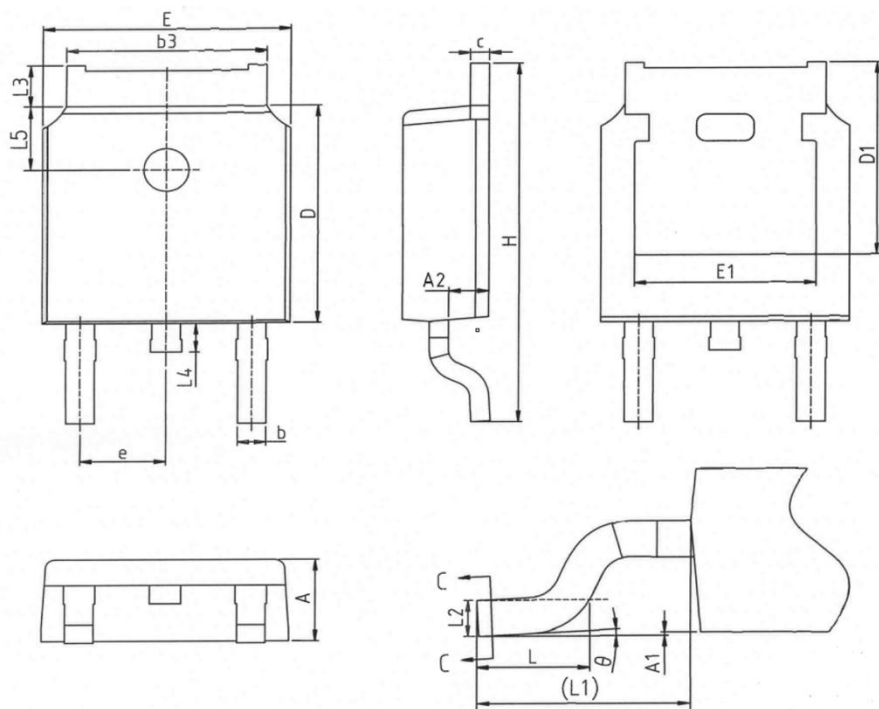

Figure 16. Unclamped inductive load test circuit and Unclamped inductive waveform



Package Outlines

DPAK



COMMON DIMENSIONS

SYMBOL	mm		
	MIN	NOM	MAX
A	2.20	2.30	2.38
A1	0.00	—	0.12
A2	0.97	1.07	1.17
b	0.68	0.78	0.90
b3	5.20	5.33	5.46
c	0.43	0.53	0.61
D	5.98	6.10	6.22
D1	5.30REF		
E	6.40	6.60	6.73
E1	4.63	—	—
e	2.286BSC		
H	9.40	10.10	10.50
L	1.38	1.50	1.75
L1	2.90REF		
L2	0.51BSC		
L3	0.88	—	1.28
L4	0.50	—	1.00
L5	1.65	1.80	1.95
θ	0°	—	8°

* Dimensions in millimeters

Package Marking and Ordering Information

Part Number	Top Marking	Package	Packing Method	Quantity
BMD65N340E2	BMD65N340E2	DPAK	Tape & Reel	2500 units

Disclaimer

Bestirpower reserve the right to make changes, corrections, enhancements, modifications, and improvements to Bestirpower products and/or to this document at any time without notice.

The information given in this document shall in no event be regarded as a guarantee of conditions or characteristics. Bestirpower does not assume any liability for infringement of patents, copyrights, or other intellectual property rights of third parties by or arising from the use of Products or technical information described in this document.

This document is the property of Bestirpower Co., LTD., and not allowed to copy or transformed to other format if not under the authority approval.

© 2025 bestirpower – All rights reserved