

TDSEMIC

拓電半導體

自主封測 品質把控 售後保障

WEB | WWW.TDSEMIC.COM



電源管理



顯示驅動



二三極管



LDO穩壓器



觸摸芯片



MOS管



運算放大器



存儲芯片



MCU



串口通信

BC846C-TD

產品規格說明書

◆ Features

Ideally suited for automatic insertion.
For switching and AF amplifier applications.

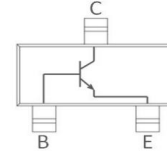

◆ Absolute Maximum Ratings(Ta=25℃)

Symbol	Parameter	Part	Value	Unit
V _{CBO}	Collector-Base Voltage	BC846 BC847 BC848	80 50 30	V
V _{CEO}	Collector-Emitter Voltage	BC846 BC847 BC848	65 45 30	V
V _{EBO}	Emitter-Base Voltage		6	V
I _C	Collector Current		100	mA
P _C	Collector Power Dissipation		200	mW
R _{ΘJA}	Thermal Resistance From Junction To Ambient		625	℃/W
T _J , T _{stg}	Operation Junction And Storage Temperature Range		-55~+150	℃

◆ Electrical Characteristics (Ta=25℃ unless otherwise specified)

Symbol	Parameter		Test conditions	Min	Max	Unit
V _{(BR)CBO}	Collector-base breakdown voltage	BC846 BC847 BC848	I _C =10μA, I _E =0	80 50 30		V
V _{(BR)CEO}	Collector-emitter breakdown voltage	BC846 BC847 BC848	I _C =10mA, I _B =0	65 45 30		V
V _{(BR)EBO}	Emitter-base breakdown voltage		I _E =10μA, I _C =0	6		V
I _{CBO}	Collector cut-off current	BC846 BC847 BC848	V _{CB} =70V, I _E =0 V _{CB} =50V, I _E =0 V _{CB} =30V, I _E =0		100	nA
I _{EBO}	Emitter cut-off current		V _{EB} =5V, I _C =0		100	nA
h _{FE}	DC current gain	BC846A BC847A BC848A BC846B BC847B BC848B BC846C BC847C BC848C	V _{CE} =5V, I _C =2mA	110 200 420	220 450 800	
V _{CE(sat)}	Collector-emitter saturation voltage		I _C =100mA, I _B =5mA		0.5	V
V _{BE(sat)}	Base-emitter saturation voltage				1.1	V
f _T	Transition frequency		V _{CE} =5V, I _C =10mA, f=30MHz	100		MHz
C _{ob}	Collector output capacitance		V _{CB} =10V, f=1MHz		4.5	pF

◆ Marking

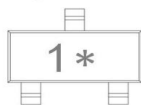

BC846A=1A; BC846B=1B; BC846C=1C;
BC847A=1E; BC847B=1F; BC847C=1G;
BC848A=1J; BC848B=1K; BC848C=1L;

◆ Typical Characteristics

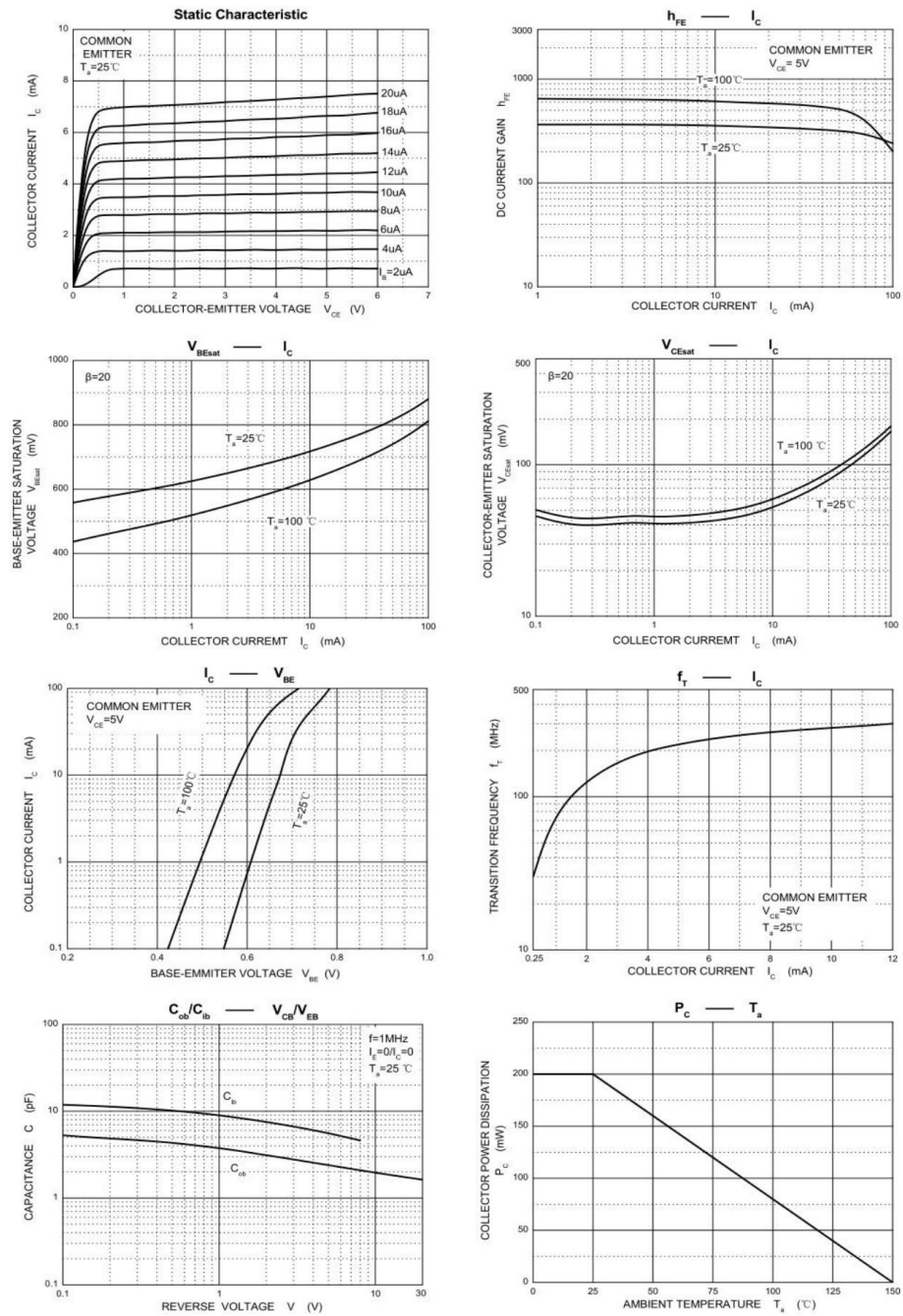

◆ SOT-23 Package Outline Dimensions

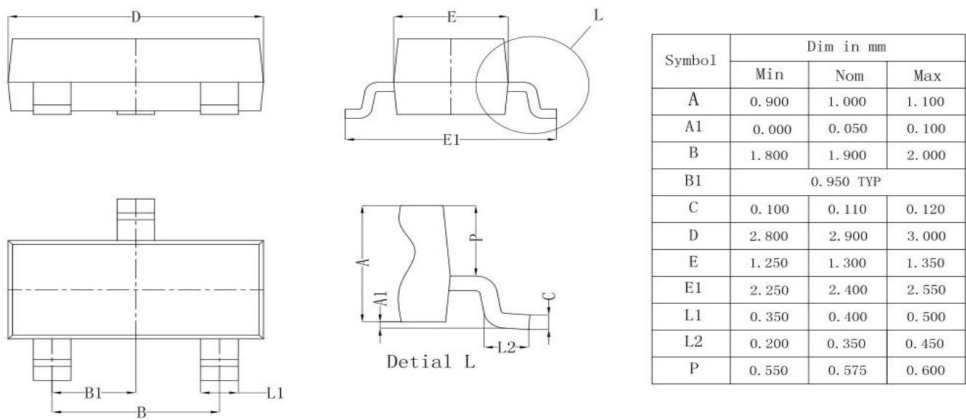

◆ Packaging SPEC.

Units				
Units/Reel	Reels/Inner Box	Units/Inner Box	Inner Boxes/Outer Box	Units/Outer Box
3,000	15	45,000	4	180,000
Reel	Dimension (unit: mm ³)			
	Inner Box		Outer Box	
7" × 8	190×190×190		400×400×210	