

1. Description

The LESD8LH5.0CT5G is designed to protect voltage sensitive components that require ultra-low capacitance from ESD and transient voltage events. Excellent clamping capability, low capacitance, low leakage, and fast response time, make these parts ideal for ESD protection on designs where board space is at a premium. Because of its low capacitance, it is suited for use in high frequency designs such as USB 2.0 high speed and antenna line applications.

3. Features

- Ultra Low Capacitance 3 pF
- Low Clamping Voltage
- Small Body Outline Dimensions:
0.039" x 0.024" (1.00 mm x 0.60mm)
- Low Body Height: 0.020" (0.5 mm)

2. Mechanical Characteristics

- CASE: Void-free, transfer-molded, thermosetting
- plastic Epoxy Meets UL 94 V-0
- LEAD FINISH: 100% Matte Sn (Tin)
- Qualified Max Reflow Temperature: 260°C
- Device Meets MSL 1 Requirements

- Stand-off Voltage: 5 V
- Low Leakage
- Response Time is Typically < 1.0 ns
- IEC61000-4-2 Level 4 ESD Protection
- This is a Pb-Free Device

4. Pinning information

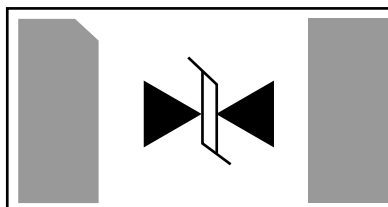

SOD-882



5. Absolute Ratings ($T_{amb}=25^{\circ}\text{C}$)

Parameter	Symbol	Value	Units
IEC 61000-4-2 (ESD) Contact Air		± 10	kV
		± 15	kV
Total Power Dissipation on FR-5 Board (Note 1) @ $T_A=25^{\circ}\text{C}$	P_D	150	mW
Storage Temperature Range	T_{STG}	-55 to 150	$^{\circ}\text{C}$
Junction Temperature Range	T_J	-55 to 125	$^{\circ}\text{C}$
Lead Solder Temperature – Maximum (10 Second Duration)	T_L	260	$^{\circ}\text{C}$

Notes:

Stresses exceeding Maximum Ratings may damage the device. Maximum Ratings are stress ratings only. Functional operation above the Recommended Operating Conditions is not implied. Extended exposure to stresses above the Recommended Operating Conditions may affect device reliability.

1. FR-5 = 1.0 x 0.75 x 0.62 in.



6. Electrical Characteristic ($T_A=25^\circ\text{C}$ unless otherwise noted)

Device	V_{RWM} (V)	$I_R(\mu\text{A})$ @ V_{RWM}	$V_{BR}(\text{V})$ @ $I_T=1\text{mA}$ (Note 2)	$C(\text{pF})$		$V_C(\text{V})$ @ $I_{PP}=3.5\text{A}$ (Note 3)	$I_{PP}(\text{A})$ $t_p=8/20\mu\text{s}$	$P_{PP}(\text{W})$	V_C
	Max	Max	Min	Typ	Max	Max	Max	Max	Per IEC61000-4-2 (Note4)
LESD8LH5.0CT5G	5	1	5.5	2.7	3.5	11.5	3.5	40	Figures 1 and 2 See Below

Notes:

- V_{BR} is measured with a pulse test current I_T at an ambient temperature of 25°C .
- Surge current waveform per Figure 4.
- For test procedure see Figures 3.

7. Electrical Parameter

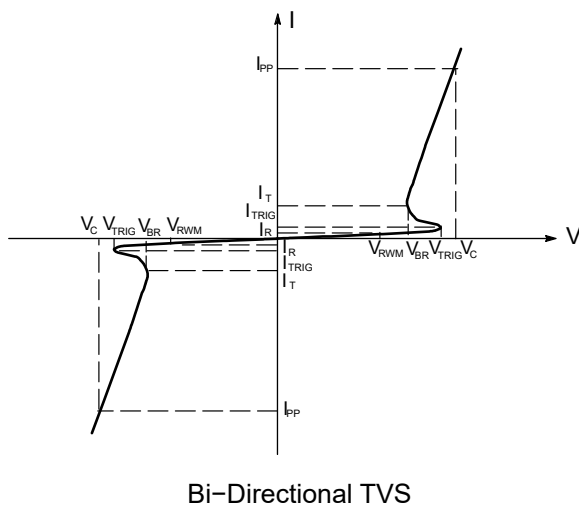

Symbol	Parameter
I_{PP}	Maximum Reverse Peak Pulse Current
V_C	Clamping Voltage @ I_{PP}
V_{RWM}	Reverse stand-off voltage
I_R	Maximum Reverse Leakage Current @ V_{RWM}
V_{BR}	Breakdown Voltage @ I_T
I_T	Test Current
V_{TRIG}	Reverse trigger voltage
I_{TRIG}	Reverse trigger current



8. Typical characteristic

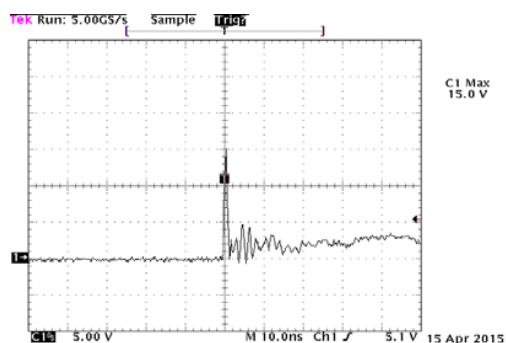

Figure 1: ESD Clamping Voltage Screenshot
Positive 8 kV Contact per IEC61000-4-2

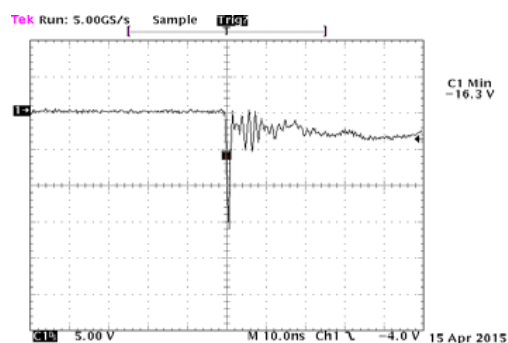

Figure 2: ESD Clamping Voltage Screenshot
Negative 8 kV Contact per IEC61000-4-2

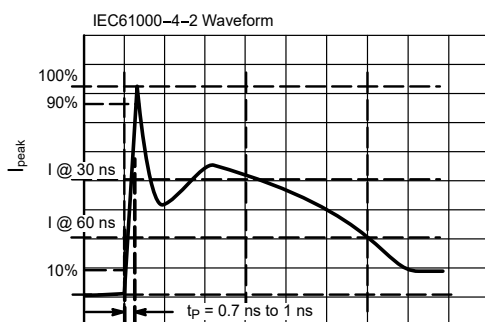

Figure 3: IEC61000-4-2 Waveform

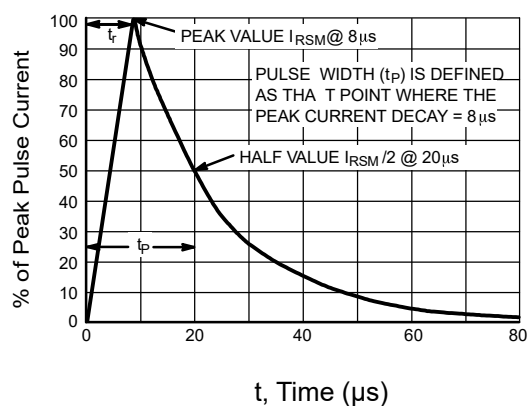

Figure 4: 8 X 20 μ s Pulse Waveform

Level	Test Voltage (kV)	First Peak Current (A)	Current at 30 ns(A)	Current at 60 ns(A)
1	2	7.5	4	2
2	4	15	8	4
3	6	22.5	12	6
4	8	30	16	8

IEC 61000-4-2 Spec



9.SOD-882 Package Outline Dimensions

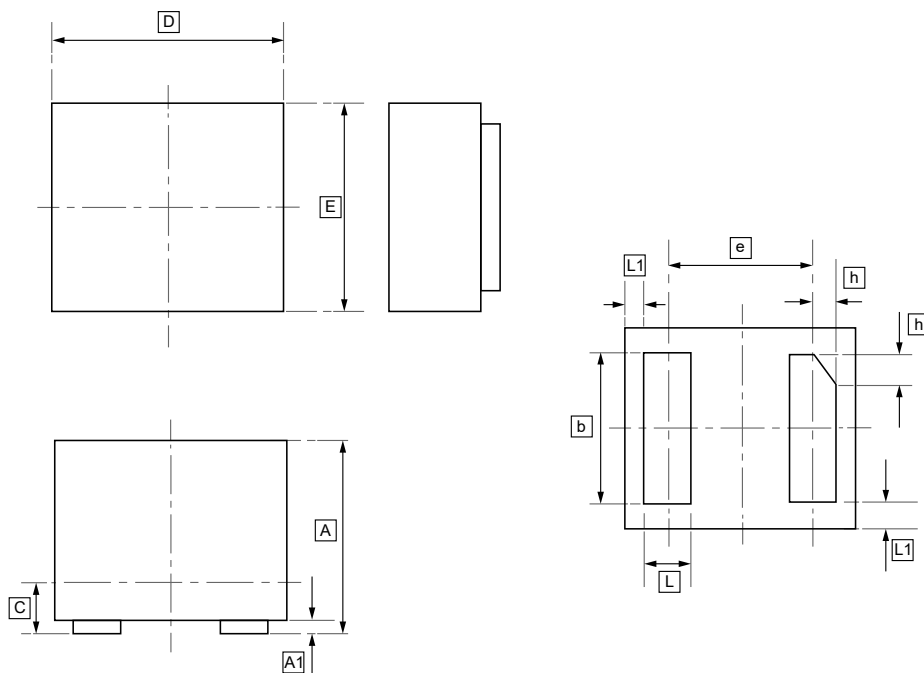

DIMENSIONS (mm are the original dimensions)

Symbol	A	A1	b	C	D	e	E	L	L1	h
Min	0.450	0.000	0.45	0.12	0.950	0.65	0.550	0.200	0.05	0.07
Max	0.550	0.050	0.55	0.18	1.050	BSC	0.650	0.300	REF	0.17



10.Ordering information

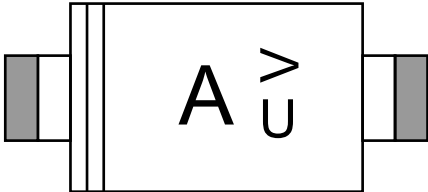

Order Code	Package	Base QTY	Delivery Mode
UMW LESD8LH5.0CT5G	SOD-882	10000	Tape and reel



11.Disclaimer

UMW reserves the right to make changes to all products, specifications. Customers should obtain the latest version of product documentation and verify the completeness and currency of the information before placing an order.

When applying our products, please do not exceed the maximum rated values, as this may affect the reliability of the entire system. Under certain conditions, any semiconductor product may experience faults or failures. Buyers are responsible for adhering to safety standards and implementing safety measures during system design, prototyping, and manufacturing when using our products to prevent potential failure risks that could lead to personal injury or property damage.

Unless explicitly stated in writing, UMW products are not intended for use in medical, life-saving, or life-sustaining applications, nor for any other applications where product failure could result in personal injury or death. If customers use or sell the product for such applications without explicit authorization, they assume all associated risks.

When reselling, applying, or exporting, please comply with export control laws and regulations of China, the United States, the United Kingdom, the European Union, and other relevant countries, regions, and international organizations.

This document and any actions by UMW do not grant any intellectual property rights, whether express or implied, by estoppel or otherwise. The product names and marks mentioned herein may be trademarks of their respective owners.