

1.Features

- EC61000-4-2(ESD) $\pm 30\text{kV}\pm 30\text{kV}(\text{air}),(\text{contact})$
- IEC61000-4-4(EFT)40A(5/50ns)
- 350 Watts Peak Pulse Power per (tp=8/20us)
- Protects one I/O line (unidirectional)
- Low clamping voltage
- Working voltages : 3.3V to 36V
- Low leakage current

2.Applications

- Cell Phone Handsets and Accessories
- Microprocessor based equipment
- Personal Digital Assistants (PDA's)
- Notebooks, Desktops, and Servers
- Portable instrumentation
- Networking and Telecom
- Serial and Parallel Ports
- Peripherals

3.Pinning information

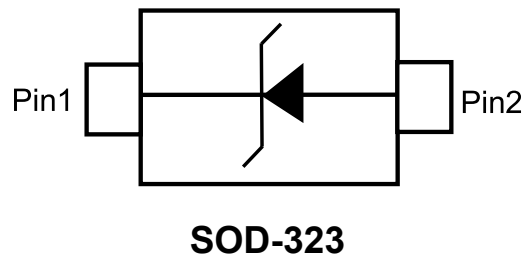

4.Absolute Maximum Ratings $T_A = 25^\circ\text{C}$

Parameter	Symbol	Maximum	Units
ESD per IEC 61000-4-2 (Air)	V_{ESD}	± 30	kV
ESD per IEC 61000-4-2(Contact)		± 30	kV
Peak Pulse Power (8/20us)	P_{PP}	350	W
Junction Temperature	T_{OPT}	-55 to 150	$^\circ\text{C}$
Storage Temperature	T_{STG}	-55 to 150	$^\circ\text{C}$
Lead Soldering Temperature	T_L	260(10sec.)	$^\circ\text{C}$



5. Electrical Characteristics (T_{amb}=25°C)

PART	DEVICE	V _{RWM} (V)	V _B (V)	I _T (mA)	V _{c@1A} (V)	V _c (V)		I _R (μA)	C _T (pF)
NUMBER	MARKING	(max.)	(min.)		(max.)	(max.)	(@A)	(max.)	(max.)
SD03	03W	3.3	4	1	6.5	10.5	20	40	450
SD05	5U	5	6	1	9.8	18	17	40	300
SD12	12W	12	13.3	1	19	32	11	1	130
SD15	15W	15	16.7	1	24	38	10	1	120
SD18	18W	18	20.0	1	29	45	9	1	100
SD20	20W	20	22.3	1	35	50	8	1	90
SD24	24W	24	26.7	1	43	52	7	1	80
SD36	36W	36	40	1	60	75	5	1	60



6. Typical characteristic

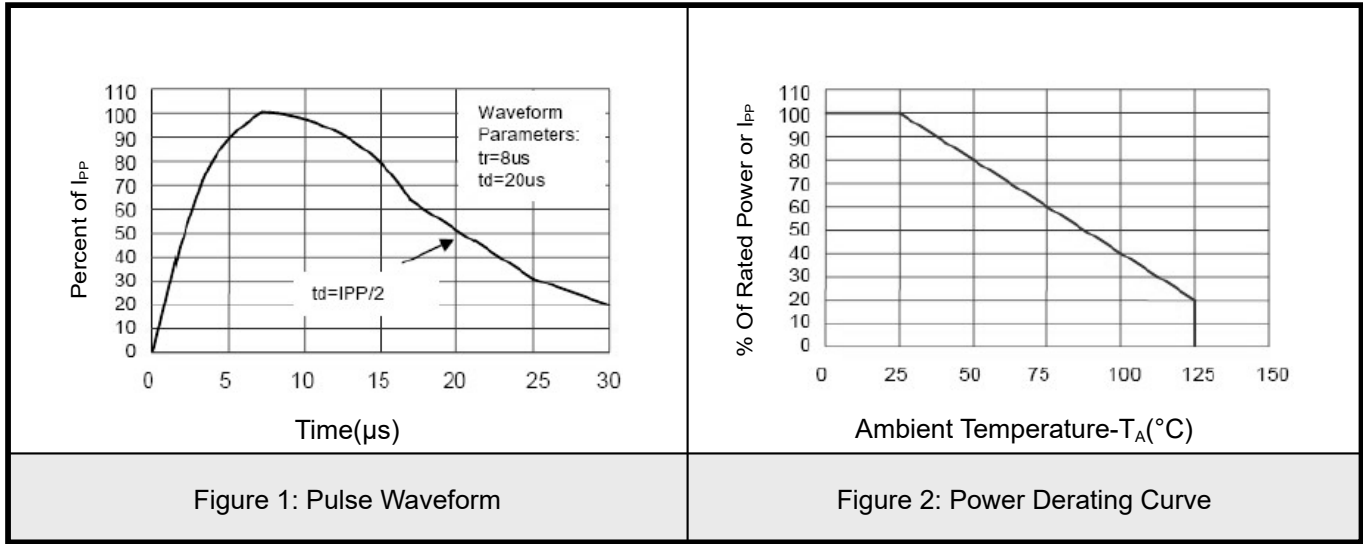



7.SOD-323 Package Outline Dimensions

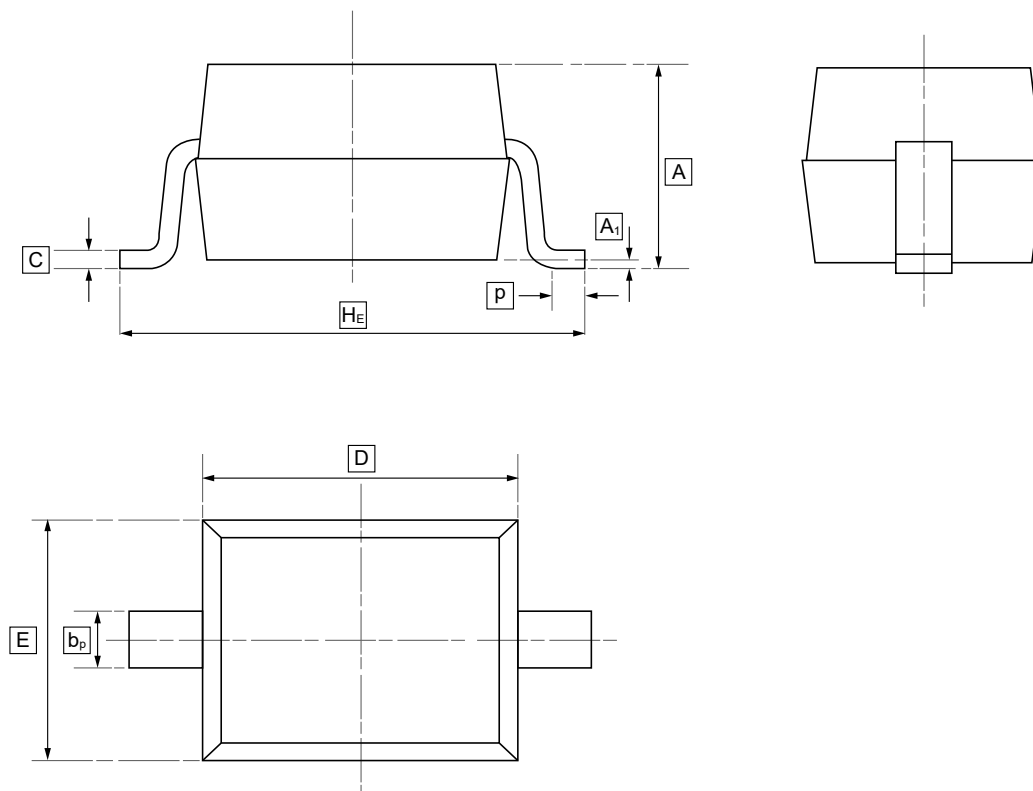

DIMENSIONS (mm are the original dimensions)

Symbol	A	b_p	C	D	E	H_E	A_1	p
Min	0.90	0.25	0.10	1.60	1.15	2.30	0.01	0.20
Max	1.20	0.40	0.15	1.80	1.35	2.80	0.10	0.50



8.Ordering information

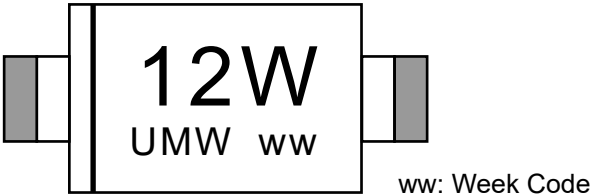

Order Code	Marking	Package	Base QTY	Delivery Mode
UMW SD03	03W	SOD-323	3000	Tape and reel
UMW SD05	05W	SOD-323	3000	Tape and reel
UMW SD12	12W	SOD-323	3000	Tape and reel
UMW SD15	15W	SOD-323	3000	Tape and reel
UMW SD18	18W	SOD-323	3000	Tape and reel
UMW SD20	20W	SOD-323	3000	Tape and reel
UMW SD24	24W	SOD-323	3000	Tape and reel
UMW SD36	36W	SOD-323	3000	Tape and reel



9.Disclaimer

UMW reserves the right to make changes to all products, specifications. Customers should obtain the latest version of product documentation and verify the completeness and currency of the information before placing an order.

When applying our products, please do not exceed the maximum rated values, as this may affect the reliability of the entire system. Under certain conditions, any semiconductor product may experience faults or failures. Buyers are responsible for adhering to safety standards and implementing safety measures during system design, prototyping, and manufacturing when using our products to prevent potential failure risks that could lead to personal injury or property damage.

Unless explicitly stated in writing, UMW products are not intended for use in medical, life-saving, or life-sustaining applications, nor for any other applications where product failure could result in personal injury or death. If customers use or sell the product for such applications without explicit authorization, they assume all associated risks.

When reselling, applying, or exporting, please comply with export control laws and regulations of China, the United States, the United Kingdom, the European Union, and other relevant countries, regions, and international organizations.

This document and any actions by UMW do not grant any intellectual property rights, whether express or implied, by estoppel or otherwise. The product names and marks mentioned herein may be trademarks of their respective owners.