

Pushbutton Ø 19 mm silver contact

82-5151.2000.B002



<https://eao.com/p/82-5151.2000.B002>

Your product:



82-5151.2000.B002

Pushbutton Ø 19 mm silver contact

FRONT

Front bezel shape:	flush
Front bezel material:	Stainless steel

MOUNTING

Mounting cut-out:	Ø 19 mm
-------------------	---------

OPERATING-/INDICATION PART

Lens optics:	opaque
Lens shape:	flush
Symbol:	Standby
Lens material:	Stainless steel
Lens colour:	Silver
Lens illumination:	non illuminative

ELECTRICAL CHARACTERISTICS

Electric strength:	1500 VAC, 50 Hz 1 minute between life terminals and ground
Electrical lifetime:	50 000 cycles of operation
Pollution degree:	2, according to EN IEC 60947-1
Switching voltage and switching current:	

according to IEC 60947-5-1 (Silver contacts)	
Service categorie AC-15	
Voltage	Current
24 VAC	1 A
35 VAC	1 A (M12 version)
110 VAC	1 A
220 VAC	0.5 A
Switch rating DC service categorie DC-13 (Silver contacts)	
Voltage	Current
24 VDC	0.7 A
35 VDC	0.5 A (M12 version)
110 VDC	0.2 A
220 VDC	0.1 A

according to UL 508 (Silver contacts)	
cosφ 0,75 ... 0,8	
Voltage	Current
120 VAC	5 A
240 VAC	3 A
24 VAC	1 A

Rated Operational Voltage Ue: 250 VAC

Thermal current Ith: 5 A

Rated insulation voltage Ui: 250 V

MECHANICAL CHARACTERISTIC

Operating Travel:	ca. 3 mm
Terminal:	Soldering terminal, 2.8 x 0.5 mm
Operating force:	4 N ... 7 N
Switching action:	Maintained
Weight:	0.018 kg
Contact material:	Silver
Tightening torque:	0.5 ... 0.6 Nm
Switching system:	Snap-action switching element
Mechanical lifetime:	500 000 cycles of operation

AMBIENT CONDITION

IP front protection:	IP65, IP67
Climate resistance:	Damp heat, 21 days according to IEC 60512-11
Vibration resistance:	10 ... 500 Hz, amplitude 1.5 mm p-p according to IEC 60068-2-6
Storage temperature:	– 40 °C ... + 80 °C
Operating temperature:	– 30 °C ... + 70 °C
Shock resistance:	

Max. 500 m / s² as per IEC 60068-2-27

CERTIFICATE

Conformities: CE, 2011 / 65 / EC (RoHS), 2014 / 35 / EU (LVD)

Approbations: CB, CCC, C UL, UL

OTHER

Short Description: Pushbutton Ø 19 mm silver contact, Maintained, Soldering terminal, 2.8 x 0.5 mm, Stainless steel, Standby, Silver

Wiring diagrams:

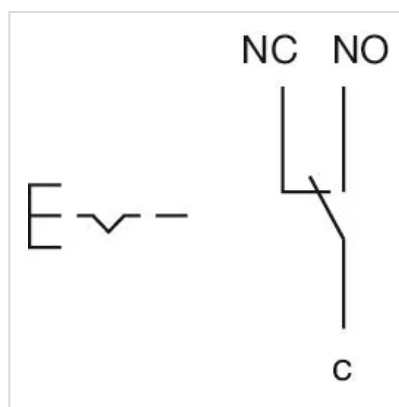

Mounting cut-outs:

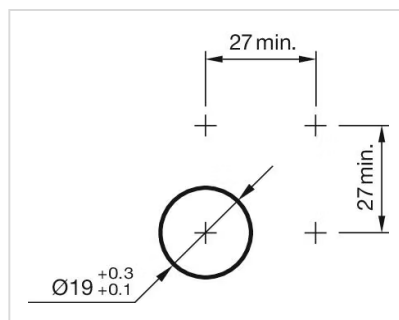

Dimension drawings:

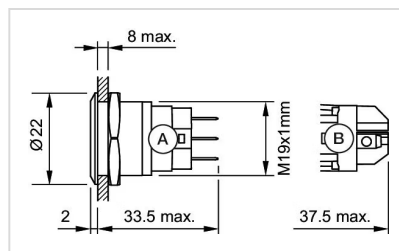

A = Solder terminal
B = Screw terminal

Component layouts:

