

# Illuminated pushbutton Ø 22 mm stainless steel 316L

82-6651.2134



<https://eao.com/p/82-6651.2134>

Your product:

---



## 82-6651.2134

### Illuminated pushbutton Ø 22 mm stainless steel 316L

#### FRONT

<b>Front form:</b>	round
<b>Front bezel material:</b>	Stainless steel 316L

#### MOUNTING

<b>Mounting cut-out:</b>	Ø 22 mm
--------------------------	---------

#### OPERATING-/INDICATION PART

<b>Lens optics:</b>	opaque
<b>Lens material:</b>	Stainless steel 316L
<b>Shape of illumination:</b>	Ring (Tritan)
<b>Lens colour:</b>	Silver
<b>Lens shape:</b>	flush
<b>Lens illumination:</b>	illuminative
<b>Illumination colour:</b>	Green

#### ELECTRICAL CHARACTERISTICS

<b>Rated Operational Voltage Ue:</b>	250 VAC
<b>Pollution degree:</b>	2, according to EN IEC 60947-1
<b>Electric strength:</b>	1500 VAC, 50 Hz 1 minute between life terminals and ground
<b>Rated insulation voltage Ui:</b>	250 V
<b>Electrical lifetime:</b>	50 000 cycles of operation
<b>Operating voltage:</b>	24 V DC (LED)

<b>Contacts:</b>	1 C
<b>Thermal current I<sub>th</sub>:</b>	5 A

## MECHANICAL CHARACTERISTIC

<b>Terminal:</b>	Plug-in terminal, 2.8 x 0.5 mm
<b>Operating Travel:</b>	ca. 3 mm
<b>Tightening torque:</b>	0.5 ... 0.6 Nm
<b>Contact material:</b>	Silver
<b>Mechanical lifetime:</b>	500 000 cycles of operation
<b>Weight:</b>	0.026 kg
<b>Switching system:</b>	Snap-action switching element
<b>Switching action:</b>	Maintained
<b>Operating force:</b>	4 N ... 7 N

## AMBIENT CONDITION

<b>IP front protection:</b>	IP65, IP67
<b>Climate resistance:</b>	Damp heat, 21 days according to IEC 60512-11
<b>Vibration resistance:</b>	10 ... 500 Hz, amplitude 1.5 mm p-p according to IEC 60068-2-6
<b>Operating temperature:</b>	– 30 °C ... + 70 °C
<b>Storage temperature:</b>	– 40 °C ... + 80 °C
<b>Shock resistance:</b>	Max. 500 m / s <sup>2</sup> as per IEC 60068-2-27

## CERTIFICATE

<b>Approbations:</b>	CB, CCC, C UL, UL
<b>Conformities:</b>	CE, 2011 / 65 / EC (RoHS), 2014 / 35 / EU (LVD)

## OTHER

<b>Kind of illumination:</b>	Single-LED
<b>Short Description:</b>	Illuminated pushbutton Ø 22 mm stainless steel 316L, Maintained, 36 V AC/DC @ 0,6 A, 24 V DC (LED), 1 C, Plug-in terminal, 2.8 x 0.5 mm, round, Stainless steel 316L, Green, Silver
<b>Hints:</b>	Switching voltage: max. 36 V AC/1A, max. 36 V DC/0.6
<b>Mounting cut-outs:</b>	

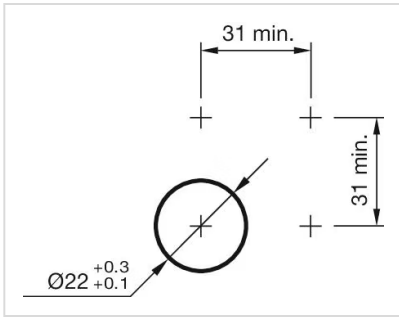

#### Wiring diagrams:

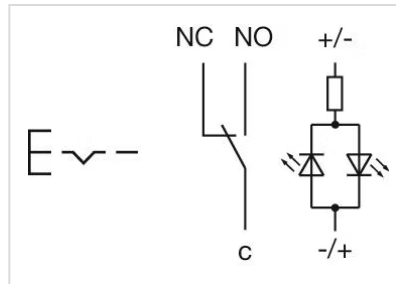

#### Component layouts:

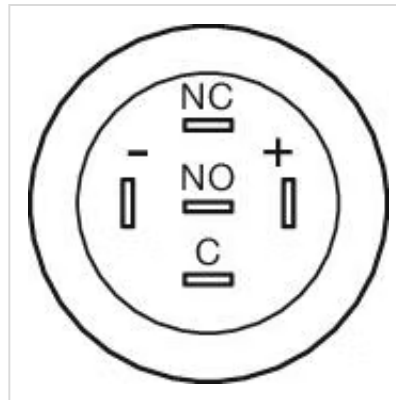

#### Dimension drawings:

