

DESCRIPTION: MALE // STANDARD DSUB // CRIMP AND POKE

SPECIFICATIONS:

ELECTRICAL:

CURRENT RATING:	5 AMPS
CONTACT RESISTANCE:	15 mOhms MAX.
INSULATION RESISTANCE:	1,000 MOhms MIN.
OPERATING TEMPERATURE:	-50°C TO +100°C
VOLTAGE:	500 VAC FOR 1 MINUTE

MATERIALS:

FRONT INSULATOR:	PBT-BLACK, UL94V-0 RATED
REAR INSULATOR:	PA66-BLACK, UL94V-0 RATED
PROCESS TEMP:	230°C
SHELL:	NICKEL PLATED STEEL

COMPATIBLE WITH NORCOMP CONTACT PART NUMBERS BELOW:

170-001-170L001	170-101-170L001
170-001-170L002	170-101-170L002
170-001-170L003	170-101-170L003
170-201-170L003	

****NOTE: CONTACTS MUST BE PURCHASED SEPARATELY****

****NOTE: ASSEMBLY INSTRUCTION ON PAGE 3****

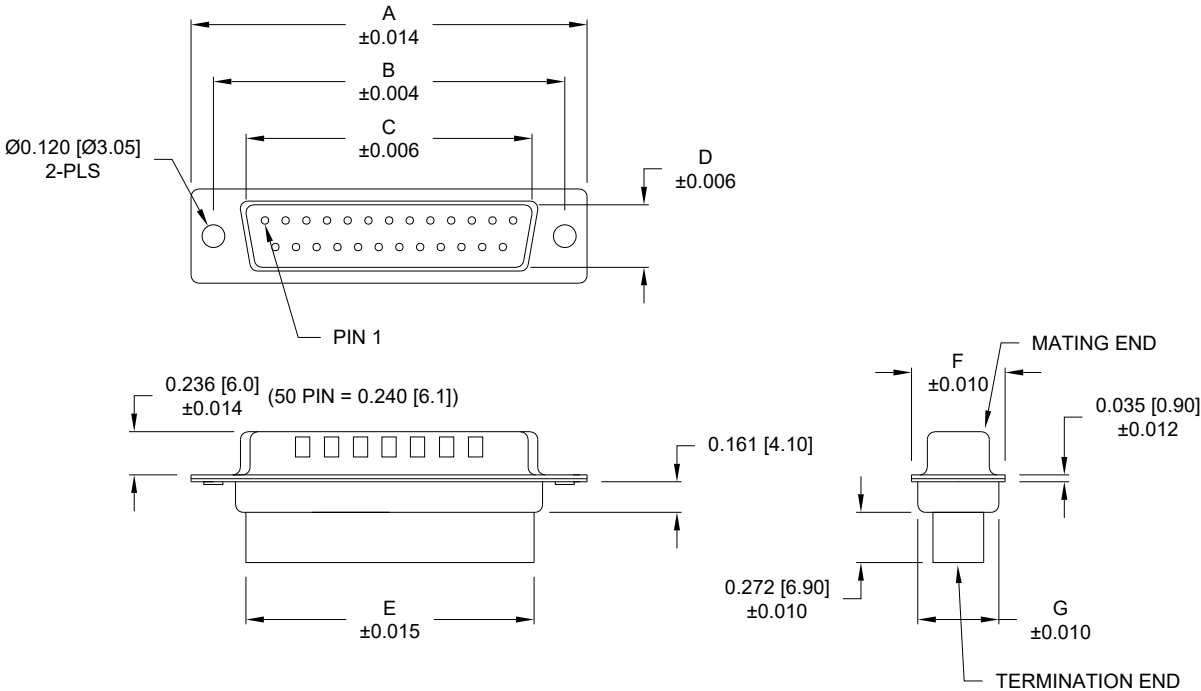

170-YYY-17YLYY0

SERIES

POSITIONS

009

015

025

037

050

GENDER

1 = MALE

TERMINATION

7 = CRIMP & POKE

SHELL PLATING

2 = TIN (DISCONTINUED)

3 = NICKEL (GROUND INDENTS)

HARDWARE OPTIONS

00 = NO HARDWARE

01 = .098" #4-40 CLINCH NUT (SOLDER SIDE)

02 = .236" #4-40 CLINCH NUT (SOLDER SIDE)

03 = .236" #4-40 CLINCH NUT (MATING SIDE)

04 = .098" M3 CLINCH NUT (SOLDER SIDE)

PLATING OPTIONS

0 = NO CONTACTS

		DIMENSIONS						
No. OF PINS	UNITS	A	B	C	D	E	F	G
9	inch	1.213	0.984	0.666	0.329	0.618	0.496	0.429
	mm	30.80	24.99	16.92	8.36	15.70	12.60	10.90
15	inch	1.541	1.312	0.994	0.329	0.933	0.496	0.429
	mm	39.15	33.32	25.25	8.36	23.70	12.60	10.90
25	inch	2.087	1.852	1.534	0.329	1.496	0.496	0.429
	mm	53.00	47.04	38.96	8.36	38.00	12.60	10.90
37	inch	2.728	2.500	2.182	0.329	2.142	0.496	0.429
	mm	69.30	63.50	55.42	8.36	54.40	12.60	10.90
50	inch	2.638	2.402	2.079	0.436	2.039	0.602	0.535
	mm	67.00	61.00	52.80	11.07	51.80	15.30	13.60

RoHS COMPLIANT



THESE DRAWINGS AND SPECIFICATIONS ARE THE PROPERTY OF NorComp AND SHALL NOT BE REPRODUCED, COPIED OR USED AS THE BASIS FOR THE MANUFACTURE OR SALE OF APPARATUS WITHOUT WRITTEN PERMISSION.

DRAWN:
P. JENKINS

DATE:
08/18/1998

UNITS = inch [mm]

DO NOT SCALE FROM DRAWING

NorComp

SCALE:
NTS

SHEET OF
1 3

REV
20

DWG NO.

170-YYY-17YLYY0

TOLERANCE:
ALL DIMENSIONS ARE ±0.010

01 0.065" (SOLDER SIDE)

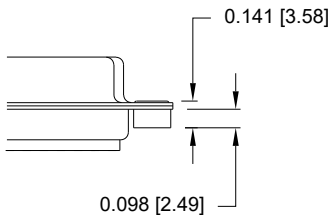

#4-40 INTERNAL THREADS

02 0.236" (SOLDER SIDE)

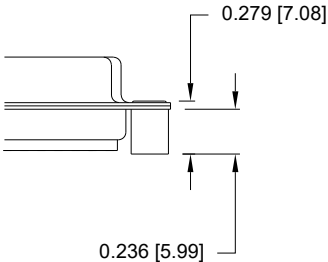

#4-40 INTERNAL THREADS

03 0.236" (MATING SIDE)

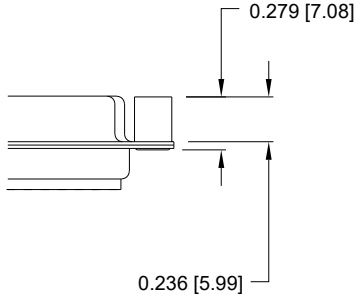

#4-40 INTERNAL THREADS

04 0.065" (SOLDER SIDE)

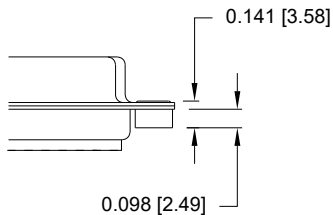

M3 INTERNAL THREADS

RoHS COMPLIANT



THESE DRAWINGS AND SPECIFICATIONS ARE THE PROPERTY OF NorComp AND SHALL NOT BE REPRODUCED, COPIED OR USED AS THE BASIS FOR THE MANUFACTURE OR SALE OF APPARATUS WITHOUT WRITTEN PERMISSION.

DRAWN:
P. JENKINS

DATE:
08/18/1998

UNITS = inch [mm]

DO NOT SCALE FROM DRAWING

NorComp

SCALE:
NTS

SHEET OF
2 3

REV
20

DWG NO. 170-YYY-17YLYY0

ASSEMBLY INSTRUCTIONS:

- 1. CHOOSE CONTACT THAT IS COMPATIBLE
 - a. SHOWN ON PAGE 1
- 2. USE APPROPRIATE CRIMP TOOL
 - a. 170-701-170-000 (STAMPED CRIMP HAND TOOL)
 - b. 170-702-170-000 (MACHINED CRIMP HAND TOOL)
- 3. FOLLOW CRIMP HAND TOOL INSTRUCTIONS
 - a. FOUND ON NORCOMP WEBSITE ON 170 SERIES CONTACTS PRODUCT PAGE
 - b. <https://www.norcomp.net/series/170-series-contacts>
- 4. ONCE CONTACT IS CRIMPED INSERT INTO HOUSING AS SHOWN BELOW:

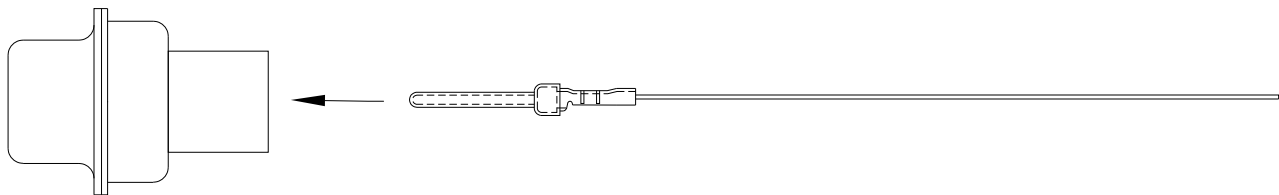

RoHS COMPLIANT



THESE DRAWINGS AND SPECIFICATIONS ARE THE PROPERTY OF NorComp AND SHALL NOT BE REPRODUCED, COPIED OR USED AS THE BASIS FOR THE MANUFACTURE OR SALE OF APPARATUS WITHOUT WRITTEN PERMISSION.

DRAWN:
P. JENKINS

DATE:
08/18/1998

UNITS = inch [mm]

DO NOT SCALE FROM DRAWING

NorComp

SCALE:
NTS

SHEET 3 OF 3

REV
20

DWG NO. 170-YYY-17YLYY0