

SUGGESTED MATING TAB

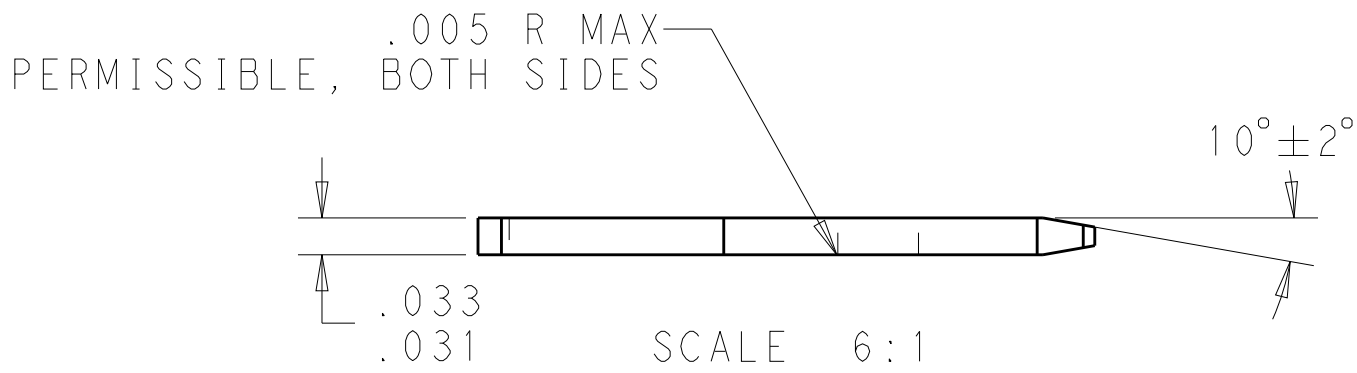

- 1 MATL: 1/2H BRASS OR NICKEL PL STEEL
- 2 NO BURRS PERMISSBLE AT HOLE
- △ MUST BE FLAT WITHIN .003 OVER THIS LENGTH
- 4 TIN PLATING IS REQUIRED ON BRASS WHEN TERMINAL TEMP IS OVER 225° F.
- 5 HOLE MUST BE SYMMETRICAL ABOUT TAB CENTERLINE WITHIN .003
- * TO BE USED ONLY WHEN SHOULDER IS ELIMINATED.

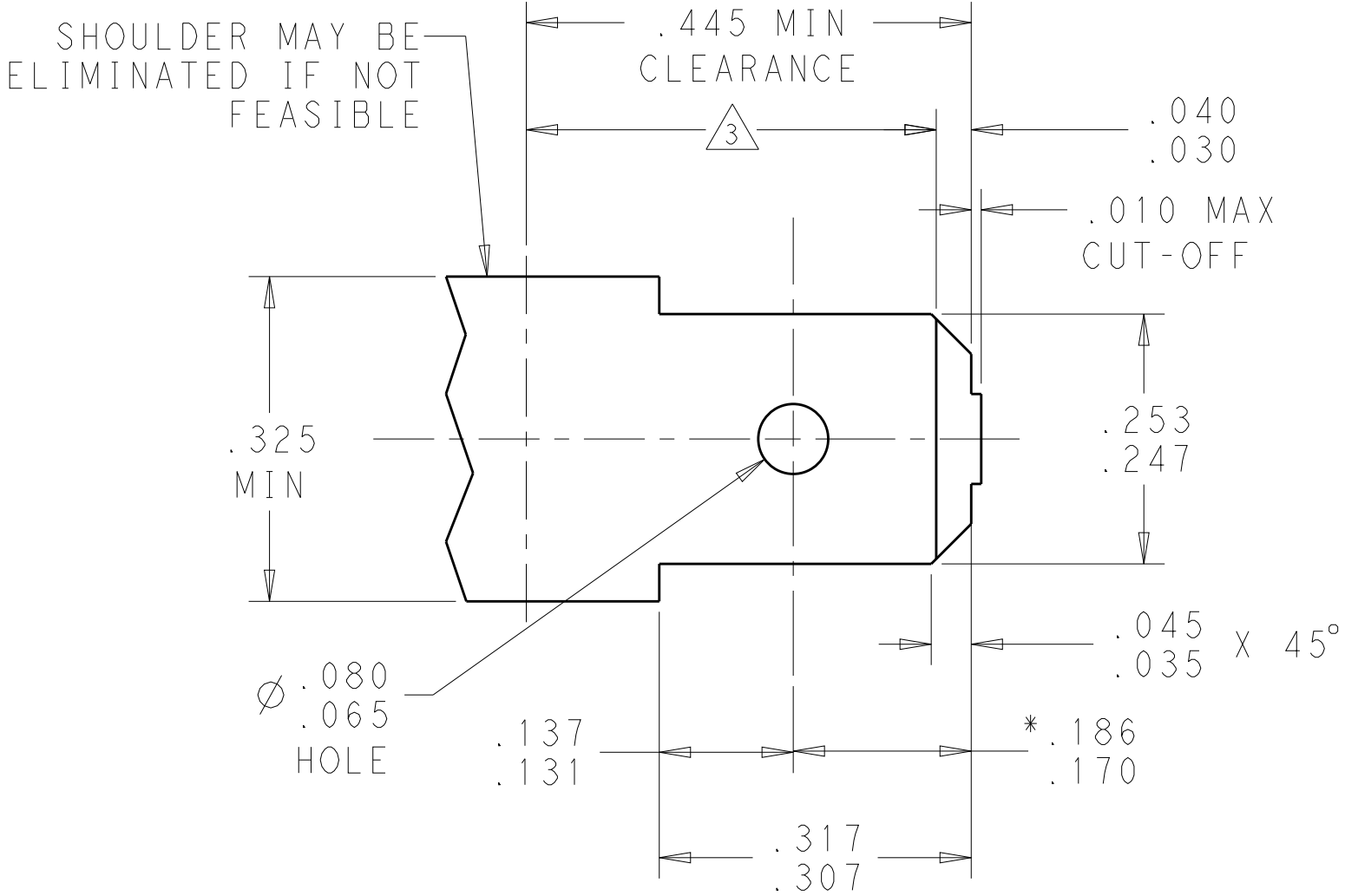
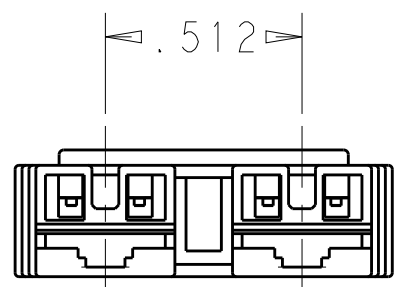
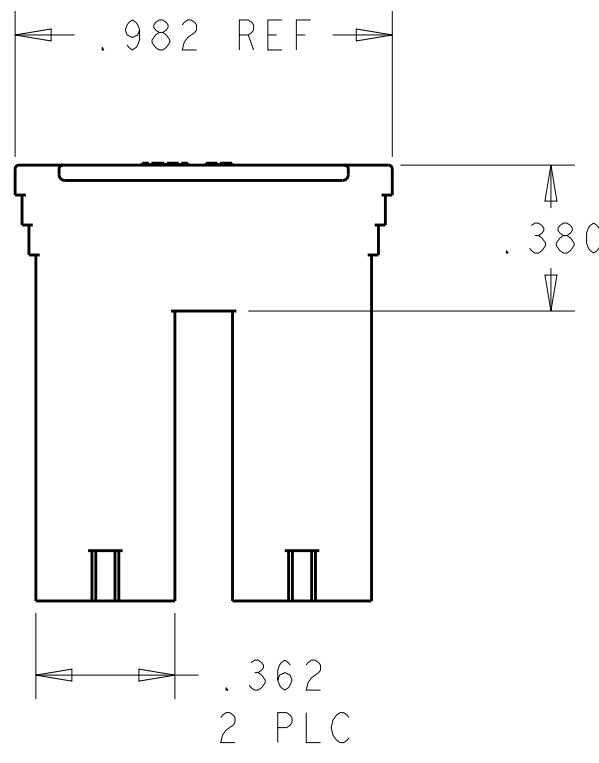
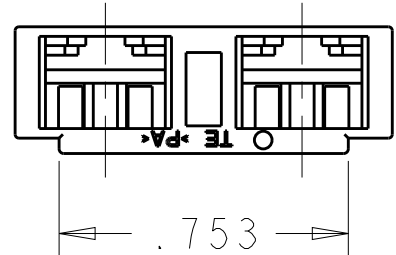
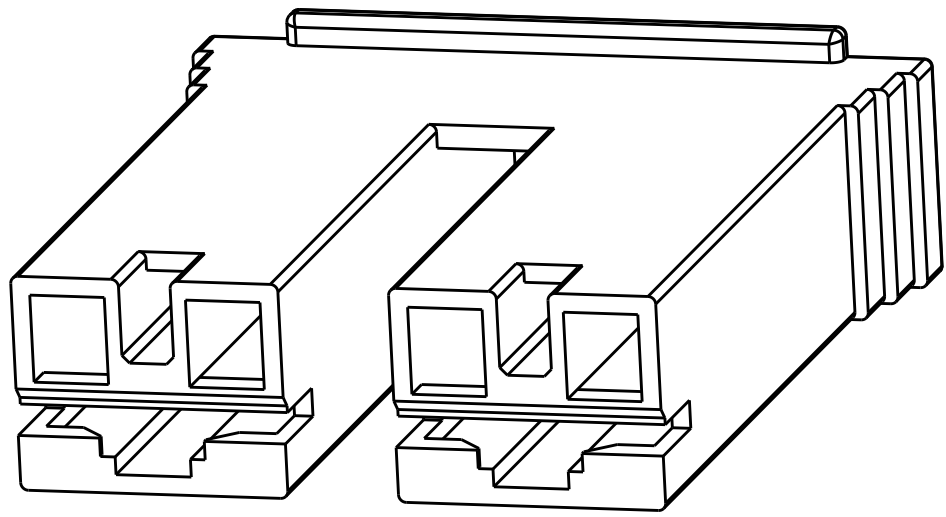

LOC	DIST	REVISIONS					
		P	LTR	DESCRIPTION	DATE	DWN	APVD
-	-		A7	REVISED PER ECR-18-006473	18SEP2018	BDA	DS
			A8	REVISED PER ECR-20-005966	01OCT2020	SS	EW

1 FOR USE WITH MKII POSITIVE LOCK, LOW INSERTION FORCE FASTON RECEPTACLES AND MOST BUDGET FASTON RECEPTACLES.

OBSOLETE

SUPERSEDED BY 3-1969453-1

NATURAL	66 Nylon V0	3-1969453-1
BLACK	66 NYLON	1969453-8
YELLOW	66 NYLON	1969453-6
BLUE	66 NYLON	1969453-5
RED	66 NYLON	1-1969453-2
NATURAL	66 NYLON V0	1-1969453-1
NATURAL (WHITE)	66/6 NYLON V0	1969453-1
COLOR	MATERIAL	PART NO.

THIS DRAWING IS A CONTROLLED DOCUMENT.		DWN	04AUG11	TE Connectivity			
DIMENSIONS: INCHES		CHK	04AUG11				
TOLERANCES UNLESS OTHERWISE SPECIFIED:		APVD	04AUG11	NAME			
0 PLC ±.1		PRODUCT SPEC					
1 PLC ±.02		APPLICATION SPEC		HOUSING, RECPT, POSITIVE-LOCK AND STANDARD FASTON, .250 SERIES MKII			
2 PLC ±.010		WEIGHT					
3 PLC ±.0005		CUSTOMER DRAWING		A200779C-1969453			
4 PLC ANGLES ±							
FINISH				SCALE 8:1 SHEET 1 OF 1 REV A8			
SEE TABLE							