

REVISIONS					
P	LTR	DESCRIPTION	DATE	DWN	APVD
1		INITIAL DRAWING	09APR2014	VA	AT
A		ECO-14-018972	29DEC2014	DS	AT
A1		ECO-16-018267	19DEC2016	DS	AT

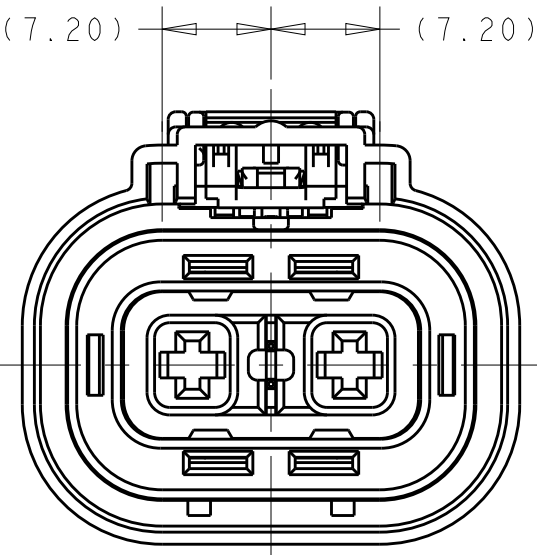

KEY A
2103628-1

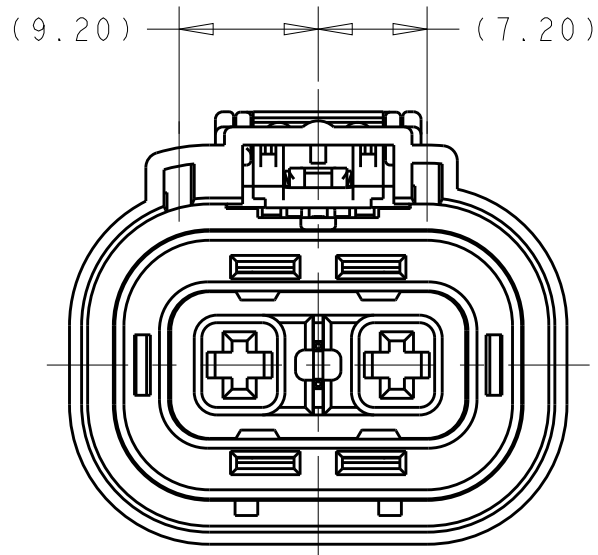

KEY B
2103628-2

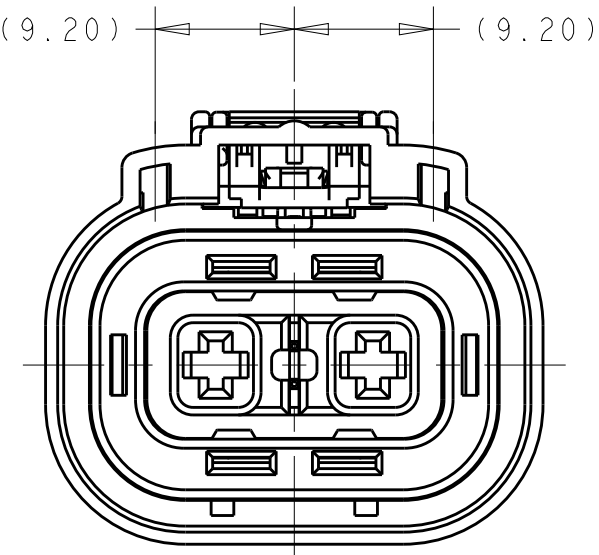

KEY D
2103628-4

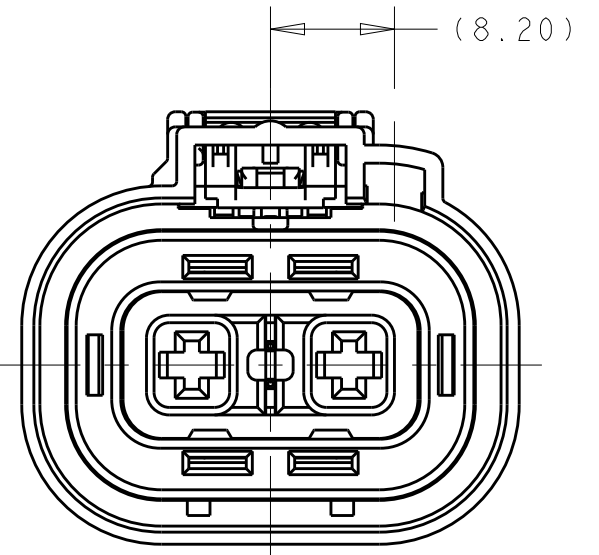

KEY E
2103628-5

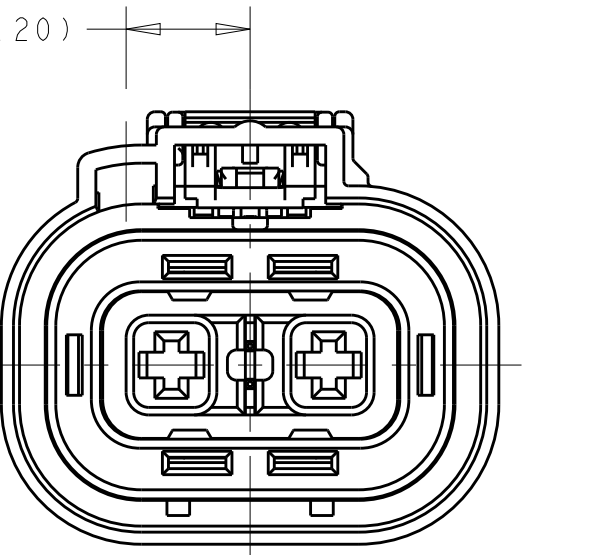

KEY F
2103628-6

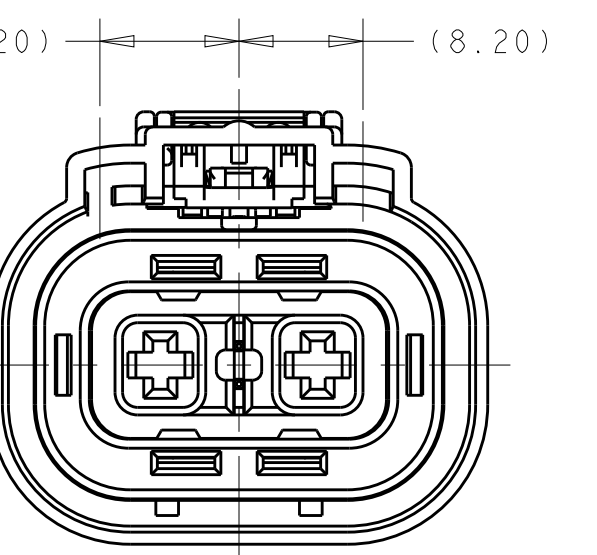

KEY G
2103628-7

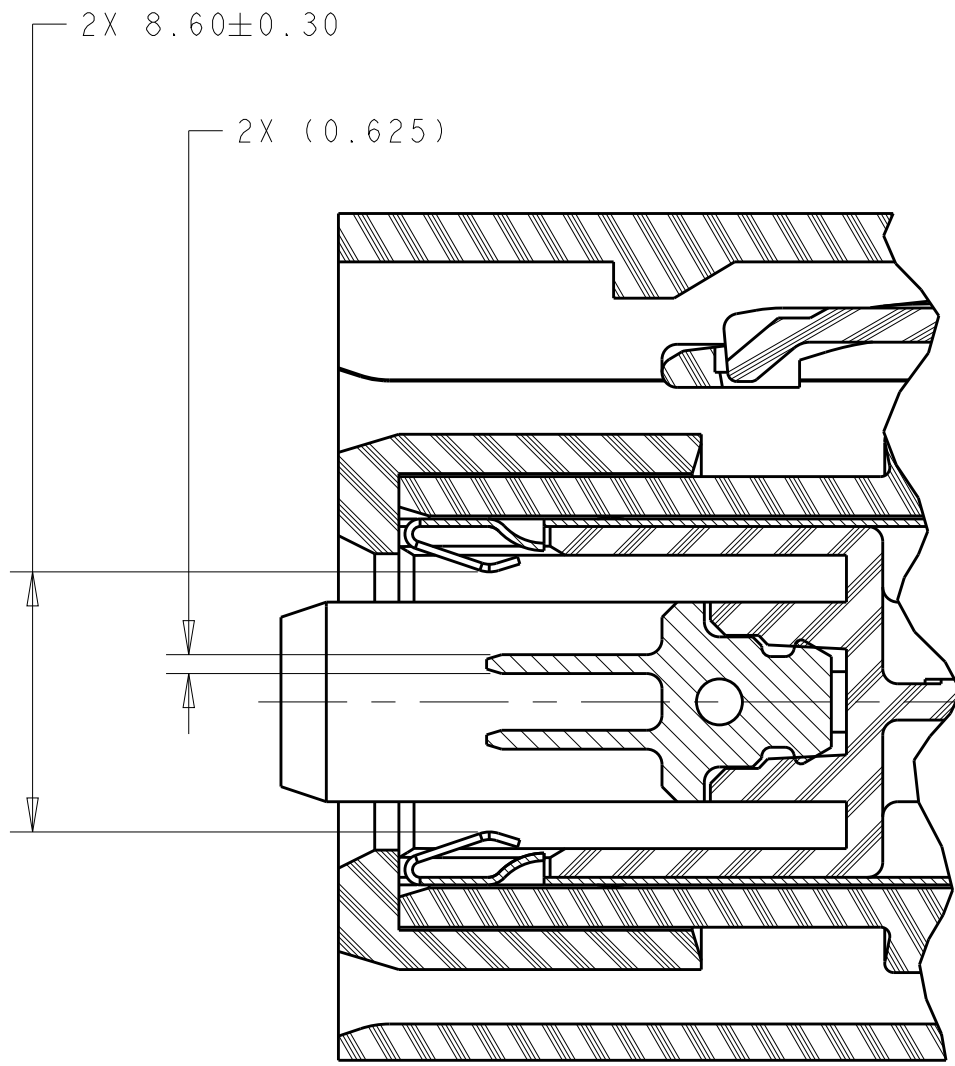
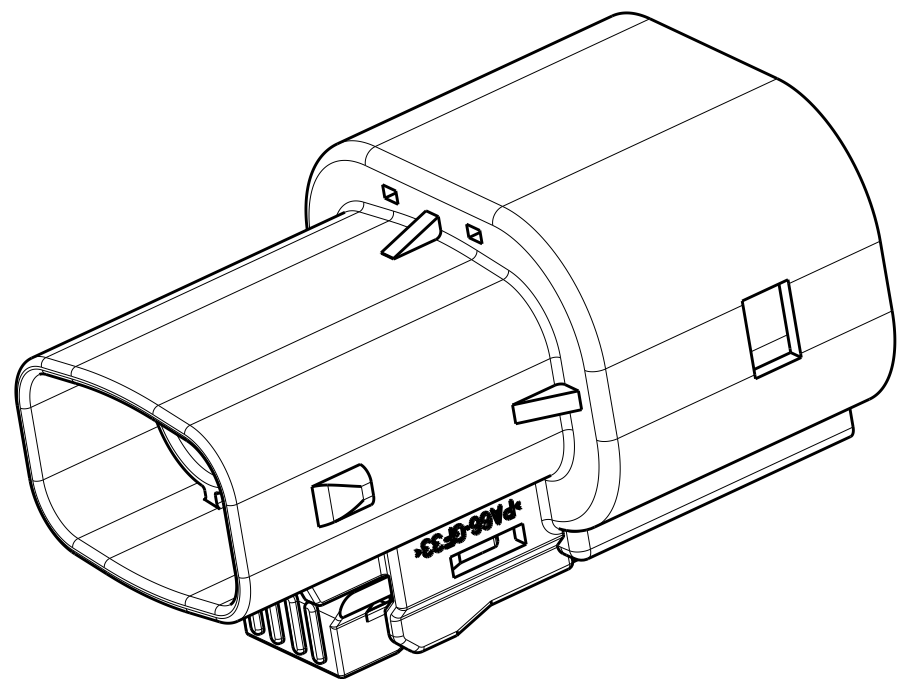
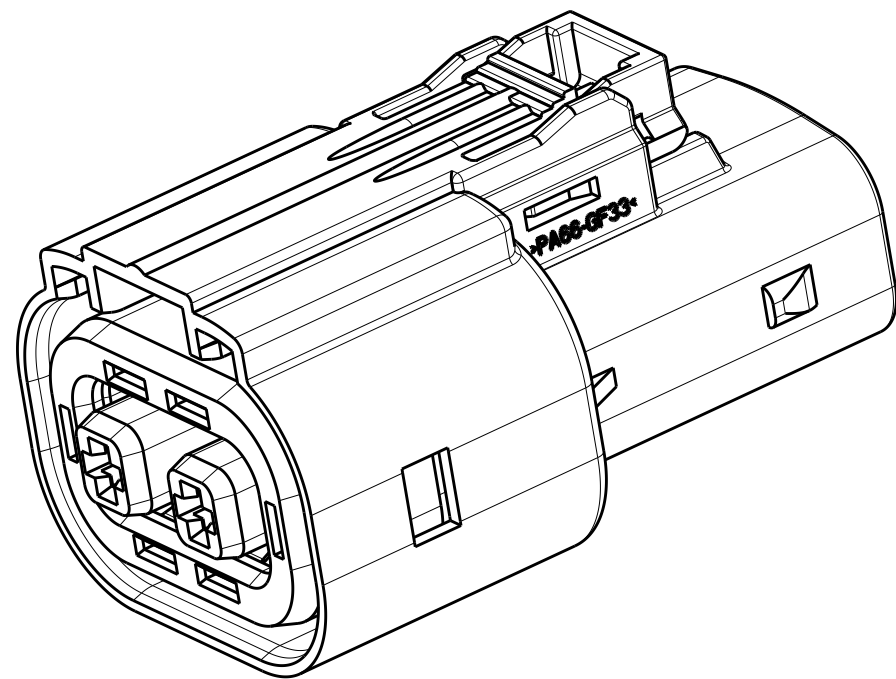
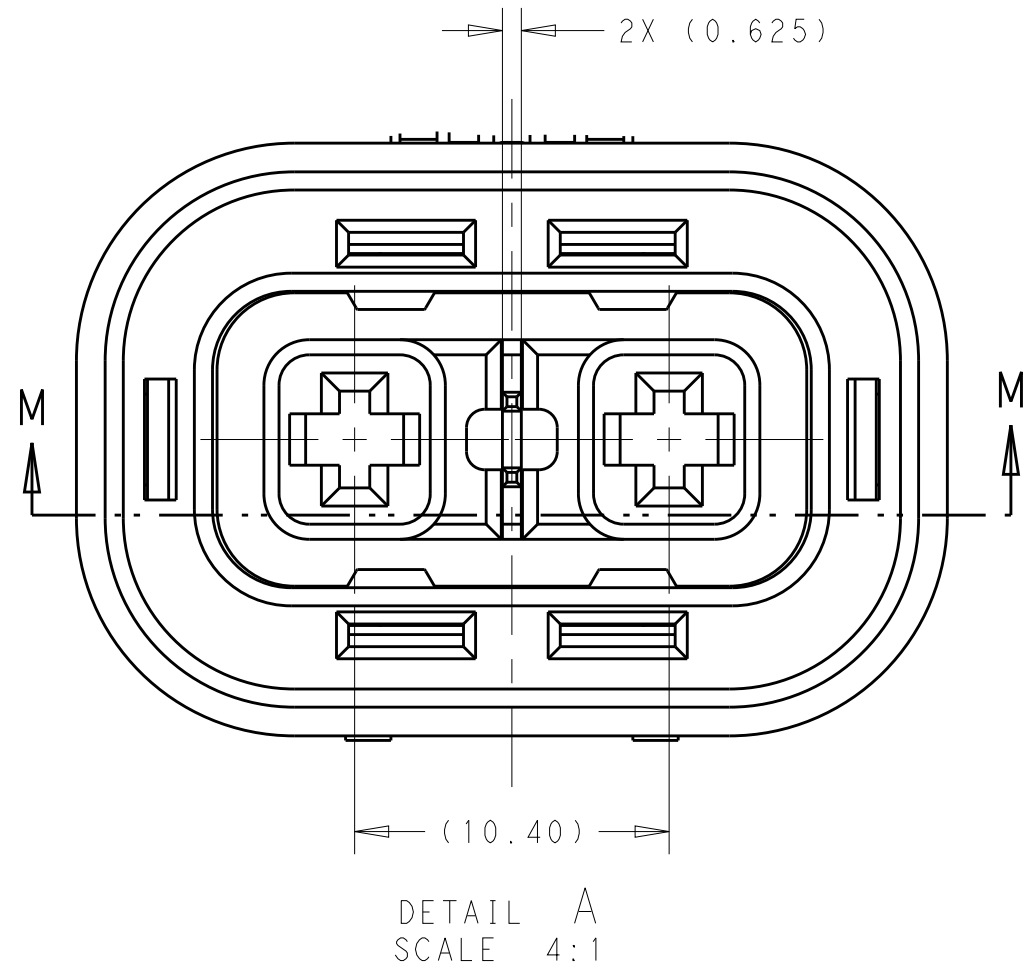
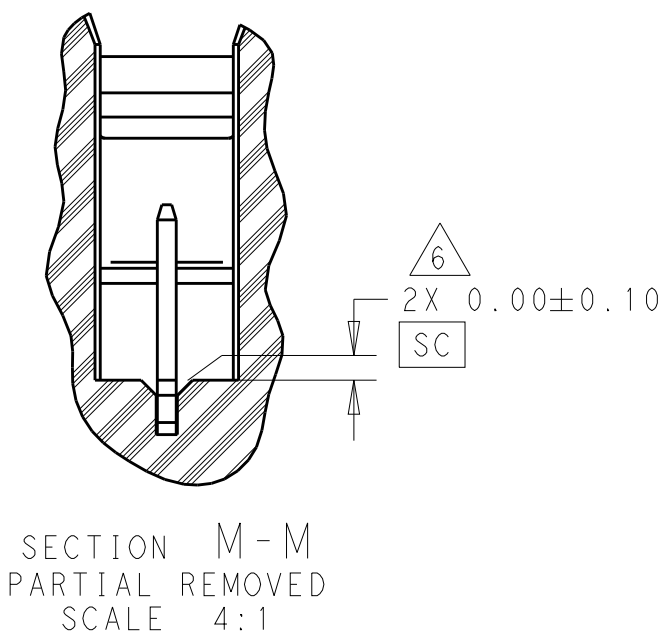
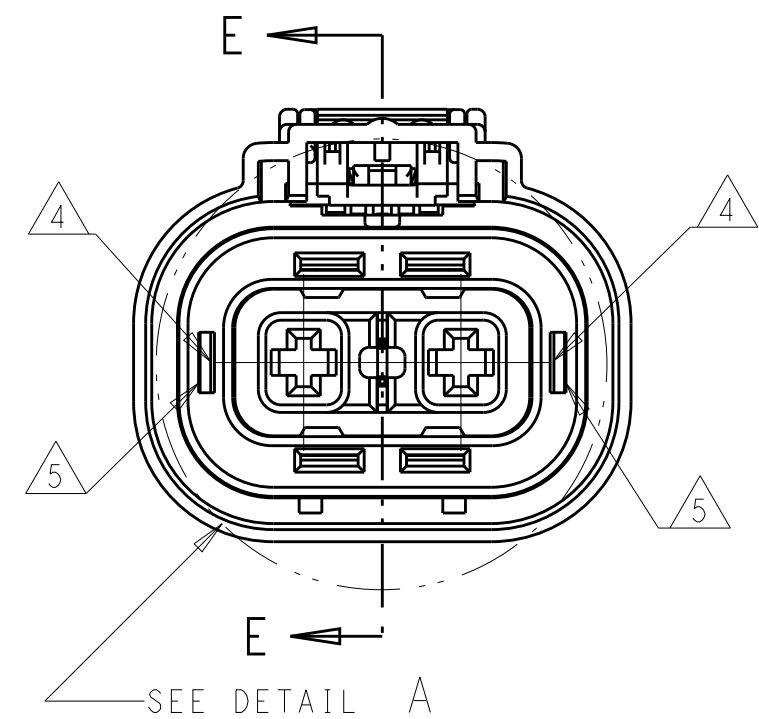
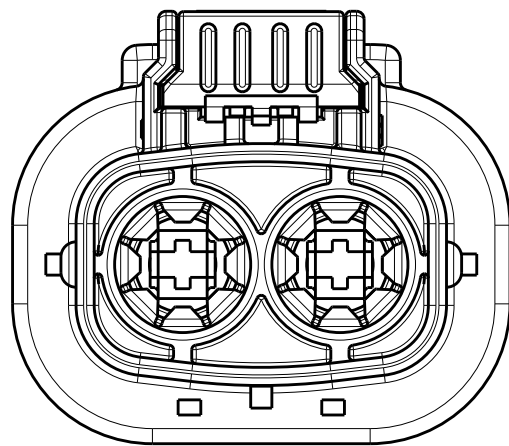
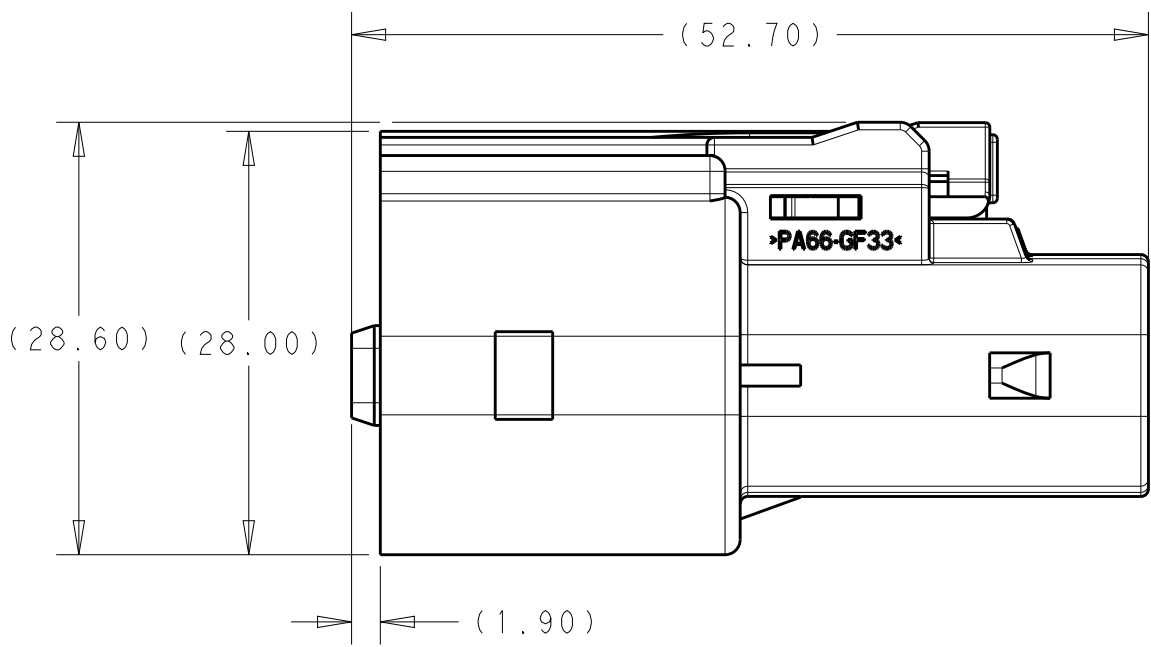
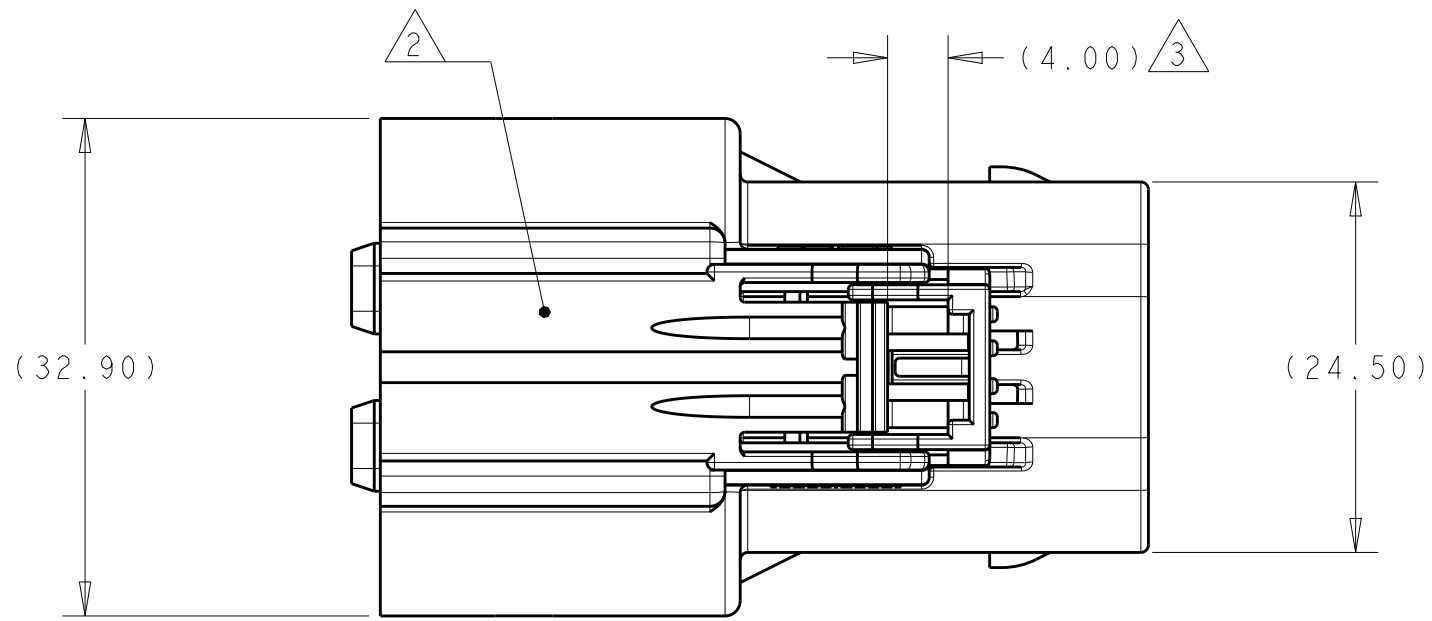

SECTION E-E
PARTIAL REMOVED
SCALE 4:1

- CONNECTOR MUST BE FREE OF ANY MECHANICAL DEFECTS WHICH MAY AFFECT FIT, FORM, OR PERFORMANCE
- PART NUMBER AND JULIAN DATE CODE MARKED IN THIS AREA
- CPA MUST BE INSTALLED IN PRE-STAGE POSITION AS SHOWN.
- INNER HOUSING SUB ASSEMBLY MUST BE FULLY LOCKED PRIOR TO ASSEMBLY IN TWO LOCATIONS INTO OUTER HOUSING. INSPECTION PRIOR TO ASSEMBLY OF PERIPHERAL SEAL RETAINER PERMITTED
- PERIPHERAL SEAL RETAINER MUST BE FULLY LOCKED IN TWO LOCATIONS INTO OUTER HOUSING.
- MEASURE EACH STAMPING SHOULDER FLUSH CONDITION TO NEIGHBORING PLASTIC SURFACE
- NOTE DELETED

PLUG ASSY, KEY G, HVA280-2PHI SE	2103628-7
PLUG ASSY, KEY F, HVA280-2PHI SE	2103628-6
PLUG ASSY, KEY E, HVA280-2PHI SE	2103628-5
PLUG ASSY, KEY D, HVA280-2PHI SE	2103628-4
PLUG ASSY, KEY B, HVA280-2PHI SE	2103628-2
PLUG ASSY, KEY A, HVA280-2PHI SE	2103628-1
DESCRIPTION	PART NO

THIS DRAWING IS A CONTROLLED DOCUMENT.		DWN: VISHWA, A 09APR2014	TE Connectivity	
DIMENSIONS:		CHK: D. SIMPSON 06MAY2014		
mm	TOLERANCES UNLESS OTHERWISE SPECIFIED:	APVD: A. TYLER 06MAY2014	NAME: PLUG ASSY, HVA280-2PHI SE	
0 PLC	±0.2	PRODUCT SPEC	SIZE: A1	
1 PLC	±0.10	APPLICATION SPEC	CAGE CODE: 2103628	
2 PLC	±0.13	WEIGHT	RESTRICTED TO	
3 PLC	±0.0001	Customer Drawing	SCALE: 2:1	
4 PLC	±0.0001		SHEET 1 OF 1	
ANGLES	±1		REV A1	
FINISH	-			