

SPECIFICATIONS:

MATERIALS:		
BACKSHELL:		DIE CAST NICKEL PLATED ZINC ALLOY
JACKSCREWS:		ZINC PLATED STEEL
HOOD SCREWS:		ZINC PLATED STEEL
COMPRESSION INSERTS:		ABS, UL 94-HB

ENVIRONMENT:		
OPERATING TEMPERATURE:		-40°C TO +120°C

BACKSHELL KIT INCLUDES:

(2) BACKSHELL HALVES

(2) 4-40 THUMBSCREWS

(2) HOUSING SCREWS (RECOMMENDED TORQUE 5.2 IN-LBS)

(1) COMPRESSION INSERTS - VARIOUS SIZES
Ø0.157 [4.0], Ø0.197 [5.0], Ø0.276 [7.0], Ø0.354 [9.0]

NOTE: 9 POSITION HAS ONLY 1 THUMBSCREW (OPPOSITE CABLE ENTRY)

DIMENSIONS(in/mm)				
SIZE	A	B	C	D
9	1.220	0.984	1.429	0.570
	30.99	24.99	36.30	14.48
15	1.556	1.312	1.587	0.570
	39.50	33.32	40.30	14.48
25	2.094	1.852	1.587	0.570
	53.20	47.04	40.30	14.48
37	2.744	2.500	1.587	0.570
	69.70	63.50	40.30	14.48

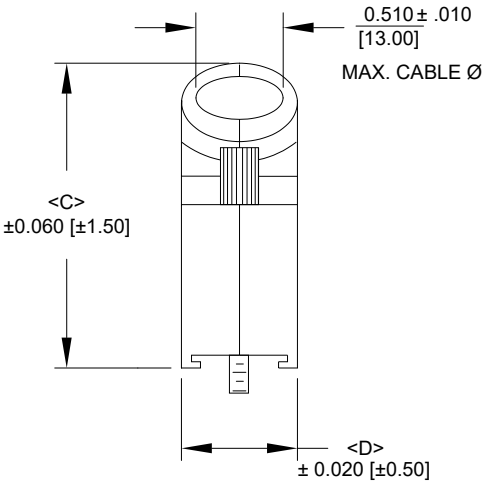
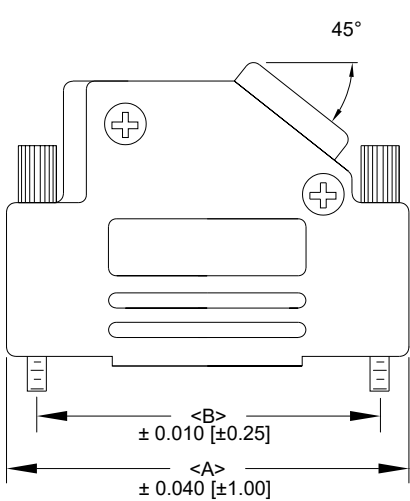

971-YYY-030R121

SERIES

POSITIONS
009
015
025
037

MATERIAL
030 = ZINC

COLOR:
12 = NICKEL OVER COPPER

PUT-UPS
1 = KIT

RoHS COMPLIANT



THESE DRAWINGS AND SPECIFICATIONS ARE THE PROPERTY OF NorComp AND SHALL NOT BE REPRODUCED, COPIED OR USED AS THE BASIS FOR THE MANUFACTURE OR SALE OF APPARATUS WITHOUT WRITTEN PERMISSION.	DRAWN: P. JENKINS
	DATE: 06/10/2005

UNITS = inch [mm]

DO NOT SCALE FROM DRAWING

NorComp	SCALE: NTS	SHEET 1 OF 1	REV 10
	DWG NO. 971-YYY-030R121		