

DESCRIPTION: DSUB IP67 FLANGE // FEMALE // COMBO // RIGHT ANGLE PIN PCB MOUNT

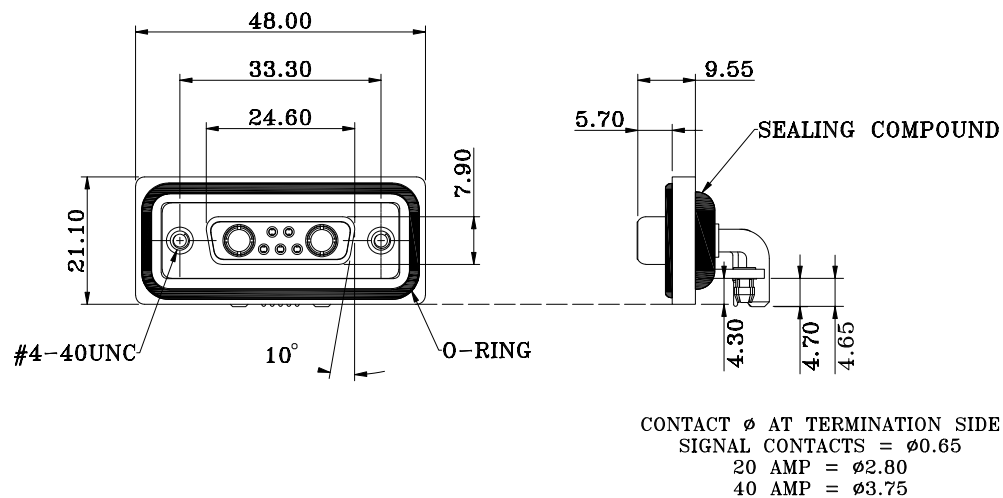

HARDWARE OPTIONS

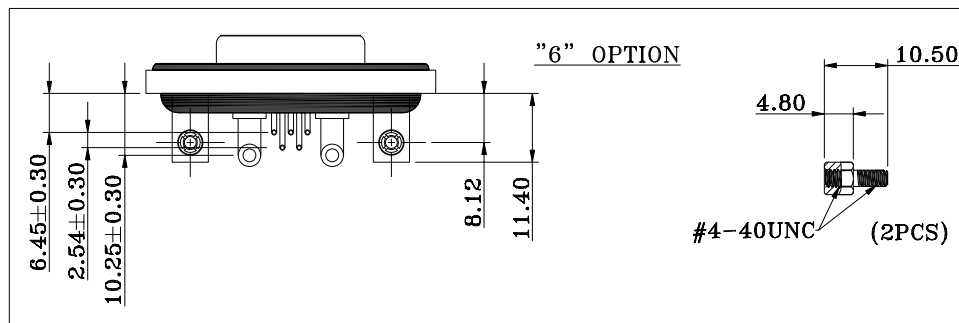
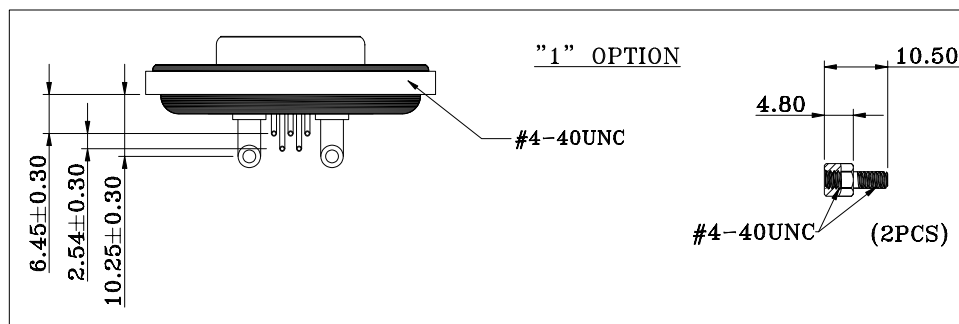

NOTE:

MATERIAL

HOUSING
FLANGE
CONTACT
SHELL
O-RING
SEALING COMPOUND
HARDWARE

PBT UL94V-0, BLACK
PBT UL94V-0, BLACK
BRASS, PLATING P/N KEY BELOW
STEEL, NICKEL
SILICONE
EPOXY
BRASS; NICKEL PLATED

ELECTRICAL

SIGNAL CONTACT RATED CURRENT 5A
POWER CONTACT RATED CURRENT P/N KEY BELOW
VOLTAGE 1000 VAC 1 MIN
INSULATOR RESISTANCE 5 GOhms MIN.
SIGNAL CONTACT RESISTANCE 10 mOhms MAX.
POWER CONTACT RESISTANCE 2.0 mOhms MAX.
WATER PROOF IP67

ENVIRONMENT

OPERATION TEMPERATURE -25°C TO +85°C

SERIES _____ CDFR7W2213LYYY
CDF = COMBO DSUB FLANGE
CONTACT TYPE _____
R = RIGHT ANGLE PCB MOUNT
POSITION _____
7W2
GENDER _____
2 = FEMALE
POWER CONTACT AMPERAGE _____
2 = 20 AMPS
4 = 40 AMPS
HARDWARE OPTIONS _____
1 = 4-40 THREADED INSERTS/4-40 JACKSCREWS
6 = 4-40 THREADED BRACKETS &
BOARD LOCKS/4-40 JACKSCREWS
CONTACT PLATING OPTIONS _____
1 = GOLD FLASH
2 = 30u" GOLD PLATING

RoHS COMPLIANT



THESE DRAWINGS AND SPECIFICATIONS ARE THE PROPERTY OF NorComp AND SHALL NOT BE REPRODUCED, COPIED OR USED AS THE BASIS FOR THE MANUFACTURE OR SALE OF APPARATUS WITHOUT WRITTEN PERMISSION.

DRAWN:

J. KADEL

DATE:

04/20/2020

TOLERANCES

X. ± 0.40
.X ± 0.30
.XX ± 0.20
.XXX ± 0.10

UNITS = mm

DO NOT SCALE FROM DRAWING

NorComp

SCALE:
NTS

SHEET OF
1 2

REV
1

DWG NO.

CDFR7W2213LYYY

**ø3.20MM HOLES NOT NEEDED FOR "1" HARDWARE OPTION

20 AMP CONFIGURATION

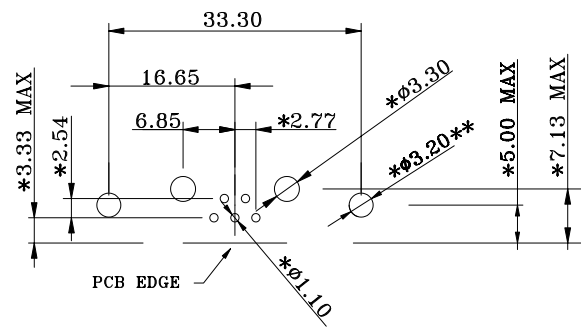

40 AMP CONFIGURATION

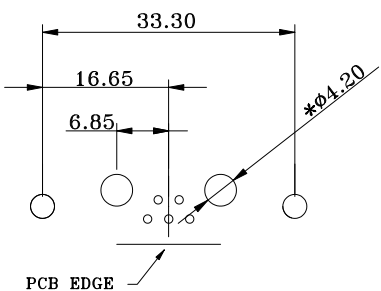

RECOMMENDED PCB LAYOUT

*TYPICAL // HOLE SIZE MAY NOT BE SUITABLE FOR YOUR SPECIFIC APPLICATION

RoHS COMPLIANT



THESE DRAWINGS AND SPECIFICATIONS ARE THE PROPERTY OF NorComp AND SHALL NOT BE REPRODUCED, COPIED OR USED AS THE BASIS FOR THE MANUFACTURE OR SALE OF APPARATUS WITHOUT WRITTEN PERMISSION.	DRAWN: J. KADEL
	DATE: 04/20/2020

TOLERANCES
X. ±0.40
.X ±0.30
.XX ±0.20
.XXX ±0.10

UNITS = mm

DO NOT SCALE FROM DRAWING

NorComp

SCALE: NTS	SHEET 2 OF 2	REV 1
DWG NO.	CDFR7W2213LYYY	