

NOTES:  
1) RUBBER GASKET  
2) ORDER PART #MJ-142

B MJ-142CP

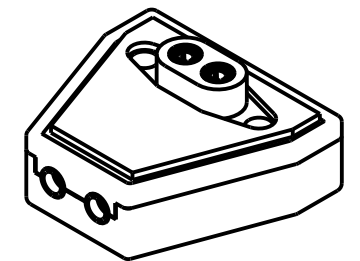
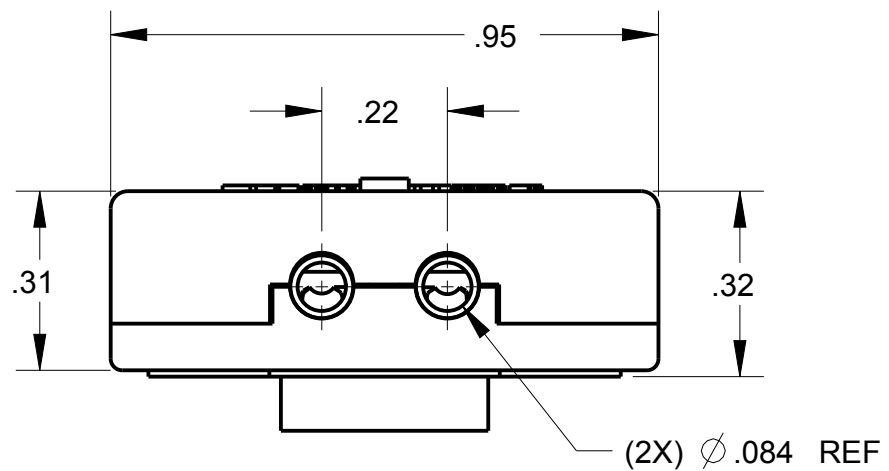
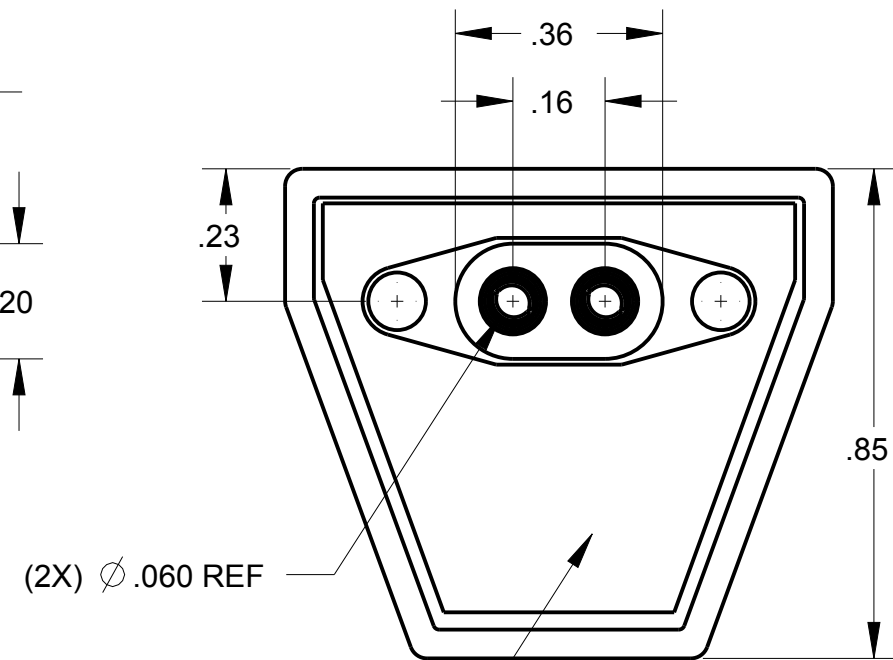
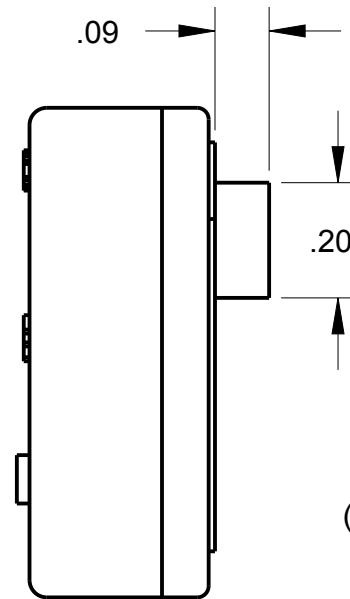
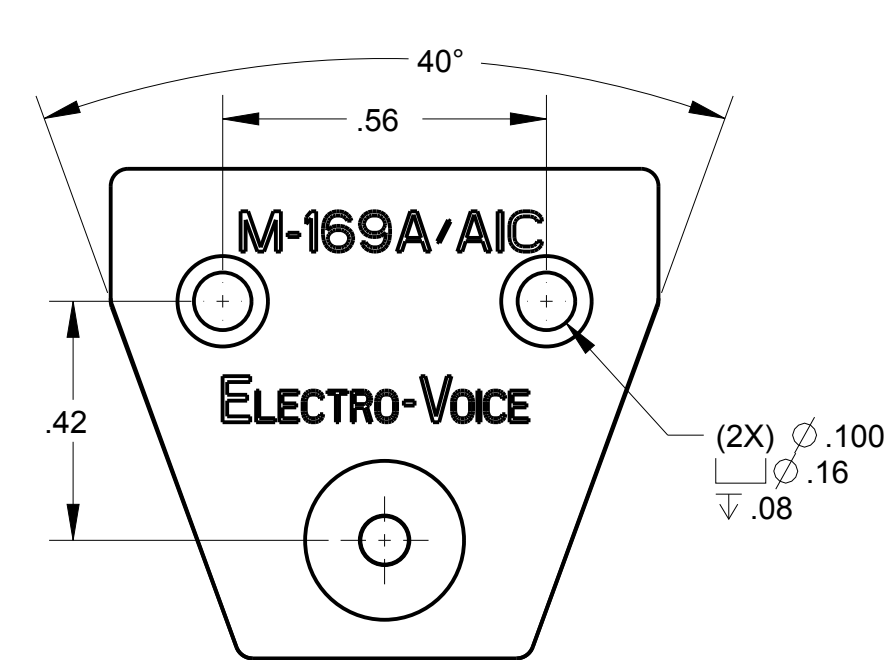

THIS DOCUMENT CONTAINS PROPRIETARY INFORMATION OF NEXUS, INCORPORATED AND SUCH INFORMATION MAY NOT BE DISCLOSED TO OTHERS FOR ANY PURPOSE OR USED FOR ANY PURPOSE WITHOUT THE WRITTEN CONSENT OF NEXUS.

A	NEW RELEASE	192	1/30 2014	HR
LET.	REVISION	CN #	DATE	CHK.

DWN.BY HR		DATE 1/30/14		MATERIAL					
CHECKED BY		DATE		FINISH					
APPR.BY		DATE		WEIGHT —		SCALE = 2.00 :1		NEXUS STAMFORD,CONN	
UNLESS OTHERWISE SPECIFIED: DIMENSIONS ARE IN INCHES &/OR [mm] TOLERANCES: DECIMAL: .XX[X.X] .XXX[X.XX] ± .0X[0.X] ± .00X[0.0X]  FRACTION: X/X X/XX ± X/XX  ANGLES: X ± .X°				TITLE 2 CONDUCTOR JACK ASS'Y					
				DO NOT SCALE DWG.		SHEET 1 OF 1		SIZE B	DWG. NO. MJ-142CP