

Rear panel feed-through - RC-17P1N8AC1X7 - 1601566

Please be informed that the data shown in this PDF Document is generated from our Online Catalog. Please find the complete data in the user's documentation. Our General Terms of Use for Downloads are valid (<http://phoenixcontact.com/download>)



Feed-through of rear wall, straight, shielded: yes, Screw locking, M23, No. of pos.: 17, type of contact: Pin, Crimp connection, Flat gasket, 4xM3, Panel thickness max.: 2.5 mm, cable diameter range: 4.5 mm ... 5.5 mm

RoHS

Key Commercial Data

| | |
|--------------|---|
| Packing unit | 20 pc |
| GTIN |  4 046356 235426 |
| GTIN | 4046356235426 |

Technical data

Data of the insulating body

| | |
|---|---|
| Note | Order information: Order crimp contacts Ø 1 mm separately |
| Coding | N |
| Contact connection method | Crimp connection |
| Type of contacts | Pin |
| Application | Signal |
| Number of positions | 17 |
| Contact diameter of power contacts | 1 mm |
| Nominal current per power contact at 25°C | 8 A |
| Nominal voltage, power contact | 150 V |
| Rated surge voltage | 1.5 kV |
| Overvoltage category | II |
| Degree of pollution | 3 |
| Overvoltage category | II |
| Degree of pollution | 3 |

Housing data

| | |
|------|---|
| Note | Order information: Order contact inserts and cable clamping/shield accessories separately |
|------|---|

Rear panel feed-through - RC-17P1N8AC1X7 - 1601566

Technical data

Housing data

| | |
|--|---------------|
| Housing material | Metal |
| Type of locking | Screw locking |
| Degree of protection (when plugged in) | IP67 |
| Thread type | M23 |

Cable seal data

| | |
|---------------------------|-------------------|
| Cable diameter | 4.5 mm ... 5.5 mm |
| Litz wire bundle diameter | 4.6 mm |

Environmental Product Compliance

| | |
|------------|---|
| REACH SVHC | Lead 7439-92-1 |
| China RoHS | Environmentally Friendly Use Period = 50 |
| | For details about hazardous substances go to tab "Downloads", Category "Manufacturer's declaration" |

Drawings

Schematic diagram

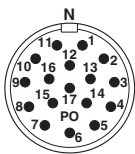

Dimensional drawing

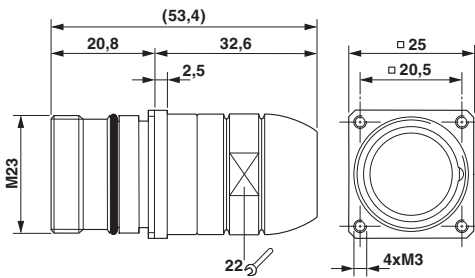

Approvals

Approvals

Approvals

EAC

Ex Approvals

Approval details

| | | |
|-----|--|---------|
| EAC | | B.01742 |
|-----|--|---------|

Phoenix Contact 2018 © - all rights reserved
<http://www.phoenixcontact.com>

PHOENIX CONTACT GmbH & Co. KG
Flachsmarktstr. 8
32825 Blomberg
Germany
Tel. +49 5235 300
Fax +49 5235 3 41200
<http://www.phoenixcontact.com>