

SECTION A-A
SCALE 1:1

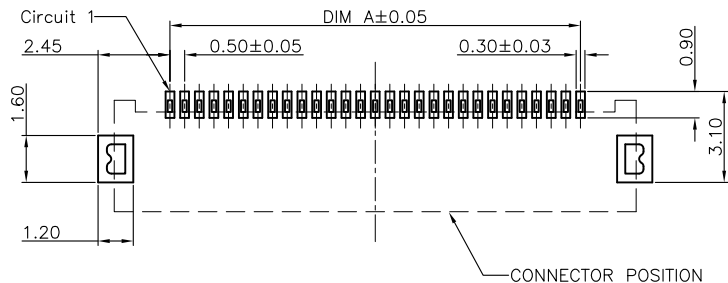

RECOMMENDED P.C.B. PATTERN LAYOUT

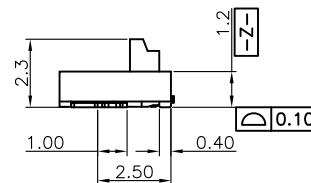
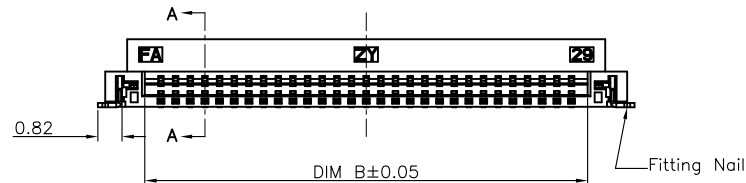
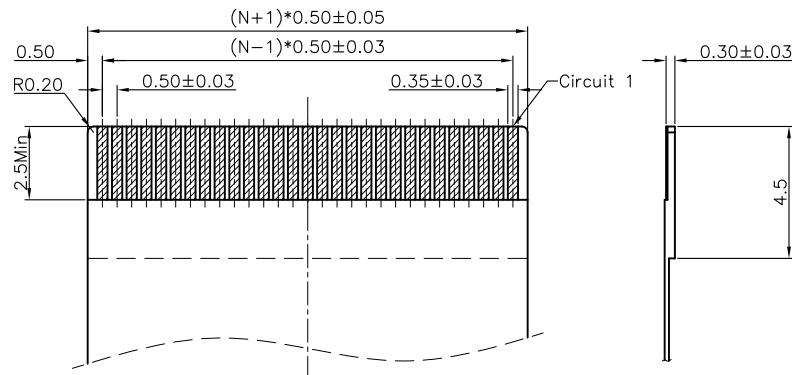

RECOMMENDED FPC/FFC DIMENSION

- Note:
- Material:
 - Housing: thermoplastic high temp.UL94V-0; Color: natural.
 - Latch: thermoplastic high temp.UL94V-0; Color: black.
 - Terminal: copper alloy.
 - Fitting Nail: copper alloy.
 - Finish:
 - Terminal:
 - 6:Gold Flash on contact and Matt tin on Solder area
 - Fitting Nail:
 - Underplating: matt Tin overall.
 - Product must comply HF RoHS specification.
 - Product No:

AFC34-S ** F * * - **

CKTS CONTACTS TYPE F:Lower

PLATING 6: Au1u" on contact and Tin on solder area

T:Gold 10u" On Contact area and gold flash on solder area

PACKING A:Tape&Reel C:Tube

REMARKS HF:Halogen free OZ:Without Logo

CKTS	DIM A	DIM B	DIM C	DIM D
4	1.50	2.60	5.80	5.30
5	2.00	3.10	6.30	5.80
6	2.50	3.60	6.80	6.30
7	3.00	4.10	7.30	6.80
8	3.50	4.60	7.80	7.30
9	4.00	5.10	8.30	7.80
10	4.50	5.60	8.80	8.30
11	5.00	6.10	9.30	8.80
12	5.50	6.60	9.80	9.30
13	6.00	7.10	10.30	9.80
14	6.50	7.60	10.80	10.30
15	7.00	8.10	11.30	10.80
16	7.50	8.60	11.80	11.30
17	8.00	9.10	12.30	11.80
18	8.50	9.60	12.80	12.30
19	9.00	10.10	13.30	12.80
20	9.50	10.60	13.80	13.30
21	10.00	11.10	14.30	13.80
22	10.50	11.60	14.80	14.30
23	11.00	12.10	15.30	14.80
24	11.50	12.60	15.80	15.30
25	12.00	13.10	16.30	15.80
26	12.50	13.60	16.80	16.30
27	13.00	14.10	17.30	16.80
28	13.50	14.60	17.80	17.30
29	14.00	15.10	18.30	17.80
30	14.50	15.60	18.80	18.30
31	15.00	16.10	19.30	18.80
32	15.50	16.60	19.80	19.30
33	16.00	17.10	20.30	19.80
34	16.50	17.60	20.80	20.30
35	17.00	18.10	21.30	20.80
36	17.50	18.60	21.80	21.30
37	18.00	19.10	22.30	21.80
38	18.50	19.60	22.80	22.30
39	19.00	20.10	23.30	22.80
40	19.50	20.60	23.80	23.30
41	20.00	21.10	24.30	23.80
42	20.50	21.60	24.80	24.30
43	21.00	22.10	25.30	24.80
44	21.50	22.60	25.80	25.30
45	22.00	23.10	26.30	25.80
46	22.50	23.60	26.80	26.30
47	23.00	24.10	27.30	26.80
48	23.50	24.60	27.80	27.30
49	24.00	25.10	28.30	27.80
50	24.50	25.60	28.80	28.30
51	25.00	26.10	29.30	28.80
52	25.50	26.60	29.80	29.30
53	26.00	27.10	30.30	29.80
54	26.50	27.60	30.80	30.30
55	27.00	28.10	31.30	30.80
56	27.50	28.60	31.80	31.30
57	28.00	29.10	32.30	31.80
58	28.50	29.60	32.80	32.30
59	29.00	30.10	33.30	32.80
60	29.50	30.60	33.80	33.30

CUSTOMER DRAWING

Tolerance Unspecified (未注公差)	Size(图幅): A4
0.0 ±0.15 0° ±5°	Unit(单位): MM
0.00 ±0.10 0°0 ±3°	Scale(比例): 1:1
0.000 ±0.05 0°0.00 ±1°	Page(页数): 1 OF 1
Project View (投影视角)	Rev(版本): C

浙江创都电子科技有限公司

Product Name(产品名称): 0.5Pitch H=1.2 FPC Back-Flip R/A Type1 SMT CONN		
Product No(产品料号): CAX-AFC34- **XIB-H1.2		
Designer(设计):	Checked(审核):	Approved(核准):

Rev	Change Description	Date	Revisor
版本	变更内容	日期	制/修订人
C	新增电镀规格	2019/02/20	
B	更新电镀	2018/05/21	
A	初版发行	2016/04/15	

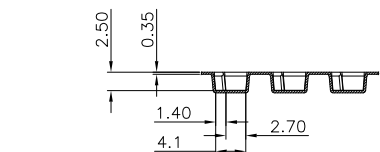
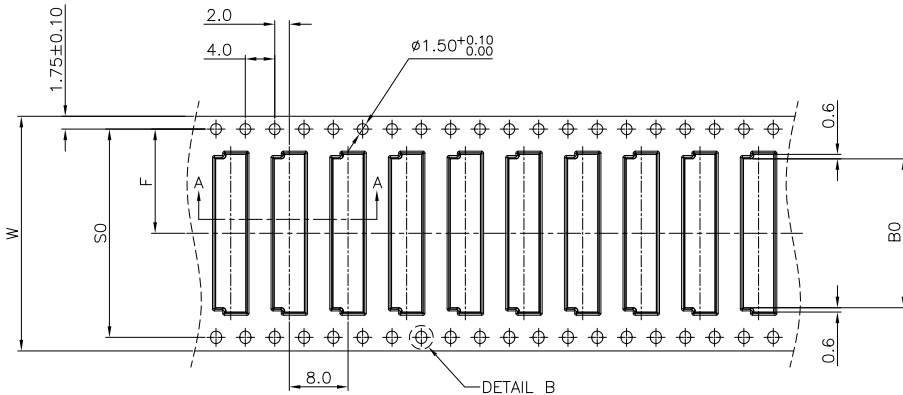
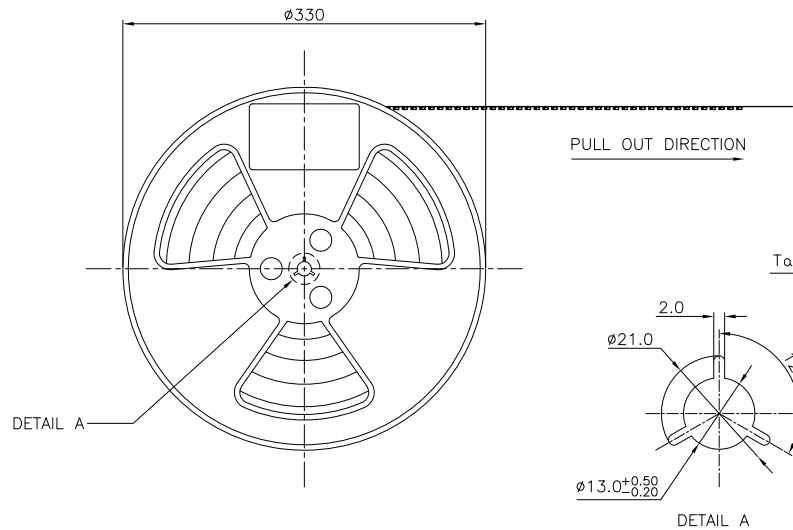
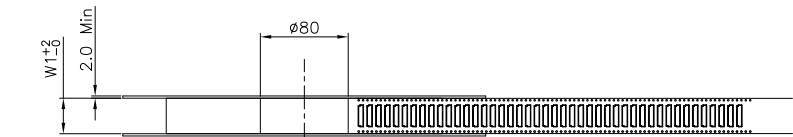

SECTION A-A
SCALE 1:1

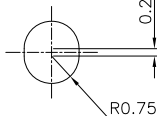

DETAIL B
SCALE 5:1

NOTES:

1. 10 SPROCKET HOLE PITCH CUMULATIVE TOLERANCE. $\pm 0.20\text{mm}$
2. CARRIER CAMBER NOT TO EXCEED 1mm IN 250mm.
3. ALL DIMENSIONS MEET EIA-481-C REQUIREMENTS.
4. MATERIAL: BLACK ANTI-STATIC POLYSTYRENE.
5. THICKNESS: $0.35 \pm 0.05\text{ mm}$.
6. PACKING LENGTH PER 13" REEL: 24.60METERS.
7. COMPONENT LOAD PER 13" REEL: 3000PCS
8. PEELING OFF FORCE OF TOP TAPE $0.1\text{N} \sim 0.7\text{N}$ ($10.2\text{gf} \sim 71.4\text{gf}$).

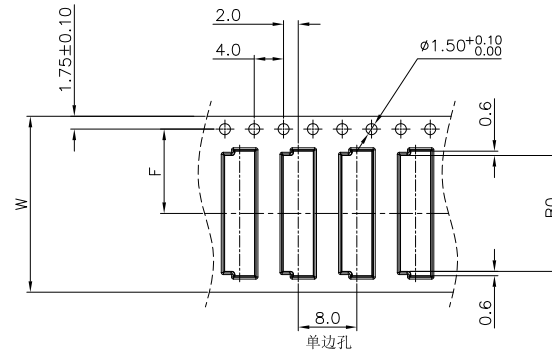
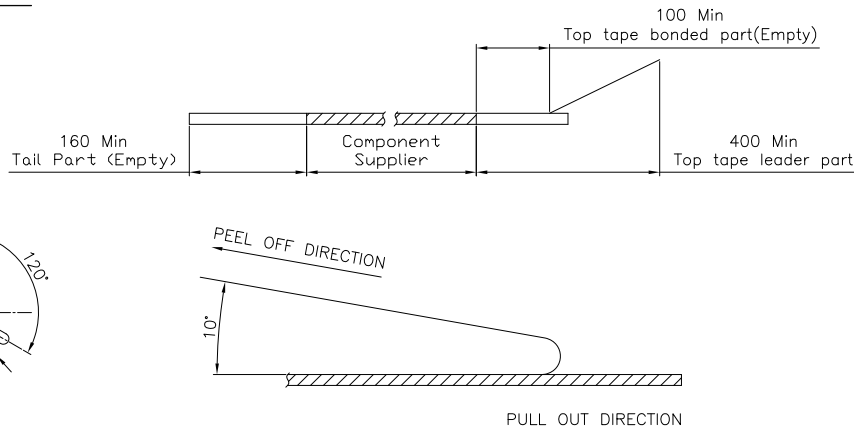

CKTS	B0±0.10	W	W1	F	S0±0.10
4	5.30	16+0.3/-0	16.4	7.5±0.10	单边孔
5	5.80				
6	6.30				
7	6.80				
8	7.30				
9	7.80	24+0.3/-0	24.4	11.5	单边孔
10	8.30				
11	8.80				
12	9.30				
13	9.80				
14	10.30				
15	10.80				
16	11.30				
17	11.80				
18	12.30				
19	12.80	32±0.30	32.4	14.2±0.10	单边孔
20	13.30				
21	13.80				
22	14.30				
23	14.80				
24	15.30				
25	15.80				
26	16.30				
27	16.80				
28	17.30				
29	17.80	44±0.30	44.4	20.2±0.15	单边孔
30	18.30				
31	18.80				
32	19.30				
33	19.80				
34	20.30				
35	20.80				
36	21.30				
37	21.80				
38	22.30				
39	22.80	56±0.30	56.4	26.2±0.15	单边孔
40	23.30				
41	23.80				
42	24.30				
43	24.80				
44	25.30				
45	25.80				
46	26.30				
47	26.80				
48	27.30				
49	27.80	60±0.30	60.4	32.2±0.15	单边孔
50	28.30				
51	28.80				
52	29.30				
53	29.80				
54	30.30				
55	30.80				
56	31.30				
57	31.80				
58	32.30				
59	32.80				
60	33.30				

CLASSIFICATION DIMENSION(尺寸类别):			
FAI(首次检验): ☉To ☉			
■ MARK IS MAJOR DIM(重点尺寸标示)			
⊙ MARK IS CRITICAL DIM(Cpk&Cp标示)			
Tolerance Unspecified (未注公差)		Size(图幅): A4	
0.0 ±0.10 0° ±3°		Unit(单位): MM	
0.00 ±0.05 0°0' ±2°		Scale(比例): 1 : 1	
0.000 ±0.02 0°0'00" ±1°		Page(页数): 1 OF 1	
Project View (投影视角)		Rev(版本): 1.0	
			

浙江创都电子科技有限公司

Product Name (产品名称):		
0.5Pitch H=1.2 FPC 后压卧式1代SMT型. 载带		
Product No (产品料号):		
EB-410XXX250-00		
Drawing No (图面编号):		Date (日期):
DNE00071-1		2013/06/14
Designer (设计):	Checked (审核):	Approved (核准):

1.0	初版发行	2013/06/14	Allan
Rev	Change Description	Date	Revisor
版本	变更内容	日期	制/修订人