

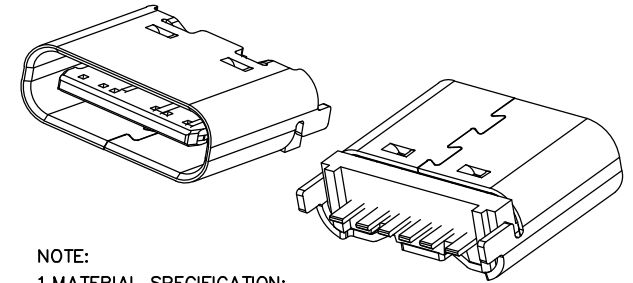

| REV. | ECN NO OR DESCRIPTION | REVISED | DATE |
|------|-----------------------|---------|------|
| | | | |
| | | | |

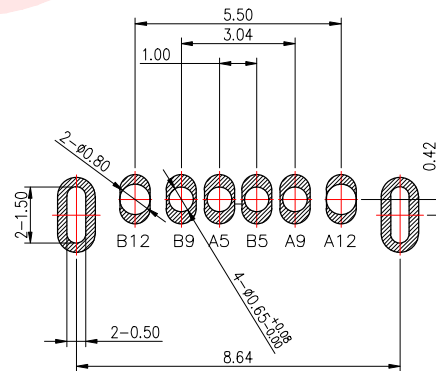
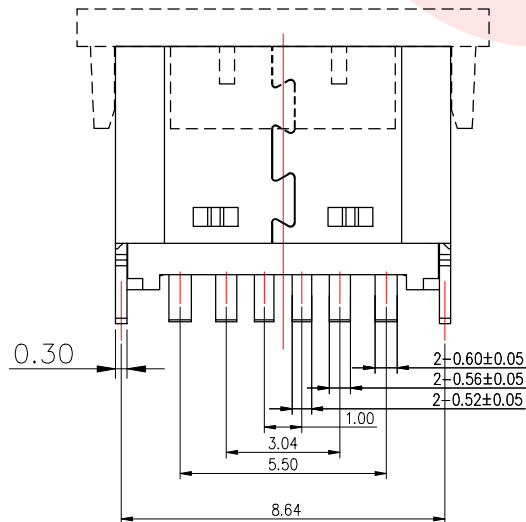
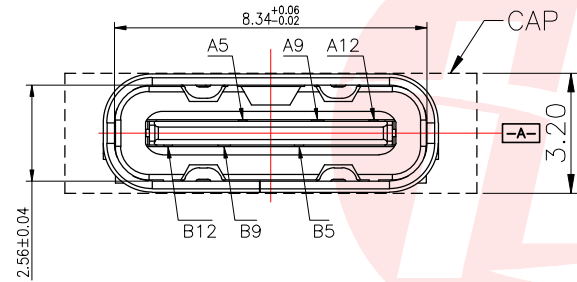
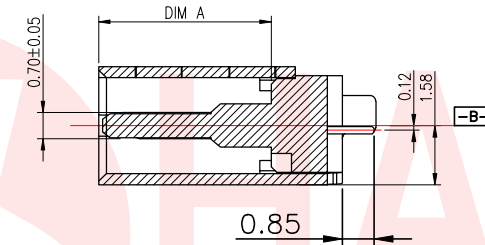
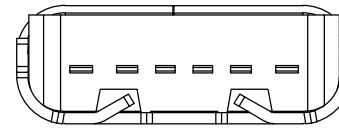
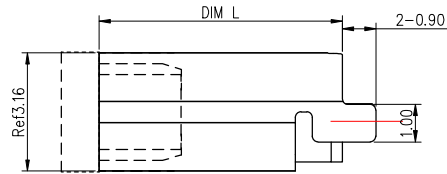
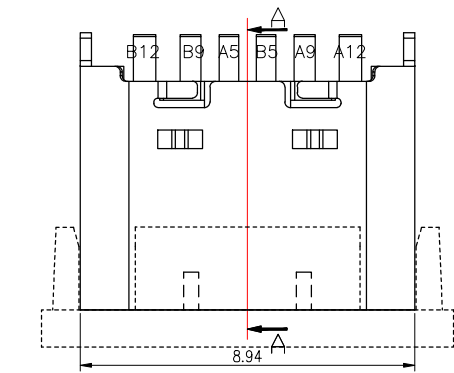

NOTE:

- MATERIAL SPECIFICATION:
 - HOUSING: HIGH TEMPERATURE RESISTANT PLASTIC, UL94 V-0.
 - CONTACTS: COPPER ALLOY
 - MID-PLATED/SHELL: STAINLESS STEEL
- PLATING SPECIFICATION:
 - CONTACTS:
Ni 50u" MIN. UNDER PLATED OVER ALL.
Au PLATED ON THE FUNCTIONAL AREA OF CONTACT.
(GOLD PLATING THICKNESS FOLLOW THE P/N)
GOLD FLASH PLATING ON SOLDER AREA
 - FRONT SHELL:
Ni 30u" MIN. UNDER PLATED OVER ALL.
- MECHANICAL PERFORMANCE,
 - INSERTION FORCE: 0.5~2.0kgf.
 - REMOVAL FORCE: 0.8kgf~2.0kgf.
 - DURABILITY: 10000 CYCLES.
- ELECTRICAL PERFORMANCE,
 - CURRENT RATING: 5.0A
VOLTAGE RATING: 20V
 - INSULATION RESISTANCE: 100MΩ MIN
 - DIELECTRIC WITHSTAND VOLTAGE, AC 100V FOR 1 MINUTE.
 - LOW CONTACT RESISTANCE: INITIAL 40MΩ /AFTER 50MΩ
- ENVIRONMENTAL PERFORMANCE:
 - OPERATING TEMPERATURE: -30°C~+80°C.
- IR REFLOW:
THE PEAK TEMPERATURE ON THE BOARD SHALL
BE MAINTAINED FOR 10 SECONDS AT 260°C.

USB TYPE-C PIN ASSIGNMENTS

| PIN NUMBER | SIGNAL NAME |
|------------|-------------|
| A5 | CC1 |
| A9 | VBUS |
| A12 | GND |
| B12 | GND |
| B9 | VBUS |
| B5 | CC2 |

| | | |
|--------------|---|------|
| MC-305LD-L68 | L | 6.80 |
| MC-305LD-L65 | L | 6.50 |

UNLESS OTHERWISE
SPECIFIED TOLERANCES

DECIMALS: ANGLES:
X :±0.35 X :±2°
X.X :±0.25 X.X :±1°
X.XX :±0.15



东莞市汉博电子科技有限公司
DONGGUAN HANBO TECHNOLOGY CO., LTD

| | | | | |
|-------|-----------------------------|------------------------|-------------|---|
| TITLE | TYPE C 6PIN 立式插板DIP 6.5&6.8 | | | |
| DWN | xiong | PART NO. MC-305LD-LXXX | | |
| CHKD | lee | SCALE:1:1 | UNIT: mm |  |
| APVD | wang | SIZE: A4 | SHEET:1OF 1 | REV: A4 |

CUSTOMER COPY

RECOMMEND P.C.B LAYOUT (COMPONENT SIDE)
TOLERANCE FOR PCB LAYOUT IS ± 0.05



| REV. | ECN NO OR DESCRIPTION | REVISED | DATE |
|------|-----------------------|---------|------|
| | | | |
| | | | |

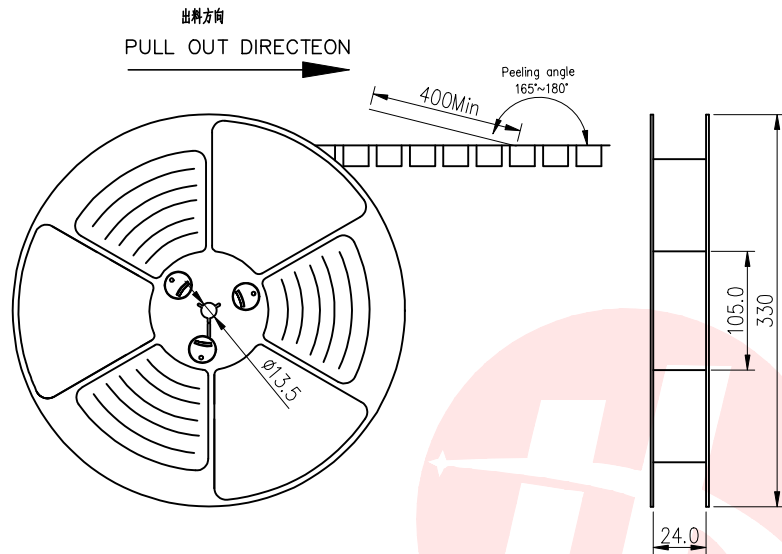

NOTES

1. 帶子引導長度

LEAD TAPE LENGTH

出料方向
PULL OUT DIRECTEON

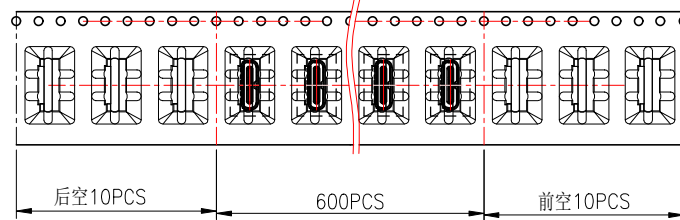

2. 上帶 剝力力為: 0.1~1.3N(10.2gf~130gf)

PEELING OFF FORCE OF TOP TAPE:0.1~1.3N(10.2gf~130gf)

出貨'運輸過程中一定注意:

THIS REQUIREMENT SHOULD BE APPLIED AT SHIPMENT:

卷帶在運輸過程中不能散開

PEELING OFF SHOULD NOT BE ALLOWED DURING TRANSPORTATION

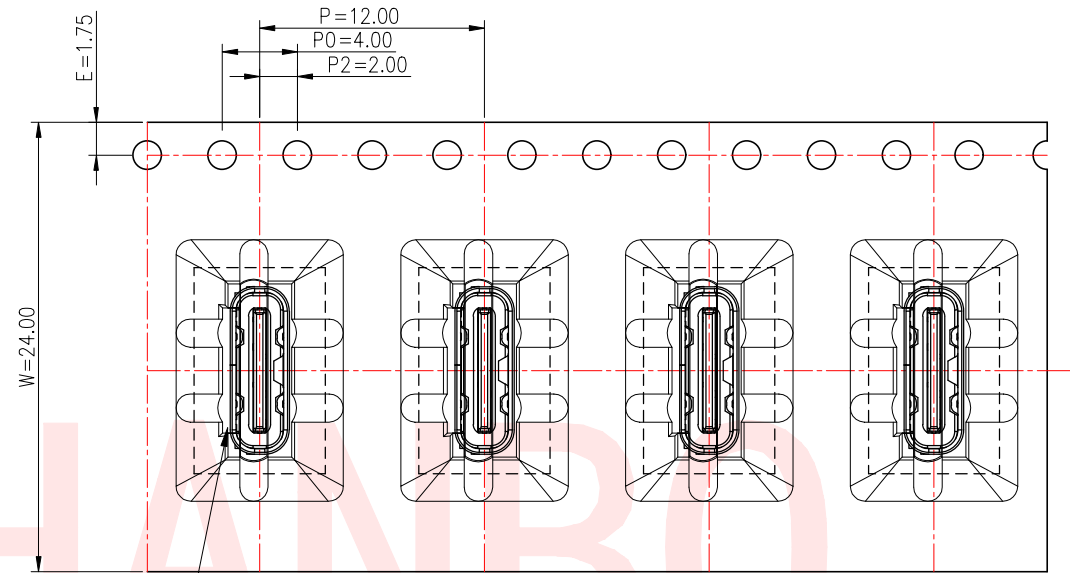

焊脚插左

TAPE & REEL 10 PCS

1 REEL
= 600 PCS

BOX

DIMENSIONS:
33.5X33.5X30.5

LABEL

1 CARTON
=10 REELS
=6000 PCS

UNLESS OTHERWISE
SPECIFIED TOLERANCES

DECIMALS: ANGLES:
X :±0.30 X :±2°
X.X :±0.20 X.X :±1°
X.XX :±0.10



东莞市汉博电子科技有限公司
DONGGUAN HANBO TECHNOLOGY CO., LTD

| | | | | |
|-------|-----------------------------|------------------------|-------------|---|
| TITLE | TYPE C 6PIN 立式插板DIP 6.5&6.8 | | | |
| DWN | xiong | PART NO. MC-305LD-LXXX | | |
| CHKD | lee | SCALE:1:1 | UNIT: mm |  |
| APVD | wang | SIZE: A4 | SHEET:10F 1 | REV: A4 |

CUSTOMER COPY