

SECTION

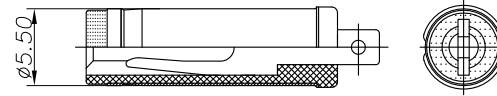

DC MATE PLUG

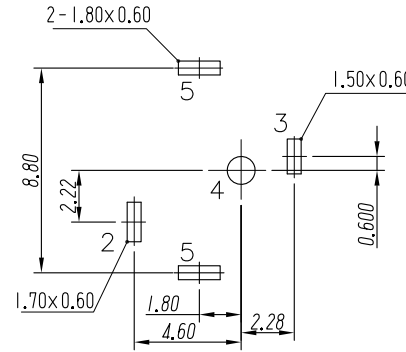

P.C.B LAYOUT
TOP VIEW

SCHEMATIC

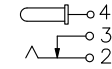

SPECIFICATION

- 1.Rating : DC 20V 6A;
- 2.Contact resistance: $\leq 0.03\Omega$;
- 3.Insulation resistance: $\geq 100M\Omega$ (DC250V);
- 4.Withstand voltage: 500VAC ;
- 5.Insertion and extraction force: 3-30N;
- 6.life test: 5,000 cycles.

6	SPRING PIECE	1	SUS301	—	—
5	COAT	1	IRON T=0.3	—	Ni-Plating
4	PIN	1	Copper needle	—	Ni-Plating
3	CONTACT FOOT	1	BRASS T=0.4	—	Ag-Plating
2	SPRING PIECE	1	BRONZE T=0.3	—	Ag-Plating
1	HOUSING	1	PA9T	—	—
NO.	DESCRIPTION	QTY	MATERIAL	COLOR	REMARK

GENERAL TOLERANCES			
0.X	±0.30	X°	±3°
0.XX	±0.20		
0.XXX	±0.10	X.X°	±1°
UNIT	SIZE	SCALE	
MM	A4	1:1	

DRAWN	
DESIGN	
CHECKED	
APPROVED	

C	TITLE: DC-JACK
PART NO.	DC-0304-6A-**
PRODUCT NO.	
DRAWING NO.	
UNIT: mm	SCALE: 1:1 REV:01-1 SHT:10F1

浙江创都电子科技有限公司

ECN NO.	REV	DATE	DESCRIPTION	MDF'D	APP'D
	01	2022.09.22	NEW DRAWING RELEASE		