

RoHS

Rated Current:3.0AMP

Contact Resistance:20mΩ Max

Withstand Voltage:1000V AC/DC

Insulation Resistance:1000MΩ Min

Operation Temperature:−40°c to +105°c

Contact Material:Brass

Contact Plating:Au 0.5u”min Over Ni20u”−50U”

Insulator Material:Polyester(UL94V−0)

Standard: PA6T

Max.Processing Temp: 230°C for 30−60 seconds
(260°C for 10 seconds)

Recommended P.C.B Layout(Top Side)
(PCB BOARD TOLERANCE±0.05)

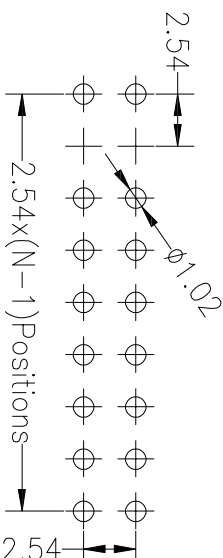
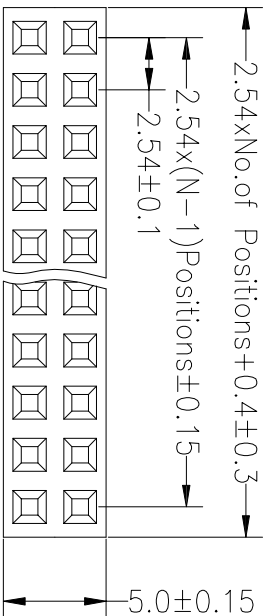

空: 5, 6, 7, 8P

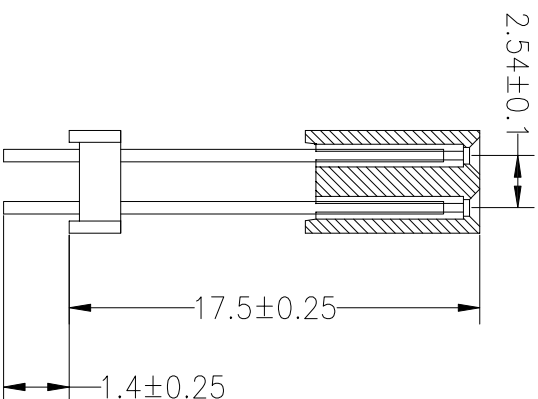
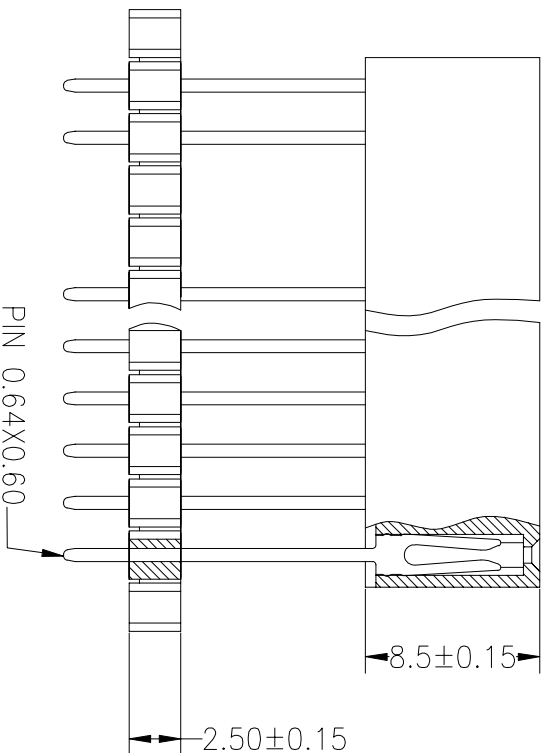

REV	DATE	MODIFICATION DESCRIPTION	CHANGE	OPERATION		DRAW	SCALE		FIT	PART NO.	TITLE:
				DIM	TOL		UNIT	mm			
A0	2012.10.08	NEW DRAWING		X.XX	±0.30	CHECK	SIZE	A4	1/1	1020300611	2.54FH 2H=8.5+2.5 2x13pin 空5-8P
REV	DATE	MODIFICATION DESCRIPTION	CHANGE	Angle	±3°	APPROVE	SHEET	1/1	PROJ.		180°PC104端 PB17.5 PC1.4

深圳市连盛精密连接器有限公司