

REV	REV NO	REV DESCRIPTION	SIGNATURE	DATE
				2025.09.08

技术指标:

1. 塑件表面应光洁、无毛边、无明显收缩、缺陷、裂纹等现象。
2. 温度范围: $-25^{\circ}\text{C}\sim 85^{\circ}\text{C}$.
3. 额定电压: 100V, AC/DC.
4. 接触电阻: $\leq 20\text{m}\Omega$.
5. 绝缘电阻: $\geq 1000\text{M}\Omega$.
6. 额定电流: 2A, AC/DC.

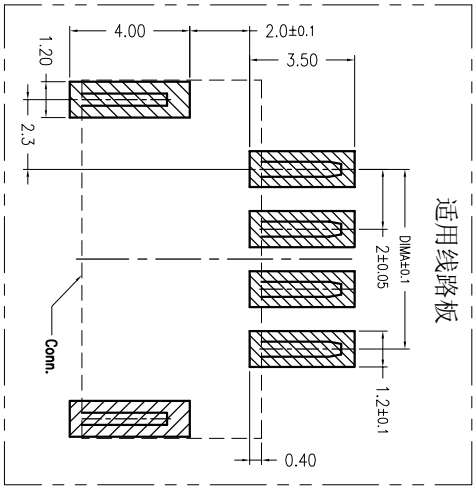
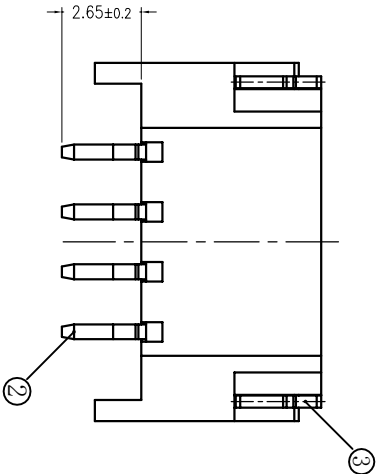
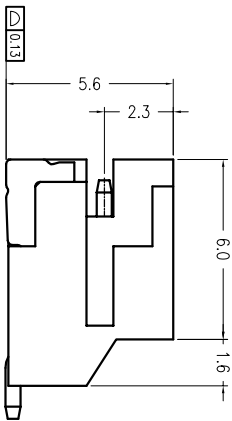
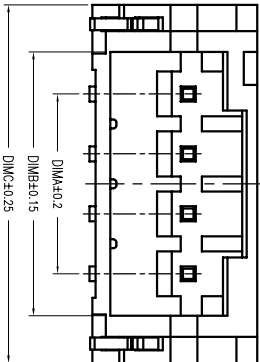
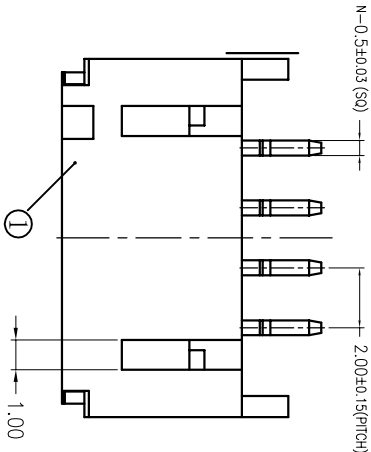

序号	项目	描述	备注
1	塑胶	ULP	
2	端子	黄铜	
3	薄片	黄铜	

CKT	Dim A	Dim B	Dim C
2	2.00	4.80	7.95
3	4.00	6.80	9.95
4	6.00	8.80	11.95
5	8.00	10.80	13.95
6	10.00	12.80	15.95
7	12.00	14.80	17.95
8	14.00	16.80	19.95
9	16.00	18.80	21.95
10	18.00	20.80	23.95
11	20.00	22.80	25.95
12	22.00	24.80	27.95
13	24.00	26.80	29.95
14	26.00	28.80	31.95
15	28.00	30.80	33.95
16	30.00	32.80	35.95
17	32.00	34.80	37.95
18	34.00	36.80	39.95
19	36.00	38.80	41.95
20	38.00	40.80	43.95



深圳市 华德共创科技有限公司
Shenzhen Huade co-create Technology Co., LTD
电话: 0755-27111216 传真: 0755-29940187

-TOLERANCES-
公差参数表

		APPD:	核准:	产品编号:	DATE	SCALE	UNIT	CODE	NUMBER
X.X	±0.30	X.X*	±3°						
X.XX	±0.20	X.XX*	±2°						
X.XXX	±0.10	X.XXX*	±1°						



TITLE:
产品名称: PH2.0针座贴片

A

B

C

D

E

F

8

7

6

5

4

3

2

1

A

B

C

D

E

F

1

2

3

4

5

6

7

8