

RoHS

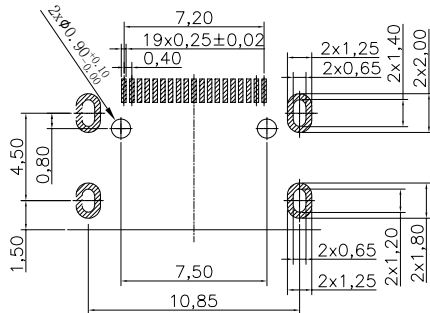
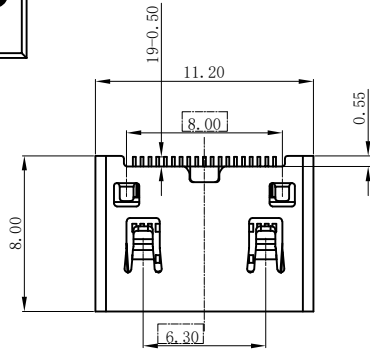

RECOMMENDED PCB LAYOUT

GENERAL TOLERANCES:±0.05

REV.	DESCRIPTION.	ECN NO.	DWG.	CKD.	APPD.	DATE.
A	NEW		Jack	Larry	J.L.Y	2025-05-14

- NOTES:
- 1.ELECTRONIC:
CONTACT RESISTANCE: 30mohm MAX
INSULATION RESISTANCE: 100 Mohm MIN
WITHSTAND VOLTAGE:AC 500V,1min.
 - 2.MECHANICAL:
DURABILITY: 10000 CYCLE.
 - 3.ENVIRONMENT CHARACTERISTICS:
OPERTING TEMPERATURE:-55°C TO +105°C
 - 4.RECOMMANDER PCB THICKNESS 1.00MM

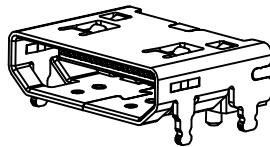
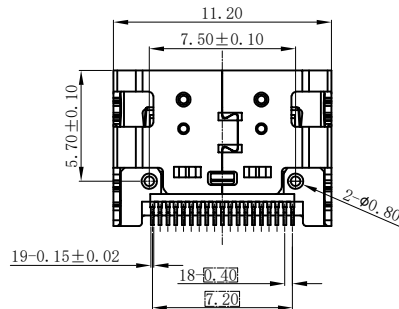
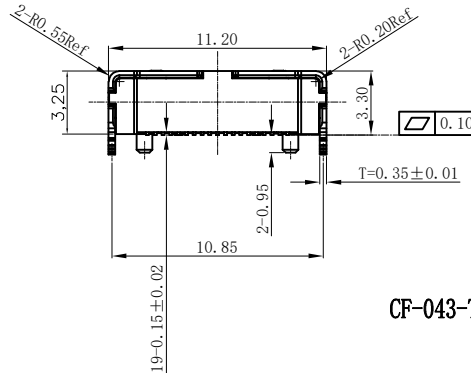
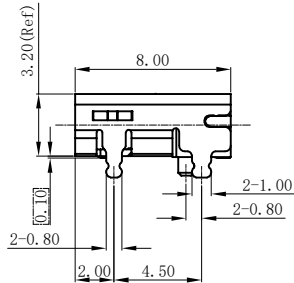
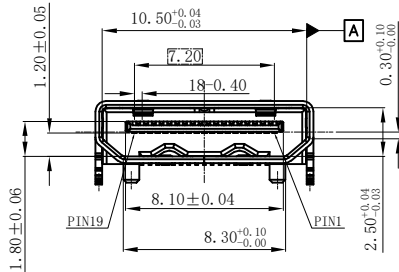

CF-043-T171B X	X	XXX	WR
外壳材质	外壳电镀要求	产品盐雾要求	
S: 铁材	E: 外壳镀镍	12H: 盐雾12H	
T: 不锈钢	G: 外壳镀金	24H: 盐雾24H	
C: 铜壳	N: 无外壳	48H: 盐雾48H	
E: 无外壳	A: 外壳镀金0.8u"	72H: 盐雾72H	
	B: 外壳镀金3u"	如无盐雾要求则不需标示	
	C: 外壳镀金0.6u"		
	D: 外壳镀雾锡		
	F: 外壳镀金1u"		

3	SHELL	1	C2680-H T=0.35	AU PLATED
2	CONTACT	19	COPPER ALLOY T=0.15	AU PLATED
1	HOUSING	1	THERMOPLASTIC(LCP)	(UL 94V-0) BLACK
No.	PART NAME	QTY	MATERIAL	REMARK

TOLERANCES UNLESS OTHERWISE SPECIFIED		东莞市辉焕精密有限公司			
UNIT (MM) X. ±0.55 X.X ±0.35 X.XX ±0.25 X.XXX ±0.15 ANGEL ±2'	ORIGINAL DATA 2025-05-14	TITLE HD CF SMT H3.25 不锈钢镀镍			
	DWG. Jack				
	CKD. Larry	PART NO. HDMI-CF043-H3.25	SCALE 1:1	SIZE A4	
	APPD. J.L.Y	DWG NO. HDMI-CF043-H3.25	SHEET 1/2	REV. A	



RoHS

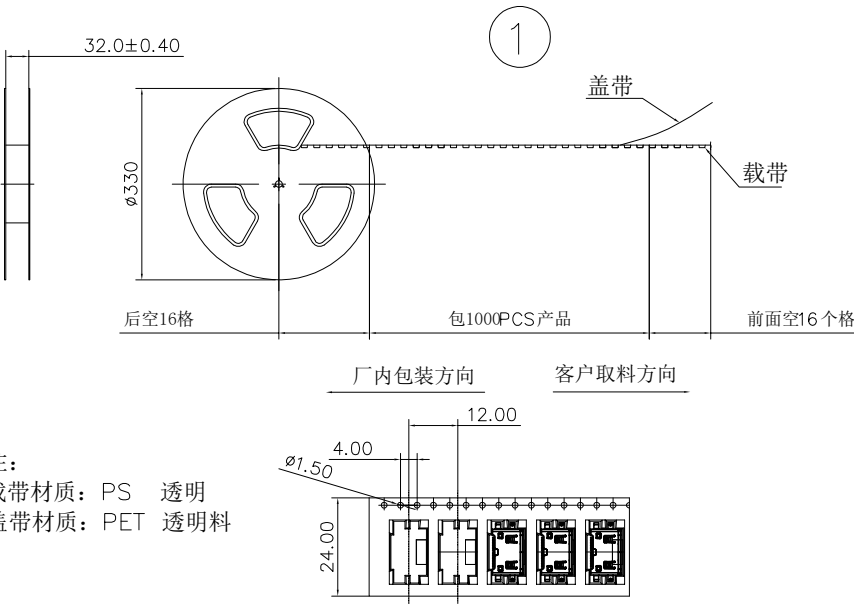

备注：
1. 载带材质：PS 透明
2. 盖带材质：PET 透明料

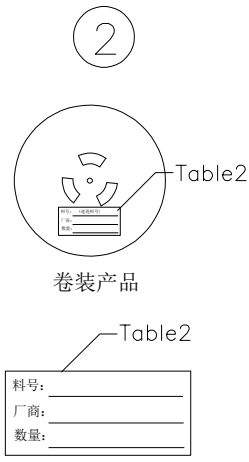

2 每卷贴上内标签（如图如示）

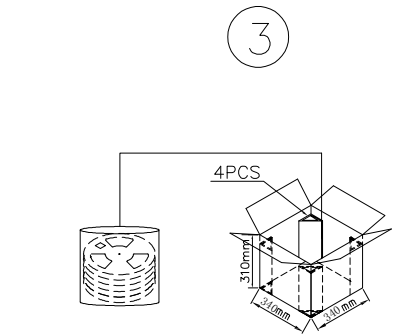

3-1. 将10盘装入PE胶袋,再放入纸箱中。
3-2. 纸箱4个角落用缓冲材料塞好,并盖上与之相配的纸板
备注: 纸箱的规格: 340*340*310(mm)
PE胶袋的规格: (长) 650mm* (宽) 620mm* (厚) 0.05mm
3-3. 包装明细:

盘/每箱	PCS/每盘	PCS/每箱
10盘/每箱	1KPCS/每盘	10KPCS/每箱

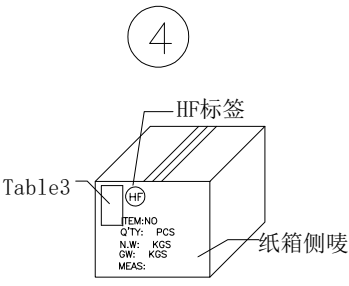

4-1 纸箱开口处以透明胶带贴合。
4-2 若有未装满的零数箱,必须以缓冲材塞
4-3. 产品外包装标签贴法:(如上图)。

TOLERANCES UNLESS OTHERWISE SPECIFIED		东莞市辉焕精密有限公司			
UNIT (MM) X. ±0.55 X.X ±0.35 X.XX ±0.25 X.XXX ±0.15 ANGEL ±2'	ORIGINAL DATA 2025-05-14		TITLE HDMI C FEMALE SMT H3.25 无Logo 包装规范		
	DWG. Jack				
	CKD. Larry		PART NO. HDMI-FC043-H3.25	SCALE 1:1	SIZE A4
	APPD. J.L.Y		DWG NO. HDMI-CF043-H3.25	SHEET 2/2	REV. A