

PIN ASSIGNMENTS

A5	CC1	B12	GND
A9	VBUS	B9	VBUS
A12	GND	B5	CC2
PIN	SIGNAL NAME	PIN	SIGNAL NAME

L	L=6.8
L	L=6.5

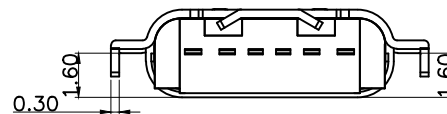
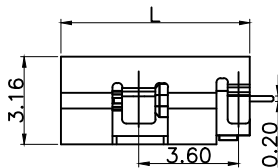

REV.	ZONE	DESCRIPTION	DESIGN	DATE
B		NEW		

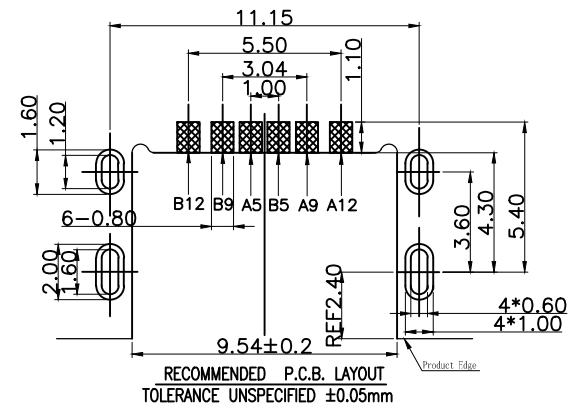

NOTE:

1.MATERIAL SPECIFICATION:

- 1.HOUSING:HIGH TEMPERATURE RESISTANT PLASTIC,UL94 V-0.
- 2.CONTACTS:COPPER ALLOY
- 3.MID PLATE: STAINLESS STEEL
- 4.FRONT SHELL: STAINLESS STEEL

2.PLATING SPECIFICATION:

2-1.CONTACTS:

- NI 50u" MIN. UNDER PLATED OVER ALL.  
Au PLATED ON THE FUNCTIONAL AREA OF CONTACT.  
(GOLD PLATING THICKNESS FOLLOW THE P/N)  
PLATING SPECIFICATIONS OF THE SOLDER AREA FOLLOW THE P/N

2-2.FRONT SHELL:

SEE TABLE1.

2-3.SHIELD PLATE&EMI PLATE:

CLEAR ONLY

3.MECHANICAL PERFORMANCE.

- 3-1.INSERTION FORCE: 0.5~2.0kgf.
- 3-2.REMOVAL FORCE: 0.8kgf~2.0kgf.
- 3-3.DURABILITY: 5000 CYCLES.

4.ELECTRICAL PERFORMANCE.

- 4-1. CURRENT RATING:3.0A  
VOLTAGE RATING:5.0V
- 4-2. ILCR:  
VBUS & GND PINS AND OTHER PINS: 40mΩ/PIN MAX.  
SHIELD: 50mΩ/MAX.  
ILCR MAX. CHANGE OF ALL PINS: 10mΩ.
- 4-3.INSULATION RESISTANCE: 100MΩ MIN
- 4-4.DIELECTRIC WITHSTAND VOLTAGE,AC 100V FOR 1 MINUTE.

5. ENVIRONMENTAL PERFORMANCE:

OPERATING TEMPERATURE: -25°C~+85°C.

6.IR REFLOW:

THE PEAK TEMPERATURE ON THE BOARD SHALL  
BE MAINTAINED FOR 10 SECONDS AT 260°C.

X.	±0.50	X.*	± 2°	UNITS	
.X	±0.30	.X*	± 1°	mm	
.XX	±0.10	.XX*	± 0.5°	MAT'L	
.XXX	± 0.05				
				FINISH	
				Q'TY	

深圳市富港科技有限公司

TITLE:

TYPE-C 6PIN 沉板1.6MM四脚插板SMT母座

APPD:

DWG NO.:

CHKD:

DR:

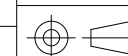

SCALE SHEET REV.  
1/1 1/1 A1



REV.	ZONE	DESCRIPTION	DESIGN	DATE
B		NEW		

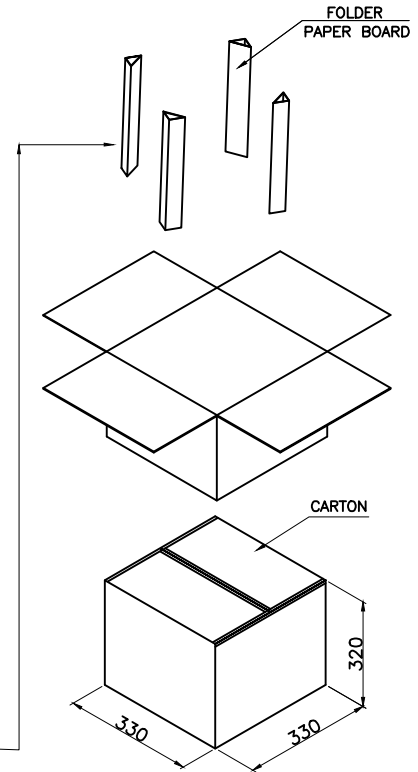
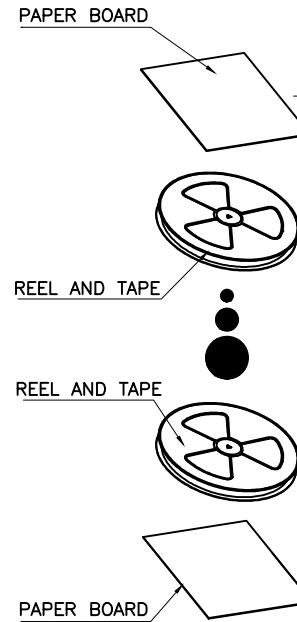
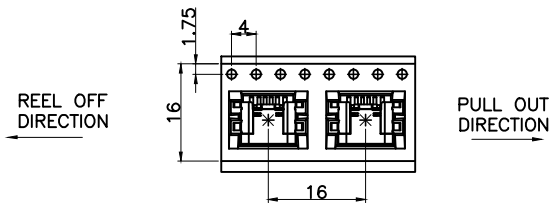
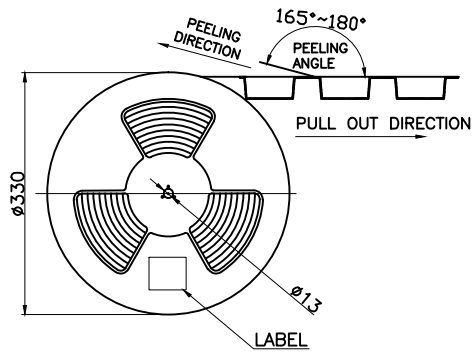
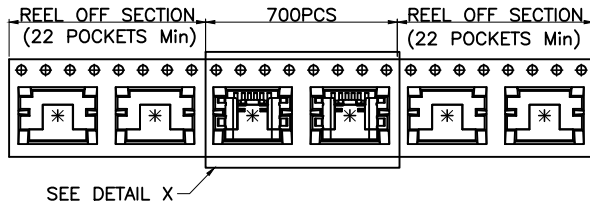

	REEL	CARTON
CONNECTOR (PCS)	1000	10000

X: ±0.50	X.* ± 2°	UNITS	深圳市富港科技有限公司		
.X ±0.30	.X* ± 1°	mm			
.XX ±0.10	.XX* ± 0.5°	MAT'L	TITLE:		
.XXX ± 0.05			TYPE-C 6PIN 沉板1.6MM四脚插板SMT母座		
		FINISH	APPD:	DWG NO.:	
		Q'TY	CHKD:		
			DR:		
				SCALE	SHEET
				1/1	1/1
				REV.	A1