

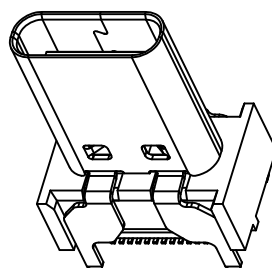

RoHS
Compliant

REV.	ZONE	DESCRIPTION	DESIGN	DATE
B		NEW		

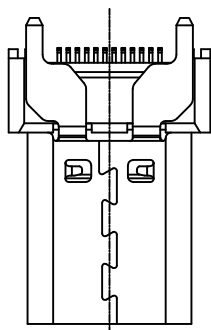

WITHOUT COVER

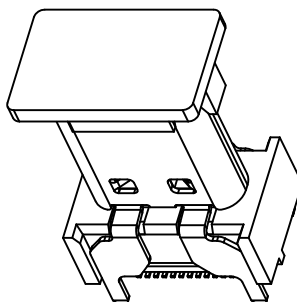

WITH COVER

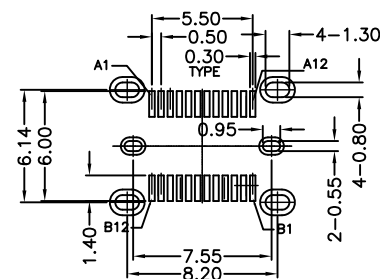

RECOMMEND P.C.B LAYOUT(COMPONENT SIDE)

TOLERANCE FOR PCB LAYOUT IS ± 0.05

KEEP OUT AREA

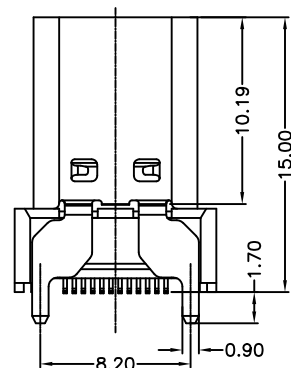
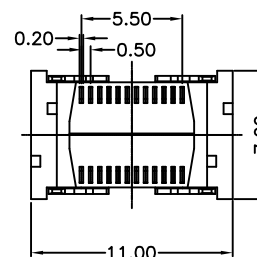
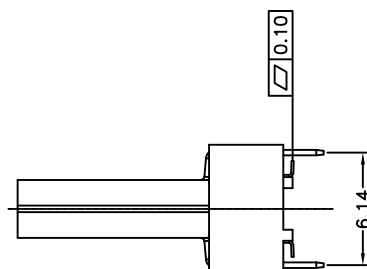
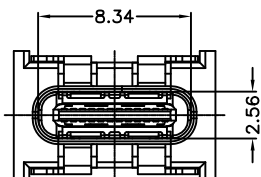

- 1.Contact Resistance:40mOHM Max.;
- 2.Dielectric Withstanding Voltage:100V AC For 1 Minute;
- 3.Insulation Resistance:100M OHM Min.;
- 4.Mating And unmating Force:
Mating Force: 5~20N
Unmating Force: 8~20N(0~1000cycle);
6~20N(1001~10000cycle);
- 5.Durability:10000 Cycles;

Item	Title	Material	Dispose	Remark
1	Shell	Stainless Steel	Ni:30u" Min.	
2	GND Plate	Stainless Steel		
3	Mid Plate	Stainless Steel	Solder Tails: Matt Tin	
4	Top Contact	Copper Alloy	Mating Area: See P/N	
5	Bottom Contact	Copper Alloy	Solder Tails: Matt Tin	
6	Insulator	High Temperature Plastic	UL 94V-0	Black

X. ± 0.50	X.* $\pm 2^{\circ}$	UNITS mm	深圳市富港科技有限公司	
.X ± 0.30	.X.* $\pm 1^{\circ}$	MATL	TITLE: TYPE-C 24PIN立式贴片母座 高度H=15.0MM	
.XX ± 0.10	.XX.* $\pm 0.5^{\circ}$			
.XXX ± 0.05		FINISH	APPD:	DWG NO.:
		QTY	CHKD:	
			DR:	
				SCALE SHEET REV. 1/1 1/1 A1