

1	2	3	4	5	6	7	8	9	10	11	12	13	14	15	
											变更单号	版本	日 期	内 容 描 述	变更者

The image shows a technical drawing of a mechanical part, likely a cross-section of a shaft or a similar component. The drawing is oriented horizontally. On the left side, there is a hatched area representing a cross-section. A dimension line with arrows at both ends indicates a length of 1.50. This dimension spans from the left edge of the hatched area to the center of a vertical feature. To the right of this feature, another dimension line with arrows at both ends indicates a length of 0.80. This dimension spans from the center of the vertical feature to the right edge of the hatched area. The drawing is simple, with clean lines and no shading.

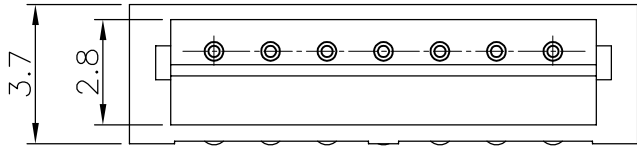
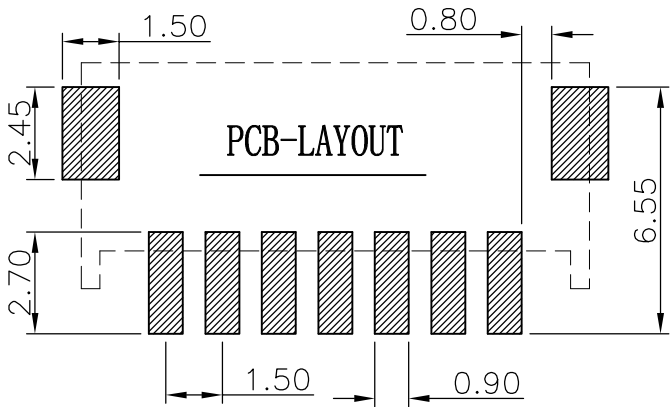

技术参数:

1. 额定电流:1A AC/DC.
2. 额定电压:250V AC/DC.
3. 工作温度:-20℃ to 85℃.
4. 接触电阻:30mΩ Max.
5. 绝缘电阻:100MΩ Min.
6. 耐电压:500V AC/minute.
7. 符合ROSH要求.

材料

1. 底座:LCP.
2. 插针和焊片:黄铜.
3. 电镀:镍 和 锡.

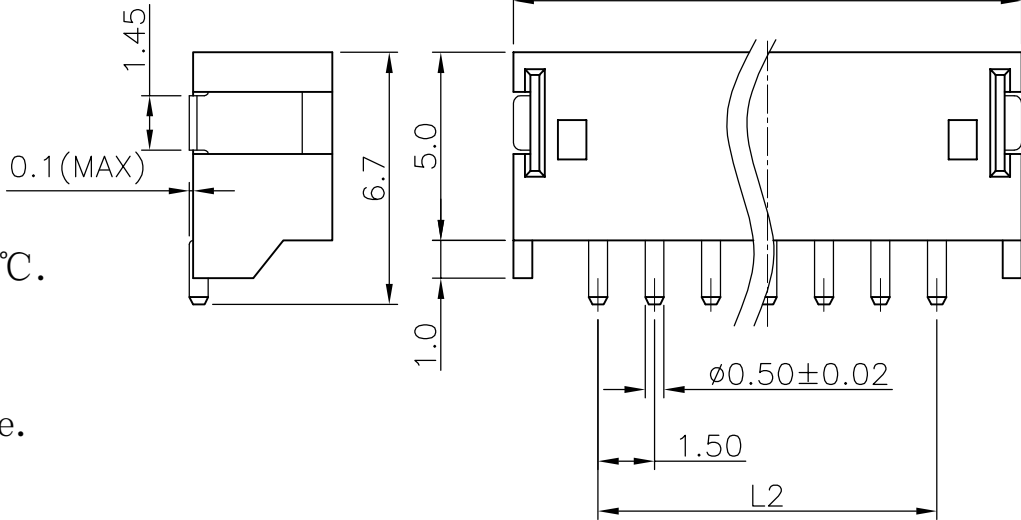

1.5-16AWTB	27.0	22.5
1.5-15AWTB	25.5	21.0
1.5-14AWTB	24.0	19.5
1.5-13AWTB	22.5	18.0
1.5-12AWTB	21.0	16.5
1.5-11AWTB	19.5	15.0
1.5-10AWTB	18.0	13.5
1.5-9AWTB	16.5	12.0
1.5-8AWTB	15.0	10.5
1.5-7AWTB	13.5	9.0
1.5-6AWTB	12.0	7.5
1.5-5AWTB	10.5	6.0
1.5-4AWTB	9.0	4.5
1.5-3AWTB	7.5	3.0
1.5-2AWTB	6.0	1.5
名称	L1	L2

CAX 浙江创都电子科技有限公司 ZHEJIANG CHUANGDU ELECTRONICS AND TECHNOLOGY CO., LTD.									
X. ±0.50	设计	叶云龙	日期	2020. 11. 14	名称	1.5-nAWTB			
X.X ±0.25	审核	黄斌斌	日期	2020. 11. 14	料号	001-0004-***			
X.XX±0.20	批准	王红芳	日期	2020. 11. 14					
X° ±3°									
未注公差	比例	1:1	单位	mm	版本	A	页码	1 OF 1	A4