

3A Fast Response LDO Regulator

Features

- High-Current Capability
- Operating Input Voltage Range: 3V to 22V
- Low Dropout Voltage
- Low Ground Current
- Accurate 1% Tolerance
- Fast Transient Response
- Fixed Output Voltages: 3.3V, 5.0V
- Adjustable Output Voltage : 1.24V to 21V
- Packages: TO-263-5、TO-220-5 and TO-252-4

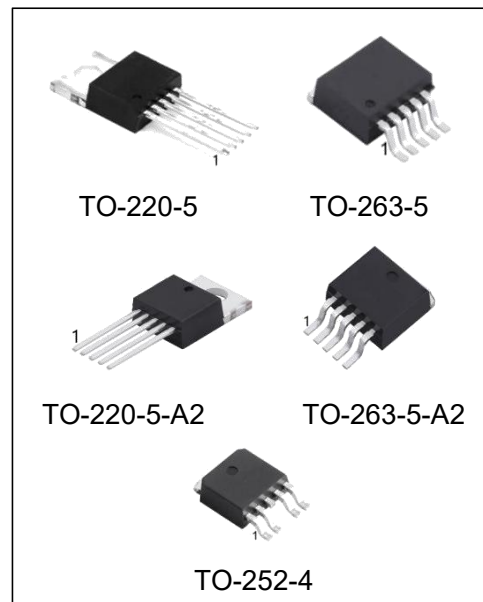

Ordering Information

DEVICE	Package Type	MARKING	Packing	Packing Qty
LT1764AT-3.3	TO-220-5/TO-220-5-A2	LT1764A-3.3	TUBE	1000pcs/box
LT1764AT-5.0	TO-220-5/TO-220-5-A2	LT1764A-5.0	TUBE	1000pcs/box
LT1764AT	TO-220-5/TO-220-5-A2	LT1764A	TUBE	1000pcs/box
LT1764AS-3.3/TR	TO-263-5/TO-263-5-A2	LT1764A-3.3	REEL	500pcs/reel
LT1764AS-5.0/TR	TO-263-5/TO-263-5-A2	LT1764A-5.0	REEL	500pcs/reel
LT1764AS/TR	TO-263-5/TO-263-5-A2	LT1764A	REEL	500pcs/reel
LT1764AMDT-3.3/TR	TO-252-4	LT1764A-3.3	REEL	2500pcs/reel
LT1764AMDT-5.0/TR	TO-252-4	LT1764A-5.0	REEL	2500pcs/reel
LT1764AMDT/TR	TO-252-4	LT1764A	REEL	2500pcs/reel

General Description

The LT1764A is a high-current, low-dropout voltage regulator that uses proprietary Super β PNP process with a PNP pass element. The 3A LDO regulator features 300mV to 370mV (full load) dropout voltage and very low ground current. Designed for high-current loads, these devices also find applications in lower current, low-dropout critical systems, where their dropout voltages and ground current values are important attributes.

Along with a total accuracy of $\pm 2\%$ (over temperature, line, and load regulation) the regulator features very fast transient recovery from input voltage surges and output load current changes.

The LT1764A has an adjustable output that can be set by two external resistors to a voltage between 1.24V and 21V. In addition, the device is fully protected against overcurrent faults, reversed input polarity, reversed lead insertion, and over temperature operation. A TTL/CMOS logic enable (EN) pin is available in the LT1764A to shutdown the regulator. When not used, the device can be set to continuous operation by connecting EN to the input (IN). The LT1764A is available in the standard TO263-5 TO220-5 and TO-252 package with an operating junction temperature range of -40°C to $+125^{\circ}\text{C}$.

Pin Configuration

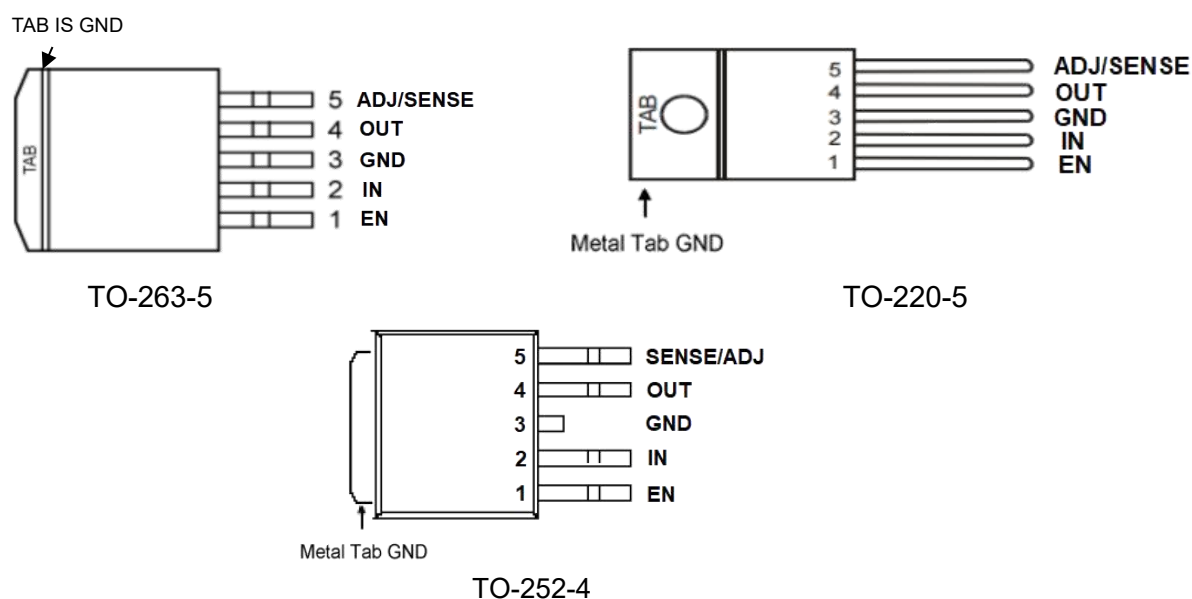

Note: PIN5=SENSE for LT1764A-3.3/LT1764A-5.0

PIN5=ADJ for LT1764A

Typical Application Circuit

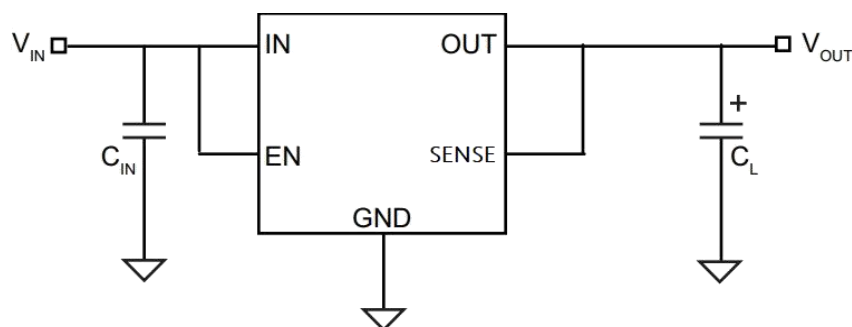

LT1764A-3.3/LT1764A-5.0

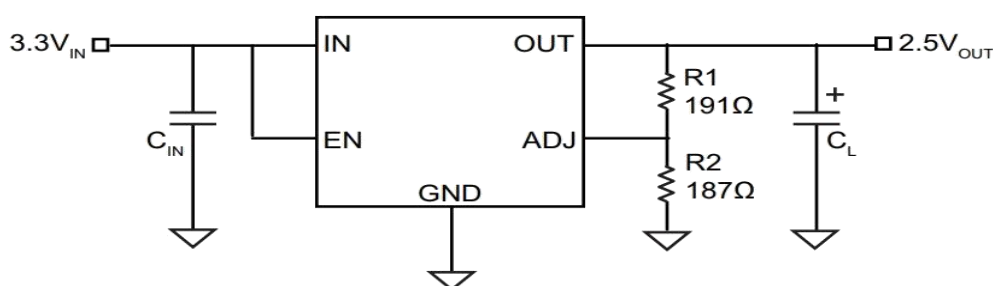

LT1764A

Absolute Maximum Ratings(Ta=25°C)

Rating		Symbol	Value	Unit
Input Supply Voltage		V_{IN}	22	V
Enable Input Voltage		V_{EN}	V_{IN}	V
Operating Junction Temperature Range ⁽¹⁾		T_J	- 40 to +125	°C
Storage Temperature Range		T_{stg}	- 65 to +150	°C
Package Thermal Resistances	TO-263	θ_{JC}	3	°C/W
	TO-252		3	°C/W
Package Thermal Resistances	TO-263	θ_{JA}	28	°C/W
	TO-252		56	°C/W
Lead Temperature (soldering 10sec.)	TO-263/TO-220	T_L	245	°C
	TO-252		260	°C

Note: Absolute Maximum Ratings indicate limits beyond which damage to the device may occur. Operating Ratings indicate conditions for which the device is intended to be functional, but specific performance is not ensured.

(1) Operating Junction temperature range: -40°C to +125°C. This product is designed for industrial grade applications. For automotive grade versions compliant with AEC-Q100, please conduct internal screening per the standard or contact our sales team for availability.

Electrical Characteristics

$V_{IN} = V_{OUT} + 1V$; $I_{OUT} = 100\text{ mA}$; $T_A = +25^\circ\text{C}$, **bold** values indicate $-40^\circ\text{C} \leq T_J \leq +125^\circ\text{C}$, unless noted. Note 1

Parameter	Symbol	Min.	Typ.	Max.	Units	Conditions
Output Voltage						
Output Voltage Accuracy	ΔV_{OUT}	-2	—	2	%	$100\text{ mA} \leq I_{OUT} \leq 3\text{ A}$, $(V_{OUT} + 1\text{ V}) \leq V_{IN} \leq 22\text{ V}$
Line Regulation	$\Delta V_{OUT}/\Delta V_{IN}$	—	0.1	0.5	%	$I_{OUT} = 100\text{ mA}$, $(V_{OUT} + 1\text{ V}) \leq V_{IN} \leq 22\text{ V}$
Load Regulation	$\Delta V_{OUT}/\Delta I_{OUT}$	—	0.2	1	%	$V_{IN} = V_{OUT} + 1\text{ V}$, $100\text{ mA} \leq I_{OUT} \leq 3\text{ A}$
Dropout Voltage (Note 2)	V_{DO}	—	100	200	mV	$I_{OUT} = 100\text{ mA}$, $V_{IN} \geq V_{OUT} + 1\text{ V}$
		—	300	—		$I_{OUT} = 1.5\text{ A}$, $V_{IN} \geq V_{OUT} + 1\text{ V}$
		—	500	—		$I_{OUT} = 2.75\text{ A}$, $V_{IN} \geq V_{OUT} + 1\text{ V}$
		—	560	800		$I_{OUT} = 3\text{ A}$, $V_{IN} \geq V_{OUT} + 1.3\text{ V}$
Ground Current						
Ground Current	I_{GND}	—	5	20	mA	$I_{OUT} = 750\text{ mA}$, $V_{IN} = V_{OUT} + 1\text{ V}$
		—	15	—		$I_{OUT} = 1.5\text{ A}$
		—	60	150		$I_{OUT} = 3\text{ A}$
Ground Pin Current at Dropout	I_{GNDDO}	—	2	—	mA	$V_{IN} = 0.5\text{ V}$ less than specified V_{OUT} ; $I_{OUT} = 10\text{ mA}$
Current Limit	I_{LIMIT}	3	4	—	A	$V_{OUT} = 0\text{ V}$, Note 3
Output Noise Voltage (10 Hz to 100 kHz)	e_n	—	400	—	μVRMS	$C_L = 10\text{ }\mu\text{F}$
		—	260	—		$C_L = 33\text{ }\mu\text{F}$
Ground Pin Current in Shutdown	I_{SHDN}	—	32	—	μA	Input Voltage $V_{IN} = 22\text{ V}$
Reference						
Reference Voltage	V_{REF}	1.215	—	1.267	V	Note 4
Adjust Pin Bias Current	I_{ADJ}	—	40	—	nA	—
		—	—	120		
ENABLE Input						
Input Logic Voltage	V_{ENABLE}	—	—	0.8	V	Low (OFF)
		2.4	—	—		High (ON)
Enable Pin Input Current	I_{ENABLE}	—	15	30	μA	$V_{EN} = 4.2\text{ V}$
		—	—	75		
		—	—	2		$V_{EN} = 0.8\text{ V}$
		—	—	4		
Regulator Output Current in Shutdown	$I_{OUT-SHDN}$	—	10	—	μA	Note 5
		—	—	20		

- Note:** 1、Specification for packaged product only
2、Dropout voltage is defined as the input-to-output differential when output voltage drops to 99% of its nominal value with $V_{OUT} + 1V$ applied to V_{IN} .
3、 $V_{IN} = V_{OUT}(\text{nominal}) + 1V$. For example, use $V_{IN} = 4.3V$ for a 3.3V regulator or use 6V for a 5V regulator. Employ pulse testing procedure for current-limit.
4、 $V_{REF} \leq V_{OUT} \leq V_{IN} - 1$, $3V \leq V_{OUT} \leq 22V$, $10\text{ mA} \leq I_L \leq I_{FL}$, $T_J \leq T_J(\text{MAX})$.
5、 $V_{EN} \leq 0.8V$, $V_{IN} \leq 22V$ and $V_{OUT} = 0V$.

Typical Characteristics

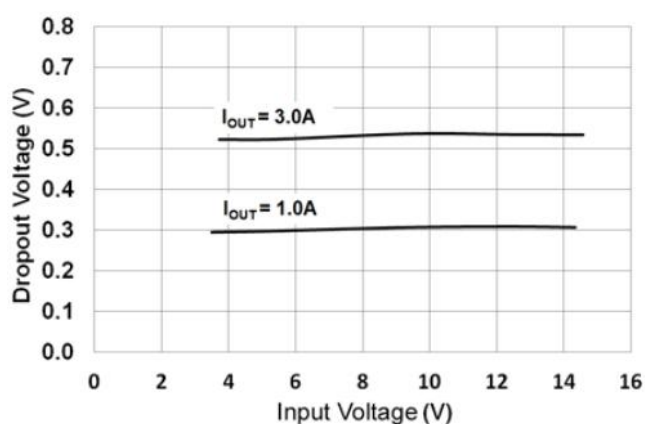

Dropout Voltage vs. Input Voltage.

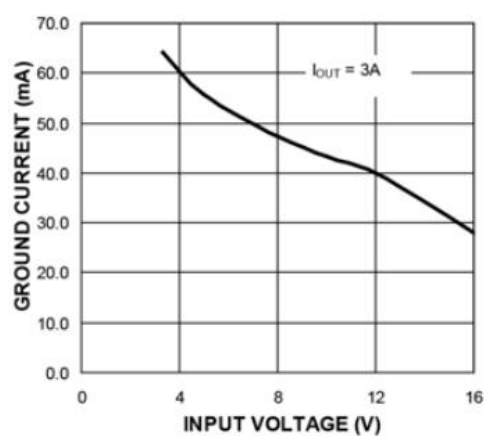

GND Pin Current vs. Input Voltage.

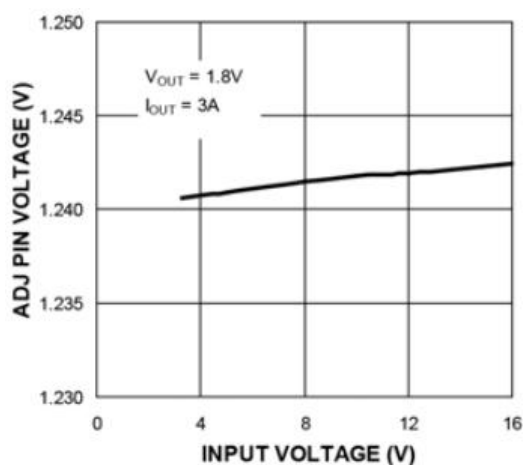

Adjust Pin Voltage vs. Input Voltage.

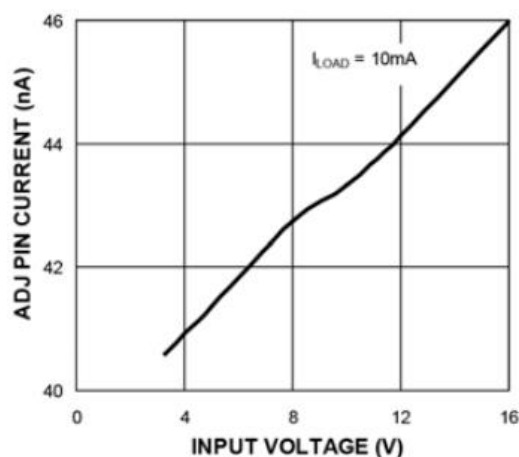

Adjust Pin Current vs. Input Voltage.

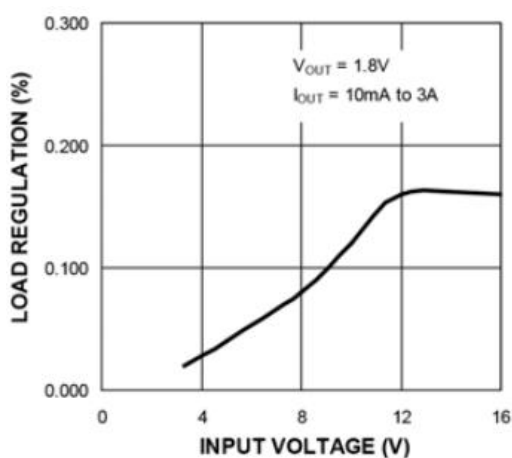

Load Regulation vs. Input Voltage.

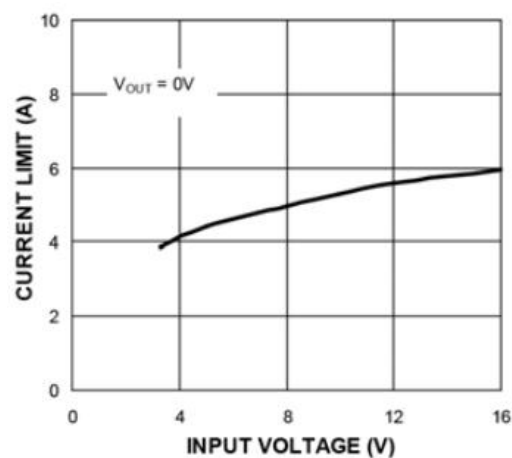

Short-Circuit Current vs. Input Voltage.

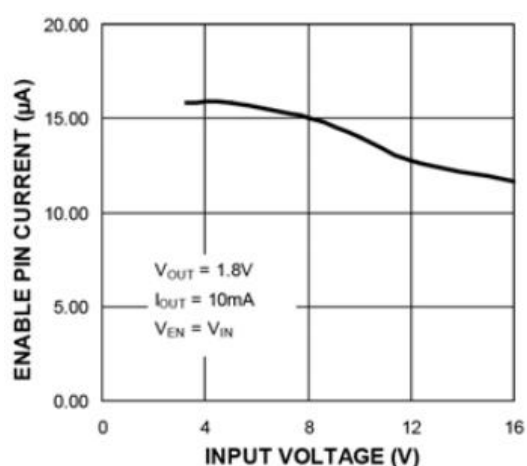

Enable Pin Current vs. Input Voltage.

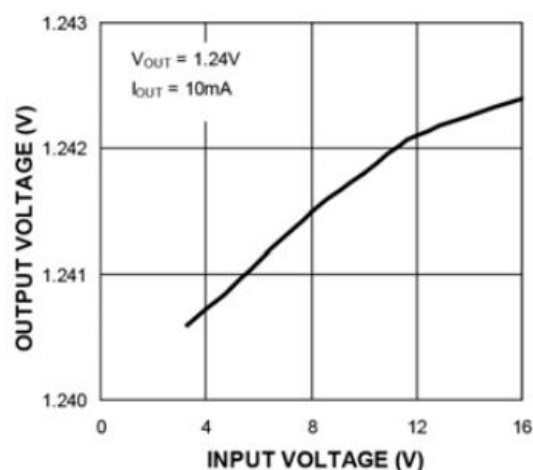

Output Voltage vs. Input Voltage.

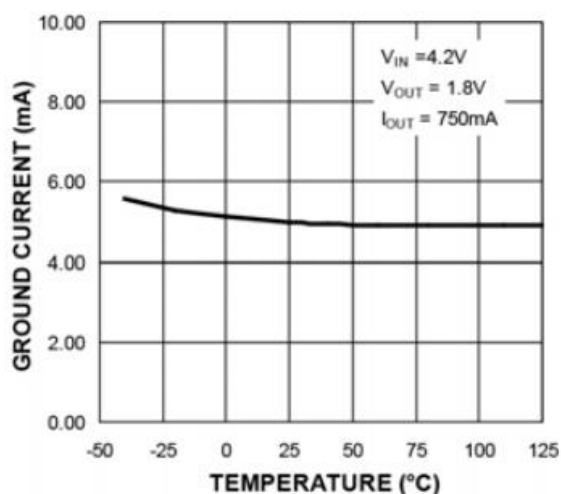

GND Pin Current vs. Temperature.

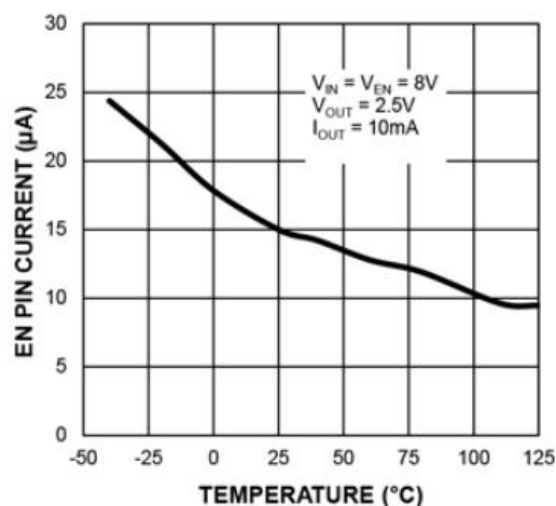

Enable Bias Current vs. Temperature.

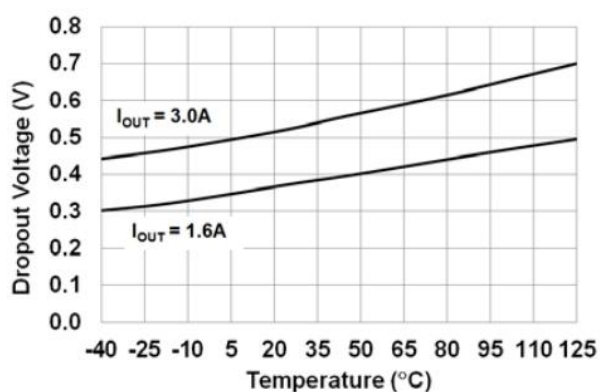

Dropout Voltage vs. Temperature.

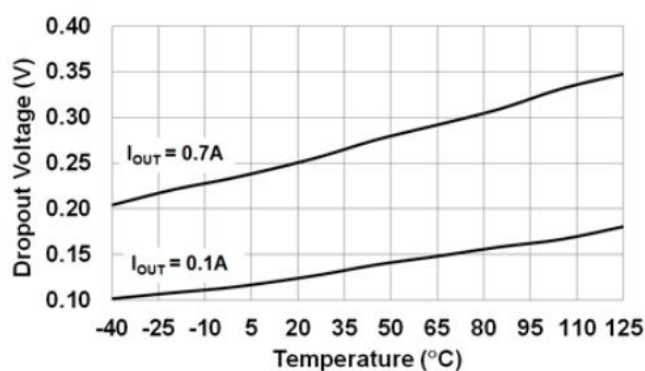

Dropout Voltage vs. Temperature.

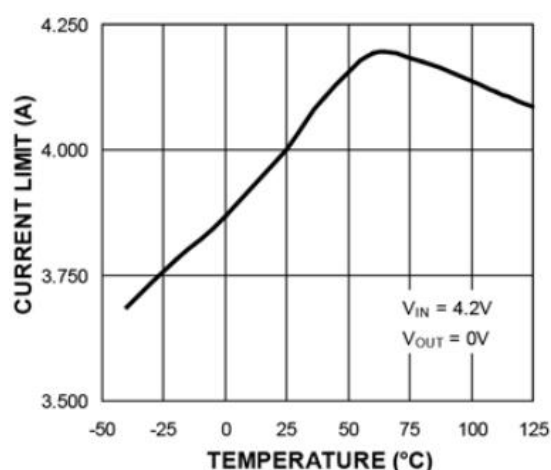

Short-Circuit Current vs. Temperature.

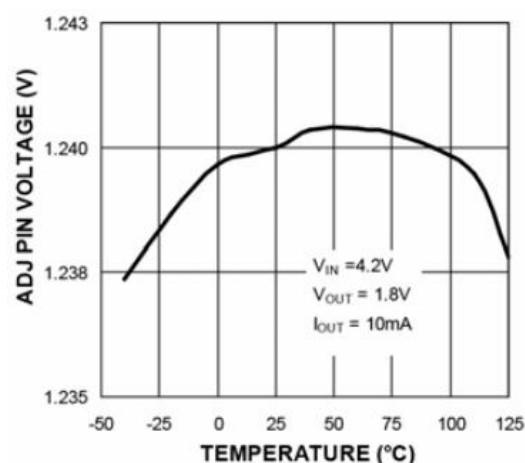

Adjust Pin Voltage vs. Temperature.

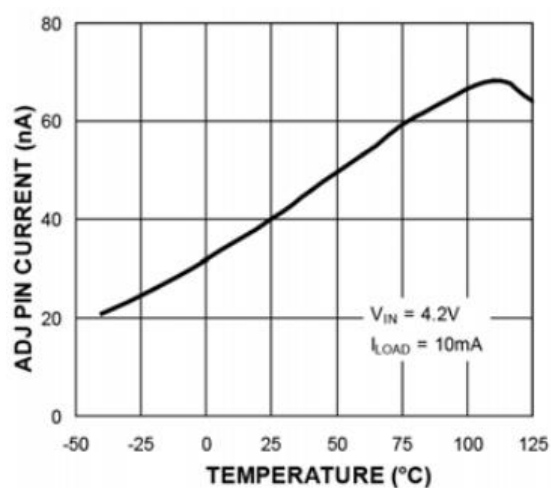

Adjust Pin Current vs. Temperature.

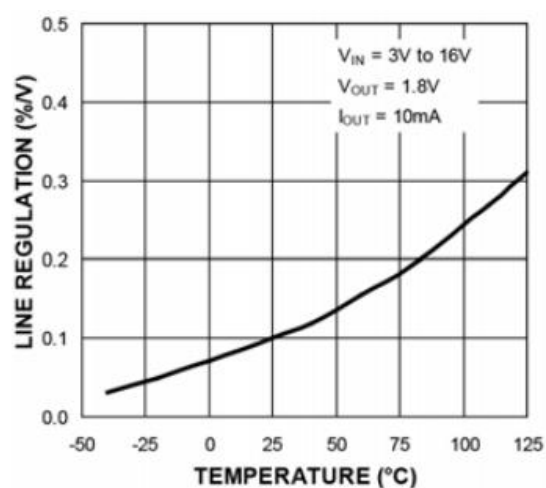

Line Regulation vs. Temperature.

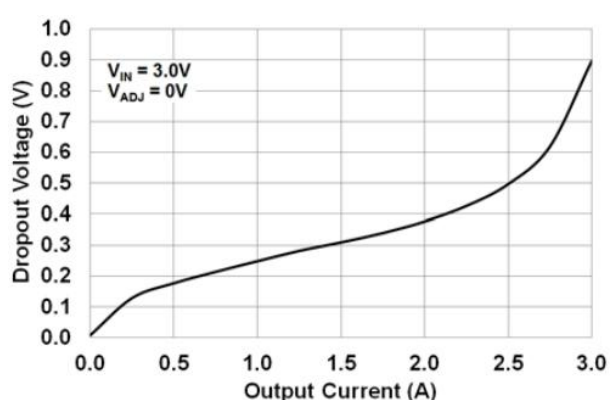

Dropout Voltage vs. Output Current.

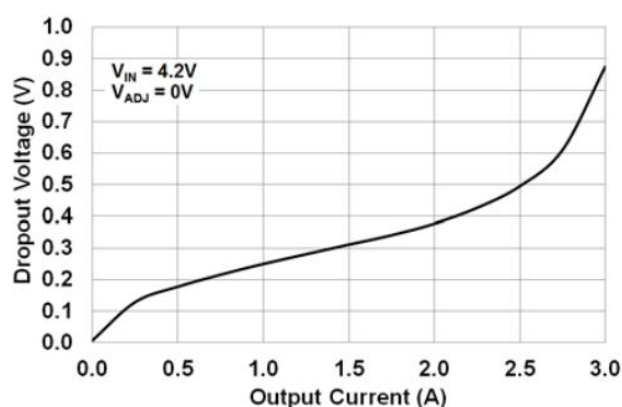

Dropout Voltage vs. Output Current.

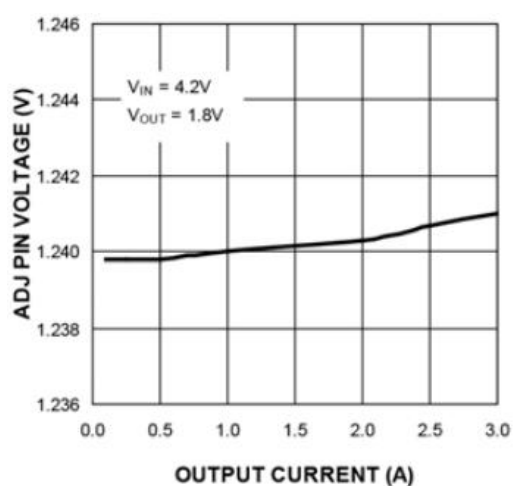

Adjust Pin Voltage vs. Output Current.

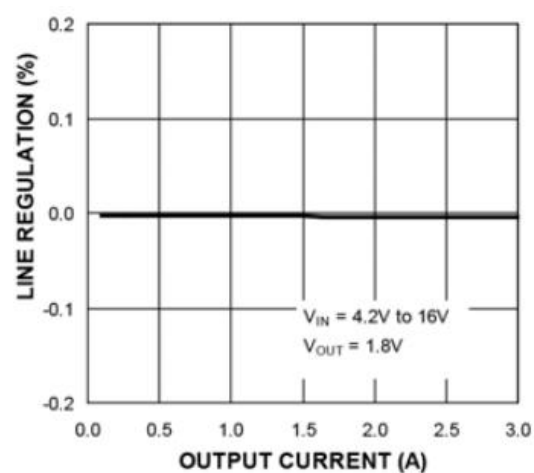

Line Regulation vs. Output Current

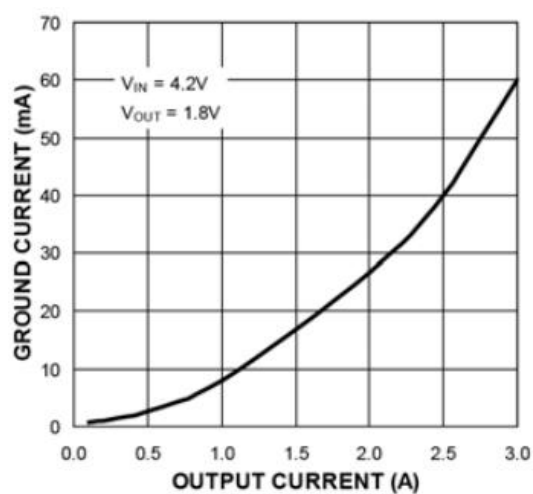

GND Pin Current vs. Output Current.

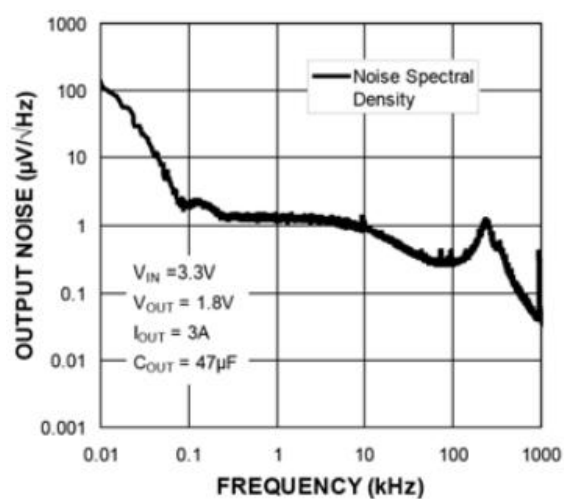

Output Noise vs. Frequency

Application Information

The LT1764A is a high-performance, low-dropout voltage regulator suitable for all moderate to high-current voltage regulation applications. Its 560 mV typical dropout voltage at full load makes it especially valuable in battery-powered systems and as high efficiency noise filters in post-regulator applications. Unlike older NPN-pass transistor designs, where the minimum dropout voltage is limited by the base-emitter voltage drop and collector-emitter saturation voltage, dropout performance of the PNP output is limited merely by the low V_{CE} saturation voltage.

A trade-off for the low dropout voltage is a varying base driver requirement. But the Super β PNP process reduces this drive requirement to merely 1% of the load current.

The LT1764A regulator is fully protected from damage due to fault conditions. Current limiting is linear; output current under overload conditions is constant. Thermal shutdown disables the device when the die temperature exceeds the +125°C maximum safe operating temperature. The output structure of the regulators allows voltages in excess of the desired output voltage to be applied without reverse current flow. The LT1764A offers a logic-level ON/OFF control. When disabled, the device draws 32 μ A at maximum 26V input.

1 Capacitor Requirements

For stability and minimum output noise, a capacitor on the regulator output is necessary. The value of this capacitor is dependent upon the output current; lower currents allow smaller capacitors. The LT1764A is stable with a 10 μ F capacitor at full load.

This capacitor need not be an expensive low-ESR type; aluminum electrolytics are adequate. In fact, extremely low-ESR capacitors may contribute to instability. Tantalum capacitors are recommended for systems where fast load transient response is important.

When the regulator is powered from a source with high AC impedance, a 0.1 μ F capacitor connected between input and GND is recommended.

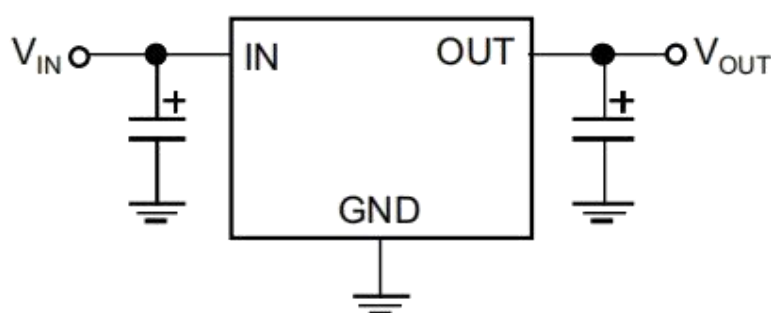

FIGURE 1: Linear Regulators Require Only Two Capacitors for Operation.

2 Transient Response and 5V to 3.3V Conversion

The LT1764A has excellent response to variations in input voltage and load current. By virtue of its low dropout voltage, the device does not saturate into dropout as readily as similar NPN-based designs. A 3.3V output LT1764A LDO will maintain full speed and performance with an input supply as low as 4.2V, and will still provide some regulation with supplies down to 3.8V, unlike NPN devices that require 5.1V or more for good performance and become nothing more than a resistor under 4.6V of input. LT1764A PNP regulators provide superior performance in “5V to 3.3V” conversion applications than NPN regulators, especially when all tolerances are considered.

3 Minimum Load Current

The LT1764A regulator operates within a specified load range. If the output current is too small, leakage currents dominate and the output voltage rises.

A minimum load current of 10 mA is necessary for proper regulation and to swamp any expected leakage current across the operating temperature range.

For best performance the total resistance ($R1+R2$) should be small enough to pass the minimum regulator load current of 10 mA.

4 Adjustable Regulator Design

The output voltage can be programmed anywhere between 1.25V and the 21V. Two resistors are used. The resistor values are calculated by:

EQUATION 4-1:

$$R1 = R2 \times \left(\frac{V_{OUT}}{1.240} - 1 \right)$$

Where:

V_{OUT} = Desired output voltage.

shows component definition. Applications with widely varying load currents may scale the resistors to draw the minimum load current required for proper operation (see the Minimum Load Current section).

Physical Dimensions

TO-220-5

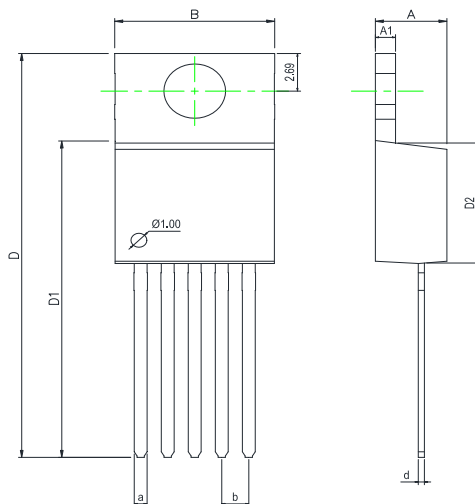

Dimensions In Millimeters(TO-220-5)

Symbol:	A	A1	B	D	D1	D2	a	d	b
Min:	4.52	1.25	10	28.2	22.4	8.69	0.71	0.33	1.70BSC
Max:	4.62	1.29	10.3	28.9	22.6	8.79	0.97	0.42	

TO-263-5

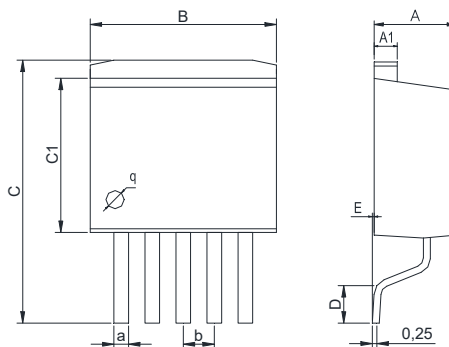

Dimensions In Millimeters(TO-263-5)

Symbol:	A	A1	B	C	C1	D	E	a	b
Min:	4.45	1.22	10	13.7	8.40	1.90	0	0.71	1.70BSC
Max:	4.62	1.32	10.4	14.6	8.90	2.10	0.20	0.97	

Physical Dimensions

TO-263-5_(A2)

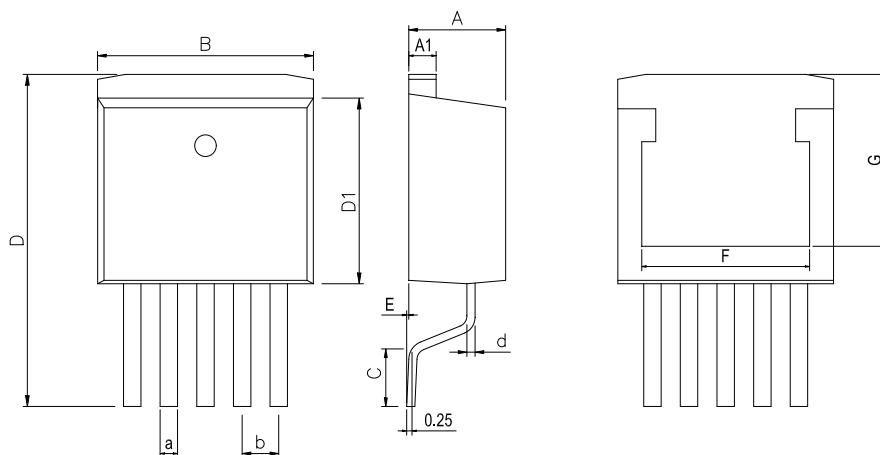

Dimensions In Millimeters(TO-263-5)

Symbol:	A	A1	B	C	D	D1	E	F	G	a	b
Min:	4.40	1.22	9.8	2.10	14.7	8.50	0	7.70	7.87	0.71	1.70
Max:	4.60	1.32	10.4	2.60	15.6	9.10	0.305	7.90	8.07	0.97	BSC

TO-220-5_(A2)

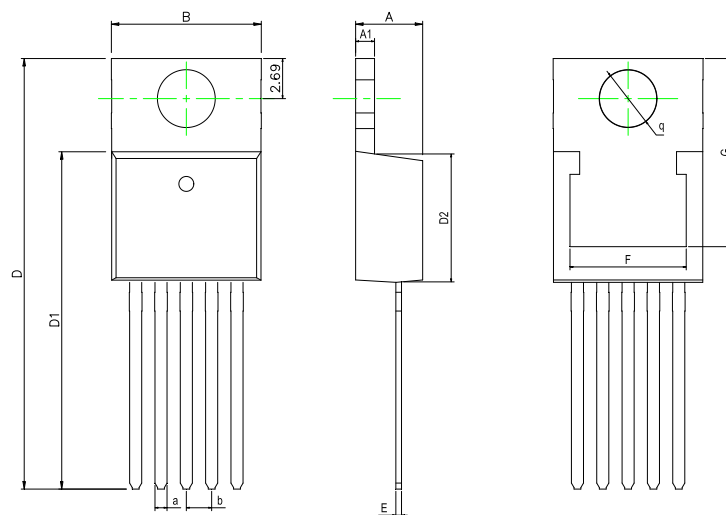

Dimensions In Millimeters(TO-220-5)

Symbol:	A	A1	B	D	D1	D2	E	F	G	a	b	q
Min:	4.40	1.22	9.8	28.5	22.4	8.50	0.33	7.70	12.55	0.71	1.70	3.80
Max:	4.60	1.32	10.4	28.9	22.7	9.10	0.43	7.90	12.65	0.97	BSC	TYP

Physical Dimensions

TO-252-4

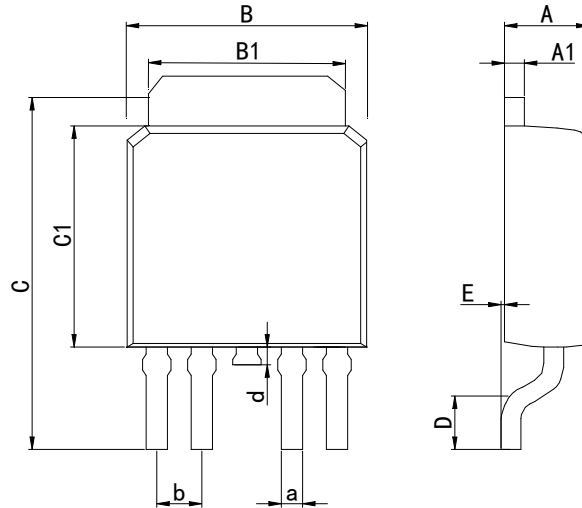

Dimensions In Millimeters(TO-252-4)

Symbol:	A	A1	B	B1	C	C1	D	E	a	d	b
Min:	2.10	0.45	6.40	5.10	9.20	5.30	0.90	0	0.50	0.60	1.27
Max:	2.50	0.70	6.80	5.50	10.6	6.30	1.75	0.23	0.80	1.20	BSC

Revision History

REVISION NUMBER	DATE	REVISION	PAGE
V1.0	2017-11	New	1-15
V1.1	2025-9	Document Reformatting	1-15

IMPORTANT STATEMENT:

Huaguan Semiconductor reserves the right to change products and services offered without prior notice. Customers should obtain the latest relevant information before placing orders and verify that such information is current and complete. Huaguan Semiconductor assumes no responsibility or liability for altered documents.

Customers are responsible for complying with safety standards and implementing safety measures when using Huaguan Semiconductor products in system design and end-product manufacturing. You assume full responsibility for: selecting the appropriate Huaguan Semiconductor products for your application; designing, validating, and testing your application; and ensuring that your application complies with applicable standards and all other safety, security, or other requirements. This is to prevent potential risks that may lead to personal injury or property damage.

Huaguan Semiconductor products are not approved for use in life support, military, aerospace, or other high-risk applications. Huaguan products are neither intended nor warranted for use in such systems or equipment. Any failure or malfunction may lead to personal injury or severe property damage. Such applications are deemed "Unsafe Use." Unsafe Use includes, but is not limited to: surgical and medical equipment, nuclear energy control equipment, aircraft or spacecraft instruments, control or operation of vehicle power, braking, or safety systems, traffic signal instruments, all types of safety devices, and any other applications intended to support or sustain life. Huaguan Semiconductor shall not be liable for consequences resulting from Unsafe Use in these fields. Users must independently evaluate and assume all risks. Any issues, liabilities, or losses arising from the use of products beyond their approved applications shall be solely borne by the user. Users may not claim any compensation from Huaguan Semiconductor based on these terms. If any third party claims against Huaguan Semiconductor due to such Unsafe Use, the user shall compensate Huaguan Semiconductor for all resulting damages and liabilities.

Huaguan Semiconductor provides technical and reliability data (including datasheets), design resources (including reference designs), application or other design advice, web tools, safety information, and other resources for its semiconductor products. However, no guarantee is made that these resources are free from defects, and no express or implied warranties are provided. The use of testing and other quality control techniques is limited to Huaguan Semiconductor's quality assurance scope. Not all parameters of each device are tested.

Huaguan Semiconductor's documentation authorizes you to use these resources only for developing applications related to the products described herein. You are not granted rights to any other intellectual property of Huaguan Semiconductor or any third party. Any other reproduction or display of these resources is strictly prohibited. You shall fully indemnify Huaguan Semiconductor and its agents against any claims, damages, costs, losses, and liabilities arising from your use of these resources. Huaguan Semiconductor shall not be held responsible.