

### MOUNTING DETAIL

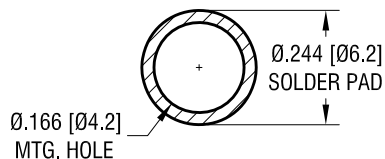

### ACTUAL SIZE

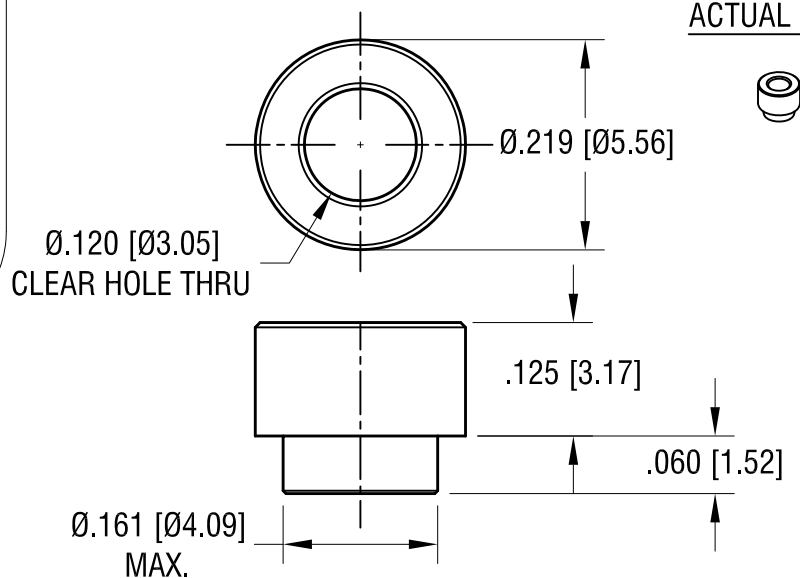

### NOTES:

- SUPPLIED ON TAPE AND REEL ONLY.  
TAPE AND REEL SPECIFICATIONS:
- TAPE:  
MAT'L - ALL CONDUCTIVE POLYSTYRENE CARRIER  
ANSI/EIA-481 STANDARD
- REEL:  
13" [330.2] DIA. 1000 PIECES PER REEL
- REELS TO BE SUPPLIED IN SEALED BAGS  
WITH VCI PROTECTION.
- KAPTON TAPE ADDED TO TOP SURFACE  
OF STANDOFF.

7.25.24	SPECIFIED VCI PACKAGING.	A
DATE	DESCRIPTION	REV.

KEYSTONE ELECTRONICS CORP.			
www.keyelco.com • NEW HYDE PARK NY 11040 • Tel (516)328-7500			
PART NAME			
SM STANDOFF			
MATERIAL			
STEEL			
FINISH		DRN BY	DATE
MATTE TIN PLATE		NT	1.03.17
		APP'D	SCALE
		RH	5X, 1X
TOLERANCES		INCH	[MM]
DECIMAL		± .005	[± 0.13]
ANGULAR		± 1°	
UNLESS OTHERWISE SPECIFIED		CODE	DWG NO.
		C	4887