

Features

- Small package
- Low forward voltage
- Fast reverse recovery time
- Small total capacitance

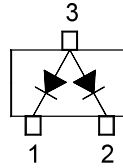

Marking Code: **A1**

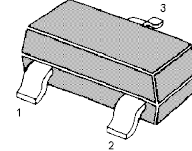

SOT-23 Plastic Package

Applications

- Ultra high speed switching application

Absolute Maximum Ratings ($T_a = 25^\circ\text{C}$)

Parameter	Symbol	Value	Unit
Peak Repetitive Reverse Voltage	V_{RRM}	85	V
Continuous Reverse Voltage	V_R	75	V
Forward Current (DC)	I_F	215	mA
Single Diode Loaded		125	
Double Diode Loaded			
Repetitive Peak Forward Current	I_{FRM}	450	mA
Non-repetitive Peak Forward Surge Current	I_{FSM}	0.5	A
at $t = 1$ s		1	
at $t = 1$ ms		4	
at $t = 1$ μ s			
Power Dissipation	P_{tot}	350	mW
Thermal Resistance from Junction to Ambient Air	$R_{\theta JA}$	357	$^\circ\text{C/W}$
Operating Junction Temperature	T_J	150	$^\circ\text{C}$
Storage Temperature Range	T_{stg}	- 65 to + 150	$^\circ\text{C}$

Characteristics at $T_a = 25^\circ\text{C}$

Parameter	Symbol	Max.	Unit
Forward Voltage			
at $I_F = 1$ mA	V_F	715	mV
at $I_F = 10$ mA	V_F	855	mV
at $I_F = 50$ mA	V_F	1	V
at $I_F = 150$ mA	V_F	1.25	V
Reverse Current			
at $V_R = 25$ V	I_R	30	nA
at $V_R = 75$ V	I_R	1	μ A
at $V_R = 25$ V, $T_J = 150^\circ\text{C}$	I_R	30	μ A
at $V_R = 75$ V, $T_J = 150^\circ\text{C}$	I_R	50	μ A
Diode Capacitance	C_d	2	pF
at $V_R = 0$, $f = 1$ MHz			
Reverse Recovery Time	t_{rr}	4	ns
at $I_F = I_R = 10$ mA, $R_L = 100\ \Omega$			

Typical Characteristics

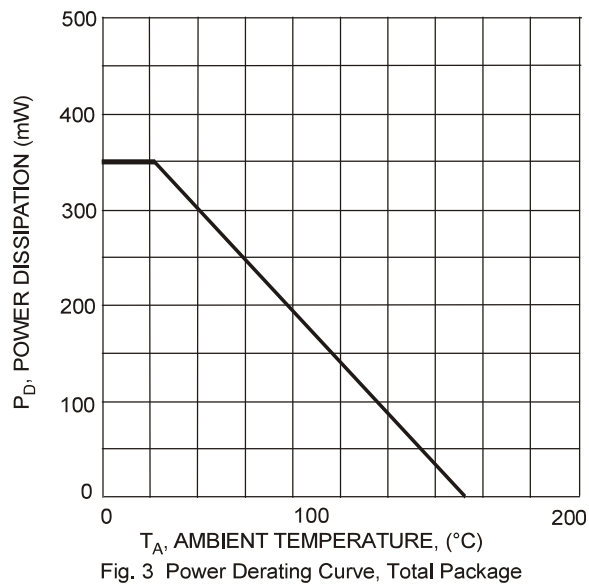
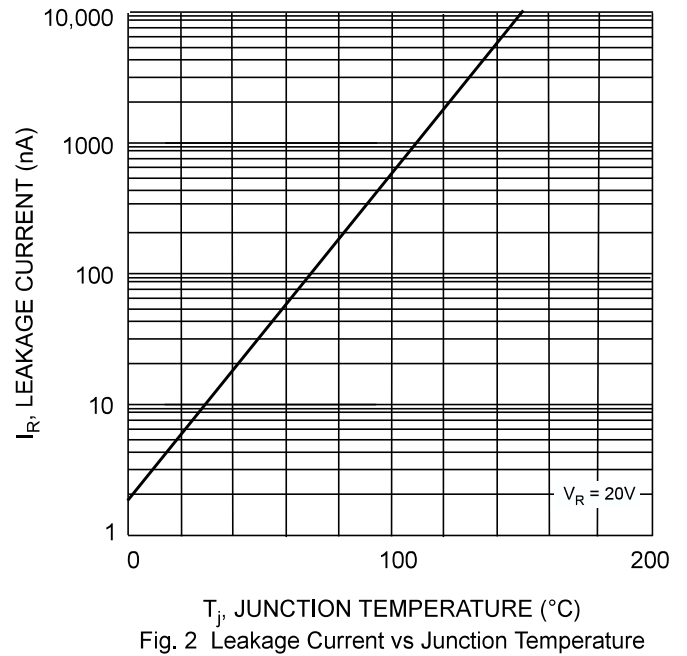
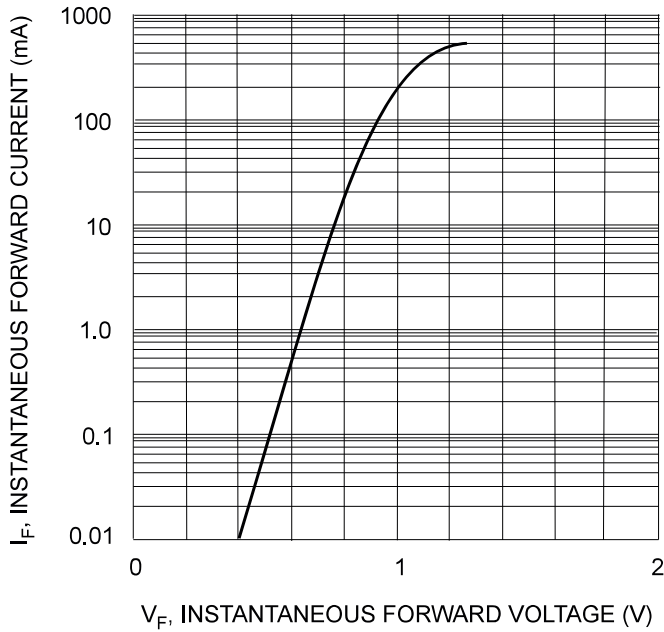

PACKAGE OUTLINE

Plastic surface mounted package; 3 leads

SOT-23

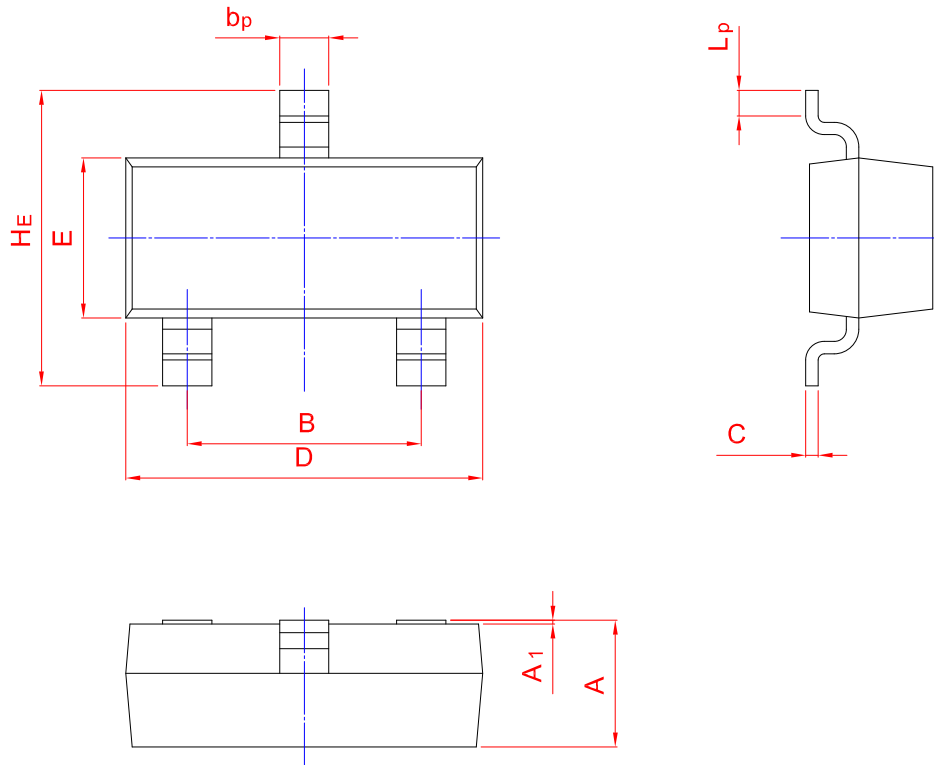
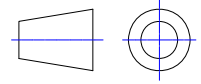

UNIT	A	B	bp	C	D	E	HE	A1	Lp
mm	1.40 0.95	2.04 1.78	0.50 0.35	0.19 0.08	3.10 2.70	1.65 1.20	3.00 2.20	0.100 0.013	0.50 0.20

WPMtek reserves the right to make changes to the product specification and data in this document without notice. WPMtek makes no warranty, representation or guarantee regarding the suitability of its products for any particular purpose, nor does WPMtek assume any liability arising from the application or use of any products or circuits, and specifically disclaims any and all liability, including without limitation special, consequential or incidental damages. Any enquiry, please write to sales@wpmtek.com for further information.