

DESCRIPTION

The MBR2065CS/CT meet the ROHS and Green Product requirement with full function reliability approved.

FEATURE

- *High Surge Capacity
- *For Use In Low Voltage,High Frequency Inverters, Free Wheeling and Polarity Protection Applications.
- *Metal Silicon Junction,Majority Carrier Conduction.
- *High Current Capacity,Low Forward Voltage Drop.
- *Guard Ring for Over Voltage Protection.

MARKING



WPM : LOGO

MBR2065CT=Device Code (TO-220F)

MBR2065CS=Device Code (TO-252)

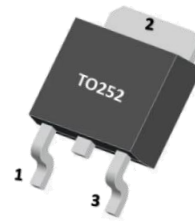

1. ANODE

2. CATHODE

3. ANODE

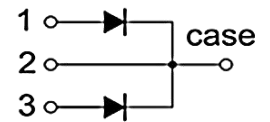

ABSOLUTE MAXIMUM RATINGS($T_A=25^{\circ}\text{C}$, unless otherwise specified.)

SYMBOL	PARAMETER		VALUE	UNIT
VRRM	Peak repetitive reverse voltage		65	V
VRWM	Working peak reverse voltage		65	V
VR	DC blocking voltage		65	V
VR(RMS)	RMS reverse voltage		45.5	V
IO	Average rectified output current		20 (10*2)	A
IFSM	Non-Repetitive peak forward surge current (8.3ms half sine wave)		150*2	A
Tj	Junction temperature		150	$^{\circ}\text{C}$
Tstg	Storage temperature		-55 ~ +150	$^{\circ}\text{C}$
R θ JA	Thermal Resistance from Junction to Ambient	TO-252	100	$^{\circ}\text{C/W}$
		TO-220F	58	
R θ JC	Thermal Resistance From Junction To Case	TO-252	5	$^{\circ}\text{C/W}$
		TO-220F	3	

Notes: Absolute maximum ratings are those values beyond which the device could be permanently damaged. Absolute maximum ratings are stress ratings only and functional device operation is not implied.

ELECTRICAL CHARACTERISTICS ($T_A=25^\circ\text{C}$, unless otherwise specified)

PARAMETER	SYMBOL	TEST CONDITIONS	MIN	TYP	MAX	UNIT
Reverse voltage	$V_{(BR)}$	$I_R=0.1\text{mA}$	65			V
Reverse current	I_R	$V_R=65\text{V}$	$T_j=25^\circ\text{C}$		50	μA
			$T_j=125^\circ\text{C}$	5.0		mA
Forward voltage	V_F	$I_F=5\text{A}$	$T_j=25^\circ\text{C}$	0.60		V
			$T_j=125^\circ\text{C}$	0.54		V
		$I_F=10\text{A}$	$T_j=25^\circ\text{C}$	0.72	0.75	V
			$T_j=125^\circ\text{C}$	0.62		V

*Pulse test: pulse width $\leq 300\mu\text{s}$, duty cycle $\leq 2.0\%$

TYPICAL CHARACTERISTICS

FIG.1: FORWARD CURRENT DERATING CURVE

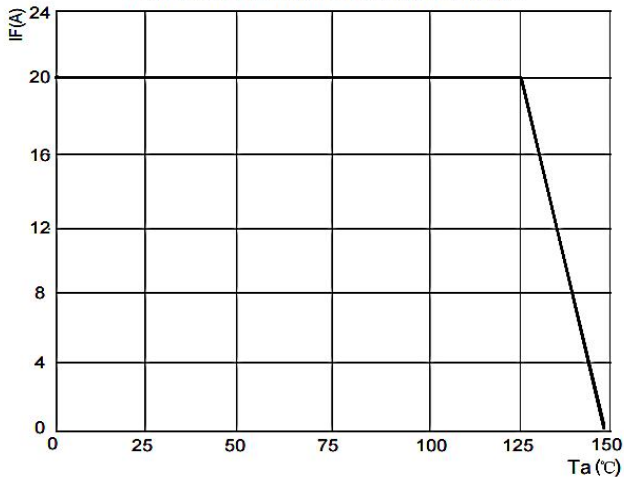

FIG.2: TYPICAL FORWARD CHARACTERISTICS

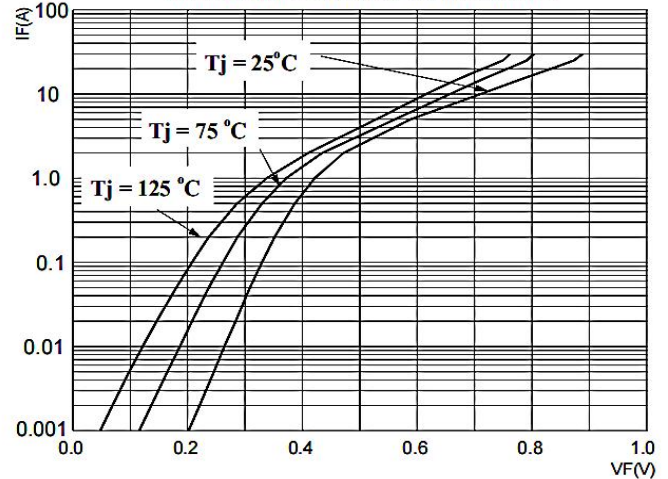

FIG.3: TOTAL CAPACITANCE DERATING CURVE

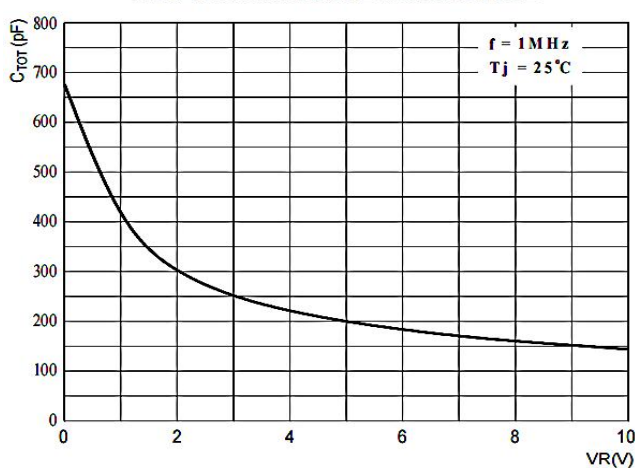
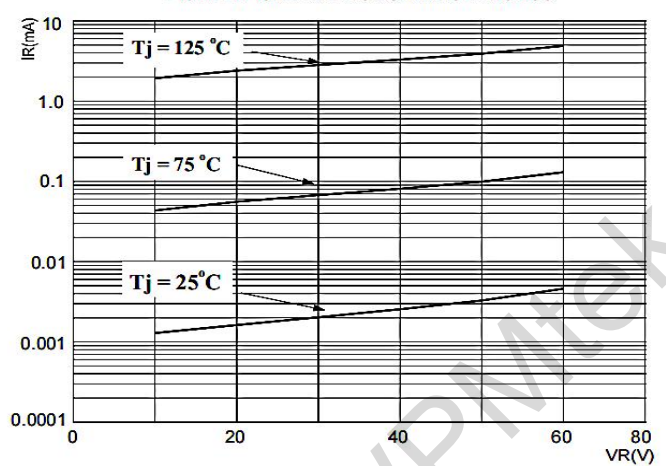
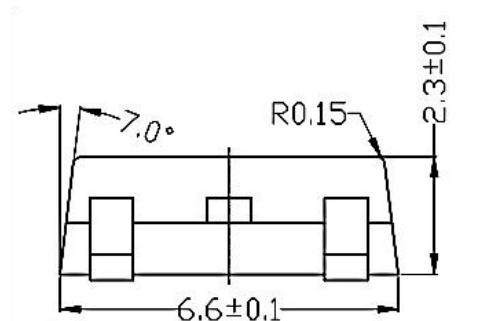
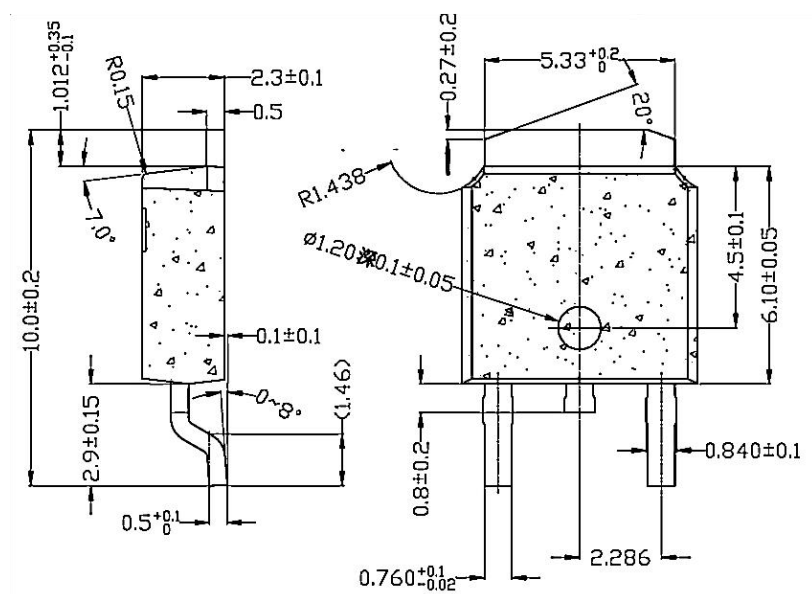

FIG.4: TYPICAL REVERSE CHARACTERISTICS



TO - 252 Package Outline Dimensions



TO - 252 Packing Information

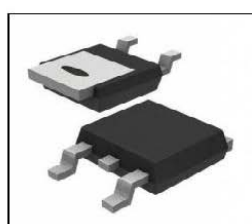

2500PC
S/reel

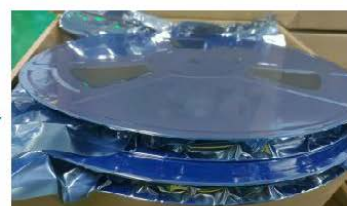

2 Reel/BOX



5 Inner
Box



Outer box

Inner box

Package version	Reel dimensions $\Phi \times H$ (mm)	Per Reel (pcs)	Reels per box	Inner box dimensions $L \times W \times H$ (mm)	Outer box (pcs)	Outer box dimensions $L \times W \times H$ (mm)
T0-252	$\Phi 330 \times 20$	2500	2	360*340*50	25000	375*375*280

TO - 220F Package Outline Dimensions

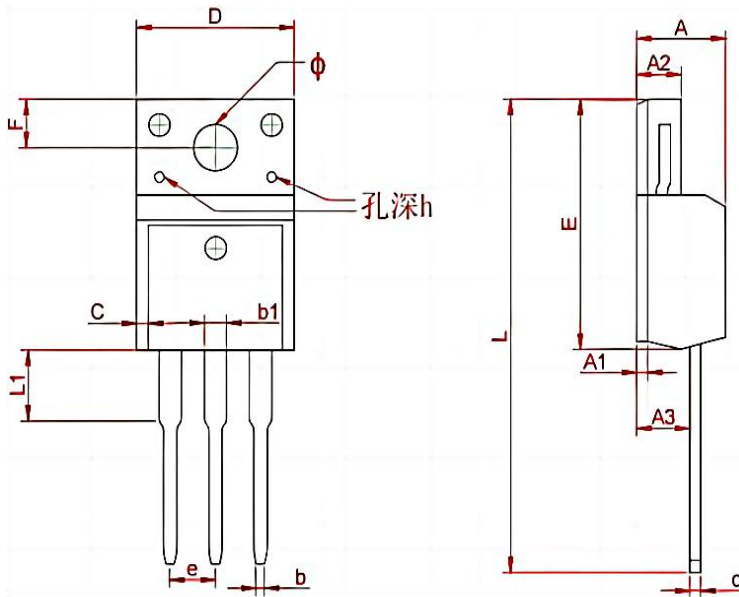

Symbol	Dimensions In Millimeters	
	Min	Max
A	4.300	4.750
A1	0.7 REF	
A2	2.300	2.850
A3	2.500	2.900
b	0.380	0.420
b1	1.220	1.280
C	1.08	1.200
c	0.480	0.520
D	10.15	10.450
E	15.700	15.950
e	2.574 TYP	
F	3.470 REF	
y	3.200 REF	
h	0.000	0.800
L	28.780	28.900
L1	2.990	3.100

TO - 220F Packing Information



50PCS



20 Tube



5 Inner
Box



Outer Box

Inner Box

Package version	Tube dimensions LxWxH (mm)	Per Tube (pcs)	Tube per box	Inner box dimensions LxWxH (mm)	PCS/ Inner box	Outer box dimensions LxWxH(mm)	PCS/ Outer box
TO-220F	530*32*7	50	20	580*155*50	1000	602*277*188	5000

WPMtek reserves the right to make changes to the product specification and data in this document without notice. WPMtek makes no warranty, representation or guarantee regarding the suitability of its products for any particular purpose, nor does WPMtek assume any liability arising from the application or use of any products or circuits, and specifically disclaims any and all liability, including without limitation special, consequential or incidental damages. Any enquiry, please write to sales@wpmtek.com for further information.