

RoHS Compliant

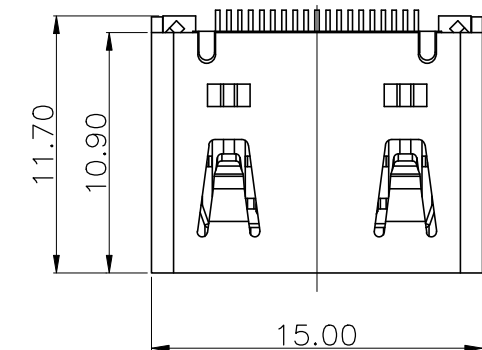

0.10  
(19 TIMES)

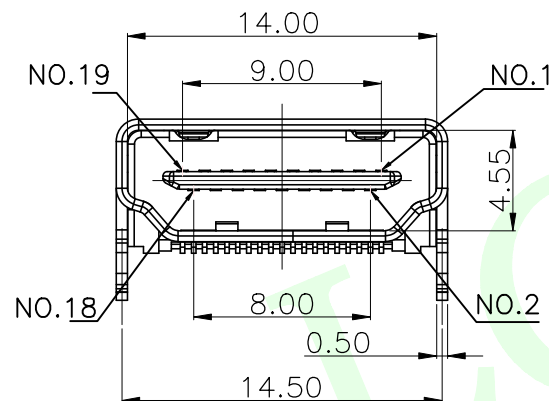
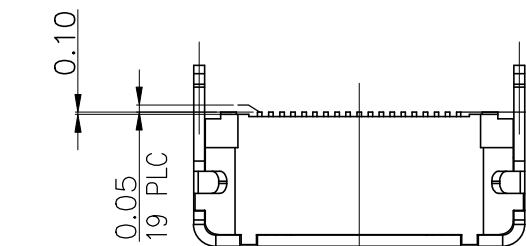
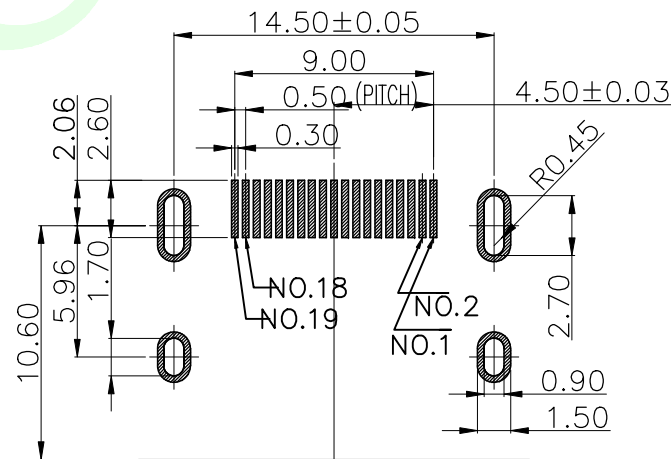
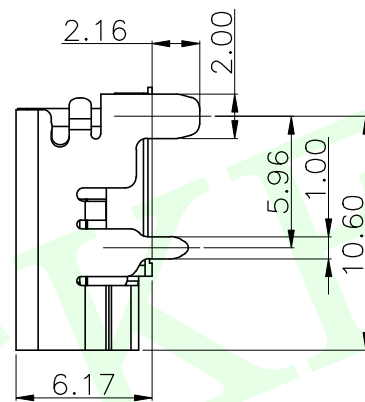

RECOMMENDED PCB LAYOUT (T=1.60)  
TOLERANCES UNLESS OTHERWISE  
SPEC. ±0.05

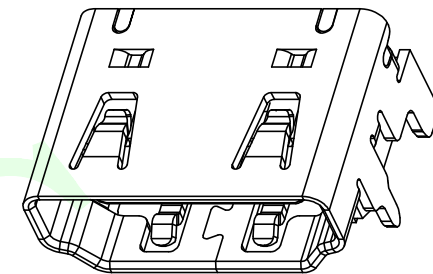
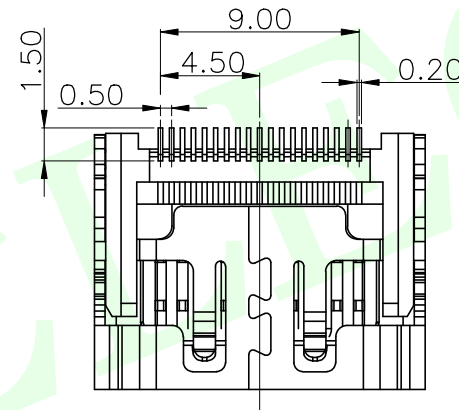

备注:

- 材质:  
1-1 塑胶: LCP E475 UL94V-0, 颜色: 黑色  
1-2 端子: 黄铜 C2680-H  
1-3 铁壳: 铁材 SPCC
- 电镀:  
端子接触区域: 镀金1u".  
端子锡脚: 镀雾锡 80u"Min.  
端子整个表面: 镀镍 50u"Min.  
铁壳: 镀光亮可焊镍100u".
- 电气性能:  
3-1 端子额定电流: 0.5A  
3-2 耐电压: 500V 交流电  
3-3 接触电阻: 100mΩ Max  
3-4 绝缘阻抗:  
公母未对插绝缘阻抗100 兆欧最小  
公母对插后绝缘阻抗10 兆欧最小
- 机械性能  
4-1 插入力: 4.5kgf MAX  
4-2 拔出力: 1.0~4.0kgf
- 环境  
温度范围: -25° C TO +85° C
- 零件必须符合ROHS标准.
- ▼ 符号为重点检验尺寸.

2	外壳	SPCC 麻面 T=0.50mm 电镀镍80u"	1Pcs
1	MD主体	Molding主体~9.8*13.96*6.0mm~LCP~黑色 (0.5u"金)	1Pcs
NO.	品名	规格	数量

MEASURE POINT:	QP
QUADRANT POINT	TP
TANGENCY POINT	IP
INTERSECTION POINT	
UNLESS OTHERWISE SPECIFIED, TOLERANCE:	
X.	±0.25
X.x	±0.20
X.xx	±0.15
ANGULAR	±3°

联晟欣连接器 (深圳) 有限公司 Lianshengxin Connector (Shenzhen) Co., Ltd				
DESIGN	Andy	DATE	2014.12.24	TITLE:
CHECKED		DATE		HDMI TYPE-A/F端子镀金0.5u"黑色
APPROVED		DATE		载带热封
PART NO:	LCK-HDMI-1001	REV:	04	SCALE: 1:1
DRAWING NO:		SIZE:	A4	UNIT: mm
		SHEET:	1/1	