

Features

- ◆ Low turn-on voltage
- ◆ Fast switching
- ◆ Also available in lead free version

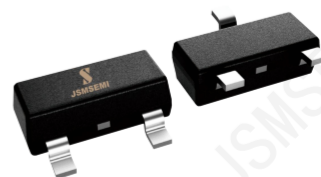

SOT23

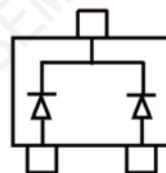

Equivalent Circuit

Absolute Maximum Ratings(TA=25℃)

Symbol	Parameter	Value	Unit
V_R	DC Blocking Voltage	70	V
I_F	Forward Continuous Current	70	mA
I_{FSM}	Non-repetitive Peak Forward Surge Current@8.3mS	100	mA
P_d	Power Dissipation	200	mW
$R_{\theta JA}$	Thermal Resistance From Junction To Ambient	500	°C/W
T_J	Operating Junction Temperature Range	-40~+125	°C
T_{stg}	Storage Temperature Range	-55~+150	°C

Electrical Characteristics (TA=25℃ unless otherwise specified)

Symbol	Parameter	Test conditions	Min	Max	Unit
$V_{(BR)}$	Reverse breakdown voltage	$I_R=10\mu A$	70		V
I_R	Reverse current	$V_R=50V$		100	nA
V_F	Forward voltage	$I_F=1mA$		410	mV
		$I_F=15mA$		1000	mV
C_D	Diode capacitance	$V_R=0V, f=1MHz$		2	pF
t_{rr}	Reverse recovery time	$I_F=I_R=10mA, I_{rr}=0.1I_R, R_L=100\Omega$		5	nS

Typical Characteristics

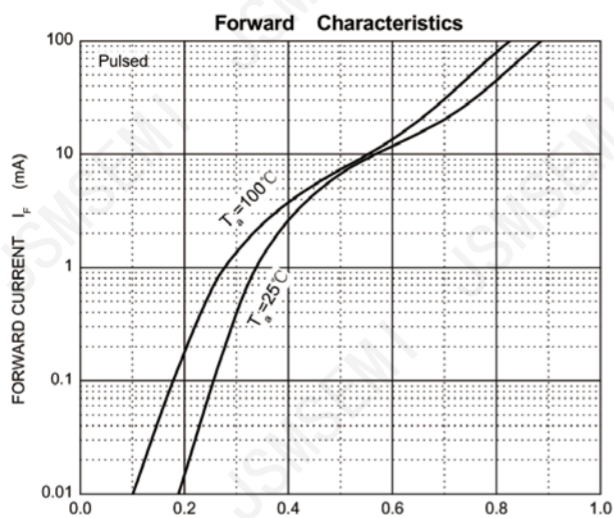

FORWARD VOLTAGE V_F (V)

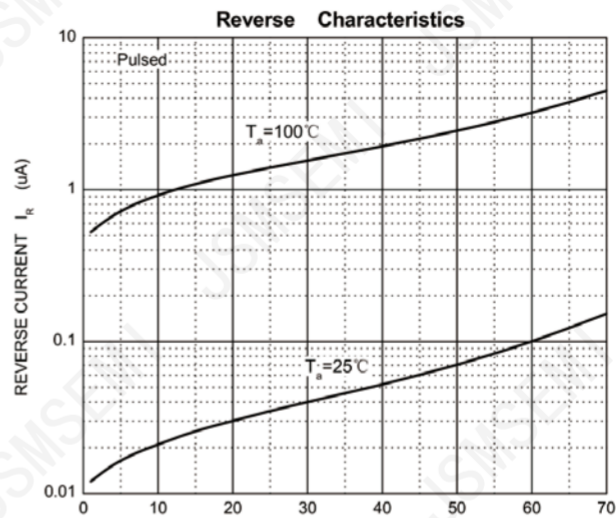

REVERSE VOLTAGE V_R (V)

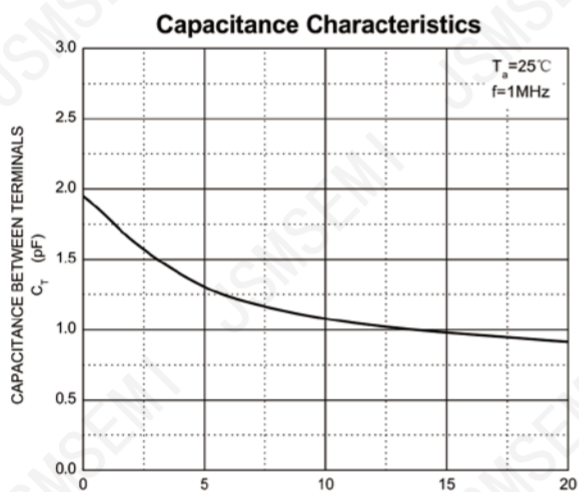

REVERSE VOLTAGE V_R (V)

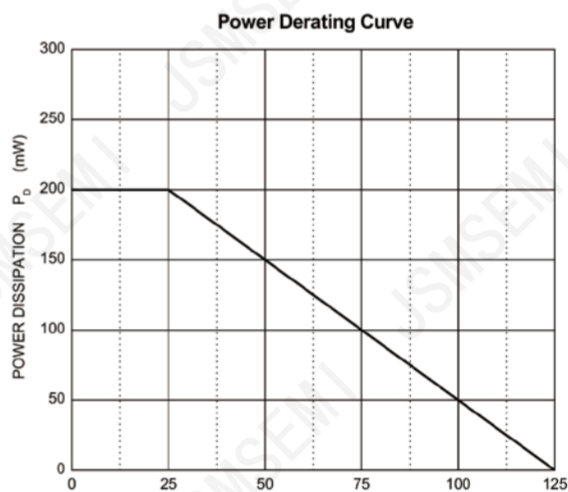

AMBIENT TEMPERATURE T_a ($^\circ\text{C}$)

Package Outline Dimensions

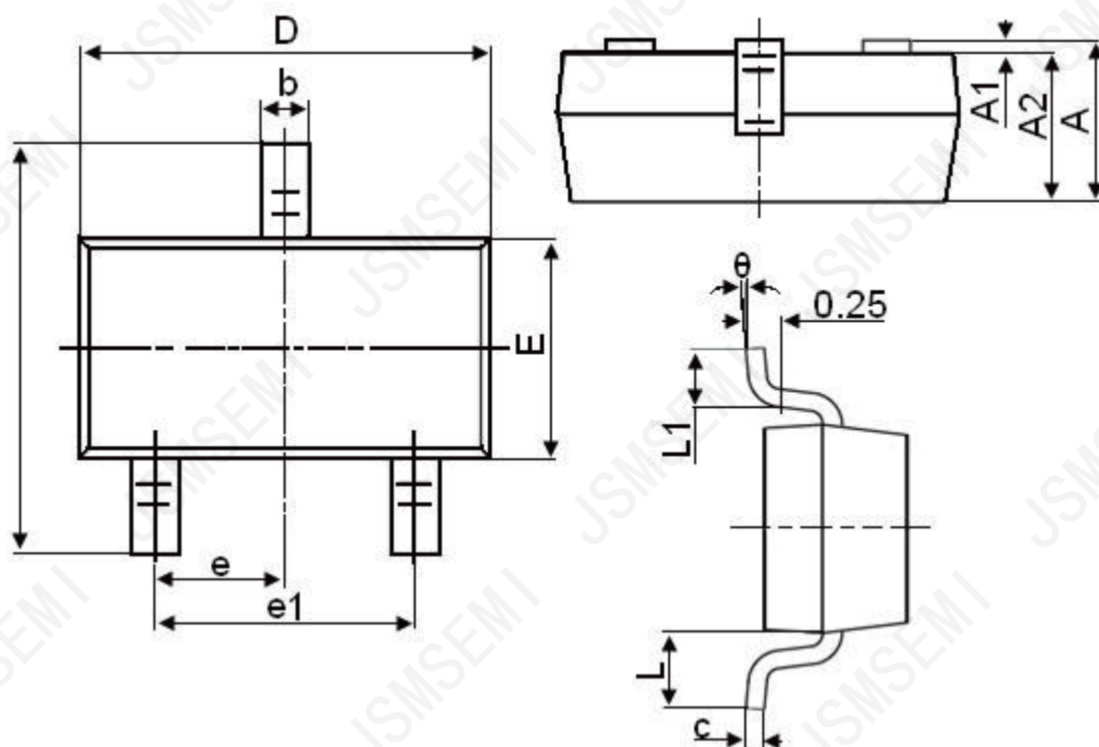

Symbol	Dimensions in Millimeters	
	mm	
	Min	Max
A	0.900	1.150
A1	0.000	0.100
A2	0.900	1.050
b	0.300	0.500
c	0.080	0.150
D	2.800	3.000
E	1.200	1.400
E1	2.250	2.550
e	0.950TYP	
e1	1.800	2.000
L	0.550REF	
L1	0.300	0.500
θ	0°	8°

Revision History

Rev.	Change	Date
V1.0	Initial version	2/23/2024

Important Notice

JSMSEMI Semiconductor (JSMSEMI) PRODUCTS ARE NEITHER DESIGNED NOR INTENDED FOR USE IN MILITARY AND/OR AEROSPACE, AUTOMOTIVE OR MEDICAL DEVICES OR SYSTEMS UNLESS THE SPECIFIC JSMSEMI PRODUCTS ARE SPECIFICALLY DESIGNATED BY JSMSEMI FOR SUCH USE. BUYERS ACKNOWLEDGE AND AGREE THAT ANY SUCH USE OF JSMSEMI PRODUCTS WHICH JSMSEMI HAS NOT DESIGNATED FOR USE IN MILITARY AND/OR AEROSPACE, AUTOMOTIVE OR MEDICAL DEVICES OR SYSTEMS IS SOLELY AT THE BUYER' S RISK.

JSMSEMI assumes no liability for application assistance or customer product design. Customers are responsible for their products and applications using JSMSEMI products.

Resale of JSMSEMI products or services with statements diferent from or beyond the parameters stated by JSMSEMI for that product or service voids all express and any implied warranties for the associated JSMSEMI product or s ervice. JSMSEMI is not responsible or liable for any such statements.

JSMSEMI All Rights Reserved. Information and data in this document are owned by JSMSEMI wholly and may not be edited, reproduced, or redistributed in any way without the express written consent from JSMSEMI.

Any and all information described or contained herein are subject to change without notice due to product/technology improvement, etc. When designing equipment, refer to the "Delivery Specification" for the JSMSEMI product that you intend to use.

For additional information please contact Kevin@jsmsemi.com or visit www.jsmsemi.com