

DESCRIPTION

The MBR60100CT meet the ROHS and Green Product requirement with full function reliability approved.

FEATURE

- *Low power loss, high efficiency.
- *High surge capacity.
- *High frequency operation.
- *For use in low voltage, high frequency inverters, free wheeling, and polarity protection applications.
- *Metal silicon junction, majority carrier conduction.
- *High current Capability, low forward voltage drop.
- *Guard ring for over voltage protection.

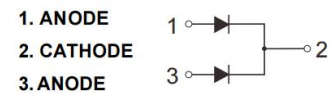

MARKING



WPM : LOGO

MBR60100CT=Device Code

ABSOLUTE MAXIMUM RATINGS($T_A=25^\circ\text{C}$, unless otherwise specified.)

Parameter		Symbol	Value	Unit
Maximum repetitive peak reverse voltage		VRRM	100	V
Maximum average forward rectified current	Per leg	IF(AV)	30	A
	Total device		60	
Peak forward surge current 8.3ms single half sine-wave superimposed on rated load (JEDEC method at rated TL)		IFSM	300	A
Operating junction and Storage temperature range		TJ ,Tstg	-55 to+150	$^\circ\text{C}$
Typical thermal resistance3)		R θ JC	2.5	$^\circ\text{C/W}$

ELECTRICAL CHARACTERISTICS ($T_A=25^\circ\text{C}$, unless otherwise specified)

Parameter	Test Conditions		Symbol	TYP.	MAX.	Unit
Instaneous forward voltage (Per leg)	IF=10.0A		VF	0.75		V
	IF=20.0A			0.85	0.9	
Reverse Current	VR=100V	TA=25℃	IR		50	μA
		TA=125℃		8		mA

TYPICAL CHARACTERISTICS

FIG. 1- FORWARD CURRENT DERATING CURVE

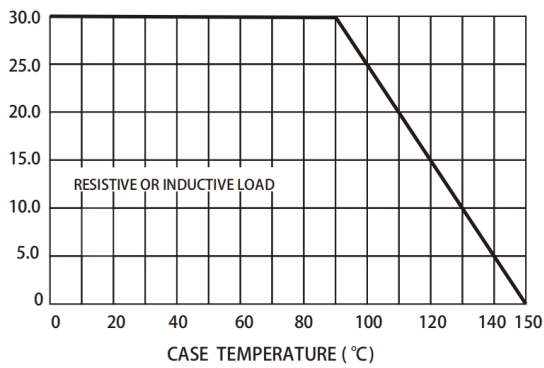

FIG. 2-MAXIMUM NON-REPETITIVE PEAK FORWARD SURGE CURRENT

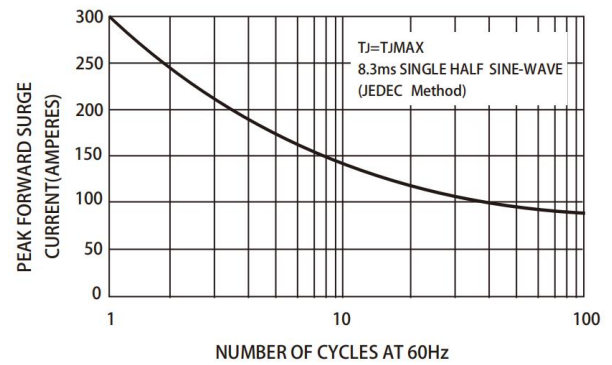

FIG. 3-TYPICAL INSTANTANEOUS FORWARD CHARACTERISTICS

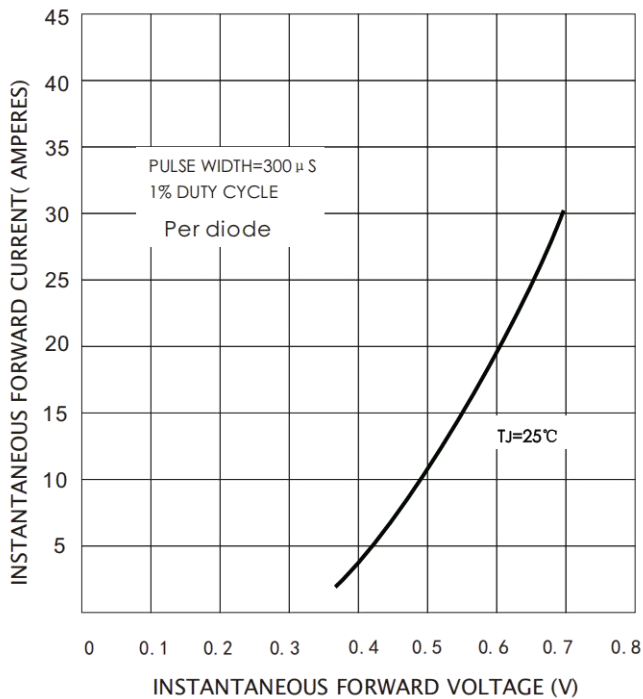
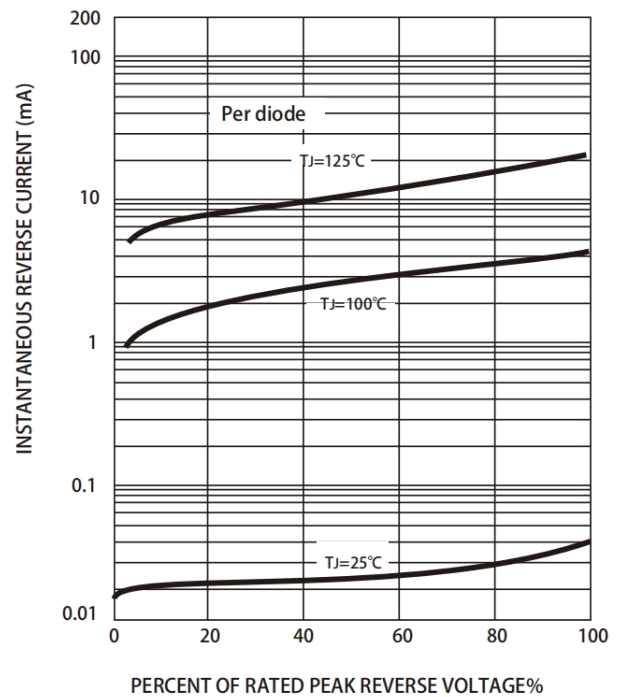
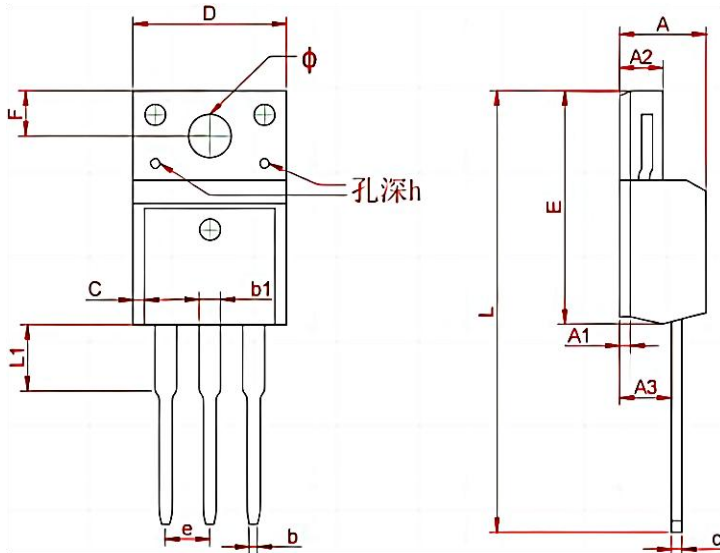

FIG. 4-TYPICAL REVERSE CHARACTERISTICS



TO - 220F Package Outline Dimensions



Symbol	Dimensions In Millimeters	
	Min	Max
A	4.300	4.750
A1	0.7 REF	
A2	2.300	2.850
A3	2.500	2.900
b	0.380	0.420
b1	1.220	1.280
C	1.08	1.200
c	0.480	0.520
D	10.15	10.450
E	15.700	15.950
e	2.574 TYP	
F	3.470 REF	
y	3.200 REF	
h	0.000	0.800
L	28.780	28.900
L1	2.990	3.100

TO - 220F Packing Information



50PCS

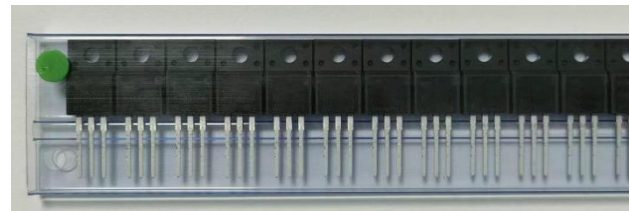

20 Tube



Outer Box

5 Inner
Box



Inner Box

Package version	Tube dimensions LxWxH (mm)	Per Tube (pcs)	Tube per box	Inner box dimensions LxWxH (mm)	PCS/ Inner box	Outer box dimensions LxWxH(mm)	PCS/ Outer box
TO-220F	530*32*7	50	20	580*155*50	1000	602*277*188	5000

WPMtek reserves the right to make changes to the product specification and data in this document without notice. WPMtek makes no warranty, representation or guarantee regarding the suitability of its products for any particular purpose, nor does WPMtek assume any liability arising from the application or use of any products or circuits, and specifically disclaims any and all liability, including without limitation special, consequential or incidental damages. Any enquiry, please write to sales@wpmtek.com for further information.