

RoHS Compliant

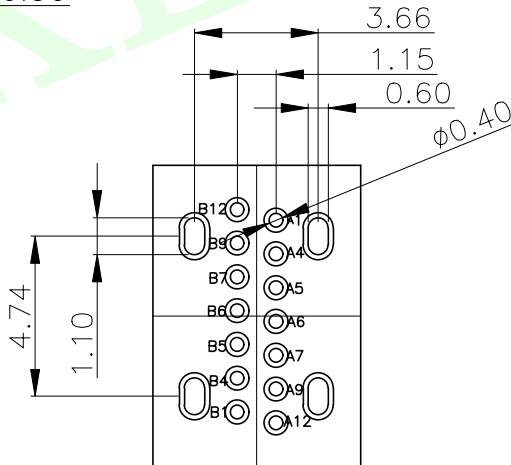
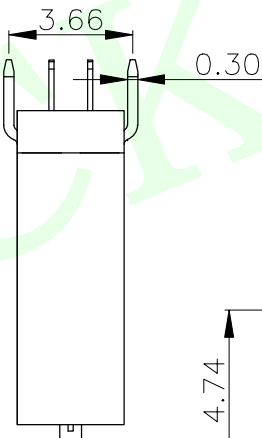
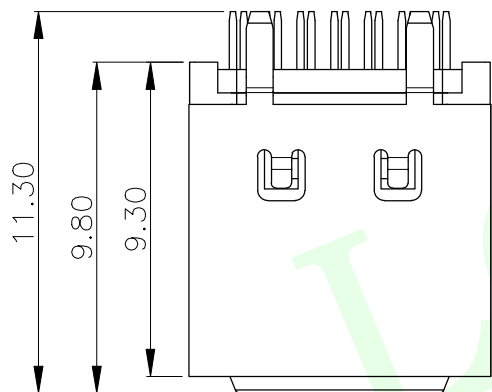
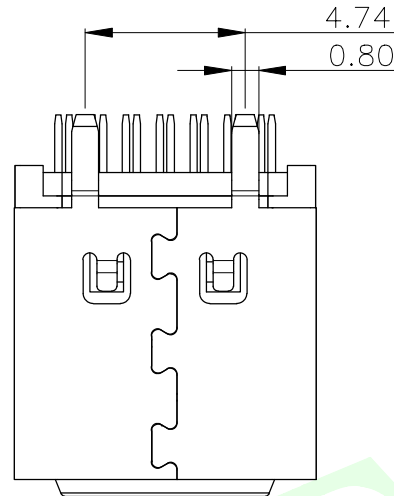
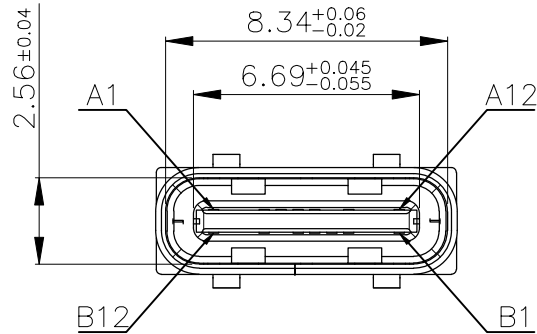

PIN DEFINE TABLE			
PIN	SIGNAL	PIN	SIGNAL
A12	GND	B1	GND
A11		B2	
A10		B3	
A9	VBUS	B4	VBUS
A8		B5	CC2
A7	D-	B6	D+
A6	D+	B7	D-
A5	CC1	B8	
A4	VBUS	B9	VBUS
A3		B10	
A2		B11	
A1	GND	B12	GND

备注:

1. 材质:

1.1 胶芯: LCP+30%G.F UL94V-0

1.2 端子: 黄铜C2680 : 镍底50U" MIN

接触区域镀金 (AU 1u") 焊接区域镀金G/F

1.3 外壳: SUS304, T=0.30mm: 表面镀镍50U" MIN

1.4 中夹片: SUS301:

2. 主要特性:

2.1 额定电流: 5A

2.2 接触阻抗: 40mΩ MAX (初始值)

50mΩ MAX (测试后)

2.3 绝缘阻抗: 100MΩ MIN

2.4 耐压测试: 100V AC R M S

2.5 整体插入力: 5-20N 整体插入力: 5-20N (耐久后)

整体拔出: 8-20N 整体拔出: 6-20N (耐久后)

2.6 耐久: 5000次

2.7 耐高温: SMT回流焊 (峰值260° ±5°), 塑胶不能有起泡, 融胶等不良, 变色, 翘曲变形在公差范围以内。

2.8 产品须做焊锡测试, 粘锡面积达到95%以上:

2.9 盐雾测试: 24H MIN

3.0 工作温度: -25℃ ~ +80℃

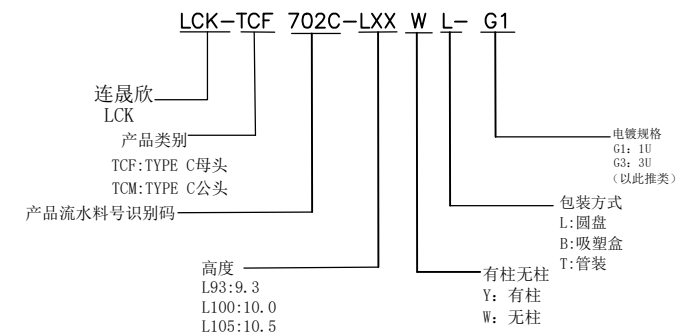

RECOMMENDED P.C.B. LAYOUT
TOLERANCE UNSPECIFIED ±0.05mm

MEASURE POINT:
QUADRANT POINT (QP)
TANGENCY POINT (TP)
INTERSECTION POINT (IP)

UNLESS OTHERWISE
SPECIFIED, TOLERANCE:
X. ±0.25
X.X ±0.20
X.XX ±0.15
ANGULAR ±3°

联晟欣连接器 (深圳) 有限公司
Lianshengxin Connector (Shenzhen) Co., Ltd

DESIGN	Andy	DATE	2014.12.24	TITLE:
CHECKED		DATE		TYPE C 14PIN母座立插10.0&10.5
APPROVED		DATE		
PART NO:	LCK-TCF702C-LXXXWL-G1	REV:	04	SCALE: 1:1
DRAWING NO:		SIZE:	A4	SHEET: 1/1

RoHS Compliant

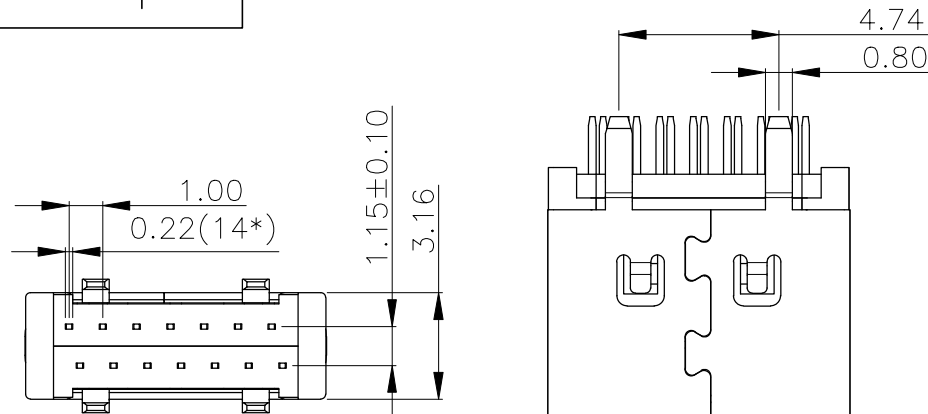

PIN DEFINE TABLE			
PIN	SIGNAL	PIN	SIGNAL
A12	GND	B1	GND
A11		B2	
A10		B3	
A9	VBUS	B4	VBUS
A8		B5	CC2
A7	D-	B6	D+
A6	D+	B7	D-
A5	CC1	B8	
A4	VBUS	B9	VBUS
A3		B10	
A2		B11	
A1	GND	B12	GND

备注:

1. 材质:

1.1胶芯: LCP+30%G.F UL94V-0

1.2端子: 黄铜C2680 : 镍底50U" MIN

接触区域镀金 (AU 1u") 焊接区域镀金G/F

1.3外壳: SUS304, T=0.30mm: 表面镀镍50U" MIN

1.4中夹片: SUS301:

2. 主要特性:

2.1额定电流: 5A

2.2接触阻抗: 40mΩ MAX (初始值)

50mΩ MAX (测试后)

2.3绝缘阻抗: 100MΩ MIN

2.4耐压测试: 100V AC R M S

2.5整体插入力: 5-20N 整体插入力: 5-20N (耐久后)

整体拔出: 8-20N 整体拔出: 6-20N (耐久后)

2.6耐久: 5000次

2.7耐高温: SMT回流焊 (峰值260° ±5°), 塑胶不能有起泡, 融胶等不良, 变色, 翘曲变形在公差范围以内。

2.8产品须做锡焊测试, 粘锡面积达到95%以上:

2.9盐雾测试: 24H MIN

3.0工作温度: -25℃ ~ +80℃

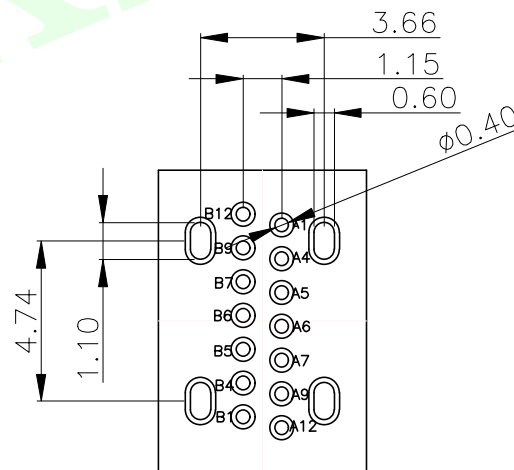
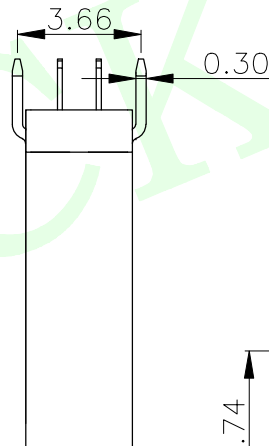
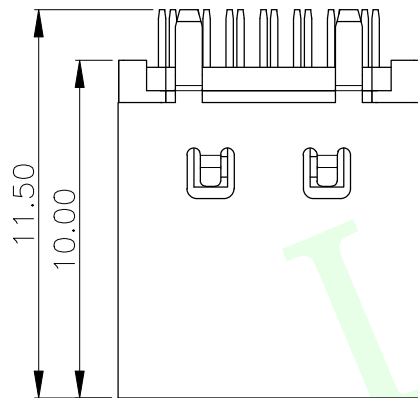

RECOMMENDED P.C.B. LAYOUT
TOLERANCE UNSPECIFIED ±0.05mm

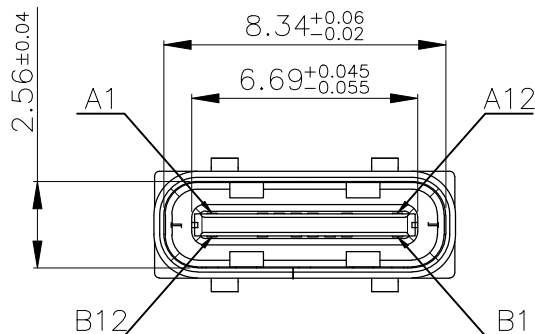
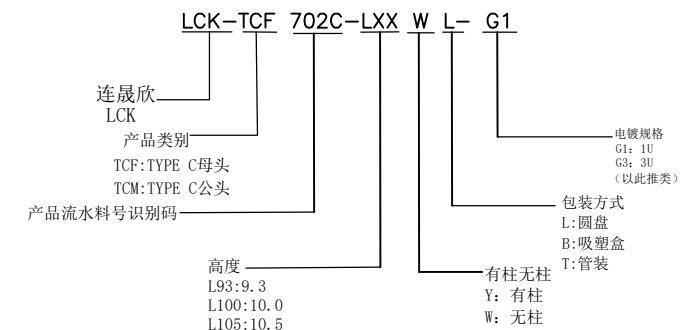

MEASURE POINT: QUADRANT POINT (QP) TANGENCY POINT (TP) INTERSECTION POINT (IP)		UNLESS OTHERWISE SPECIFIED, TOLERANCE:		DESIGN: Andy		DATE: 2014.12.24		TITLE: TYPE C 14PIN母座立插10.0&10.5	
X. ±0.25		X.x ±0.20		APPROVED		DATE		REV: 04	
X.xx ±0.15		ANGULAR ±3°		PART NO: LCK-TCF702C-LXXXWL-G1		REV: 04		SCALE: 1:1	
DRAWING NO:		SIZE: A4		SHEET: 1/1		UNIT: mm			

RoHS Compliant

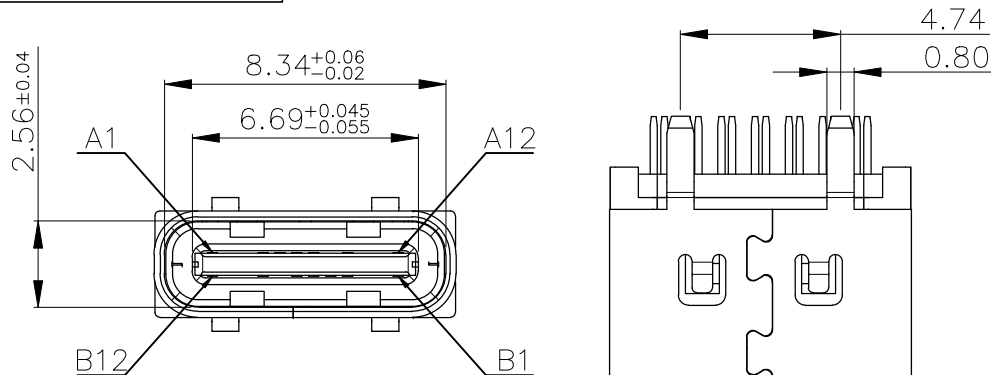

PIN DEFINE TABLE			
PIN	SIGNAL	PIN	SIGNAL
A12	GND	B1	GND
A11		B2	
A10		B3	
A9	VBUS	B4	VBUS
A8		B5	CC2
A7	D-	B6	D+
A6	D+	B7	D-
A5	CC1	B8	
A4	VBUS	B9	VBUS
A3		B10	
A2		B11	
A1	GND	B12	GND

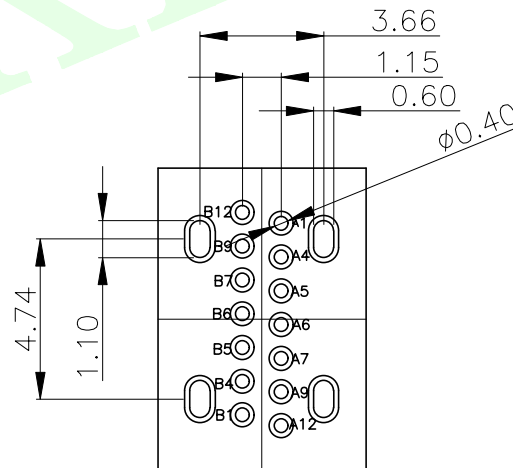
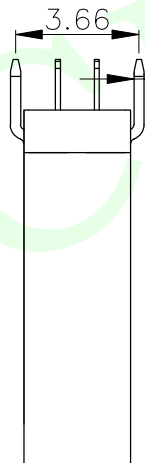
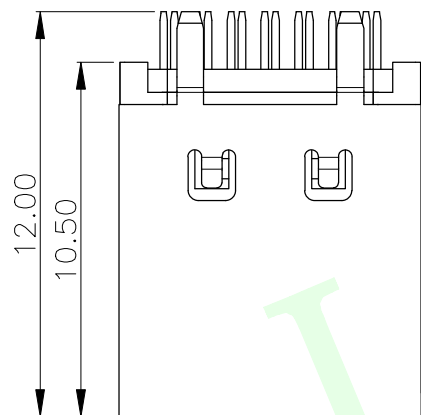

RECOMMENDED P.C.B. LAYOUT
TOLERANCE UNSPECIFIED $\pm 0.05\text{mm}$

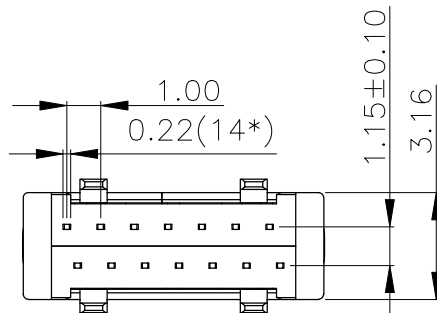

- 备注:
1. 材质:
 - 1.1 胶芯: LCP+30%G.F UL94V-0
 - 1.2 端子: 黄铜C2680 : 镍底50U" MIN
接触区域镀金 (AU 1u") 焊接区域镀金G/F
 - 1.3 外壳: SUS304, T=0.30mm: 表面镀镍50U" MIN
 - 1.4 中夹片: SUS301:
 2. 主要特性:
 - 2.1 额定电流: 5A
 - 2.2 接触阻抗: 40mΩ MAX (初始值)
50mΩ MAX (测试后)
 - 2.3 绝缘阻抗: 100MΩ MIN
 - 2.4 耐压测试: 100V AC R M S
 - 2.5 整体插入力: 5-20N 整体插入力: 5-20N (耐久后)
整体拔出: 8-20N 整体拔出: 6-20N (耐久后)
 - 2.6 耐久: 5000次
 - 2.7 耐高温: SMT回流焊 (峰值260° ±5°), 塑胶不能有起泡, 融胶等不良, 变色, 翘曲变形在公差范围以内。
 - 2.8 产品须做焊锡测试, 粘锡面积达到95%以上:
 - 2.9 盐雾测试: 24H MIN
 - 2.10 工作温度: -25℃~+80℃

LCK-TCF 702C-LXX W L- G1

连晟欣
LCK

产品类别
TCF: TYPE C 母头
TCM: TYPE C 公头

产品流水料号识别码

高度
L93: 9.3
L100: 10.0
L105: 10.5

电镀规格
G1: 1U
G3: 3U
(以此类推)

包装方式
L: 圆盘
B: 吸塑盒
T: 管装

有柱无柱
Y: 有柱
W: 无柱

MEASURE POINT: QUADRANT POINT TANGENCY POINT INTERSECTION POINT		UNLESS OTHERWISE SPECIFIED, TOLERANCE:		DESIGN Andy		DATE 2014.12.24		TITLE: TYPE C 14PIN母座立插9.3&10.0&10.5	
X.		±0.25		CHECKED		DATE		REV: 04	
X.x		±0.20		APPROVED		DATE		SCALE: 1:1	
X.xx		±0.15		PART NO: LCK-TCF702C-LXXXWL-G1		REV: 04		UNIT: mm	
ANGULAR		±3°		DRAWING NO:		SIZE: A4		SHEET: 1/1	