

RoHS Compliant

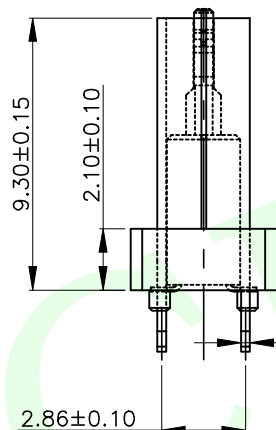
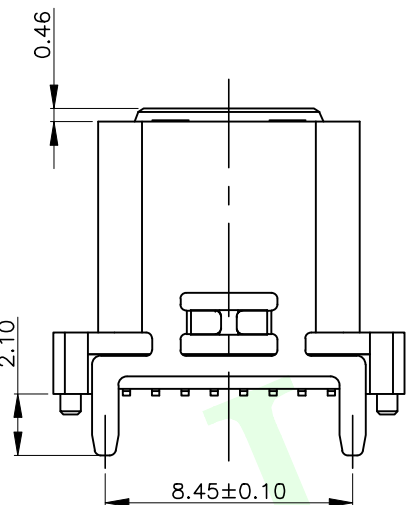
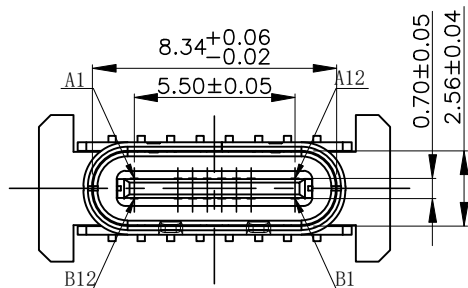

USB TYPE-C PIN ASSIGNMENTS

PIN NUMBER	SIGNAL NAME
A1	GND
A4	VBUS
A5	CC1
A6	Dp1
A7	Dn1
A8	SBU1
A9	VBUS
A12	GND

PIN NUMBER	SIGNAL NAME
B12	GND
B9	VBUS
B8	SBU2
B7	Dn2
B6	Dp2
B5	CC2
B4	VBUS
B1	GND

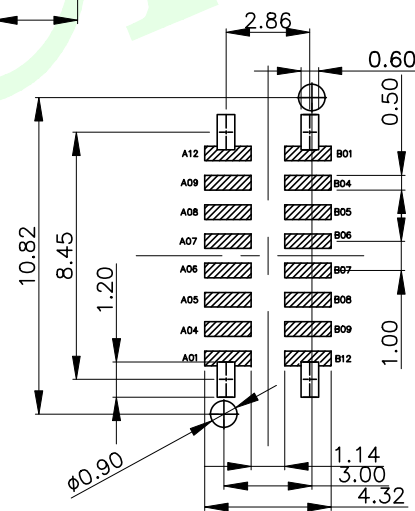
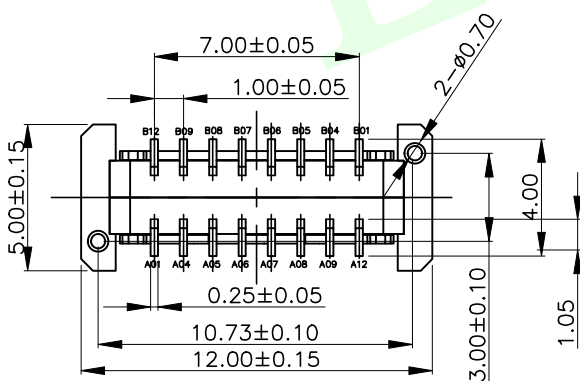

RECOMMENDED P.C.B. LAYOUT (俯视图)
TOLERANCE UNSPECIFIED ±0.05mm

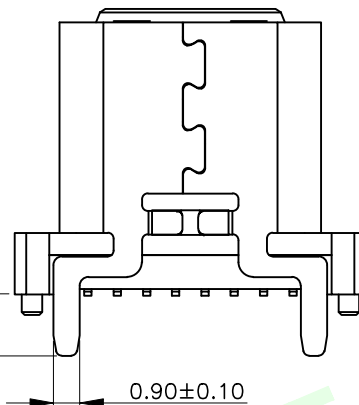

备注:

1. 材质:

1.1胶芯: LCP+30%G.F UL94V-0

1.2端子: C7025 : 镍底50U" MIN

接触区域镀金 (AU 1u")焊接区域镀金G/F

1.3外壳: SUS304, T=0.30mm: 表面镀镍30U" MIN

1.4中夹片: SUS301:

2. 主要特性:

2.1额定电流: 5A

2.2接触阻抗: 40mΩ MAX (初始值)

50mΩ MAX (测试后)

2.3绝缘阻抗: 100MΩ MIN

2.4耐压测试: 100V AC R M S

2.5整体插入力: 5-20N 整体插入力: 5-20N (耐久后)

整体拔出力: 8-20N 整体拔出力: 6-20N (耐久后)

2.6耐久: 10000次

2.7耐高温: SMT回流焊 (峰值260° ±5°), 塑胶不能有起泡, 融胶等不良, 变色, 翘曲变形在公差范围以内。

2.8产品须做焊锡测试, 粘锡面积达到95%以上:

2.9盐雾测试: 24H MIN

3.0工作温度: -25℃~+80℃

LCK-TCF 829 -LXXX Y L- G1

连晟欣

LCK

产品类别

TCF:TYPE C母头

TCM:TYPE C公头

产品流水料号识别码

壳长

L93: 9.3

L100: 10.0

L105: 10.5

.....

L185: 18.5

有柱无柱

Y: 有柱

W: 无柱

包装方式

L: 圆盘

B: 吸塑盒

T: 管装

电镀规格

G1: 1U

G3: 3U

(以此类推)

QUADRANT POINT (QP)	联晟欣连接器 (深圳) 有限公司			
TANGENCY POINT (TP)	Lianshengxin Connector (Shenzhen) Co., Ltd			
INTERSECTION POINT (IP)				
UNLESS OTHERWISE SPECIFIED, TOLERANCE:	DESIGN	Andy	DATE	2014.12.24
X. ±0.25	CHECKED		DATE	
X.x ±0.20	APPROVED		DATE	
X.xx ±0.15	PART NO:	LCK-TCF829-L93YL-G1	REV:	04
ANGULAR ±3°	DRAWING NO:		SCALE:	1:1
			UNIT:	mm
			SHEET:	1/1

RoHS Compliant

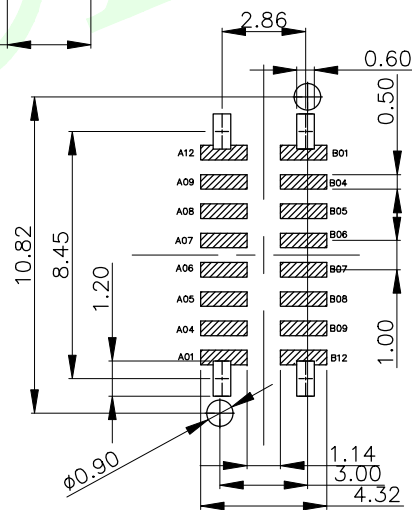
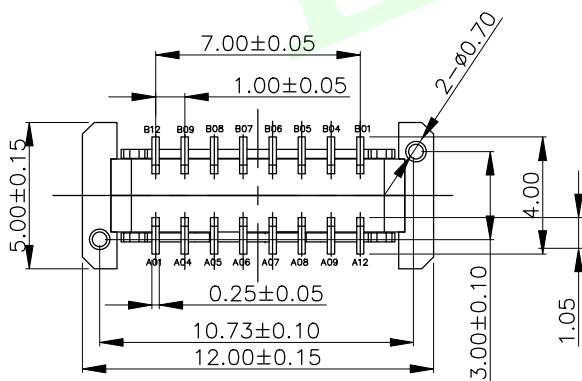
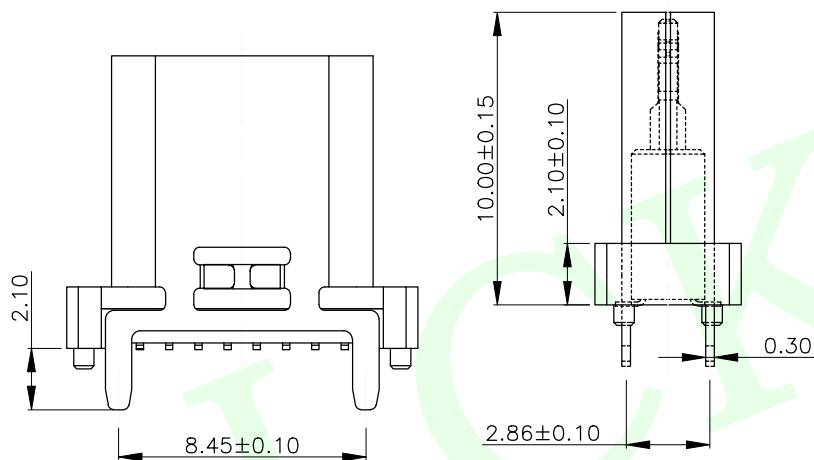
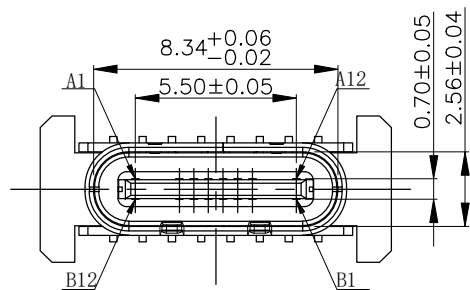

RECOMMENDED P.C.B. LAYOUT (俯视图)
TOLERANCE UNSPECIFIED ±0.05mm

备注:

1. 材质:

1.1 胶芯: LCP+30%G.F UL94V-0

1.2 端子: C7025 : 镍底50U" MIN

接触区域镀金 (AU 1u") 焊接区域镀金G/F

1.3 外壳: SUS304, T=0.30mm: 表面镀镍30U" MIN

1.4 中夹片: SUS301:

2. 主要特性:

2.1 额定电流: 5A

2.2 接触阻抗: 40mΩ MAX (初始值)

50mΩ MAX (测试后)

2.3 绝缘阻抗: 100MΩ MIN

2.4 耐压测试: 100V AC R M S

2.5 整体插入力: 5-20N 整体插入力: 5-20N (耐久后)

整体拔出: 8-20N 整体拔出: 6-20N (耐久后)

2.6 耐久: 10000次

2.7 耐高温: SMT回流焊 (峰值260° ±5°), 塑胶不能有起泡, 融胶等不良, 变色, 翘曲变形在公差范围以内。

2.8 产品须做焊锡测试, 粘锡面积达到95%以上:

2.9 盐雾测试: 24H MIN

3.0 工作温度: -25℃ ~ +80℃

USB TYPE-C PIN ASSIGNMENTS

PIN NUMBER	SIGNAL NAME	PIN NUMBER	SIGNAL NAME
A1	GND	B12	GND
A4	VBUS	B9	VBUS
A5	CC1	B8	SBU2
A6	Dp1	B7	Dn2
A7	Dn1	B6	Dp2
A8	SBU1	B5	CC2
A9	VBUS	B4	VBUS
A12	GND	B1	GND

QUADRANT POINT (QP)
TANGENCY POINT (TP)
INTERSECTION POINT (IP)

UNLESS OTHERWISE SPECIFIED, TOLERANCE:

X. ±0.25
X.x ±0.20
X.xx ±0.15
ANGULAR ±3°



联晟欣连接器 (深圳) 有限公司
Lianshengxin Connector (Shenzhen) Co., Ltd

DESIGN	Andy	DATE	2014.12.24	TITLE:
CHECKED		DATE		TYPE C 16PIN 母座立贴10.0mm
APPROVED		DATE		
PART NO:	LCK-TCF829-L100YL-G1	REV:	04	SCALE: 1:1
DRAWING NO:		SIZE:	A4	SHEET: 1/1

RoHS Compliant

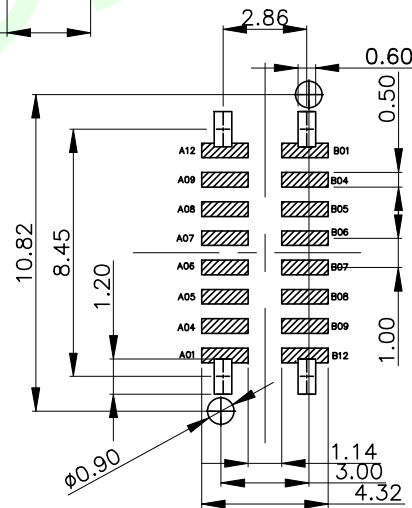
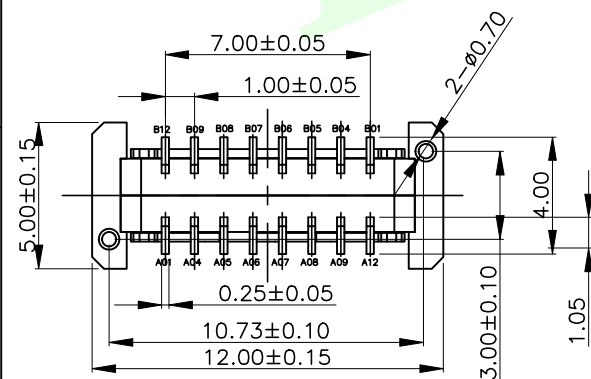
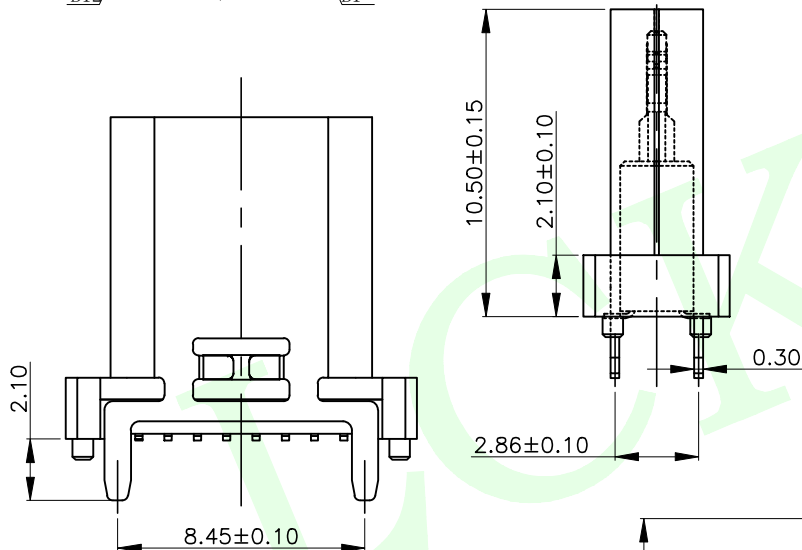
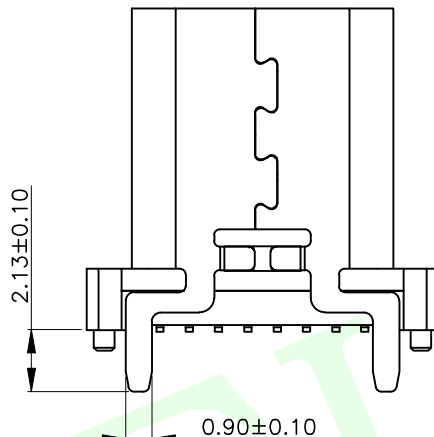
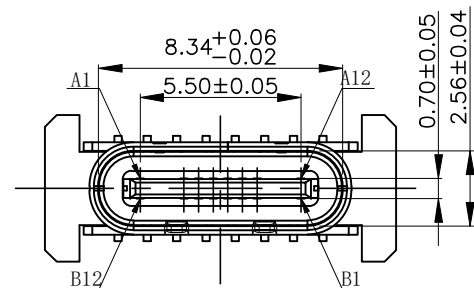

RECOMMENDED P.C.B. LAYOUT (俯视图)
TOLERANCE UNSPECIFIED ±0.05mm

备注:

1. 材质:

1.1 胶芯: LCP+30%G.F UL94V-0

1.2 端子: C7025 : 镍底50U" MIN

接触区域镀金 (AU 1u") 焊接区域镀金G/F

1.3 外壳: SUS304, T=0.30mm: 表面镀镍30U" MIN

1.4 中夹片: SUS301:

2. 主要特性:

2.1 额定电流: 5A

2.2 接触阻抗: 40mΩ MAX (初始值)

50mΩ MAX (测试后)

2.3 绝缘阻抗: 100MΩ MIN

2.4 耐压测试: 100V AC R M S

2.5 整体插入力: 5-20N 整体插入力: 5-20N (耐久后)

整体拔出力: 8-20N 整体拔出力: 6-20N (耐久后)

2.6 耐久: 10000次

2.7 耐高温: SMT回流焊 (峰值260° ±5°), 塑胶不能有起泡, 融胶等不良, 变色, 翘曲变形在公差范围以内。

2.8 产品须做焊锡测试, 粘锡面积达到95%以上:

2.9 盐雾测试: 24H MIN

3.0 工作温度: -25℃~+80℃

USB TYPE-C PIN ASSIGNMENTS

PIN NUMBER	SIGNAL NAME
A1	GND
A4	VBUS
A5	CC1
A6	Dp1
A7	Dn1
A8	SBU1
A9	VBUS
A12	GND

PIN NUMBER	SIGNAL NAME
B12	GND
B9	VBUS
B8	SBU2
B7	Dn2
B6	Dp2
B5	CC2
B4	VBUS
B1	GND

QUADRANT POINT (QP)
TANGENCY POINT (TP)
INTERSECTION POINT (IP)

UNLESS OTHERWISE
SPECIFIED, TOLERANCE:

X. ±0.25
X.x ±0.20
X.xx ±0.15
ANGULAR ±3°



联晟欣连接器 (深圳) 有限公司
Lianshengxin Connector (Shenzhen) Co., Ltd

DESIGN: Andy DATE: 2014.12.24 TITLE: TYPE C 16PIN 母座立贴10.5mm
CHECKED: DATE:
APPROVED: DATE:
PART NO: LCK-TCF829-L105YL-G1 REV: 04 SCALE: 1:1 UNIT: mm
DRAWING NO: SIZE: A4 SHEET: 1/1

RoHS Compliant

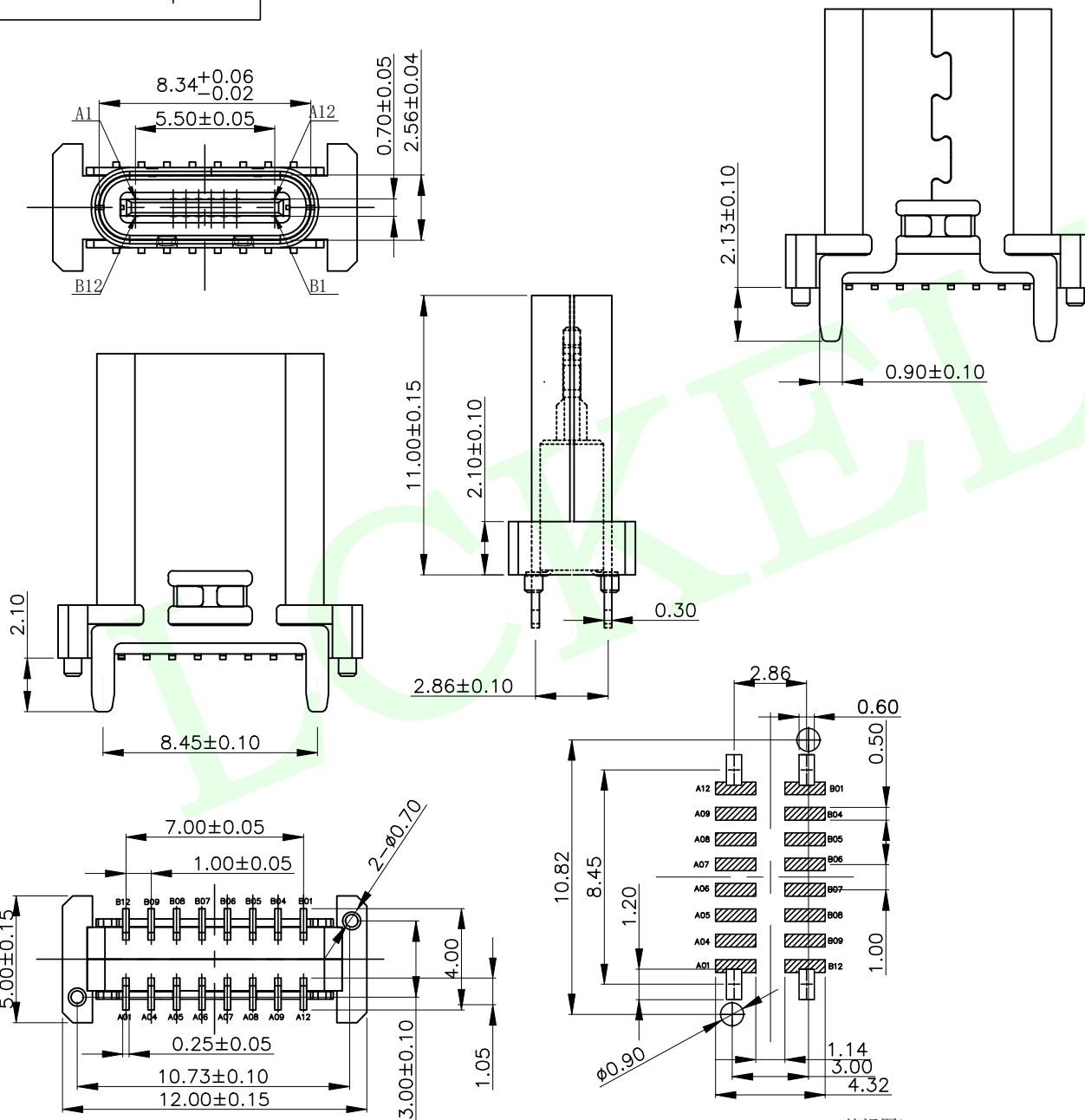

备注:

1. 材质:

1.1 胶芯: LCP+30%G.F UL94V-0

1.2 端子: C7025 : 镍底50U" MIN

接触区域镀金 (AU 1u") 焊接区域镀金G/F

1.3 外壳: SUS304, T=0.30mm: 表面镀镍30U" MIN

1.4 中夹片: SUS301:

2. 主要特性:

2.1 额定电流: 5A

2.2 接触阻抗: $40m\Omega$ MAX (初始值)

$50m\Omega$ MAX (测试后)

2.3 绝缘阻抗: $100M\Omega$ MIN

2.4 耐压测试: 100V AC R M S

2.5 整体插入力: 5-20N 整体插入力: 5-20N (耐久后)

整体拔出力: 8-20N 整体拔出力: 6-20N (耐久后)

2.6 耐久: 10000次

2.7 耐高温: SMT回流焊 (峰值 $260^{\circ} \pm 5^{\circ}$), 塑胶不能有起泡, 融胶等不良, 变色, 翘曲变形在公差范围以内。

2.8 产品须做焊锡测试, 粘锡面积达到95%以上:

2.9 盐雾测试: 24H MIN

3.0 工作温度: $-25^{\circ}C \sim +80^{\circ}C$

USB TYPE-C PIN ASSIGNMENTS

PIN NUMBER	SIGNAL NAME	PIN NUMBER	SIGNAL NAME
A1	GND	B12	GND
A4	VBUS	B9	VBUS
A5	CC1	B8	SBU2
A6	Dp1	B7	Dn2
A7	Dn1	B6	Dp2
A8	SBU1	B5	CC2
A9	VBUS	B4	VBUS
A12	GND	B1	GND

RECOMMENDED P.C.B. LAYOUT (俯视图)
TOLERANCE UNSPECIFIED $\pm 0.05mm$

QUADRANT POINT (QP)	 联晟欣连接器 (深圳) 有限公司 Lianshengxin Connector (Shenzhen) Co., Ltd				
TANGENCY POINT (TP)					
INTERSECTION POINT (IP)					
UNLESS OTHERWISE SPECIFIED, TOLERANCE:	DESIGN	Andy	DATE	2014.12.24	TITLE:
X. ± 0.25	CHECKED		DATE		TYPE C 16PIN 母座立贴11.0mm
X.x ± 0.20	APPROVED		DATE		
X.xx ± 0.15	PART NO:	LCK-TCF829-L110YL-G1	REV:	04	SCALE: 1:1
ANGULAR $\pm 3^{\circ}$	DRAWING NO:		SIZE:	A4	UNIT: mm
			SHEET:	1/1	

RoHS Compliant

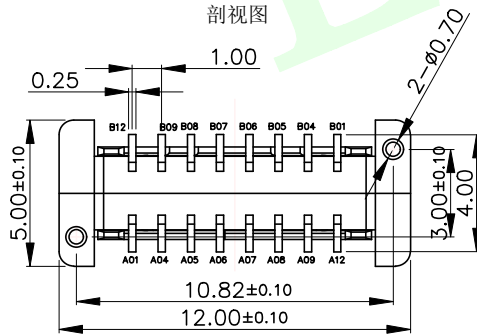
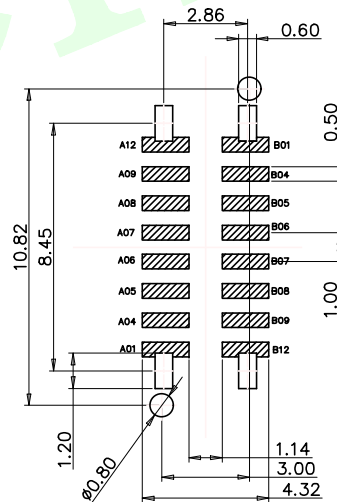
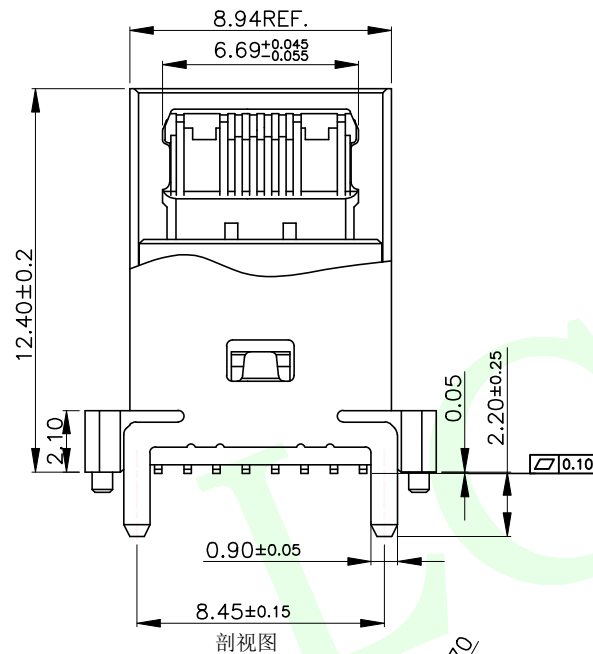
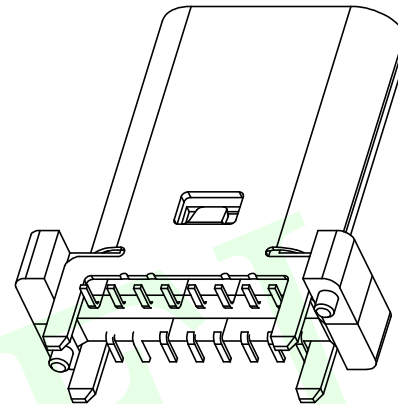
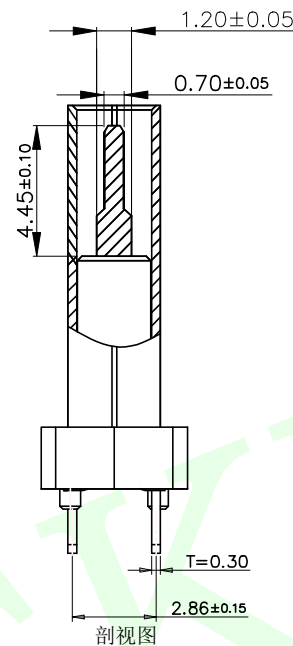
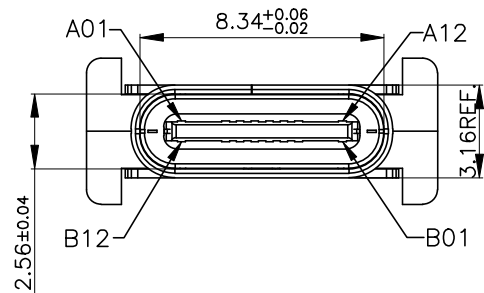

RECOMMENDED P.C.B. LAYOUT (俯视)
TOLERANCE UNSPECIFIED ±0.05mm

备注:

1. 材质:

1.1 胶芯: LCP+30%G.F UL94V-0

1.2 端子: C7025 : 镍底50U" MIN

接触区域镀金 (AU 1u") 焊接区域镀金G/F

1.3 外壳: SUS304, T=0.30mm: 表面镀镍30U" MIN

1.4 中夹片: SUS301:

2. 主要特性:

2.1 额定电流: 5A

2.2 接触阻抗: 40mΩ MAX (初始值)

50mΩ MAX (测试后)

2.3 绝缘阻抗: 100MΩ MIN

2.4 耐压测试: 100V AC R M S

2.5 整体插入力: 5-20N 整体插入力: 5-20N (耐久后)

整体拔出力: 8-20N 整体拔出力: 6-20N (耐久后)

2.6 耐久: 10000次

2.7 耐高温: SMT回流焊 (峰值260° ±5°), 塑胶不能有起泡, 融胶等不良, 变色, 翘曲变形在公差范围以内。

2.8 产品须做焊锡测试, 粘锡面积达到95%以上:

2.9 盐雾测试: 24H MIN

3.0 工作温度: -25℃ ~ +80℃

USB TYPE-C PIN ASSIGNMENTS

PIN NUMBER	SIGNAL NAME	PIN NUMBER	SIGNAL NAME
A1	GND	B12	GND
A4	VBUS	B9	VBUS
A5	CC1	B8	SBU2
A6	Dp1	B7	Dn2
A7	Dn1	B6	Dp2
A8	SBU1	B5	CC2
A9	VBUS	B4	VBUS
A12	GND	B1	GND

QUADRANT POINT TANGENCY POINT INTERSECTION POINT UNLESS OTHERWISE SPECIFIED, TOLERANCE: X. ±0.25 X.x ±0.20 X.xx ±0.15 ANGULAR ±3°	<div>QP</div> <div>TP</div> <div>IP</div>	<div> 联晟欣连接器（深圳）有限公司 Lianshengxin Connector (Shenzhen) Co., Ltd</div>					
		DESIGN	Andy	DATE	2014.12.24	TITLE:	
		CHECKED		DATE		TYPE C 16PIN 母座立贴12.4mm	
		APPROVED		DATE			
PART NO: LCK-TCF829-L124YL-G1				REV: 04	SCALE: 1:1	UNIT: mm	
DRAWING NO:				SIZE: A4	SHEET: 1/1		

RoHS Compliant

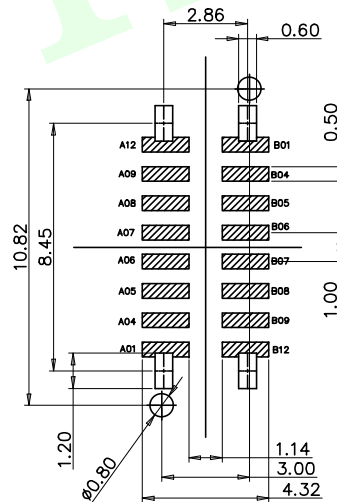
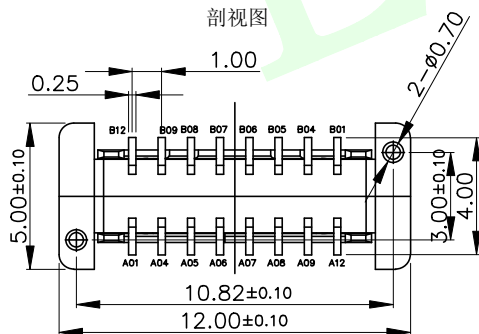
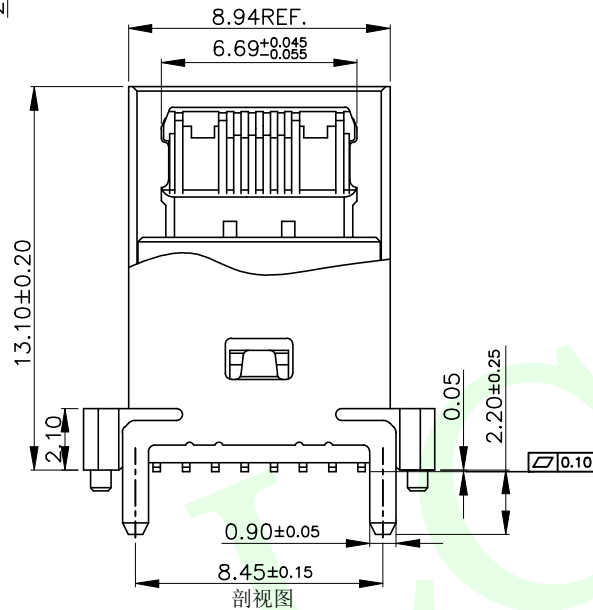
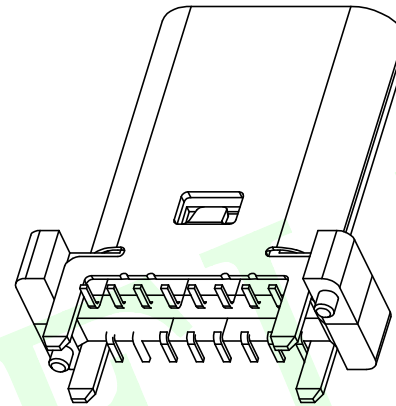
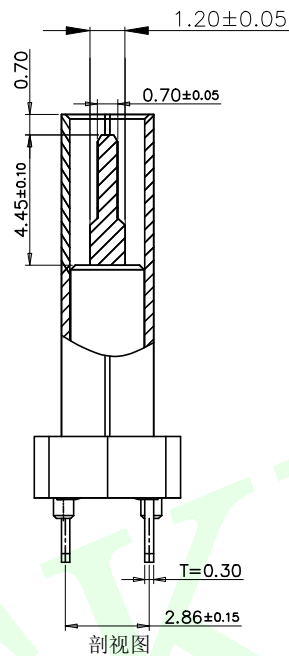
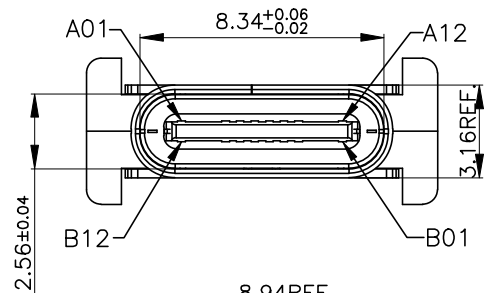

RECOMMENDED P.C.B. LAYOUT (俯视图)
TOLERANCE UNSPECIFIED ±0.05mm

备注:

1. 材质:

1.1 胶芯: LCP+30%G.F UL94V-0

1.2 端子: C7025 : 镍底50U" MIN

接触区域镀金 (AU 1u") 焊接区域镀金G/F

1.3 外壳: SUS304, T=0.30mm: 表面镀镍30U" MIN

1.4 中夹片: SUS301:

2. 主要特性:

2.1 额定电流: 5A

2.2 接触阻抗: 40mΩ MAX (初始值)

50mΩ MAX (测试后)

2.3 绝缘阻抗: 100MΩ MIN

2.4 耐压测试: 100V AC R M S

2.5 整体插入力: 5-20N 整体插入力: 5-20N (耐久后)

整体拔出力: 8-20N 整体拔出力: 6-20N (耐久后)

2.6 耐久: 10000次

2.7 耐高温: SMT回流焊 (峰值260° ±5°), 塑胶不能有起泡, 融胶等不良, 变色, 翘曲变形在公差范围以内。

2.8 产品须做焊锡测试, 粘锡面积达到95%以上:

2.9 盐雾测试: 24H MIN

3.0 工作温度: -25℃~+80℃

USB TYPE-C PIN ASSIGNMENTS

PIN NUMBER	SIGNAL NAME	PIN NUMBER	SIGNAL NAME
A1	GND	B12	GND
A4	VBUS	B9	VBUS
A5	CC1	B8	SBU2
A6	Dp1	B7	Dn2
A7	Dn1	B6	Dp2
A8	SBU1	B5	CC2
A9	VBUS	B4	VBUS
A12	GND	B1	GND

QUADRANT POINT TANGENCY POINT INTERSECTION POINT UNLESS OTHERWISE SPECIFIED, TOLERANCE: X. ±0.25 X.x ±0.20 X.xx ±0.15 ANGULAR ±3°	QP	 联晟欣连接器 (深圳) 有限公司 Lianshengxin Connector (Shenzhen) Co., Ltd			
	TP				
	IP	DESIGN	Andy	DATE	2014.12.24
		CHECKED		DATE	
		APPROVED		DATE	
		PART NO:	LCK-TCF829-L131YL-G1	REV:	04
		DRAWING NO:		SCALE:	1:1
				SHEET:	1/1
				UNIT:	mm

RoHS Compliant

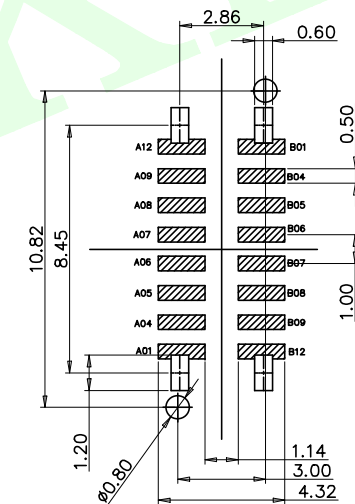
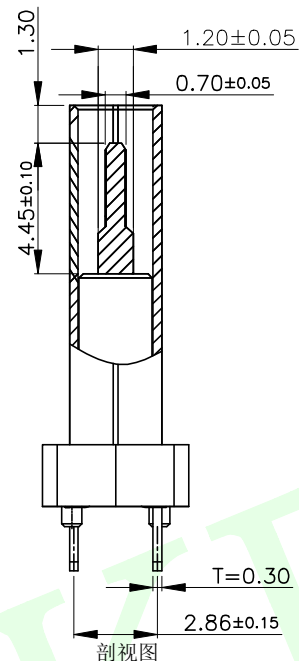
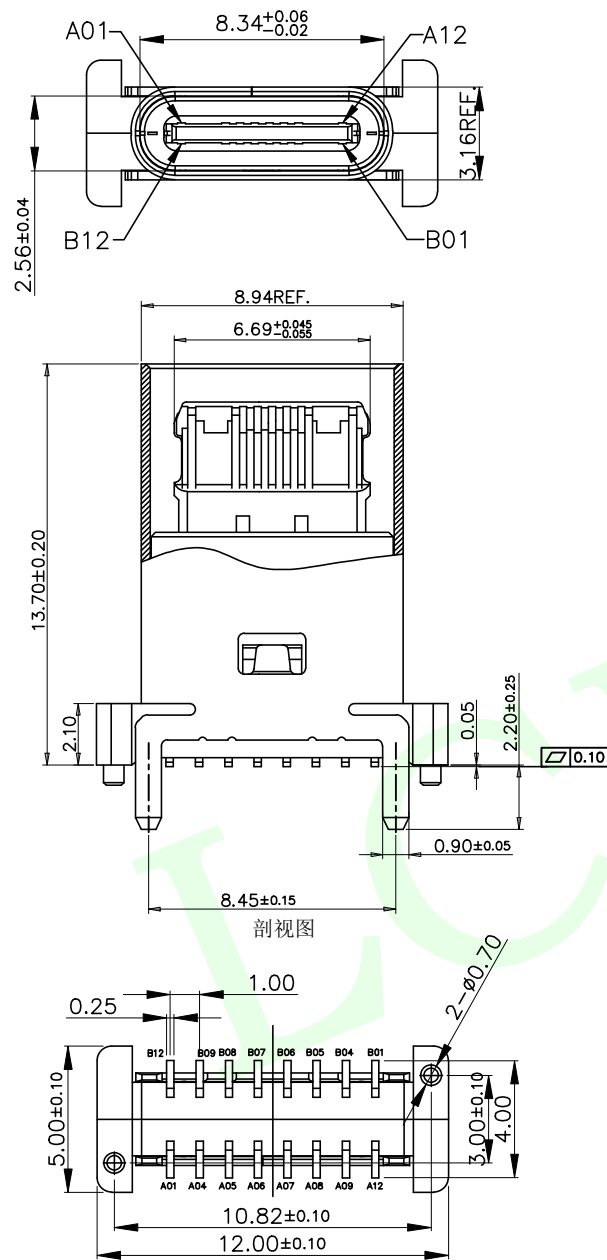

RECOMMENDED P.C.B. LAYOUT (俯视)
TOLERANCE UNSPECIFIED $\pm 0.05 \text{ mm}$

备注:

1. 材质:

1.1 胶芯: LCP+30%G.F UL94V-0

1.2 端子: C7025 : 镍底50U" MIN

接触区域镀金 (AU 1u") 焊接区域镀金G/F

1.3 外壳: SUS304, T=0.30mm: 表面镀镍30U" MIN

1.4 中夹片: SUS301:

2. 主要特性:

2.1 额定电流: 5A

2.2 接触阻抗: $40 \text{ m}\Omega$ MAX (初始值)

$50 \text{ m}\Omega$ MAX (测试后)

2.3 绝缘阻抗: $100 \text{ M}\Omega$ MIN

2.4 耐压测试: 100V AC R M S

2.5 整体插入力: 5-20N 整体插入力: 5-20N (耐久后)

整体拔出: 8-20N 整体拔出: 6-20N (耐久后)

2.6 耐久: 10000次

2.7 耐高温: SMT回流焊 (峰值 $260^\circ \pm 5^\circ$), 塑胶不能有起泡, 融胶等不良, 变色, 翘曲变形在公差范围以内。

2.8 产品须做焊锡测试, 粘锡面积达到95%以上:

2.9 盐雾测试: 24H MIN

3.0 工作温度: $-25^\circ \text{C} \sim +80^\circ \text{C}$

USB TYPE-C PIN ASSIGNMENTS

PIN NUMBER	SIGNAL NAME	PIN NUMBER	SIGNAL NAME
A1	GND	B12	GND
A4	VBUS	B9	VBUS
A5	CC1	B8	SBU2
A6	Dp1	B7	Dn2
A7	Dn1	B6	Dp2
A8	SBU1	B5	CC2
A9	VBUS	B4	VBUS
A12	GND	B1	GND

QUADRANT POINT	ⓀⓅ	 联晟欣连接器（深圳）有限公司 Lianshengxin Connector (Shenzhen) Co., Ltd						
TANGENCY POINT	ⓀⓅ							
INTERSECTION POINT	ⓀⓅ							
UNLESS OTHERWISE SPECIFIED, TOLERANCE:								
X.	±0.25	DESIGN	Andy	DATE	2014.12.24	TITLE:		
X.x	±0.20	CHECKED		DATE		TYPE C 16PIN 母座立贴13.7mm		
X.xx	±0.15	APPROVED		DATE				
ANGULAR	±3°	PART NO: LCK-TCF829-L137YL-G1				REV: 04	SCALE: 1:1	UNIT: mm
		DRAWING NO:				SIZE: A4	SHEET: 1/1	

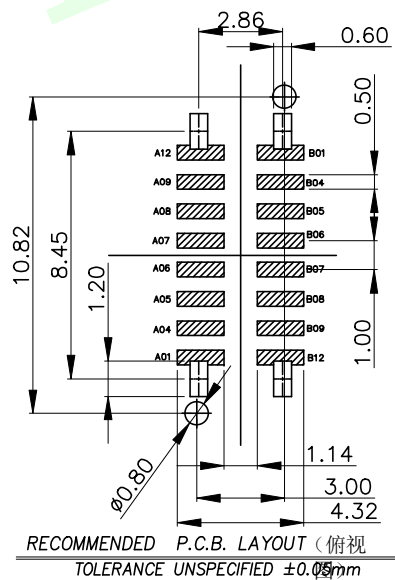
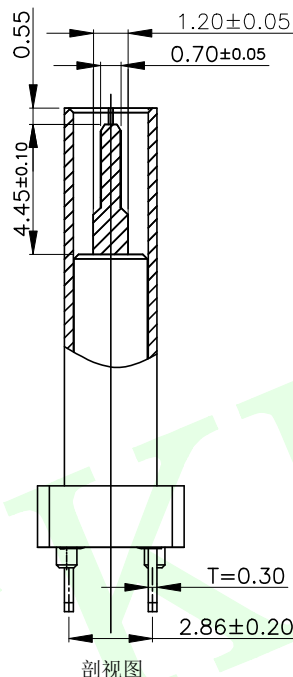
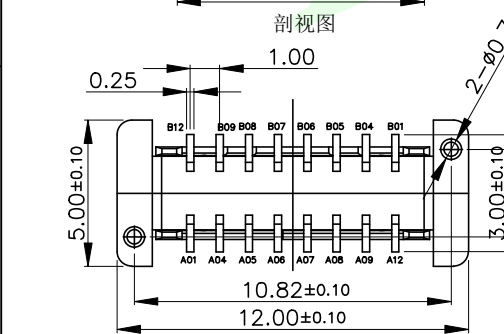
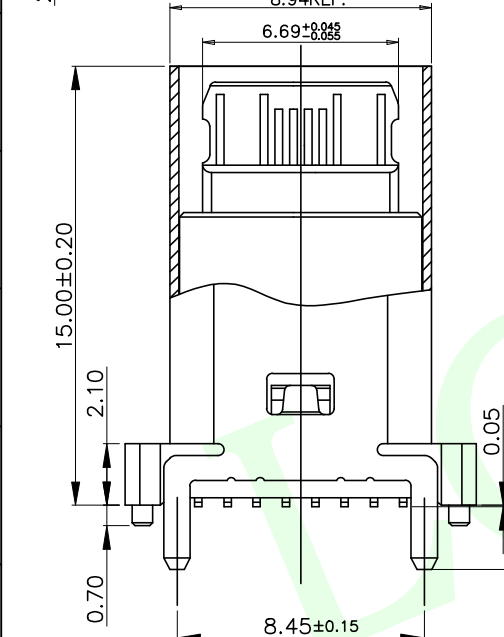

备注:

1. 材质:
 - 1.1胶芯: LCP+30%G. F UL94V-0
 - 1.2端子: C7025 : 镍底50U” MIN
接触区域镀金 (AU 1u”) 焊接区域镀金G/F
 - 1.3外壳: SUS304, T=0.30mm: 表面镀镍30U” MIN
 - 1.4中夹片: SUS301:
2. 主要特性:
 - 2.1额定电流: 5A
 - 2.2接触阻抗: 40mΩ MAX (初始值)
50mΩ MAX (测试后)
 - 2.3绝缘阻抗: 100MΩ MIN
 - 2.4耐压测试: 100V AC R M S
 - 2.5整体插入力: 5-20N 整体插入力: 5-20N (耐久后)
整体拔出力: 8-20N 整体拔出力: 6-20N (耐久后)
 - 2.6耐久: 10000次
 - 2.7耐高温: SMT回流焊 (峰值260° ±5°), 塑胶不能有起泡, 融胶等不良, 变色, 翘曲变形在公差范围以内。
 - 2.8产品须做焊锡测试, 粘锡面积达到95%以上:
 - 2.9盐雾测试: 24H MIN
 - 3.0工作温度: -25℃~+80℃

USB TYPE-C PIN ASSIGNMENTS

PIN NUMBER	SIGNAL NAME	PIN NUMBER	SIGNAL NAME
A1	GND	B12	GND
A4	VBUS	B9	VBUS
A5	CC1	B8	SBU2
A6	Dp1	B7	Dn2
A7	Dn1	B6	Dp2
A8	SBU1	B5	CC2
A9	VBUS	B4	VBUS
A12	GND	B1	GND

QUADRANT POINT (QP)		 联晟欣连接器（深圳）有限公司					
TANGENCY POINT (TP)		Lianshengxin Connector (Shenzhen) Co., Ltd					
INTERSECTION POINT (IP)							
UNLESS OTHERWISE SPECIFIED, TOLERANCE: X. ±0.25 X.x ±0.20 X.xx ±0.15 ANGULAR ±3°		DESIGN	Andy	DATE	2014.12.24	TITLE:	
		CHECKED		DATE		TYPE C 16PIN 每座立贴15.0mm	
		APPROVED		DATE			
		PART NO: LCK-TCF829-L150YL-G1				REV: 04	SCALE: 1:1
DRAWING NO:				SIZE: A4	SHEET: 1/1		

RoHS Compliant

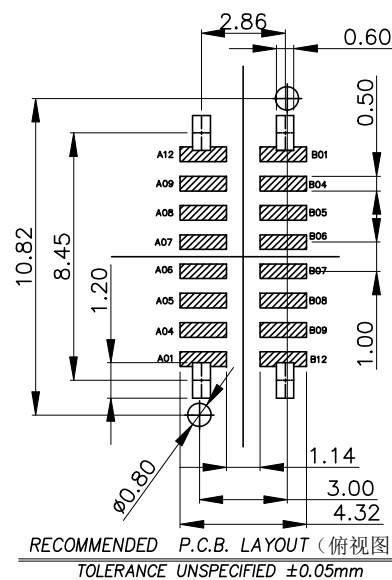
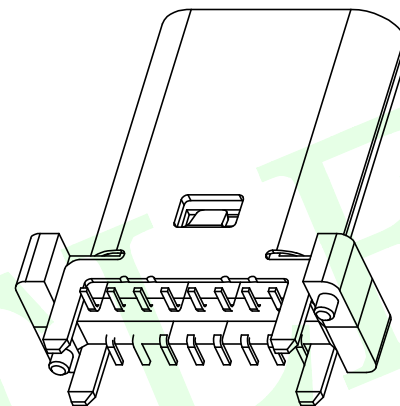
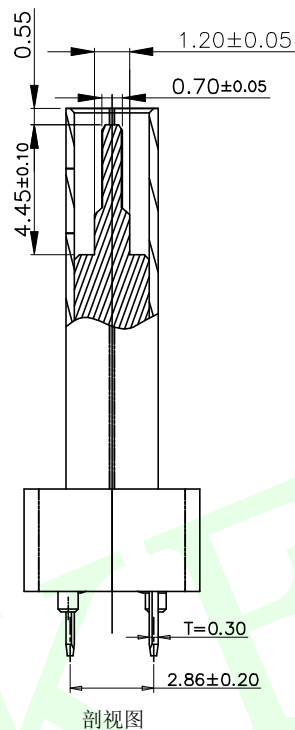
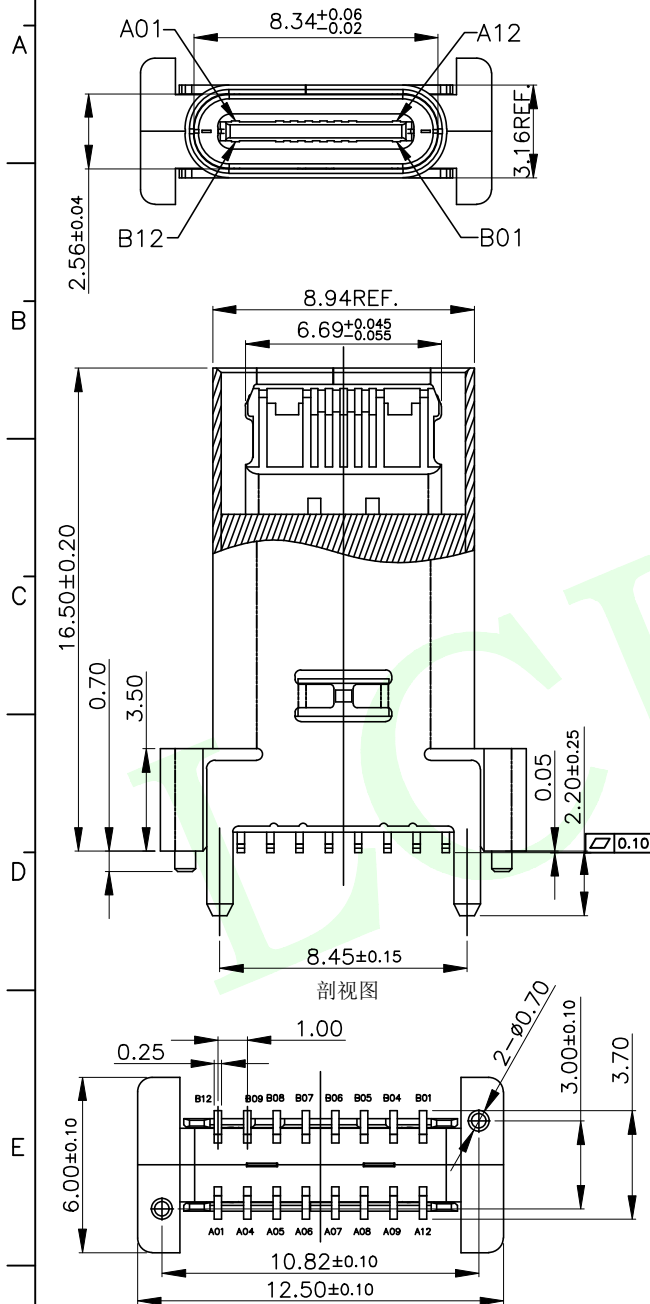

备注:

1. 材质:

1.1胶芯: LCP+30%G. F UL94V-0

1.2端子: C7025 : 镍底50U" MIN

接触区域镀金 (AU 1u") 焊接区域镀金G/F

1.3外壳: SUS304, T=0.30mm: 表面镀镍30U” MIN

1.4中夹片: SUS301:

2. 主要特性:

2.1 额定电流: 5A

2.2接触阻抗: 40mΩ MAX (初始值)

50m Ω MAX (测试后)

2.3绝缘阻抗: 100MΩ MIN

2.4耐压测试: 100V AC R M S

2.5整体插入力:5-20N 整体插入力: 5-20N (耐久后)

整体拔出力: 8-20N 整体拔出力: 6-20N (耐久后)

2.6耐久：10000次

2.7耐高温：SMT回流焊（峰值 $260^{\circ} \pm 5^{\circ}$ ），塑胶不能有起泡，融胶等不良，变色，翘曲变形在公差范围以内。

2.8产品须做焊锡测试，粘锡面积达到95%以上:

2.9盐雾测试: 24H MIN

3.0工作温度: $-25^{\circ}\text{C} \sim +80^{\circ}\text{C}$

USB TYPE-C PIN ASSIGNMENTS

PIN NUMBER	SIGNAL NAME	PIN NUMBER	SIGNAL NAME
A1	GND	B12	GND
A4	VBUS	B9	VBUS
A5	CC1	B8	SBU2
A6	Dp1	B7	Dn2
A7	Dn1	B6	Dp2
A8	SBU1	B5	CC2
A9	VBUS	B4	VBUS
A12	GND	B1	GND

QUADRANT POINT	<input type="checkbox"/> QP
TANGENCY POINT	<input type="checkbox"/> TP
INTERSECTION POINT	<input type="checkbox"/> IP

UNLESS OTHERWISE
SPECIFIED, TOLERANCE:

X.	± 0.25
----	------------

X,x	±0.20
Y,yy	±0.15

ANGULAR



联晟欣连接器（深圳）有限公司

Lianshengxin Connector (Shenzhen) Co., Ltd

DESIGN	Andy	DATE	2014.12.24	TITLE: TYPE C 16PIN 母座立貼16.5mm		
CHECKED		DATE				
APPROVED		DATE				
PART NO: LCK-TCF829-L165YL-G1				REV: 04	SCALE: 1:1	UNIT: mm
DRAWING NO:				SIZE: A4	SHEET: 1/1	

RoHS Compliant

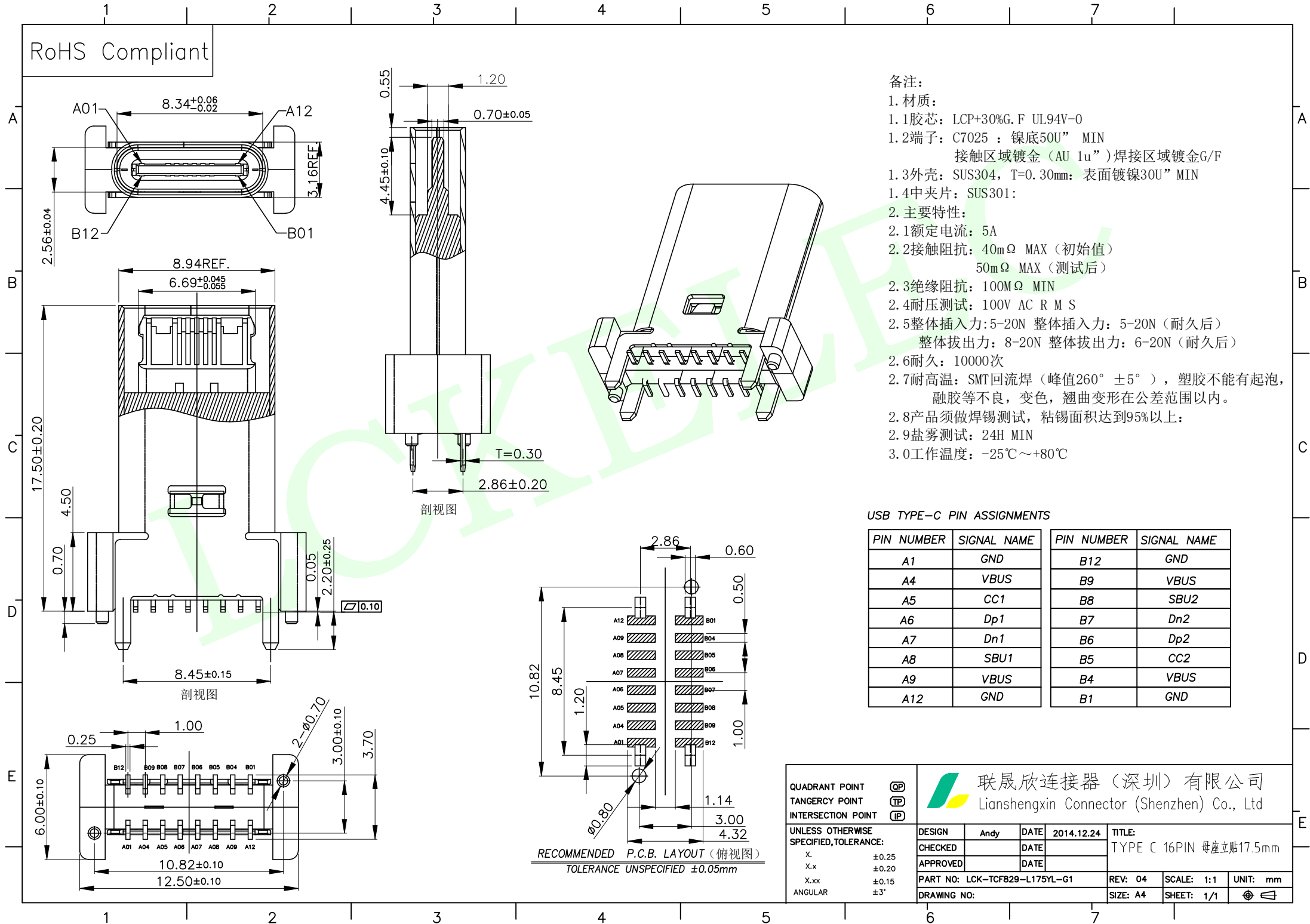

USB TYPE-C PIN ASSIGNMENTS

PIN NUMBER	SIGNAL NAME	PIN NUMBER	SIGNAL NAME
A1	GND	B12	GND
A4	VBUS	B9	VBUS
A5	CC1	B8	SBU2
A6	Dp1	B7	Dn2
A7	Dn1	B6	Dp2
A8	SBU1	B5	CC2
A9	VBUS	B4	VBUS
A12	GND	B1	GND

QUADRANT POINT (QP)		TANGENCY POINT (TP)		INTERSECTION POINT (IP)		UNLESS OTHERWISE SPECIFIED, TOLERANCE:		X. ±0.25		X.x ±0.20		X.xx ±0.15		ANGULAR ±3°	
DESIGN		Andy		DATE		2014.12.24		TITLE:		TYPE C 16PIN 母座立贴17.5mm		REV: 04		SCALE: 1:1	
CHECKED		DATE		DATE		DATE		PART NO: LCK-TCF829-L175YL-G1		REV: 04		SCALE: 1:1		UNIT: mm	
APPROVED		DATE		DATE		DATE		DRAWING NO:		SIZE: A4		SHEET: 1/1			

RoHS Compliant

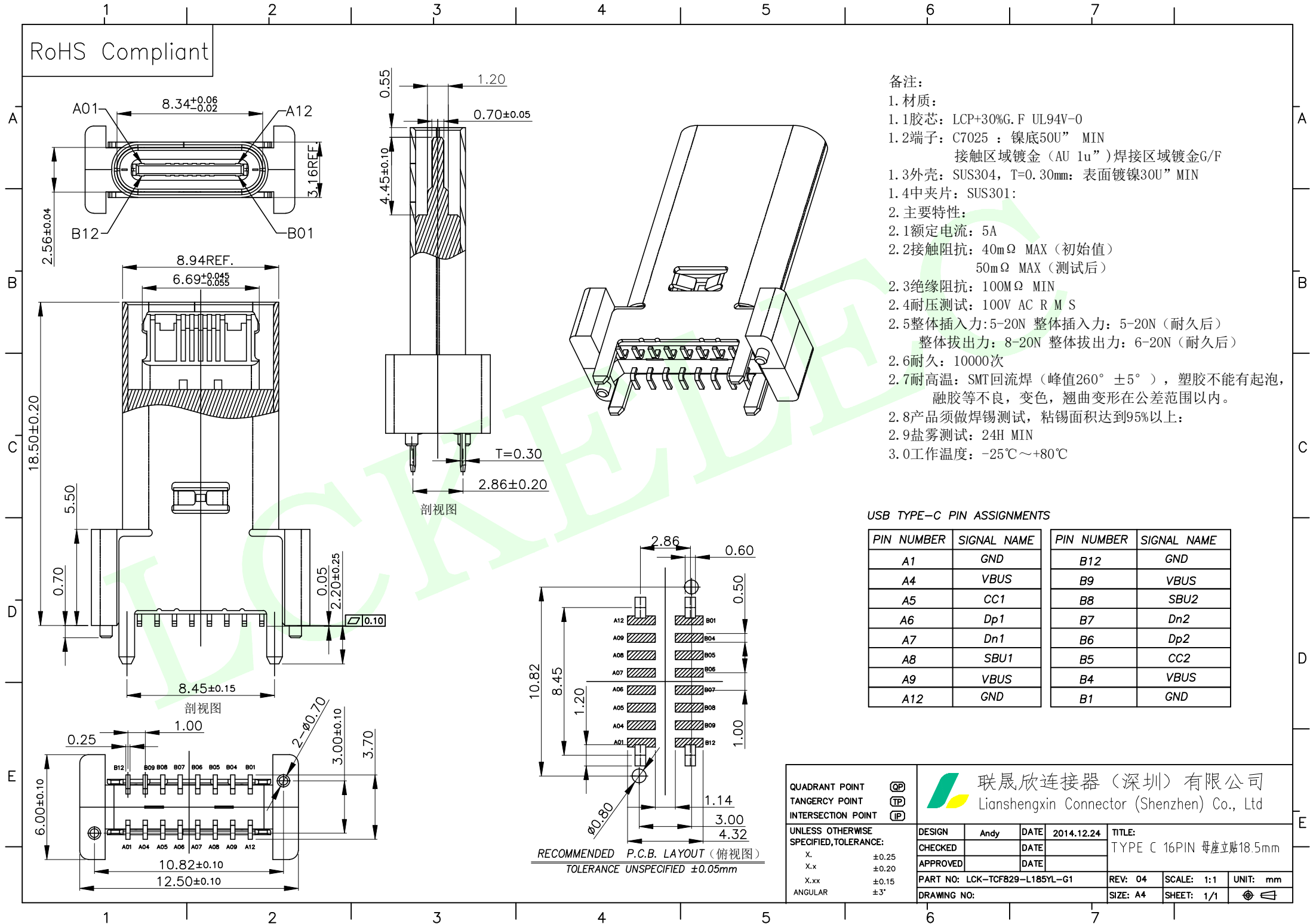

备注:

1. 材质:

1.1 胶芯: LCP+30%G.F UL94V-0

1.2 端子: C7025 : 镍底50U" MIN

接触区域镀金 (AU 1u") 焊接区域镀金G/F

1.3 外壳: SUS304, T=0.30mm: 表面镀镍30U" MIN

1.4 中夹片: SUS301:

2. 主要特性:

2.1 额定电流: 5A

2.2 接触阻抗: 40m Ω MAX (初始值)

50m Ω MAX (测试后)

2.3 绝缘阻抗: 100M Ω MIN

2.4 耐压测试: 100V AC R M S

2.5 整体插入力: 5-20N 整体插入力: 5-20N (耐久后)

整体拔出: 8-20N 整体拔出: 6-20N (耐久后)

2.6 耐久: 10000次

2.7 耐高温: SMT回流焊 (峰值260 $^{\circ}$ \pm 5 $^{\circ}$), 塑胶不能有起泡, 融胶等不良, 变色, 翘曲变形在公差范围以内。

2.8 产品须做焊锡测试, 粘锡面积达到95%以上:

2.9 盐雾测试: 24H MIN

3.0 工作温度: -25 $^{\circ}$ C ~ +80 $^{\circ}$ C

USB TYPE-C PIN ASSIGNMENTS

PIN NUMBER	SIGNAL NAME	PIN NUMBER	SIGNAL NAME
A1	GND	B12	GND
A4	VBUS	B9	VBUS
A5	CC1	B8	SBU2
A6	Dp1	B7	Dn2
A7	Dn1	B6	Dp2
A8	SBU1	B5	CC2
A9	VBUS	B4	VBUS
A12	GND	B1	GND

QUADRANT POINT \square
TANGENCY POINT \circ
INTERSECTION POINT \times

UNLESS OTHERWISE
SPECIFIED, TOLERANCE:

X. \pm 0.25
X.x \pm 0.20
X.xx \pm 0.15
ANGULAR \pm 3 $^{\circ}$



联晟欣连接器 (深圳) 有限公司
Lianshengxin Connector (Shenzhen) Co., Ltd

DESIGN	Andy	DATE	2014.12.24	TITLE:
CHECKED		DATE		TYPE C 16PIN 母座立贴18.5mm
APPROVED		DATE		
PART NO:	LCK-TCF829-L185YL-G1	REV:	04	SCALE: 1:1
DRAWING NO:		SIZE:	A4	UNIT: mm
		SHEET:	1/1	

RoHS Compliant

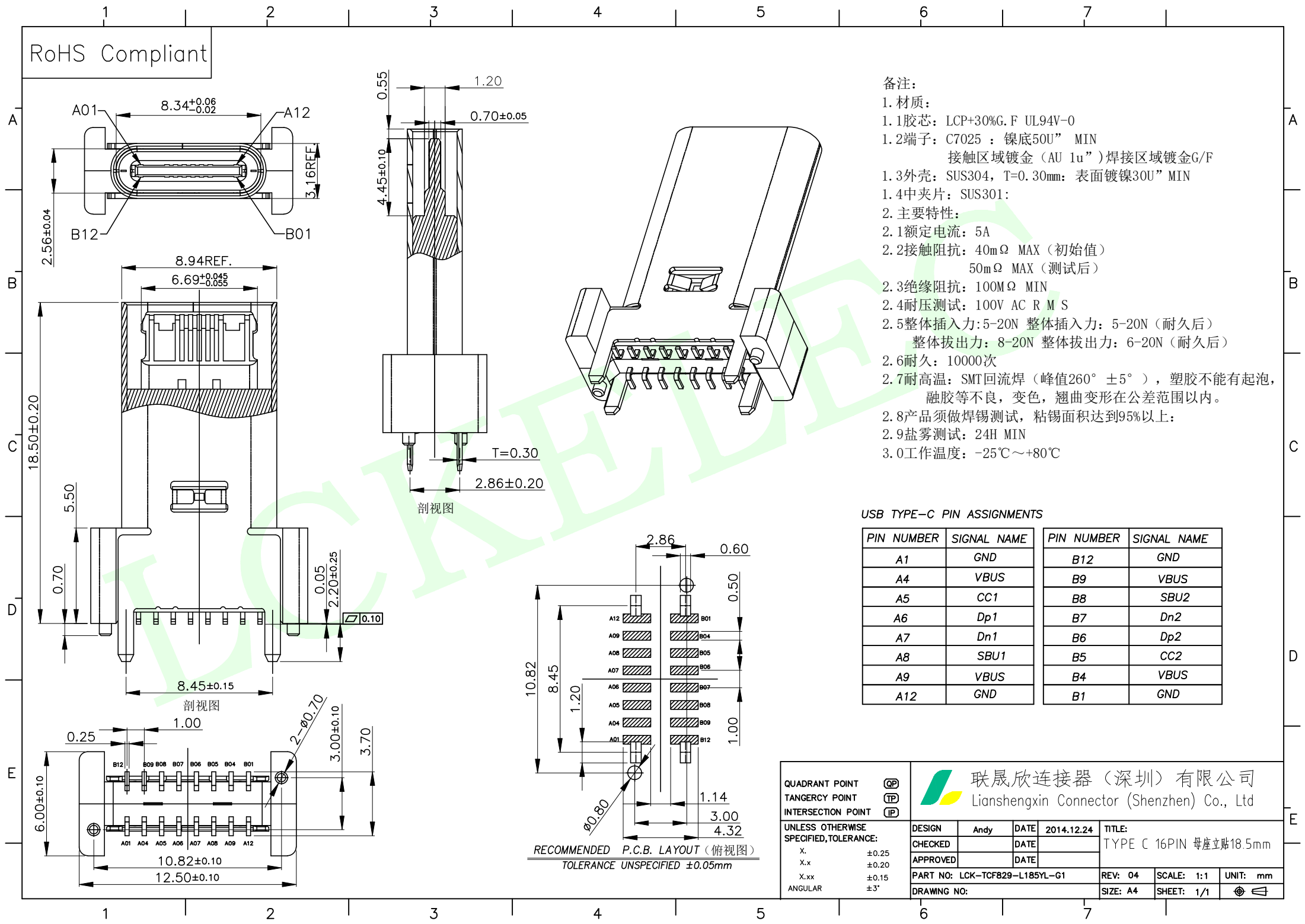

备注:

1. 材质:

1.1 胶芯: LCP+30%G.F UL94V-0

1.2 端子: C7025 : 镍底50U" MIN

接触区域镀金 (AU 1u") 焊接区域镀金G/F

1.3 外壳: SUS304, T=0.30mm: 表面镀镍30U" MIN

1.4 中夹片: SUS301:

2. 主要特性:

2.1 额定电流: 5A

2.2 接触阻抗: $40\text{m}\Omega$ MAX (初始值)

$50\text{m}\Omega$ MAX (测试后)

2.3 绝缘阻抗: $100\text{M}\Omega$ MIN

2.4 耐压测试: 100V AC R M S

2.5 整体插入力: 5-20N 整体插入力: 5-20N (耐久后)

整体拔出: 8-20N 整体拔出: 6-20N (耐久后)

2.6 耐久: 10000次

2.7 耐高温: SMT回流焊 (峰值 $260^\circ \pm 5^\circ$), 塑胶不能有起泡, 融胶等不良, 变色, 翘曲变形在公差范围以内。

2.8 产品须做焊锡测试, 粘锡面积达到95%以上:

2.9 盐雾测试: 24H MIN

3.0 工作温度: $-25^\circ\text{C} \sim +80^\circ\text{C}$

USB TYPE-C PIN ASSIGNMENTS

PIN NUMBER	SIGNAL NAME	PIN NUMBER	SIGNAL NAME
A1	GND	B12	GND
A4	VBUS	B9	VBUS
A5	CC1	B8	SBU2
A6	Dp1	B7	Dn2
A7	Dn1	B6	Dp2
A8	SBU1	B5	CC2
A9	VBUS	B4	VBUS
A12	GND	B1	GND

QUADRANT POINT 		 联晟欣连接器（深圳）有限公司 Lianshengxin Connector (Shenzhen) Co., Ltd						
TANGENCY POINT 								
INTERSECTION POINT 								
UNLESS OTHERWISE SPECIFIED, TOLERANCE:		DESIGN	Andy	DATE	2014.12.24	TITLE:		
X.	±0.25	CHECKED		DATE		TYPE C 16PIN 母座立贴18.5mm		
X.x	±0.20	APPROVED		DATE				
X.xx	±0.15	PART NO: LCK-TCF829-L185YL-G1				REV: 04	SCALE: 1:1	UNIT: mm
ANGULAR	±3°	DRAWING NO:				SIZE: A4	SHEET: 1/1	

RECOMMENDED P.C.B. LAYOUT (俯视图)
TOLERANCE UNSPECIFIED $\pm 0.05\text{mm}$