

RoHS Compliant

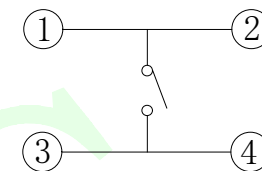

电路图

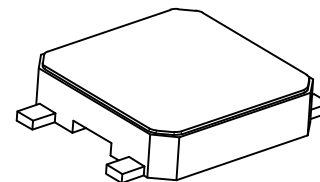
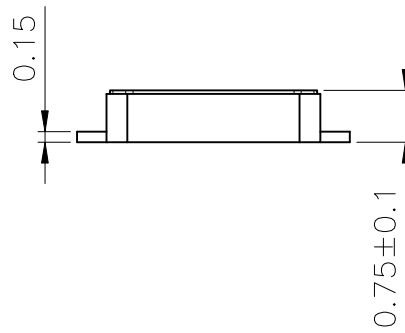
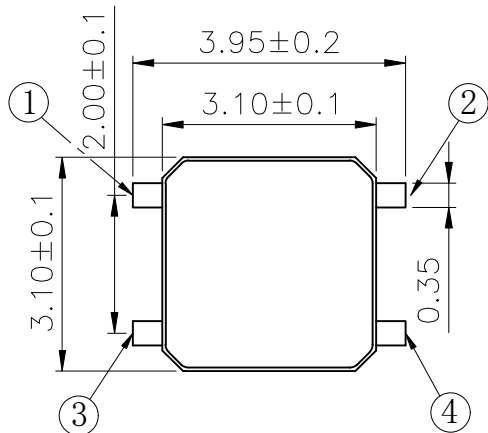
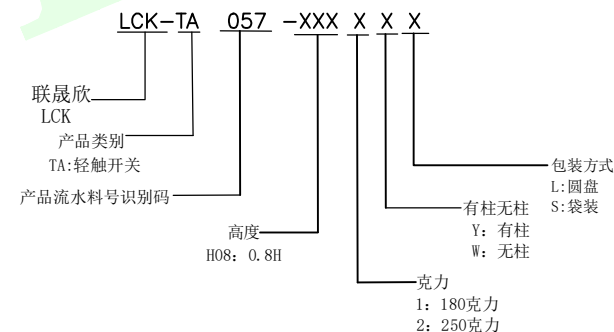
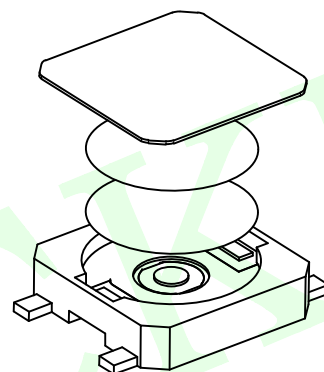

### 主要技术参数、性能 The Main Thchnology Performance

额定电流、电压 Rate voltage,current	50mA DC12V
接触电阻 Contact resistance	≤100mΩ
按力 Operating force	260±50gf
行程 travel	0.25±0.1mm
绝缘电阻 Insulated resistance	≥100MΩ
介电强度 Dielectric strength	≥250VAC/1min
寿命 Endurance	≥100000 次

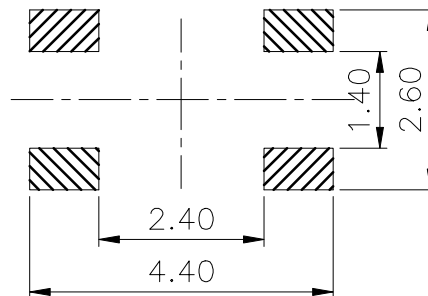

PCB. 焊接图

E	按钮	PPA	1	耐温260℃ (黑色)
D	盖板	铜	1	镀锡
C	弹片	不锈钢	1	镀银
B	基座	PPA	1	耐温260℃ (黑色)
A	卡件	铜	1	镀银
项目 ITEM	名称 DESCRIPTION	材质 MATERIAL	数量 QTY	表面处理/颜色 FINISH/COLOR

QUADRANT POINT  
TANGENCY POINT  
INTERSECTION POINT



联晟欣连接器 (深圳) 有限公司  
Lianshengxin Connector (Shenzhen) Co., Ltd

UNLESS OTHERWISE  
SPECIFIED, TOLERANCE:  
X. ±0.25  
X.x ±0.20  
X.xx ±0.15  
ANGULAR ±3°

DESIGN	Andy	DATE	2014.12.24	TITLE:	TACRILE SWITCH
CHECKED		DATE			
APPROVED		DATE			
PART NO:	LCK-TA057HXXX-XXXX	REV:	04	SCALE:	1:1
DRAWING NO:		SIZE:	A4	SHEET:	1/1