

| Description of Revision | Date | Name | Approved | ECN No. |
|-------------------------|------|------|----------|---------|
| | | | | |

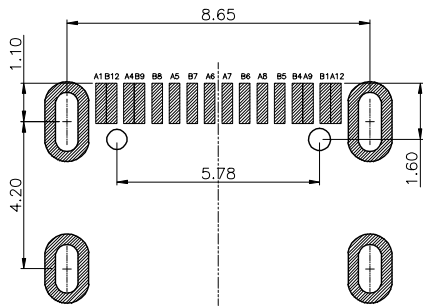
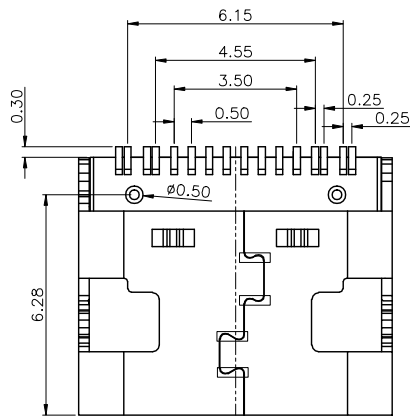
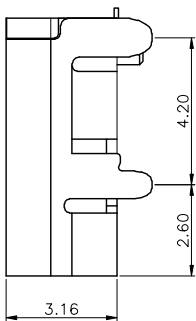
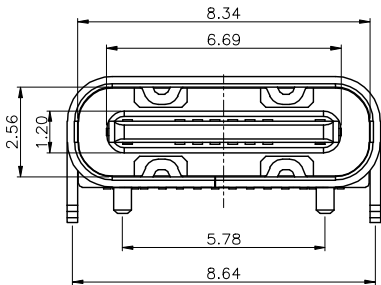
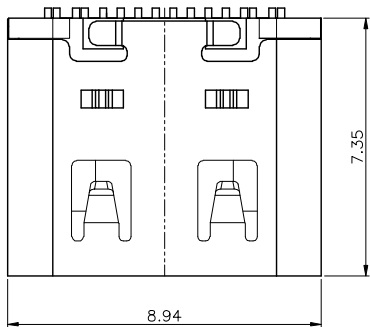
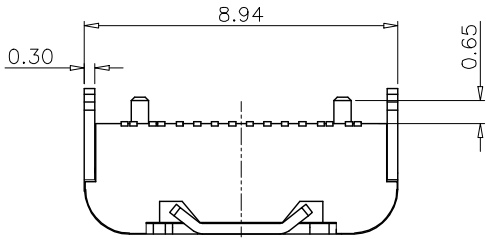

PCB LAYOUT(Recommend)
(General Tolerance:±0.05)

PIN ASSIGNMENTS

| | | | |
|-----|-------------|-----|-------------|
| A5 | CC1 | B12 | GND |
| A9 | VBUS | B9 | VBUS |
| A12 | GND | B5 | CC2 |
| PIN | SIGNAL NAME | PIN | SIGNAL NAME |

NOTE:

- MATERIAL SPECIFICATION:
 - HOUSING:HIGH TEMPERATURE RESISTANT PLASTIC,UL94 V-0.
 - CONTACTS:COPPER ALLOY
 - MID PLATE: STAINLESS STEEL
 - FRONT SHELL: STAINLESS STEEL
- PLATING SPECIFICATION:
 - CONTACTS:
Ni 50u" MIN. UNDER PLATED OVER ALL.
Au PLATED ON THE FUNCTIONAL AREA OF CONTACT.
(GOLD PLATING THICKNESS FOLLOW THE P/N)
PLATING SPECIFICATIONS OF THE SOLDER AREA FOLLOW THE P/N
 - FRONT SHELL:
SEE TABLE1.
 - SHIELD PLATE&EMI PLATE:
CLEAR ONLY
- MECHANICAL PERFORMANCE,
 - INSERTION FORCE: 0.5~2.0kgf.
 - REMOVAL FORCE: 0.8kgf~2.0kgf.
 - DURABILITY: 10000 CYCLES.
- ELECTRICAL PERFORMANCE,
 - CURRENT RATING:3.0A
VOLTAGE RATING:5.0V
 - LLCR:
VBUS & GND PINS AND OTHER PINS: 40mΩ/PIN MAX.
SHIELD: 50mΩ/MAX.
LLCR MAX. CHANGE OF ALL PINS: 10mΩ.
 - INSULATION RESISTANCE: 100MΩ MIN
 - DIELECTRIC WITHSTAND VOLTAGE,AC 100V FOR 1 MINUTE.
- ENVIRONMENTAL PERFORMANCE:
OPERATING TEMPERATURE: -25°C~+85°C.
- IR REFLOW:
THE PEAK TEMPERATURE ON THE BOARD SHALL
BE MAINTAINED FOR 10 SECONDS AT 260°C.

| | | | | | |
|---------------------------------------|-------------|-------------------------------------|------------|---------------|--------|
| UNLESS OTHERWISE SPECIFIED TOLERANCES | | 浙江创都电子科技有限公司 | | | |
| DECIMALS: | ANGLES | TITL- TYPE-C-16P-BS-T-7.35-3MD-Z | | | |
| X. ±0.20 | X'. ±2° | Drwn. JACK.LI | PART NO. | | |
| X.X ±0.15 | X.X' ±1° | Checked. PETER.LIU | SCALE. 1:8 | UNIT. mm | PROJ. |
| X.XX ±0.10 | X.XX' ±0.5° | Approved. JACK.D | SIZE. A4 | SHEET. 1 OF 1 | REV. A |
| Y.XXX ±0.05 | | CUSTOMER COPY | | | |