

## Features

- Low forward voltage drop

1 Cathode  
2 Anode

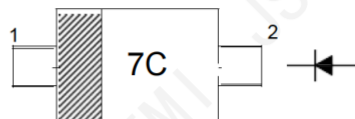

Marking Code: "7C"  
Simplified outline SOD-523 and symbol

## Maximum Ratings and Electrical Characteristics, Single Diode @T<sub>A</sub>=25°C

Parameter	Symbol	Value	Unit
Repetitive Peak Reverse Voltage	V <sub>RRM</sub>	70	V
Continuous Forward Current	I <sub>F</sub>	70	mA
Surge Non-Repetitive Forward Current (tp = 10 ms)	I <sub>FSM</sub>	1	A
Total Power Dissipation	P <sub>tot</sub>	230	mW
Thermal Resistance Junction to Ambient <sup>1)</sup>	R <sub>thJA</sub>	550	°C/W
Junction Temperature	T <sub>J</sub>	150	°C
Storage Temperature Range	T <sub>stg</sub>	- 65 to + 150	°C

<sup>1)</sup> Mounted on epoxy board, with recommended pad layout.

## Electrical Ratings @T<sub>A</sub>=25°C

Parameter	Symbol	Min.	Max.	Unit
Reverse Breakdown Voltage at I <sub>R</sub> = 10 μA	V <sub>BR</sub>	70	-	V
Forward Voltage at I <sub>F</sub> = 1 mA	V <sub>F</sub>	-	410	mV
Reverse Current at V <sub>R</sub> = 50 V	I <sub>R</sub>	-	100	nA
Diode Capacitance at V <sub>R</sub> = 0 V, f = 1 MHz	C <sub>tot</sub>	-	2	pF

## Electrical Characteristics Curves

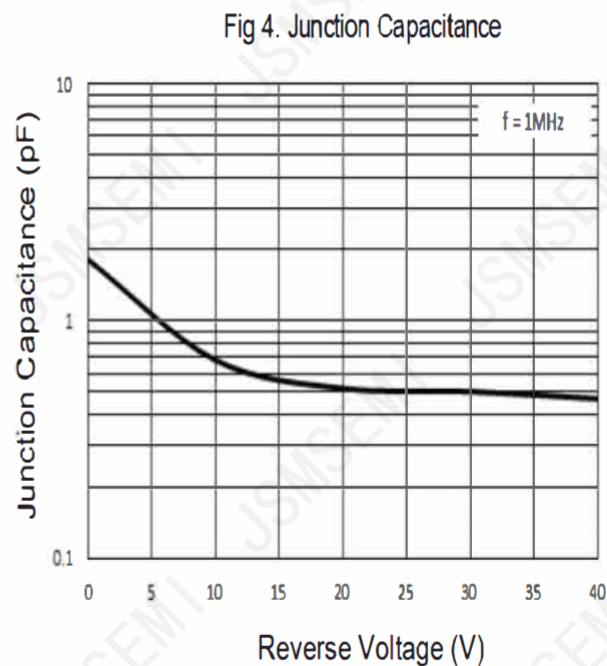
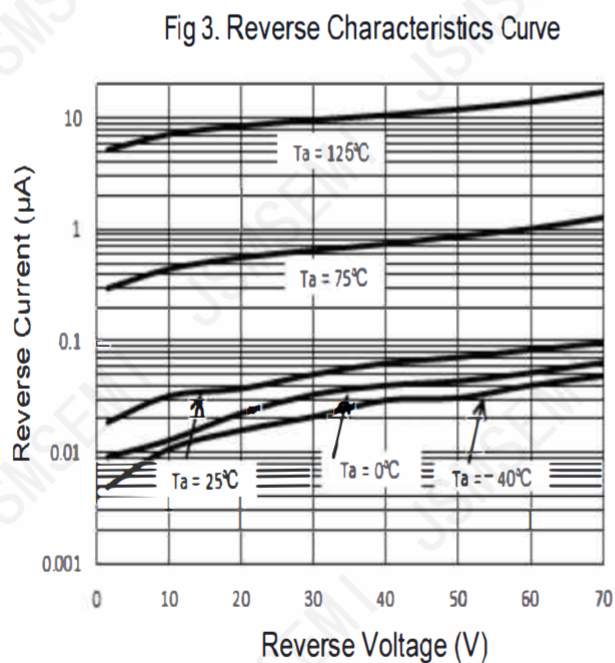
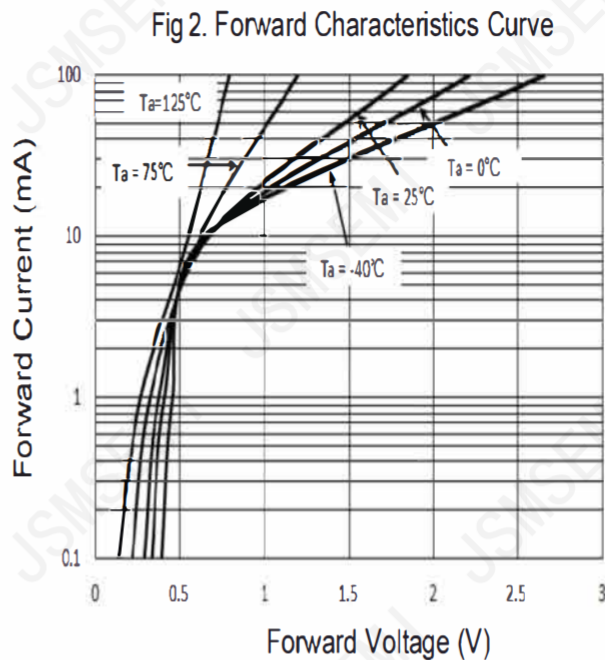
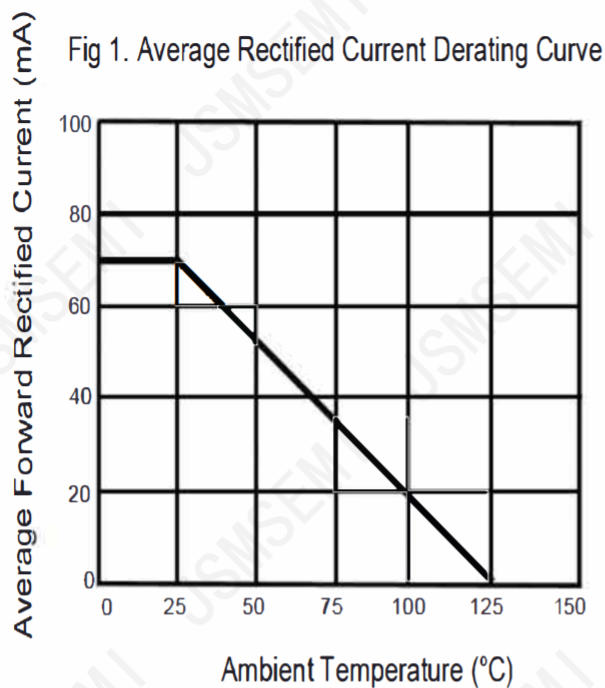

## PACKAGE OUTLINE

Plastic surface mounted package; 2 leads

### SOD-523

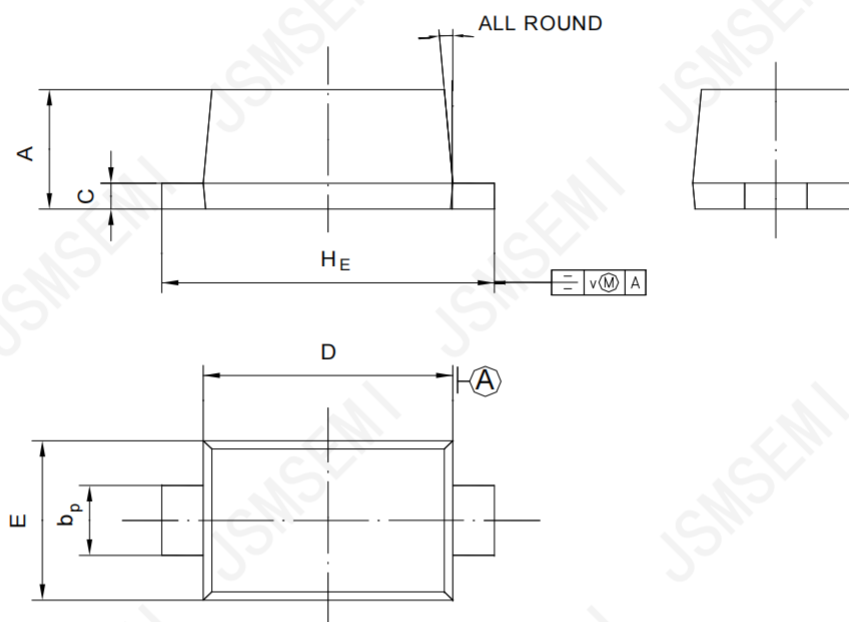

UNIT	A	b <sub>p</sub>	C	D	E	H <sub>E</sub>	V	∠
mm	0.68 0.58	0.4 0.3	0.135 0.100	1.25 1.15	0.85 0.75	1.7 1.5	0.1	5°

## Revision History

Rev.	Change	Date
V1.0	Initial version	2/23/2024

## Important Notice

JSMSEMI Semiconductor (JSMSEMI) PRODUCTS ARE NEITHER DESIGNED NOR INTENDED FOR USE IN MILITARY AND/OR AEROSPACE, AUTOMOTIVE OR MEDICAL DEVICES OR SYSTEMS UNLESS THE SPECIFIC JSMSEMI PRODUCTS ARE SPECIFICALLY DESIGNATED BY JSMSEMI FOR SUCH USE. BUYERS ACKNOWLEDGE AND AGREE THAT ANY SUCH USE OF JSMSEMI PRODUCTS WHICH JSMSEMI HAS NOT DESIGNATED FOR USE IN MILITARY AND/OR AEROSPACE, AUTOMOTIVE OR MEDICAL DEVICES OR SYSTEMS IS SOLELY AT THE BUYER' S RISK.

JSMSEMI assumes no liability for application assistance or customer product design. Customers are responsible for their products and applications using JSMSEMI products.

Resale of JSMSEMI products or services with statements diferent from or beyond the parameters stated by JSMSEMI for that product or service voids all express and any implied warranties for the associated JSMSEMI product or s ervice. JSMSEMI is not responsible or liable for any such statements.

JSMSEMI All Rights Reserved. Information and data in this document are owned by JSMSEMI wholly and may not be edited, reproduced, or redistributed in any way without the express written consent from JSMSEMI.

Any and all information described or contained herein are subject to change without notice due to product/technology improvement, etc. When designing equipment, refer to the "Delivery Specification" for the JSMSEMI product that you intend to use.

For additional information please contact Kevin@jsemsemi.com or visit www.jsemsemi.com