

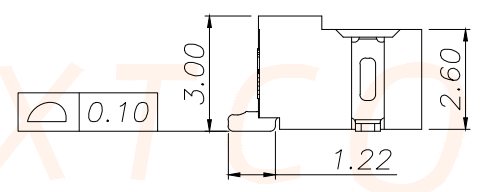

REV.	ECN NO.	DESCRIPTION	DATE	DESIGN

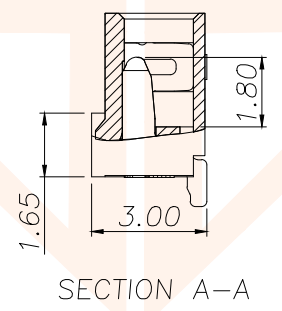

Part No	CKT	A	B	C	D
ANH1.0-2A-42	2	1.00	2.50	3.50	3.48
ANH1.0-3A-42	3	2.00	3.50	4.50	4.48
ANH1.0-4A-42	4	3.00	4.50	5.50	5.48
ANH1.0-5A-42	5	4.00	5.50	6.50	6.48
ANH1.0-6A-42	6	5.00	6.50	7.50	7.48
ANH1.0-7A-42	7	6.00	7.50	8.50	8.48
ANH1.0-8A-42	8	7.00	8.50	9.50	9.48
ANH1.0-9A-42	9	8.00	9.50	10.50	10.48
ANH1.0-10A-42	10	9.00	10.50	11.50	11.48
ANH1.0-11A-42	11	10.00	11.50	12.50	12.48
ANH1.0-12A-42	12	11.00	12.50	13.50	13.48
ANH1.0-13A-42	13	12.00	13.50	14.50	14.48
ANH1.0-14A-42	14	13.00	14.50	15.50	15.48
ANH1.0-15A-42	15	14.00	15.50	16.50	16.48
ANH1.0-16A-42	16	15.00	16.50	17.50	17.48
ANH1.0-17A-42	17	16.00	17.50	18.50	18.48
ANH1.0-18A-42	18	17.00	18.50	19.50	19.48
ANH1.0-19A-42	19	18.00	19.50	20.50	20.48
ANH1.0-20A-42	20	19.00	20.50	21.50	21.48

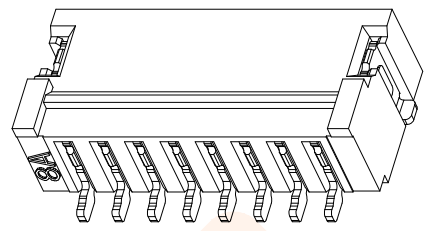
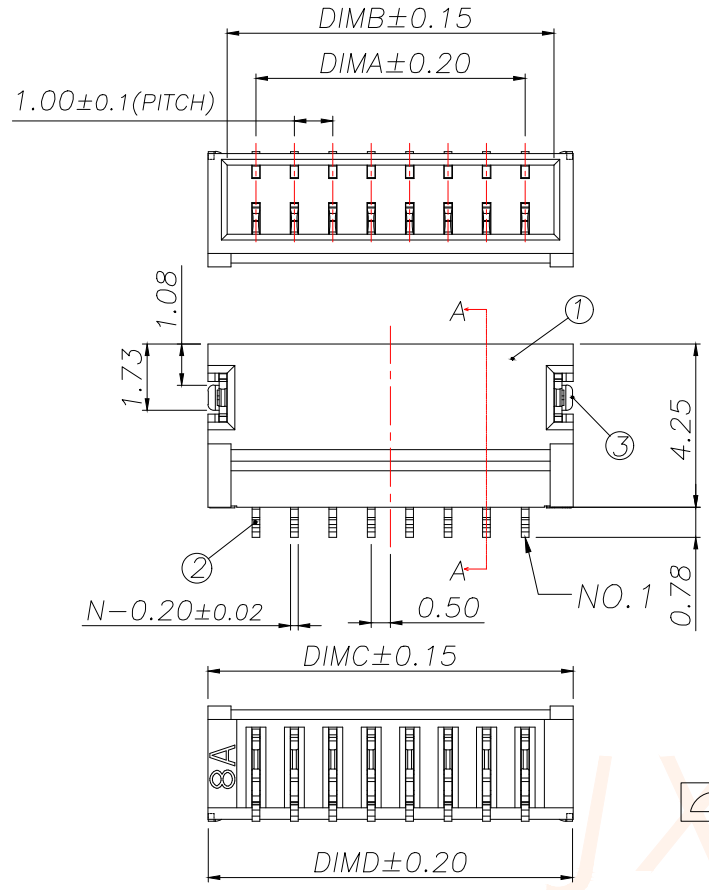
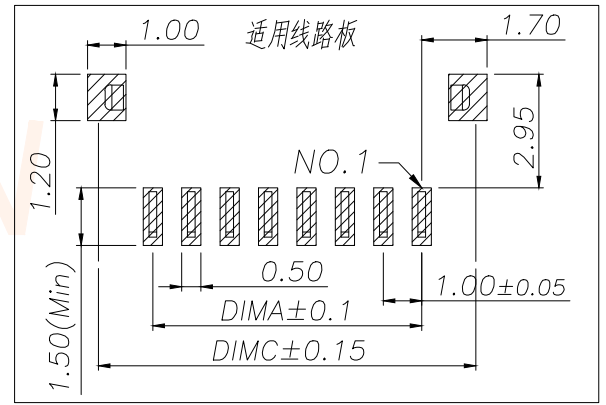

技术指标:

1. 塑件表面应光洁、无毛边、无明显收缩、缺陷、裂纹等现象。
2. 温度范围: -25°C~85°C.
3. 额定电压: 50V, AC, DC.
4. 接触电阻: ≤0.02Ω.
5. 绝缘电阻: ≥100MΩ
6. 额定电流: 1A, AC, DC.

序号	品名	材质	TOLERANCE		深圳聚兴泰电子科技有限公司 Shenzhen Juxingtai Electronic Technology Co., Ltd				
①	B型卧式WTB胶芯	PA6T UL94V-0米黄色	X.±0.50	±1°	PART NO.	TITLE:			
②	B型卧式WTB端子	铜合金/表面镀锡	X.X±0.20		ANH1.0-NA-42		1.0 Pitch B型卧式WTB		
③	B型卧式WTB焊片	铜合金/表面镀锡	X.XX±0.10		DESIGN:	Ethan	MANUFACTURE DWG		
			UNITS	mm	CHED:	Olvia	SCALE N:A	SHEET 1/1	
			MATERILA	---	APPD:	Ava			
			FINISH	---					