

規格承認書

PECIFICATION FOR APPROVAL

客 戶

CUSTOMER : _____

項 目

ITEM : 贴片塑壳内磁喇叭

型 號

TYPE : GSPK1504S-8R0.8W

描述

DESCRIPTION : 15*15*4.0mm 8ohm 0.8W S.P.L: 92dB+/- 3dB

客戶料號

CUSTOMER NO. : _____

規 格 書 號

SPECIFICATION NO.: _____

版 本

EDITION NO. : V1.0

日 期

DATE : 20

客戶承認

CUSTOMER CONFIRM AND SIGN

檢查 TESTED BY	審核 CHECKED BY	承認 APPROVED BY

東莞市贏海電子有限公司

DONGUAN INGHAI ELECTRONICS CO.,LTD

製作 ISSUED BY	審查 CHECKED BY	確認 APPROVED BY
周明	刘承成	

地址：廣東省東莞市虎門鎮懷德社區雅瑤工業區

電話 / TEL: 0769-83060958 傳真 / FAX: 0769-81608993

網址: [HTTP://WWW.INGHAI.COM](http://www.inghai.com)

Technical Terms:

Test Basic State: Temp($20\pm 2^{\circ}\text{C}$), Humidity(40~70%RH), Air pressure(860~1060hPa).

DIMENSIONS (UNIT: mm)

Tolerance: $\pm 0.5\text{mm}$ Except Specified

[illegible]

No.	Technical terms	Value
1	Rated Power	0.8W
2	Max Input Power	1.0W
3	Rated Impedance	8Ω±20%
4	Resonance Frequency	800 Hz±20%
5	Sound Output at 0.1m 0.8W	92±3dB at 1k,1.6k,2.0k&3.2kHz Average
6	THD at 0.8W/2.2kHz	≤10%
7	Buzzes & Rattles	Must be normal at sine wave 2.37Vrms
8	Operating Temperature	-40~+105℃
9	Storage Temperature	-40~+105℃
10	Weight	1.7g
11	RoHS	Yes

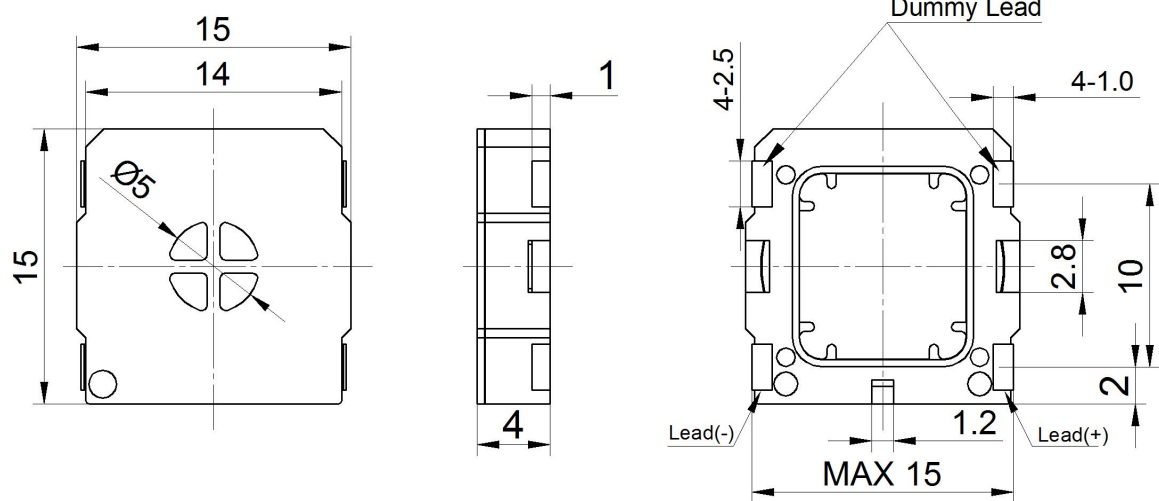

Recommended Land Pattern Dimensions

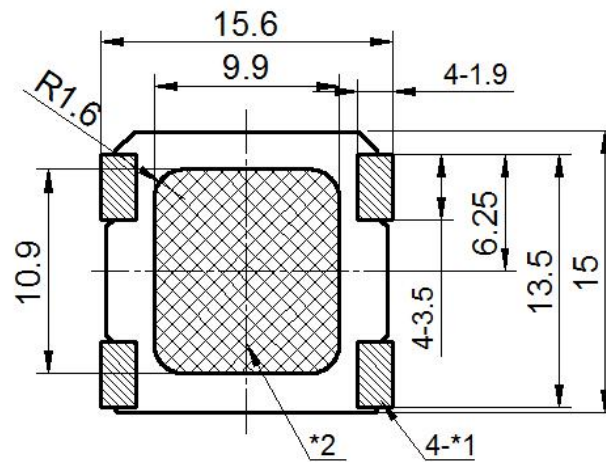

NOTE

1.Land pattern*1

2. Avoid any pattern on the shade area

*2 of PC board is highly recommended

TEST METHOD:

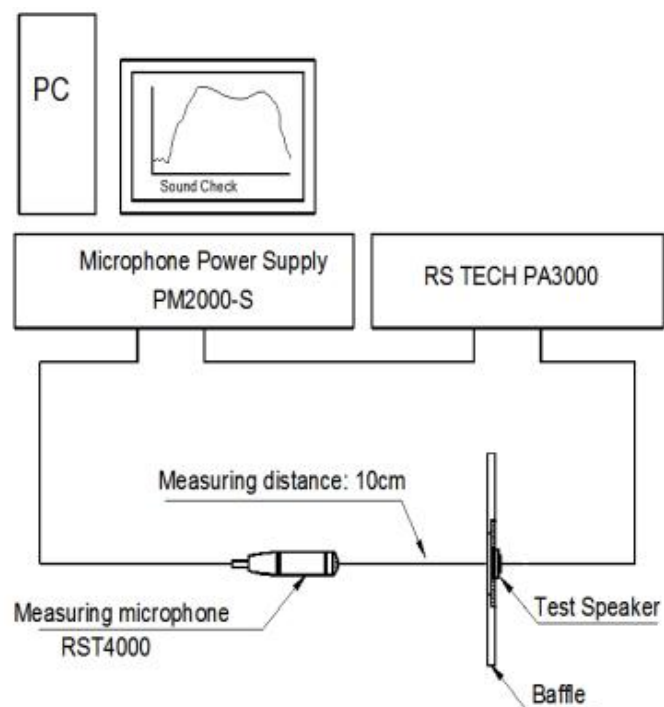

FREQUENCY RESPONSE:

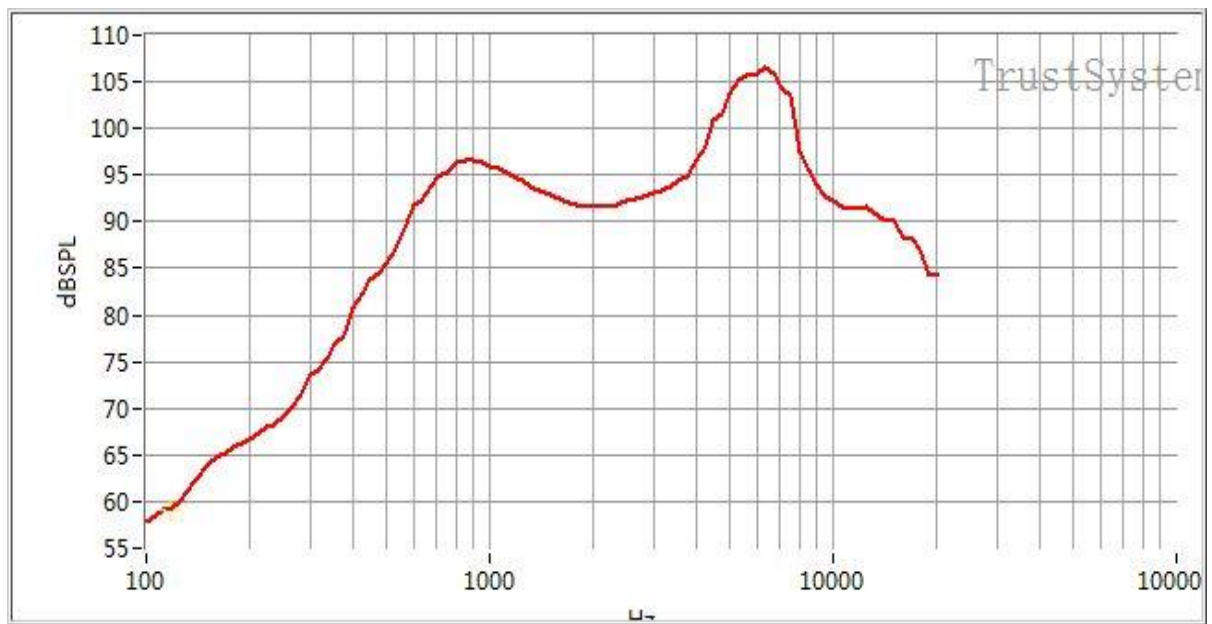

RELIABILITY TEST:

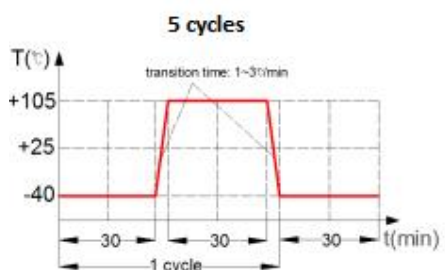
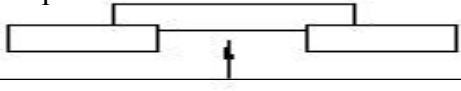
No.	Item	Test condition	Evaluation standard
1	High temp.	+105±2°C for 96hrs	After being placed for 2 to 4hrs at room temp, the product shall meet specifications, except the SPL should be in ±5dB compared with initial one; F0 should be in ±20%Hz compared with initial one.
2	Low temp.	-40±2°C for 96hrs	
3	Humidity	40±5°C, 93(+2/-3)%RH, for 96hrs	
4	Temperature cycling		After the test, the product shall meet specifications without any degradation in appearance and performance.
5	Vibration test	1.52mm amplitude, sweep time is 1 minute with 10 to 55Hz and 55 to 10Hz of vibration frequency to each of 3 perpendicular directions for 2 hrs.	
6	Drop test	The product shall be dropped from the height of 70cm onto 10mm thick wooden board each 3 times in 3 axial directions(x,y&z) (a total of 9 times).	
7	Lead pull	<p>The product shall be pushed with a force of 9.8N for 10±1 seconds behind the part.</p> 	After being placed for 2 hrs at room temp, the product shall meet specifications, except the SPL should be in ±5dB compared with initial one; F0 should be in ±20%Hz compared with initial one.
8	Endurance test	Rated power, pink noise for 96hrs	
9	Max. Short Term power test	Max power, pink noise 1sec On, 100sec Off 60 cycles	
10	Recommended temp. Profile for Reflow Oven	Shown in Fig.1	After the test, the product shall meet specifications
Warranty: For a period of one year from date of manufacturer under normal operations.			

Recommended Temp. Profile for Reflow Oven (Fig.1)

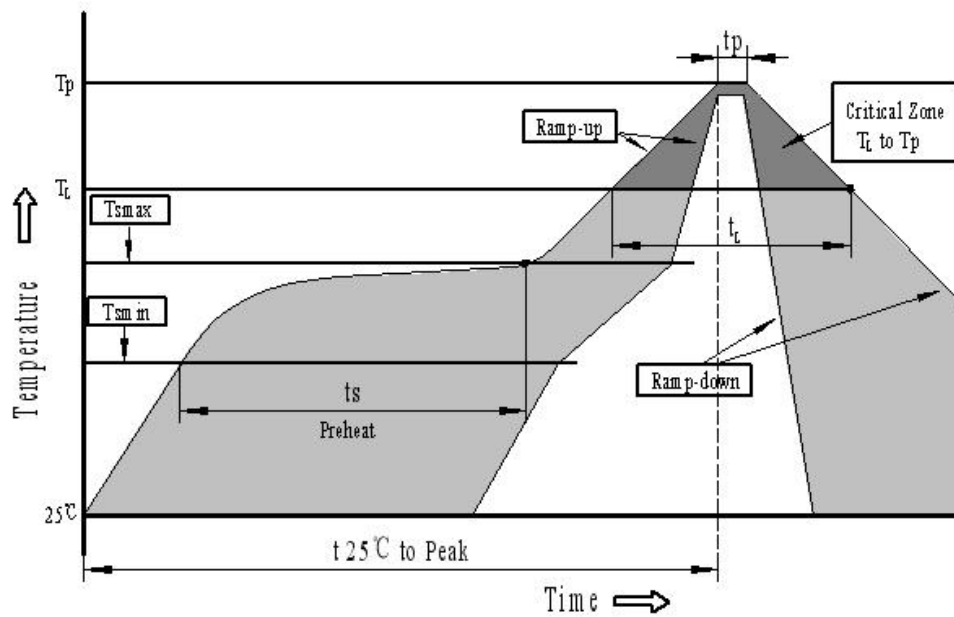

Profile Feature	Pb-Free Assembly
Average ramp-up rate(T _L to T _p)	3°C/second max.
Preheat	
-Temperature Min.(T _{sm in})	150°C
-Temperature Min.(T _{sm ax})	200°C
-Temperature Min.(ts)	60~180 seconds
T _{sm ax} to T _L	
-Ramp-up Rate	3°C/second max.
Time maintained above:	
- Temperature(T _L)	217°C
-Time(T _L)	60~150 seconds
Peak temperature(T _p)	245°C+0/-5°C
Time within 5°C of actual Peak temperature (tp)	6 seconds max.
Ramp-down Rate	6°C/second max.
Time 25°C to Peak Temperature	8 minutes max.
We suggest the customer do the reflow soldering once.	

PACKING:

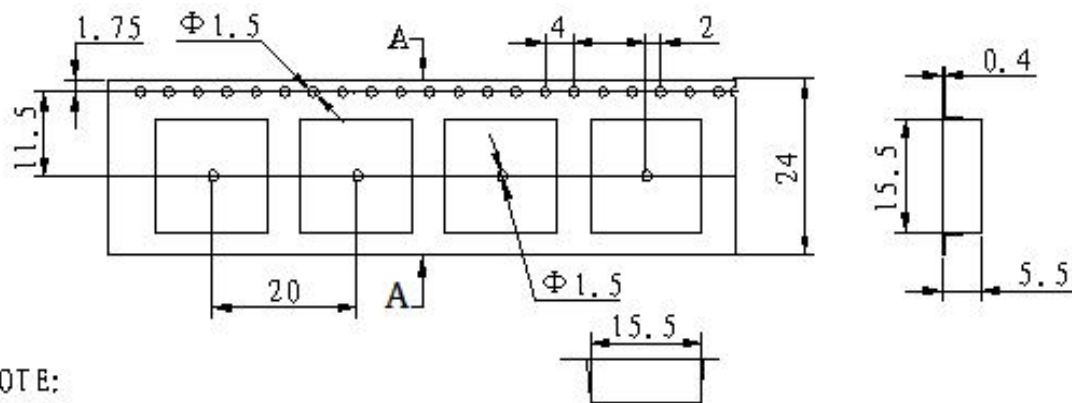

NOTE:

1. 10 sprocket hole pitch cumulative tolerance $\pm 0.20\text{mm}$.
2. All dimensions meet EIA-481-2-A requirements.
3. Thickness: $0.4 \pm 0.05\text{mm}$.
4. Component loaded per 13" reel: 600pcs.

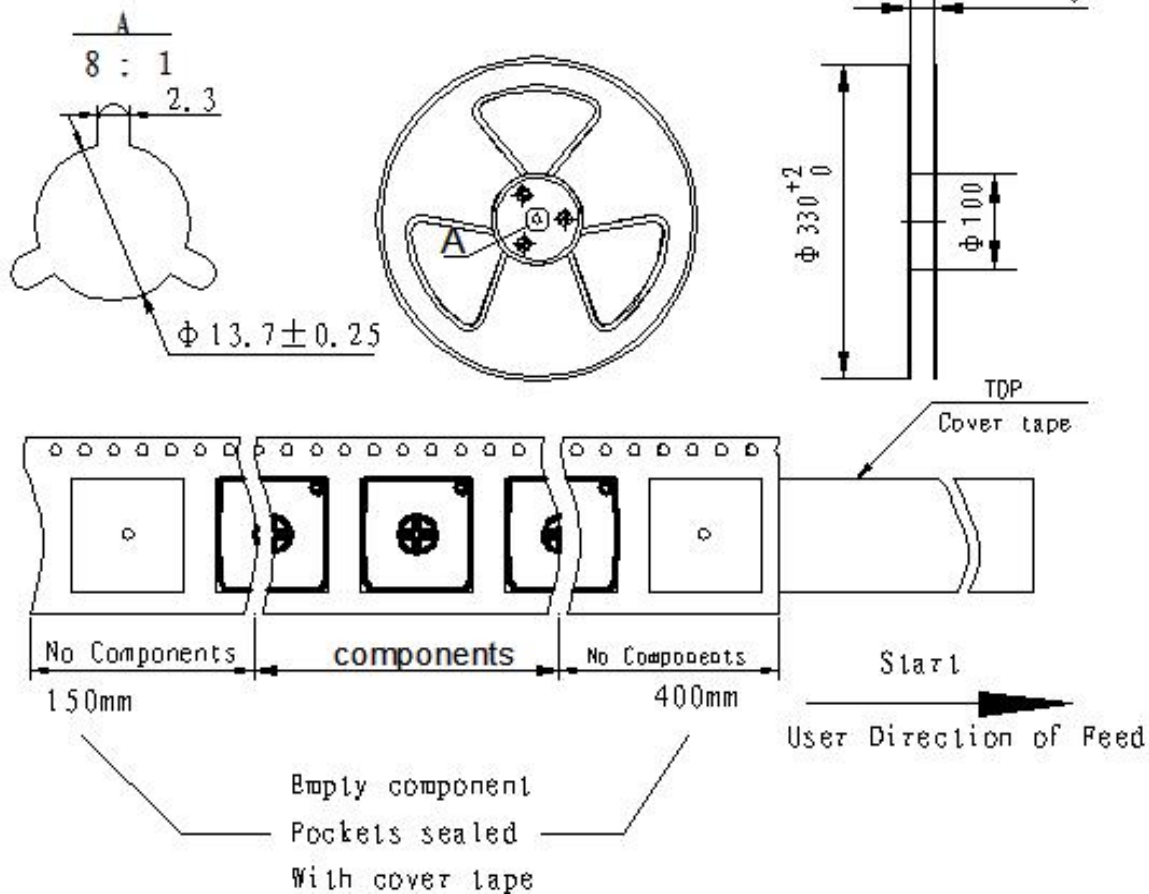

PACKING:

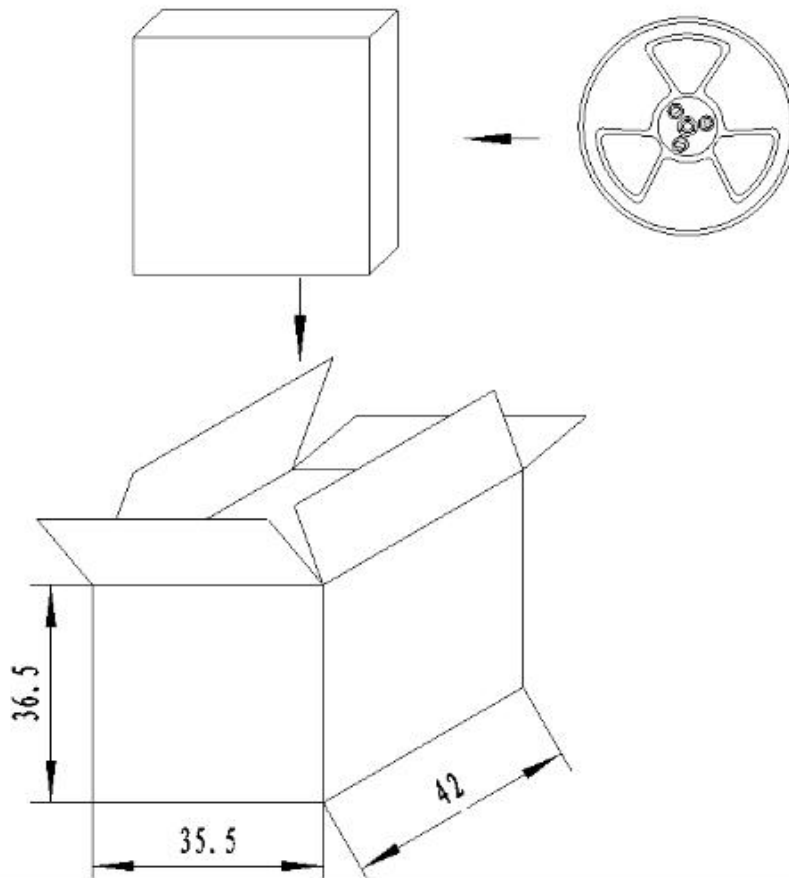

NOTES:

- 1.600 PCS per box
- 2.Total 10 boxes per carton
- 3.Total 6000 PCS carton
- 4.Volume: $42 \times 35.5 \times 36.5$ cm