

REV.	ECN.NO.	MODIFY.CONTENT	DATE
A		NEW	2019/05/29

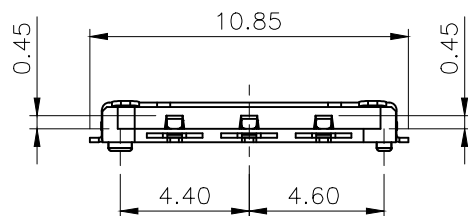

SIM PIN ASSIGNMENT	
PIN	Name
C1	VCC
C2	RST
C3	CLK
C5	GND
C6	VPP
C7	I/O

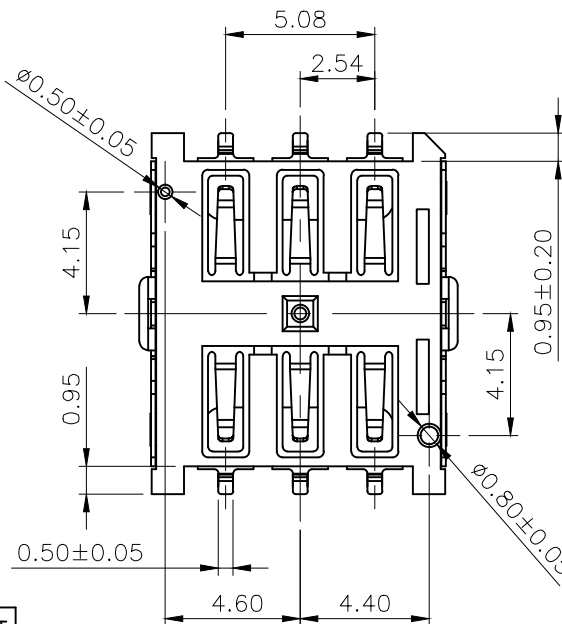
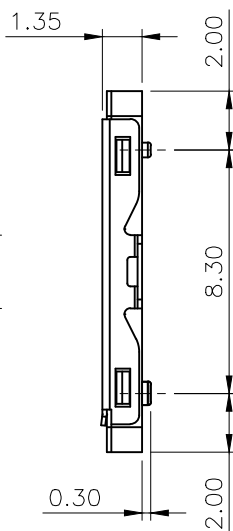
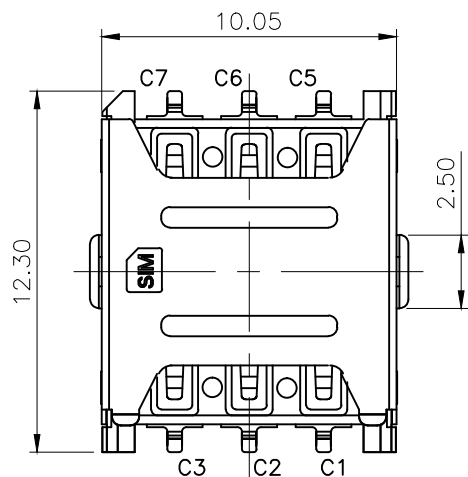
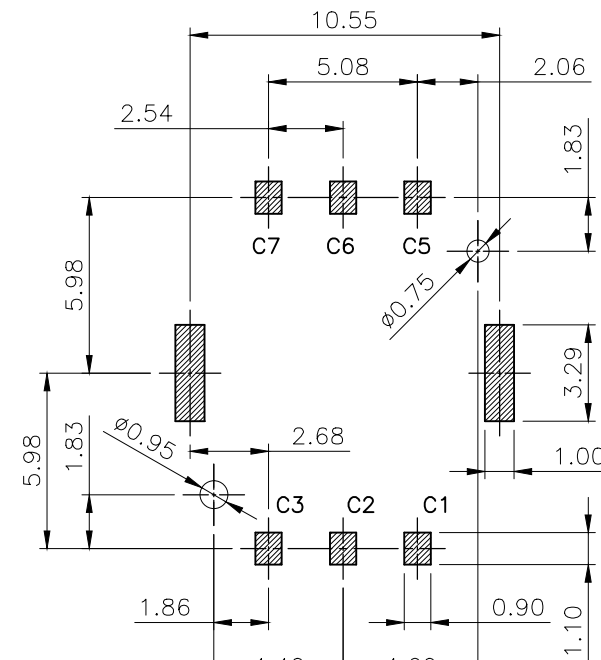
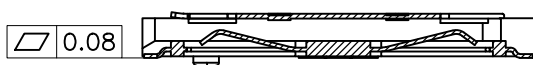

RECOMMEND PCB LAYOUT
TOLERANCE: $\pm 0.05\text{mm}$ (TOP VIEW)

MATERIALS

- HOUSING : LCP (UL 94V-0), BLACK.
- TERMINAL : PHOSPHOR BRONZE, GOLD FLASH PLATED, NICKEL UNDERPLATING.
- SHELL : STAINLESS STEEL, GOLD FLASH PLATED ON PAD AREA, NICKEL UNDERPLATING.

SPECIFICATION

- CURRENT RATING : 0.5mA AC/DC MAX.
- VOLTAGE RATING : 125V AC/DC.
- CONTACT RESISTANCE : 100m Ω MAX.
- INSULATION RESISTANCE : 1000M Ω Min, AT 500V DC.
- AMBIENT TEMPERATURE : -20°C TO +60°C

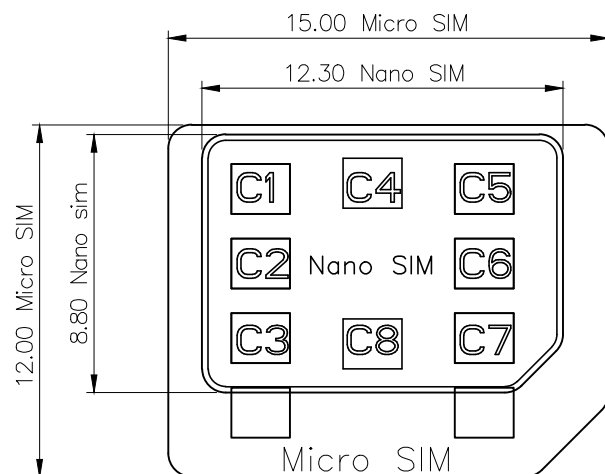
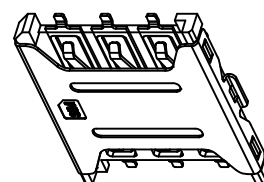

GENERAL TOLERANCE			DWG NO.		APPD:	WIND	Scale	1:1
X.±0.45	x.*±5°	Title	NANO SIM 6PIN 有柱 1.35H	CHKD:			UNIT	mm
.X±0.35	.x.*±2°			DR:				
.XX±0.25	.xx.*±1°	Part NO.	5001B-SIM135-116	Date	2019/05/29			
.XXX±0.15	.xxx.*±0.5°			东莞市文章济美电子有限公司				
SHEET	1/1							

REV.	ECN.NO.	MODIFY.CONTENT	DATE
A		NEW	2016/05/29

PULL OUT DIRECTION

COVER TAPE

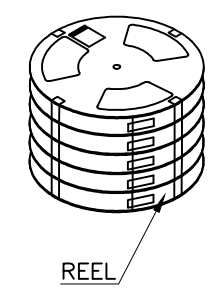

REEL

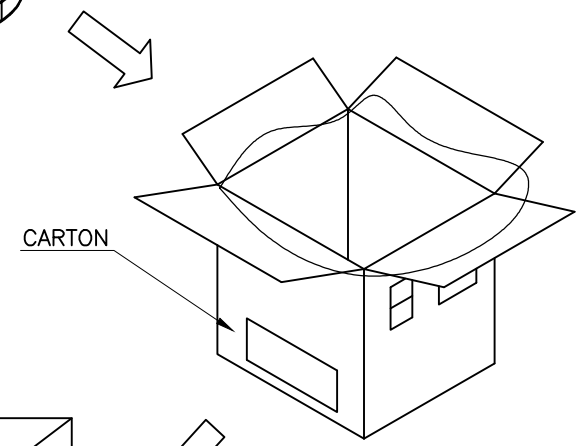
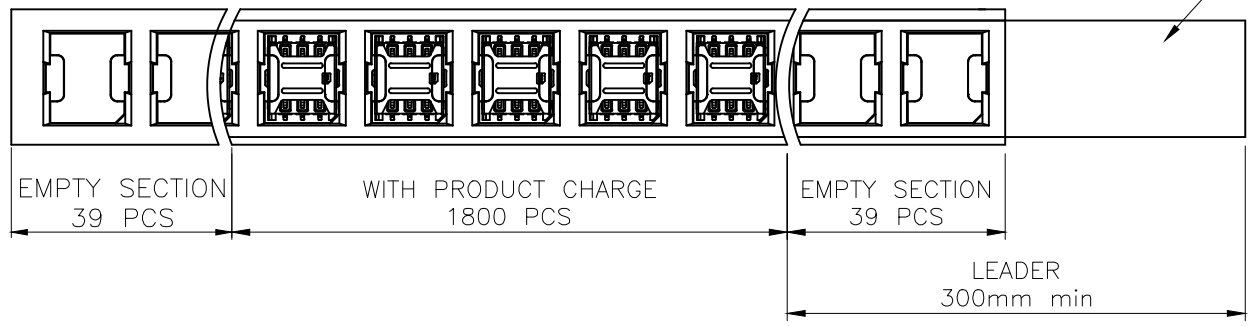

CARTON

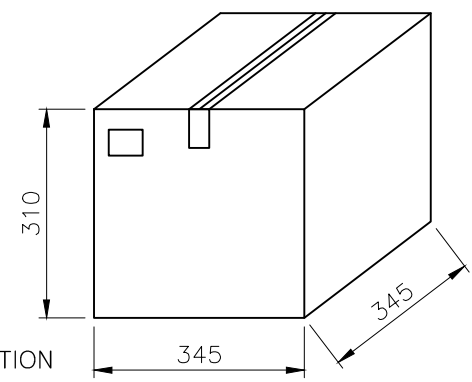
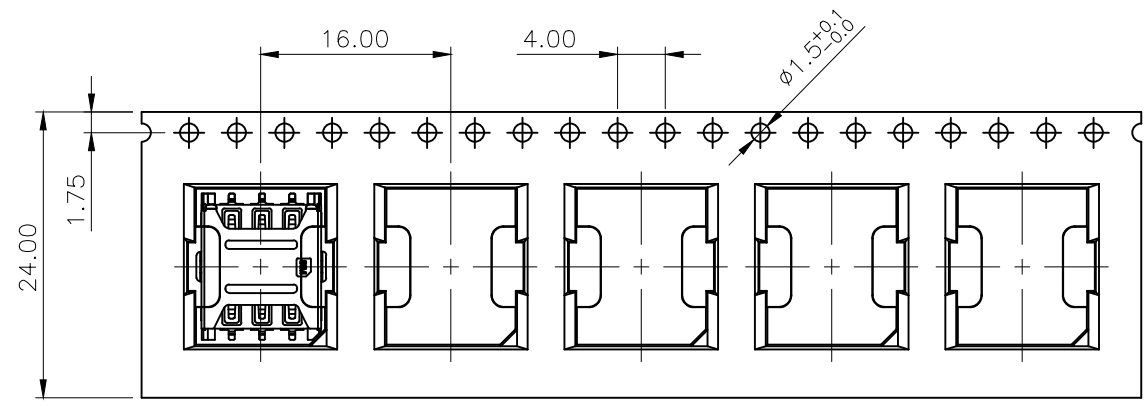

PULL OUT DIRECTION

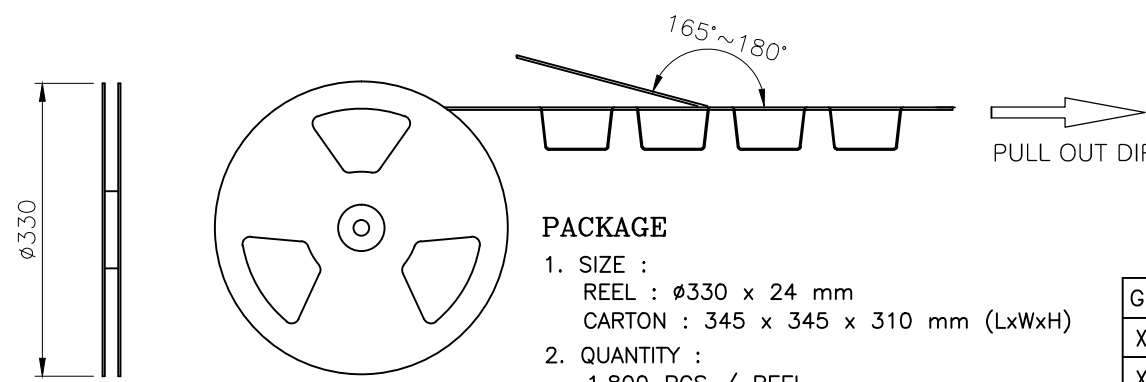

PACKAGE

- SIZE :
REEL : $\phi 330 \times 24$ mm
CARTON : $345 \times 345 \times 310$ mm (LxWxH)
- QUANTITY :
1,800 PCS / REEL
10 REEL / CARTON = 18,000 PCS

GENERAL TOLERANCE			DWG NO.		APPD:	WIND	Scale	1:1
X.±0.45	x.°±5°	Title	NANO SIM 6PIN 有柱 1.35H 包装图	CHKD:		UNIT	mm	
.X±0.35	.x°±2°			DR:				
.XX±0.25	.xx°±1°	Part NO.	5001B-SIM135-116	Date	2016/05/29			
.XXX±0.15	.xxx°±0.5°		东莞市文章济美电子有限公司					
SHEET	1/1							