

1.Features

- Small surface mounting type
- Low I_R
- High reliability

2.Pinning Information

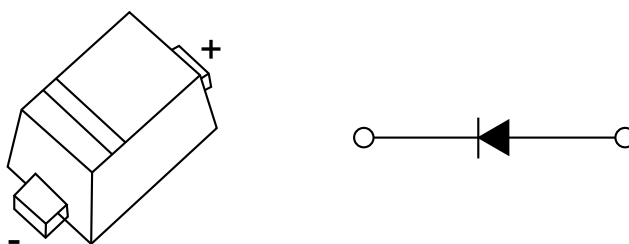

SOD-523

3.Absolute Maximum Ratings $T_A = 25^{\circ}\text{C}$

Parameter	Symbol	Rating	Units
DC Reverse Voltage	V_R	30	V
Mean Rectifying Current	I_O	200	mA
Non-repetitive Peak Forward Surge Current @ $t=8.3\text{ms}$	I_{FSM}	1	A
Power Dissipation	P_D	150	mW
Thermal Resistance Junction To Ambient	$R_{\theta JA}$	667	$^{\circ}\text{C/W}$
Operating Junction Temperature Range	T_J	-40 to 125	$^{\circ}\text{C}$
Storage Temperature Range	T_{STG}	-55 to 150	$^{\circ}\text{C}$



4. Electrical Characteristic ($T_A=25^{\circ}\text{C}$)

Parameter	Symbol	Conditions	Min	Typ	Max	Units
Forward Voltage	V_F	$I_F=200\text{mA}$			0.6	V
Reverse Current	I_R	$V_R=10\text{V}$			1	μA



5. Typical Characteristic

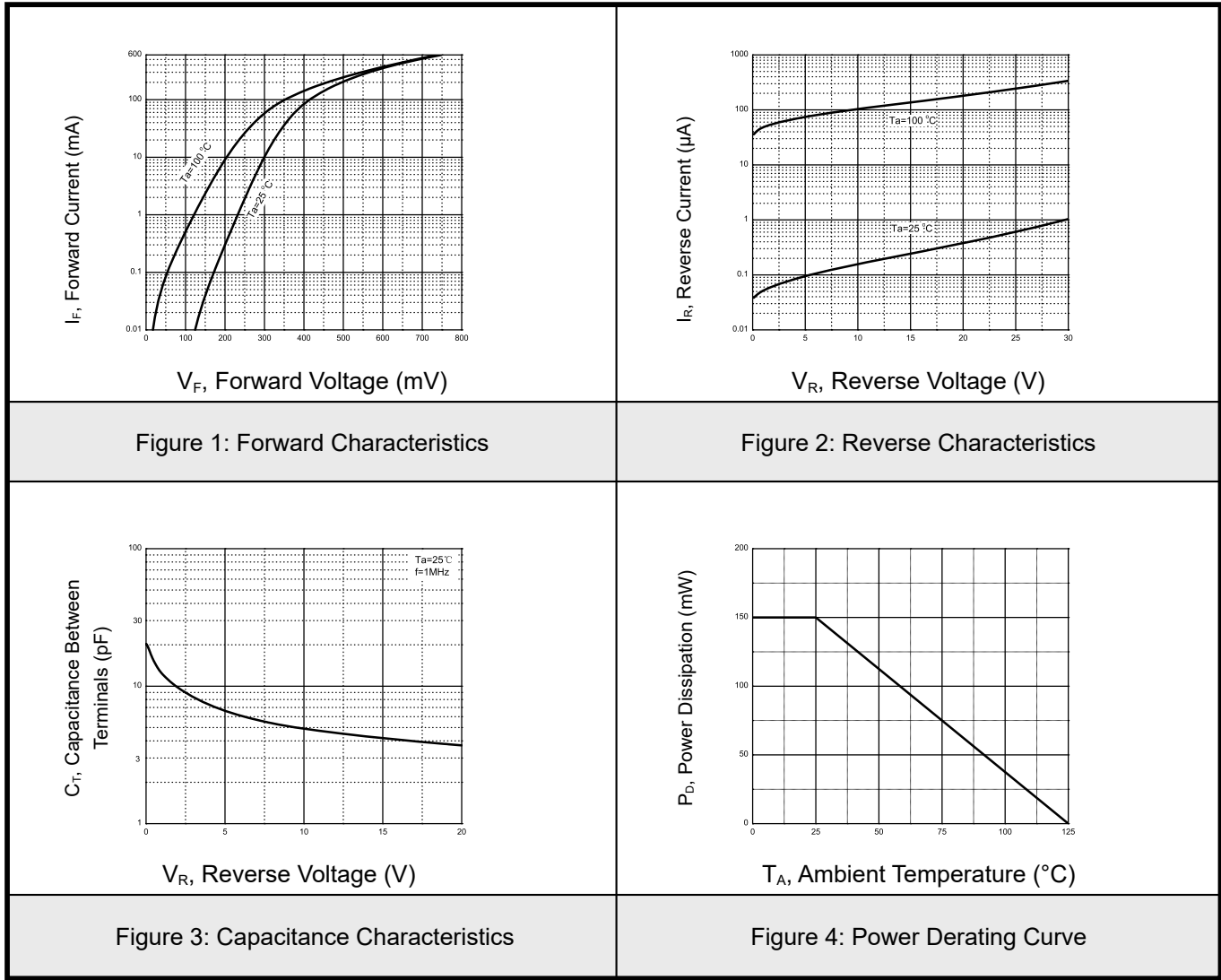



6.SOD-523 Package Outline Dimensions

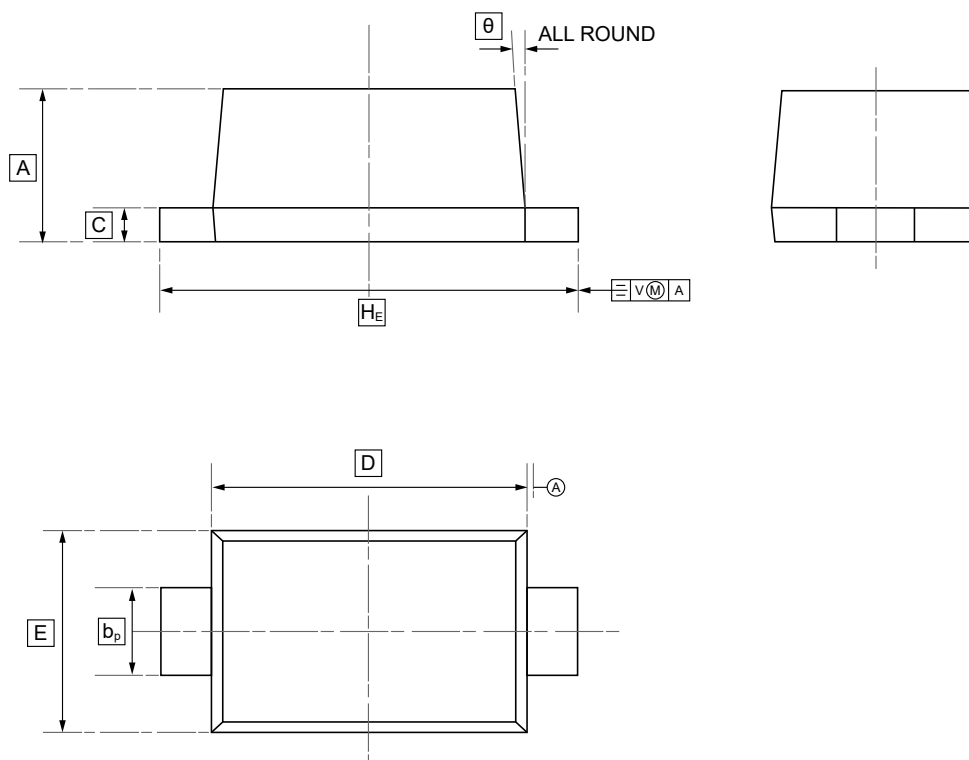

DIMENSIONS (mm are the original dimensions)

Symbol	A	b _p	C	D	E	H _E	θ
Min	0.58	0.3	0.100	1.15	0.75	1.5	5°
Max	0.68	0.4	0.135	1.25	0.85	1.7	



7.Ordering Information

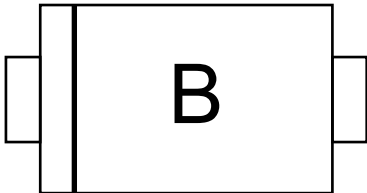

Order Code	Package	Base QTY	Delivery Mode
UMW RB520S-30	SOD-523	3000	Tape and reel



8.Disclaimer

UMW reserves the right to make changes to all products, specifications. Customers should obtain the latest version of product documentation and verify the completeness and currency of the information before placing an order.

When applying our products, please do not exceed the maximum rated values, as this may affect the reliability of the entire system. Under certain conditions, any semiconductor product may experience faults or failures. Buyers are responsible for adhering to safety standards and implementing safety measures during system design, prototyping, and manufacturing when using our products to prevent potential failure risks that could lead to personal injury or property damage.

Unless explicitly stated in writing, UMW products are not intended for use in medical, life-saving, or life-sustaining applications, nor for any other applications where product failure could result in personal injury or death. If customers use or sell the product for such applications without explicit authorization, they assume all associated risks.

When reselling, applying, or exporting, please comply with export control laws and regulations of China, the United States, the United Kingdom, the European Union, and other relevant countries, regions, and international organizations.

This document and any actions by UMW do not grant any intellectual property rights, whether express or implied, by estoppel or otherwise. The product names and marks mentioned herein may be trademarks of their respective owners.