

REV. AO	DATE 2021.06.27	ECN NO.	MODIFICATION NEW	APPROVER Jason
------------	--------------------	---------	---------------------	-------------------

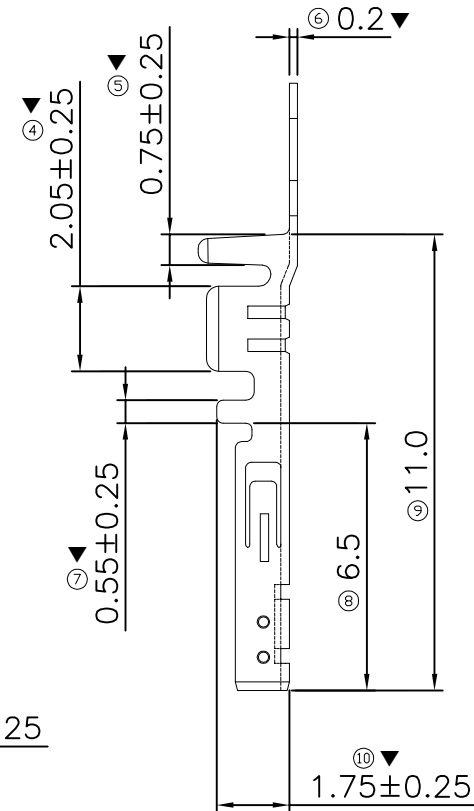
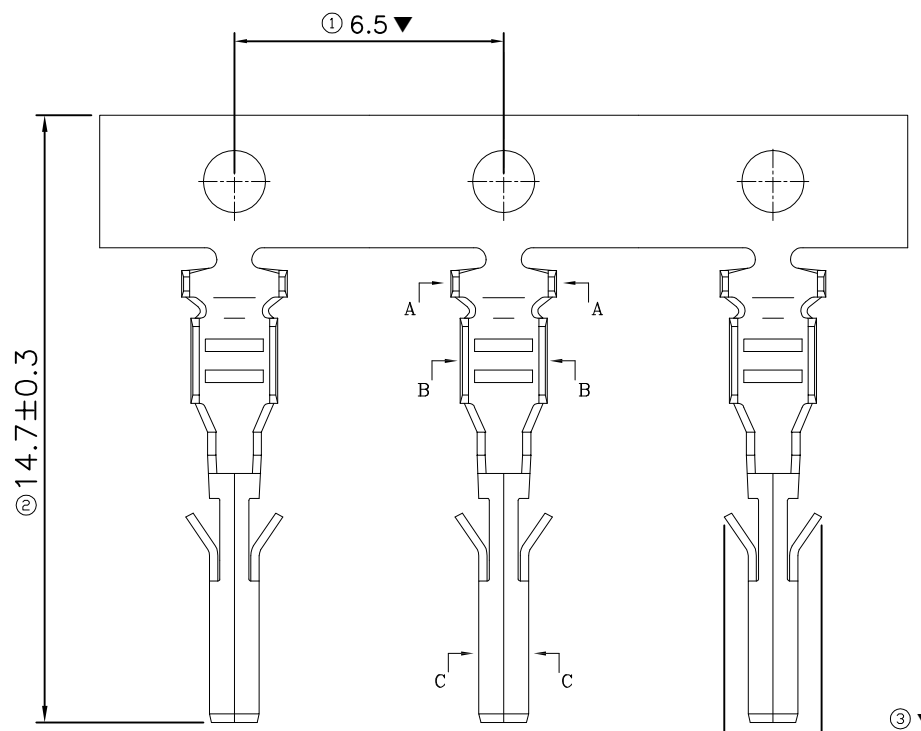

SPECIFICATIONS

- Current Rating: 5A AC,DC
- Voltage Rating: 250V AC,DC(rms)
- Temperatuer Range: -25°C~+85°C
- Contact Resistance: 20mΩ Max
- Insulation Resistance: 1000MΩ Min
- Withstanding Voltang: 1500V AC/minute
- Apply to gauge: #20-#30AWG

Material:

- Phosphor bronze Copper Alloy
Bright Tin plated

Major Dimension:▼
Lead free and ROHS compliant product

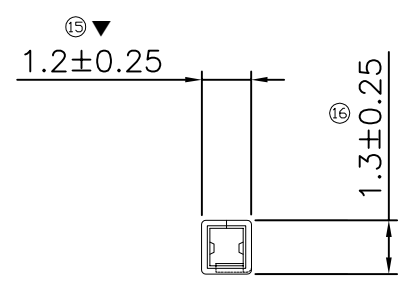
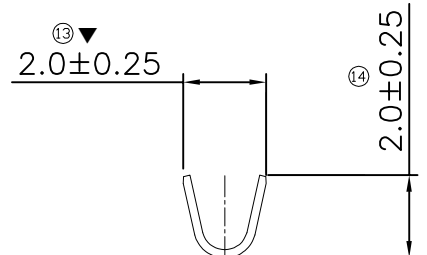
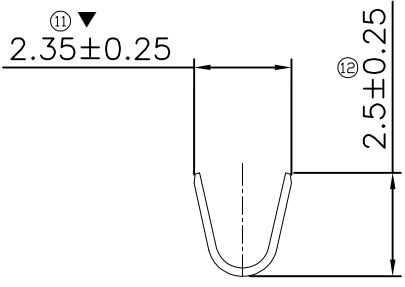

GENERAL TOLERANCE			UNITS mm	NAME(INTENDED USE) 柳线端子	ATOM® 深圳市爱特姆科技有限公司 SHENZHEN ATOM TECHNOLOGY CO., LTD.
SELECT	TOL.	ON.			
X.XXX	±0.10	±0.15	±0.20	PART NO.(INTENDED USE) TR300010113200	TITLE: Customer Drawing For 3.0 柳线 磷铜镀锡 母端
X.XX	±0.15	±0.20	±0.25		
X.X	±0.20	±0.25	±0.30	APPD: Abel	DWG NO.: ATOM-A07123
X.	±0.25	±0.30	±0.50		
ANGLE	±2'			CHKD: Tom	SCALE: 1:1
				DR: XCF	
					REV: AO