

P	LTR	DESCRIPTION	DATE	DWN	APVD
A2		REVISE	16AUG2023	S.D	W.Z
A3		REVISE	12OCT2023	S.D	W.Z
A4		rev_desc_3	25APR2024	J.Z	W.Z
A5		ADD 3 LAYER PLATING ADN AU PLATING	21FEB2025	R.W	W.Z

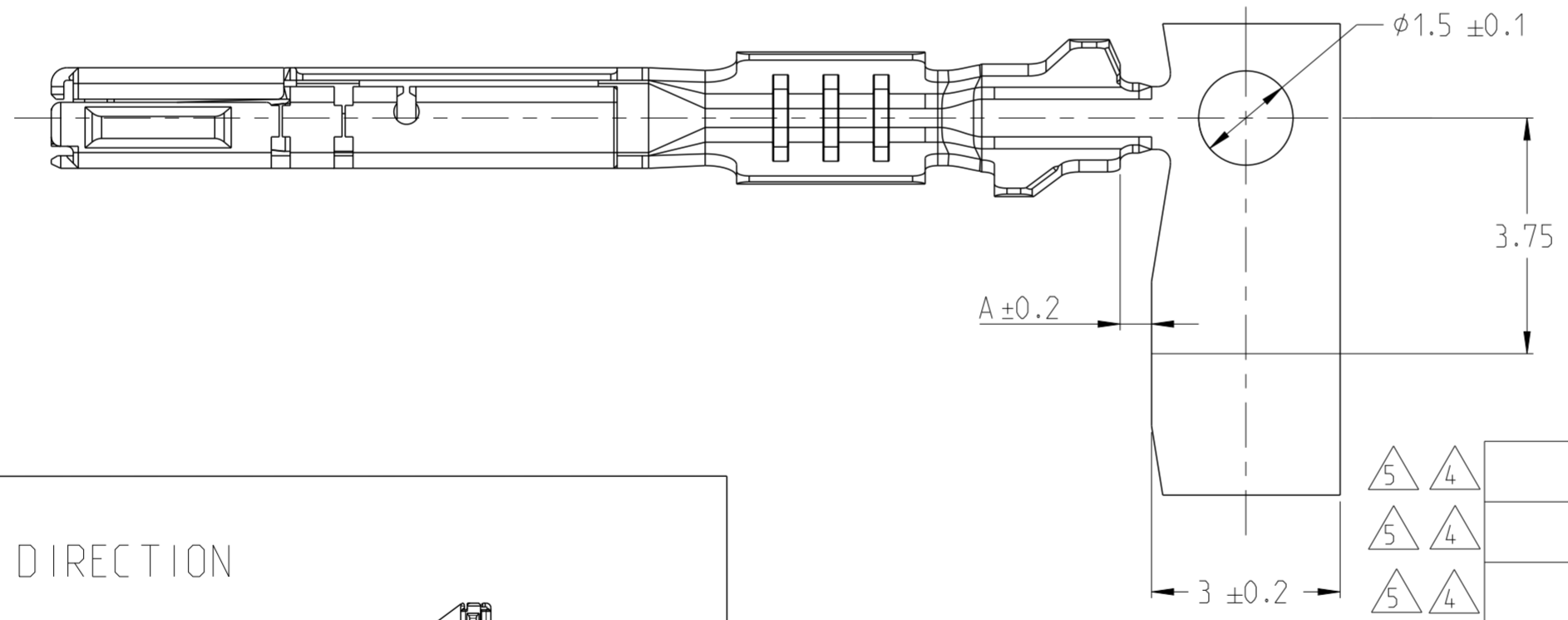

- 1. MAX.9 TERMINAL MISSING PER REEL PERMITTED
- 2. 3 LOOSE SPLICES PER REEL PERMITTED
- 3 TE LOGO
- 4 LOW INSERTION FORCE VERSION.
- 5 PRELIMINARY, NOT COMPLETE PRODUCT VALIDATION.

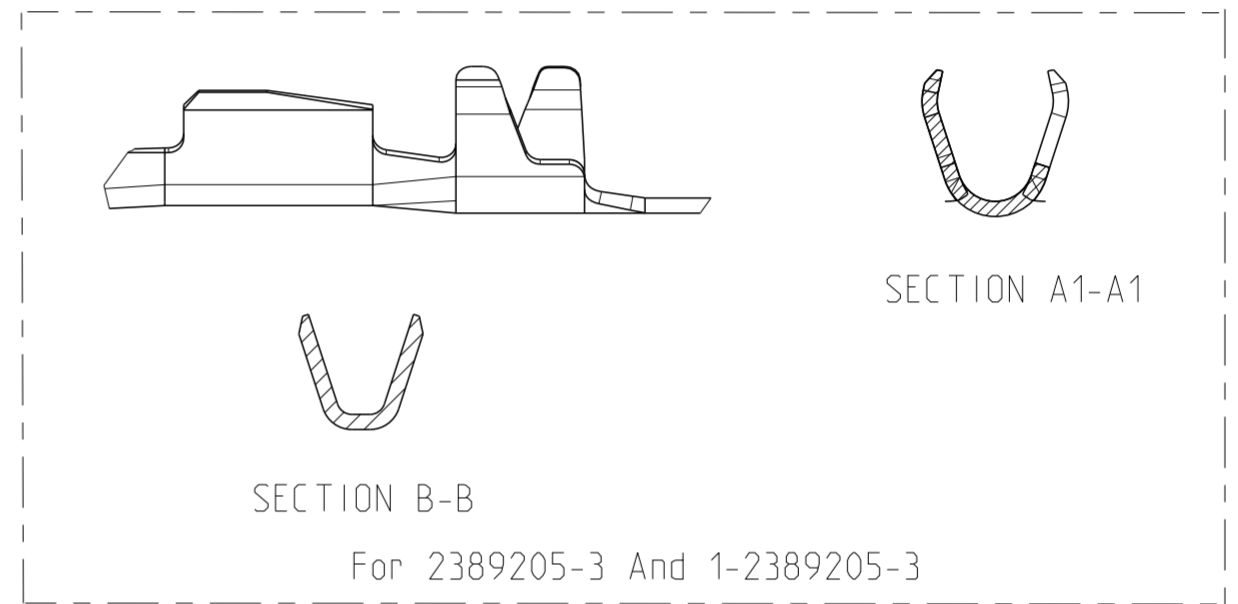
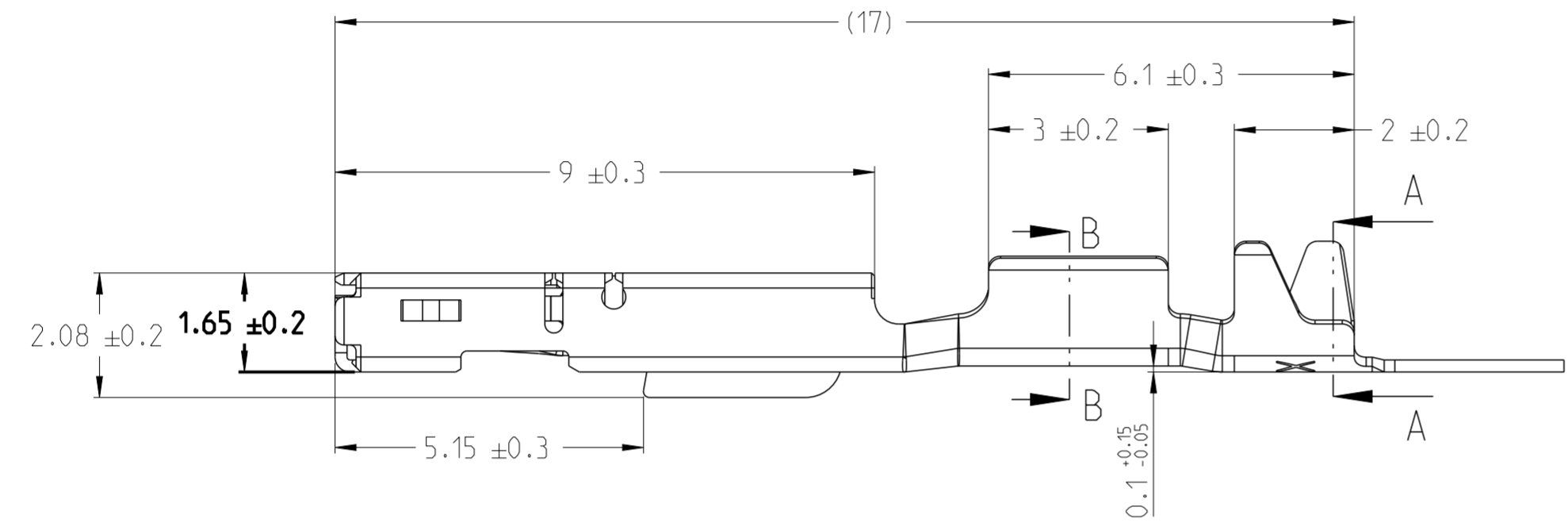
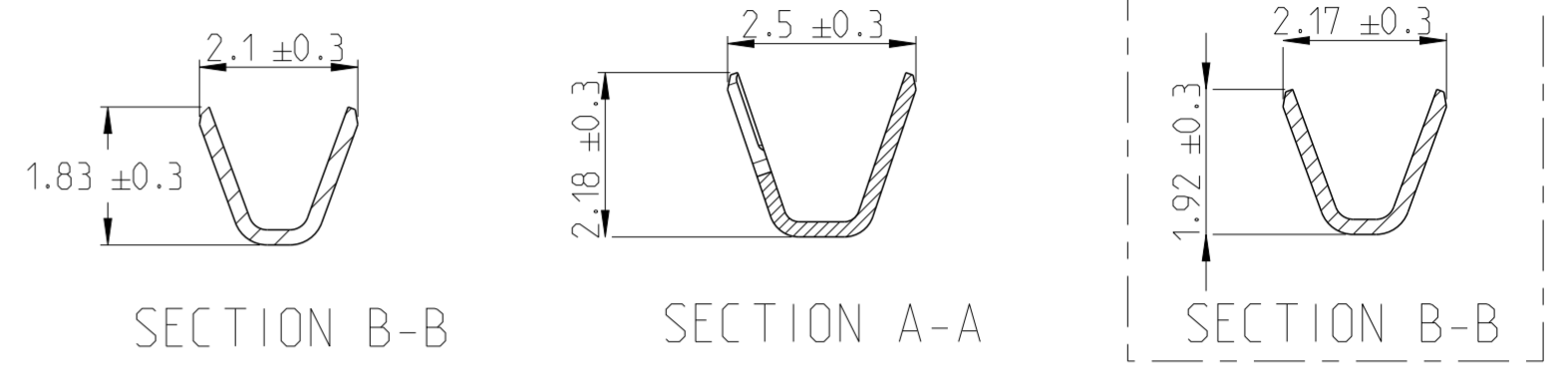
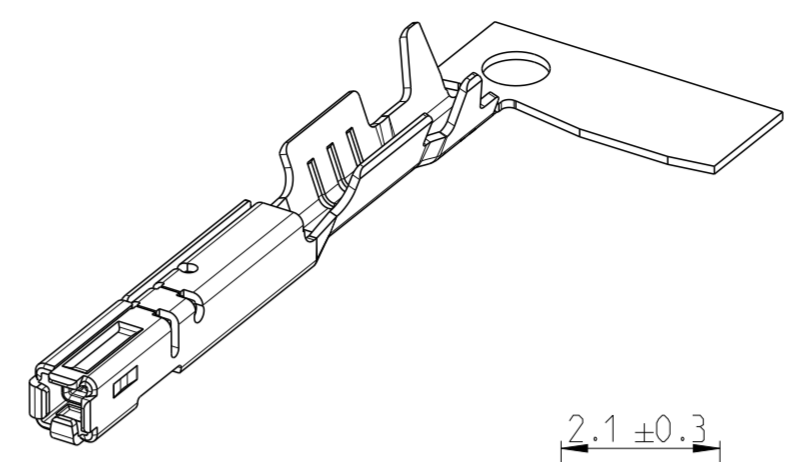
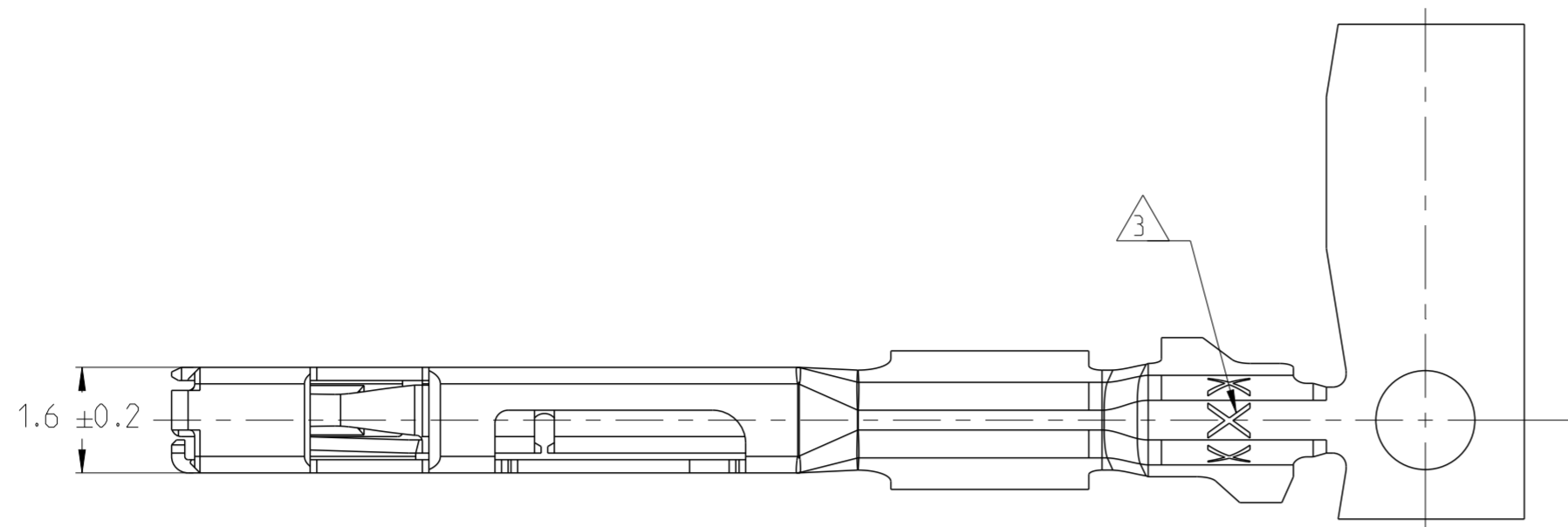
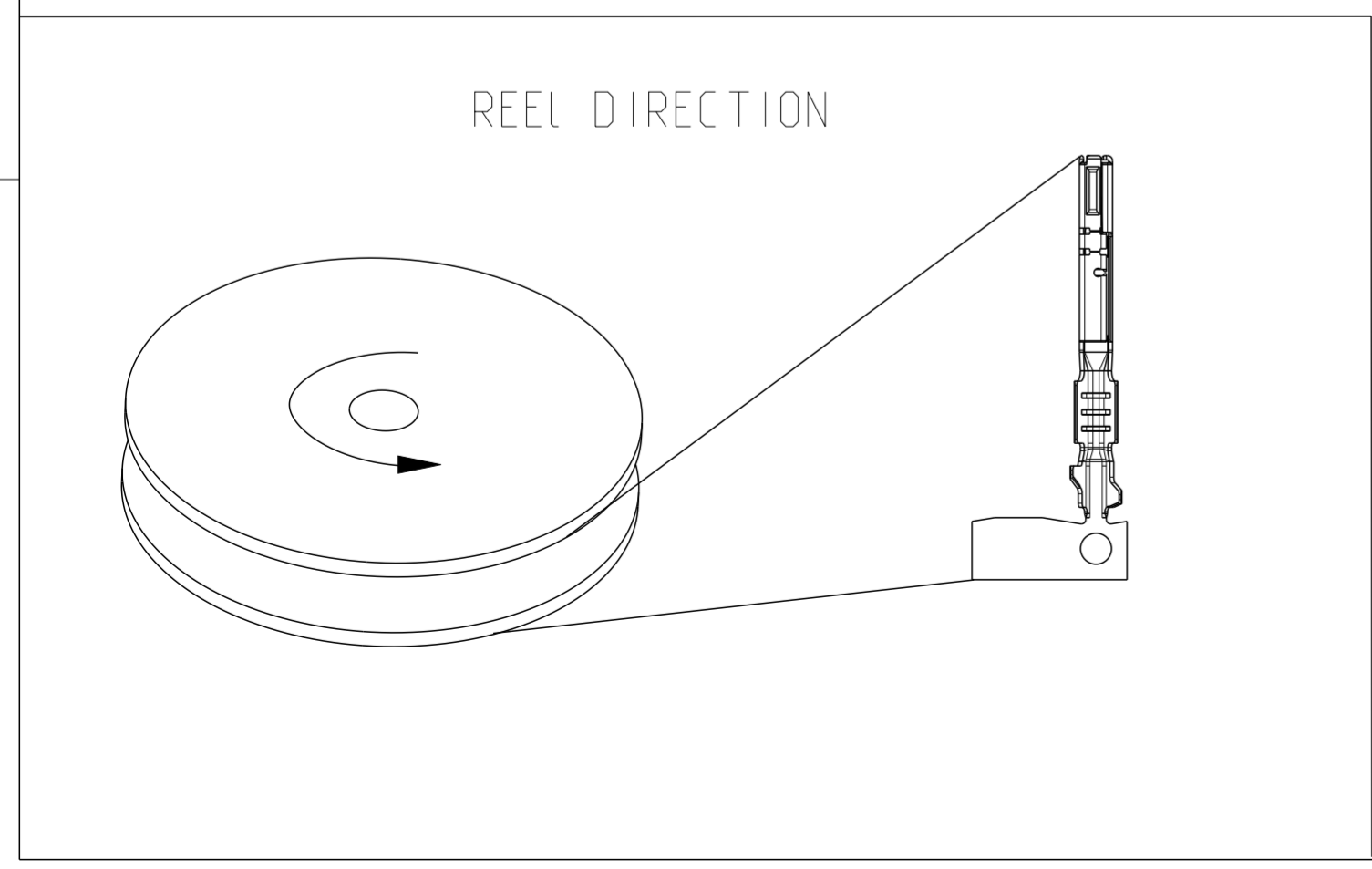

5 4	1.2-1.4	0.22-0.35mm ²	Au	CuNiSi	1	2-2389205-1	0.5
5 4	0.95-1.1	0.13-0.17mm ²	TIN	CuNiSi	1	1-2389205-3	0.8
5 4	1.4-1.6	0.5mm ²	TIN	CuNiSi	1	1-2389205-2	0.5
5 4	1.2-1.4	0.22-0.35mm ²	TIN	CuNiSi	1	1-2389205-1	0.5
	0.95-1.1	0.13-0.17mm ²	TIN	CuNiSi	A	2389205-3	0.8
	1.4-1.6	0.5mm ²	TIN	CuNiSi	A	2389205-2	0.5
	1.2-1.4	0.22-0.35mm ²	TIN	CuNiSi	A	2389205-1	0.5
	INSULATION RANGE	WIRE SIZE	FINISH	MATERIAL	REV.	PART NUMBER	DIM. A

THIS DRAWING IS A CONTROLLED DOCUMENT.

DWN	S.DU	16AUG2023
CHK	J.GU	16AUG2023
APVD	W.ZHANG	16AUG2023
PRODUCT SPEC		
APPLICATION SPEC	114-160148	
WEIGHT	-	
CUSTOMER DRAWING		

TE Connectivity

REM 064 UNSEAL RECEPTACLE CONTACT
UNSEAL

SIZE	CAGE CODE	DRAWING NO	RESTRICTED TO
A2	00779	C-2389205	-
SCALE	6:1	SHEET	1 OF 1
REV	A6		